

Oklahoma Corporation Commission
Oil & Gas Conservation Division
Post Office Box 52000
Oklahoma City, Oklahoma 73152-2000
Rule 165: 10-3-25

Form 1002A

API No.: 35103247550000

Completion Report

Spud Date: July 10, 2019

OTC Prod. Unit No.: 103-225823-0-0000

Drilling Finished Date: July 17, 2019

1st Prod Date: August 05, 2019

Completion Date: July 31, 2019

Drill Type: STRAIGHT HOLE

Well Name: FYNES MCGILL 3

Purchaser/Measurer:

Location: NOBLE 35 22N 2W
C SE NW SW
990 FNL 990 FWL of 1/4 SEC
Latitude: 36.337528 Longitude: -97.386667
Derrick Elevation: 1001 Ground Elevation: 994

First Sales Date:

Operator: DAVIDSON ENERGY INC 17058
PO BOX 782
621 DELAWARE
PERRY, OK 73077-0782

Completion Type		Location Exception		Increased Density	
X	Single Zone	Order No		Order No	
	Multiple Zone	There are no Location Exception records to display.		There are no Increased Density records to display.	
	Commingled				

Casing and Cement							
Type	Size	Weight	Grade	Feet	PSI	SAX	Top of CMT
SURFACE	8 5/8	24	J-55	364		220	SURFACE
PRODUCTION	5 1/2	17	J-55	4914		180	3700

Liner								
Type	Size	Weight	Grade	Length	PSI	SAX	Top Depth	Bottom Depth
There are no Liner records to display.								

Total Depth: 4920

Packer	
Depth	Brand & Type
There are no Packer records to display.	

Plug	
Depth	Plug Type
There are no Plug records to display.	

Initial Test Data										
Test Date	Formation	Oil BBL/Day	Oil-Gravity (API)	Gas MCF/Day	Gas-Oil Ratio Cu FT/BBL	Water BBL/Day	Pumpin or Flowing	Initial Shut-In Pressure	Choke Size	Flow Tubing Pressure
Sep 05, 2019	MISSISSIPPI CHAT	44	41	148	3364	10	PUMPING			

Completion and Test Data by Producing Formation			
Formation Name: MISSISSIPPI CHAT		Code: 401MSSCT	Class: OIL
Spacing Orders		Perforated Intervals	
Order No	Unit Size	From	To
N/A		4750	4780
Acid Volumes		Fracture Treatments	
1,000 GALLONS 15% NEFE		41,500 GALLONS WATER, 10,000 GALLONS 15% NEFE, 25,200 POUNDS 20/40 SAND	

Formation	Top
BIG LIME	4309
SKINNER	4628
MISSISSIPPI CHAT	4753
MISSISSIPPI LIME	4784
WOODFORD	4895

Were open hole logs run? Yes
Date last log run: July 16, 2019

Were unusual drilling circumstances encountered? No
Explanation:

Other Remarks
There are no Other Remarks.

FOR COMMISSION USE ONLY	
Status: Accepted	1143808

API NO. 103 24755
OTC PROD. UNIT NO. 103 225823

(PLEASE TYPE OR USE BLACK INK ONLY)

OKLAHOMA CORPORATION COMMISSION
Oil & Gas Conservation Division
Post Office Box 52000
Oklahoma City, Oklahoma 73152-2000
Rule 165:10-3-25

RECEIVED

Form 1002A
Rev. 2009

SEP 10 2019

OKLAHOMA CORPORATION COMMISSION

☒ ORIGINAL
☐ AMENDED (Reason)

TYPE OF DRILLING OPERATION

☒ STRAIGHT HOLE ☐ DIRECTIONAL HOLE ☐ HORIZONTAL HOLE
☐ SERVICE WELL

If directional or horizontal, see reverse for bottom hole location.

COUNTY Noble SEC 35 TWP 22N RGE 02W
LEASE NAME Fynes McGill WELL NO. 3
1/4 SE 1/4 NW 1/4 SW 1/4 330 FWL OF 1/4 SEC 990
ELEVATION Derrick FL 1001 Ground 994 Latitude (if known) 36.337528 Longitude (if known) -97.386667
OPERATOR NAME Davidson Energy, Inc. OTC / OCC OPERATOR NO. 17058
ADDRESS P.O. Box 782
CITY Perry STATE OK ZIP 73077

COMPLETION REPORT

SPUD DATE 07/10/2019
DRLG FINISHED DATE 07/17/2019
DATE OF WELL COMPLETION 07/31/2019
1st PROD DATE 08/05/2019
RECOMP DATE

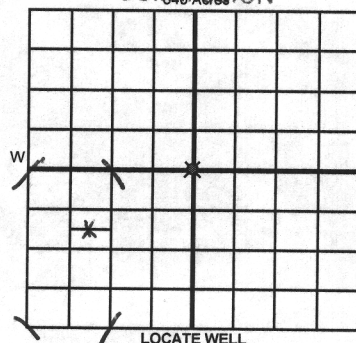

COMPLETION TYPE

☒ SINGLE ZONE
☐ MULTIPLE ZONE
☐ COMINGLED
☐ LOCATION EXCEPTION
☐ ORDER NO.
☐ INCREASED DENSITY
☐ ORDER NO.

CASING & CEMENT (Attach Form 1002C)

TYPE	SIZE	WEIGHT	GRADE	FEET	PSI	SAX	TOP OF CMT
CONDUCTOR							
SURFACE	8 5/8	24	J55	364.43		220 120	surface
INTERMEDIATE							
PRODUCTION	5 1/2	17	J55	4914		180	3700
LINER							

PACKER @ BRAND & TYPE PLUG @ TYPE PLUG @ TYPE
PACKER @ BRAND & TYPE PLUG @ TYPE PLUG @ TYPE

TOTAL DEPTH 4920

COMPLETION & TEST DATA BY PRODUCING FORMATION

FORMATION Mississippi - Miss Chat
SPACING & SPACING ORDER NUMBER N/A
CLASS: Oil, Gas, Dry, Inj, Disp, Comm Disp, Svc oil
PERFORATED INTERVALS 4750-4780
ACID/VOLUME 1000g 15% NEFE
FRACTURE TREATMENT (Fluids/Prop Amounts) 41,500 gal wtr
10,000 gal 15% NEFE
25,200# 20/40 Sand

Min Gas Allowable (165:10-17-7) OR Gas Purchaser/Measurer
Oil Allowable (165:10-13-3) First Sales Date

INITIAL TEST DATA

INITIAL TEST DATE 9/5/2019
OIL-BBL/DAY 44
OIL-GRAVITY (API) 41
GAS-MCF/DAY 148
GAS-OIL RATIO CU FT/BBL 3363.63 3364
WATER-BBL/DAY 10
PUMPING OR FLOWING pumping
INITIAL SHUT-IN PRESSURE NA
CHOKE SIZE N/A
FLOW TUBING PRESSURE N/A

AS SUBMITTED

A record of the formations drilled through, and pertinent remarks are presented on the reverse. I declare that I have knowledge of the contents of this report and am authorized by my organization to make this report, which was prepared by me or under my supervision and direction, with the data and facts stated herein to be true, correct, and complete to the best of my knowledge and belief.
Signature: Gerald W. Davidson
P.O. Box 782
ADDRESS: Perry OK 73077
NAME (PRINT OR TYPE): Gerald W. Davidson
CITY: Perry STATE: OK ZIP: 73077
DATE: 09/07/2019
PHONE NUMBER: 580 572-8137
EMAIL ADDRESS: Gerald@DavidsonEnergyInc.com

PLEASE TYPE OR USE BLACK INK ONLY
FORMATION RECORD

Give formation names and tops, if available, or descriptions and thickness of formations drilled through. Show intervals cored or drillstem tested.

NAMES OF FORMATIONS	TOP
Big Lime	4,309
Skinner	4,628
Miss. Chat	4753
Miss. Lime	4,784
Woodford	4,895

LEASE NAME Fynes McGill WELL NO. 3

FOR COMMISSION USE ONLY	
ITD on file <input type="checkbox"/> YES <input type="checkbox"/> NO	
APPROVED _____ DISAPPROVED _____	2) Reject Codes
<div style="border: 1px solid black; height: 100px; width: 100%;"></div>	

Were open hole logs run?	<input checked="" type="checkbox"/> yes <input type="checkbox"/> no	
Date Last log was run	<u>7-16-2019</u>	
Was CO ₂ encountered?	<input type="checkbox"/> yes <input checked="" type="checkbox"/> no	at what depths? _____
Was H ₂ S encountered?	<input type="checkbox"/> yes <input checked="" type="checkbox"/> no	at what depths? _____
Were unusual drilling circumstances encountered?	<input type="checkbox"/> yes <input checked="" type="checkbox"/> no	
If yes, briefly explain below		

Other remarks:

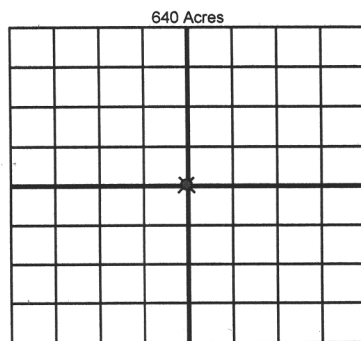

If more than three drainholes are proposed, attach a separate sheet indicating the necessary information.

Direction must be stated in degrees azimuth. Please note, the horizontal drainhole and its end point must be located within the boundaries of the lease or spacing unit.

Directional surveys are required for all drainholes and directional wells.

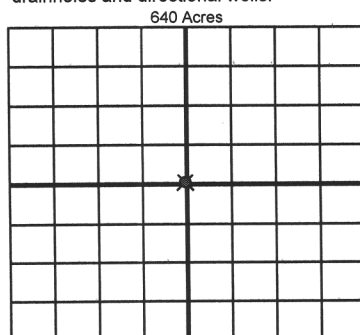

BOTTOM HOLE LOCATION FOR DIRECTIONAL HOLE

SEC	TWP	RGE	COUNTY
Spot Location			
1/4	1/4	1/4	1/4
Measured Total Depth		True Vertical Depth	BHL From Lease, Unit, or Property Line:

BOTTOM HOLE LOCATION FOR HORIZONTAL HOLE: (LATERALS)

LATERAL #1			
SEC	TWP	RGE	COUNTY
Spot Location			
1/4	1/4	1/4	1/4
Depth of Deviation		Radius of Turn	Direction
Measured Total Depth		True Vertical Depth	Total Length
		BHL From Lease, Unit, or Property Line:	

LATERAL #2			
SEC	TWP	RGE	COUNTY
Spot Location			
1/4	1/4	1/4	1/4
Depth of Deviation		Radius of Turn	Direction
Measured Total Depth		True Vertical Depth	Total Length
		BHL From Lease, Unit, or Property Line:	

LATERAL #3			
SEC	TWP	RGE	COUNTY
Spot Location			
1/4	1/4	1/4	1/4
Depth of Deviation		Radius of Turn	Direction
Measured Total Depth		True Vertical Depth	Total Length
		BHL From Lease, Unit, or Property Line:	