

Oklahoma Corporation Commission  
Oil & Gas Conservation Division  
Post Office Box 52000  
Oklahoma City, Oklahoma 73152-2000  
Rule 165: 10-3-25

Form 1002A

API No.: 35139207670003

**Completion Report**

Spud Date: August 14, 1975

OTC Prod. Unit No.:

Drilling Finished Date: September 01, 1975

**Amended**

1st Prod Date:

Amend Reason: WELL REPAIR RAISED PACKER

Completion Date: September 01, 1975

Recomplete Date: February 26, 2018

**Drill Type: STRAIGHT HOLE**

**SERVICE WELL**

Well Name: BONRAY A SWD (BONRAY A 1) 1-D

Purchaser/Measurer:

Location: TEXAS 31 4N 15E CM  
C SE  
1320 FSL 1320 FWL of 1/4 SEC  
Latitude: 36.76583 Longitude: -101.47914  
Derrick Elevation: 3122 Ground Elevation: 3113

First Sales Date:

Operator: BKEP SERVICES LLC 22860

6060 S AMERICAN PLAZA ST EAST STE 600  
TULSA, OK 74135-4351

Completion Type	
X	Single Zone
	Multiple Zone
	Commingled

Location Exception	
Order No	
There are no Location Exception records to display.	

Increased Density	
Order No	
There are no Increased Density records to display.	

Casing and Cement							
Type	Size	Weight	Grade	Feet	PSI	SAX	Top of CMT
SURFACE	8 5/8	24		1633	1000		SURFACE
PRODUCTION	5 1/2	14		5798	1000	80	3510

Liner								
Type	Size	Weight	Grade	Length	PSI	SAX	Top Depth	Bottom Depth
There are no Liner records to display.								

**Total Depth: 6785**

Packer	
Depth	Brand & Type
3921	BAKER LOC-SET

Plug	
Depth	Plug Type
4252	CIBP
6150	CIBP
6175	CIBP

Initial Test Data										
Test Date	Formation	Oil BBL/Day	Oil-Gravity (API)	Gas MCF/Day	Gas-Oil Ratio Cu FT/BBL	Water BBL/Day	Pumpin or Flowing	Initial Shut-In Pressure	Choke Size	Flow Tubing Pressure
There are no Initial Data records to display.										

Completion and Test Data by Producing Formation									
Formation Name: TOPEKA				Code: 406TOPK			Class: COMM DISP		
Spacing Orders				Perforated Intervals					
Order No		Unit Size		From			To		
There are no Spacing Order records to display.				3975			4002		
				4054			4090		
Acid Volumes				Fracture Treatments					
There are no Acid Volume records to display.				There are no Fracture Treatments records to display.					

Formation	Top
-----------	-----

Were open hole logs run? No  
Date last log run:

Were unusual drilling circumstances encountered? No  
Explanation:

Other Remarks
UIC ORDER NUMBER 547483

FOR COMMISSION USE ONLY	
Status: Accepted	1139060

# RECEIVED

Form 1002A  
Rev. 2009

API NO. **3513920767**  
OTC PROD.  
UNIT NO.

PLEASE TYPE OR USE BLACK INK ONLY  
NOTE:

Attach copy of original 1002A  
if recompletion or reentry.

OKLAHOMA CORPORATION COMMISSION  
Oil & Gas Conservation Division  
Post Office Box 52000  
Oklahoma City, Oklahoma 73152-2000  
Rule 165-10-25  
COMMISSION

*Mailed  
2-26-18*

☐ ORIGINAL  
☒ AMENDED (Reason)

Well Repair Raised Packer

COMPLETION REPORT

TYPE OF DRILLING OPERATION

☒ STRAIGHT HOLE ☐ DIRECTIONAL HOLE ☐ HORIZONTAL HOLE  
☒ SERVICE WELL

If directional or horizontal, see reverse for bottom hole location.

COUNTY	TEXAS	SEC	31	TWP	04N	RGE	15E	DATE OF WELL COMPLETION	8-14-75
LEASE NAME	BONRAY A SWD			WELL NO.	1-D			DATE OF WELL COMPLETION	9-1-75
ELEVATION	3122	Ground	3113	FSL OF 1/4 SEC	1320	FWL OF 1/4 SEC	1320	RECOMP DATE	2-26-18
Derrick FL				Latitude (if known)	36.76583			Longitude (if known)	-101.4791
OPERATOR NAME	BKEP SERVICES LLC			OTC/OCC OPERATOR NO.	22860				
ADDRESS	6060 S AMERICAN PLAZA ST E, STE 600								
CITY	TULSA			STATE	OK		ZIP	74135-4347	

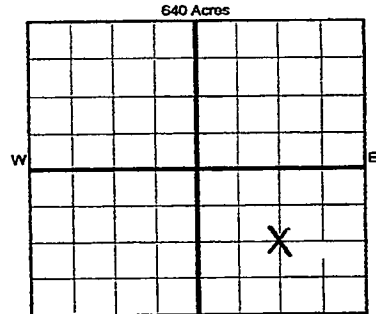

LOCATE WELL

COMPLETION TYPE

<input checked="" type="checkbox"/> SINGLE ZONE
<input type="checkbox"/> MULTIPLE ZONE
<input type="checkbox"/> COMMINGLED
<input type="checkbox"/> LOCATION
<input type="checkbox"/> EXCEPTION ORDER
<input type="checkbox"/> INCREASED DENSITY
<input type="checkbox"/> ORDER NO.

CASING & CEMENT (Form 1002C must be attached)

TYPE	SIZE	WEIGHT	GRADE	FEET	PSI	SAX	TOP OF CMT
CONDUCTOR							
SURFACE	8 5/8"	24#		1633	1000		SURFACE
INTERMEDIATE							
PRODUCTION	5 1/2"	14#		5798	1000	80	3510
LINER							

PACKER @ 3,921 BRAND & TYPE Baker Loc-Se PLUG @ 4252 TYPE CIBP PLUG @ 6150 TYPE CIBP TOTAL DEPTH 5798  
PACKER @ BRAND & TYPE PLUG @ TYPE PLUG @ 6175 TYPE CIBP 6785

COMPLETION & TEST DATA BY PRODUCING FORMATION

FORMATION	TOPEKA						
SPACING & SPACING ORDER NUMBER							
CLASS: Oil, Gas, Dry, Inj, Disp, Comm Disp, Svc	COMM DISP						
PERFORATED INTERVALS	3975'-4002'						
	4054'-4090'						
ACID/VOLUME							
FRACTURE TREATMENT (Fluids/Prop Amounts)							

Min Gas Allowable (165-10-17-7)

Gas Purchaser/Measurer  
First Sales Date

Oil Allowable (165-10-13-3)

INITIAL TEST DATA

INITIAL TEST DATE							
OIL-BBL/DAY							
OIL-GRAVITY (API)							
GAS-MCF/DAY							
GAS-OIL RATIO CU FT/BBL							
WATER-BBL/DAY							
PUMPING OR FLOWING							
INITIAL SHUT-IN PRESSURE							
CHOKE SIZE							
FLOW TUBING PRESSURE							

A record of the formations drilled through, and pertinent remarks are presented on the reverse. I declare that I have knowledge of the contents of this report and am authorized by my organization to make this report, which was prepared by me or under my supervision and direction, with the data and facts stated herein to be true, correct, and complete to the best of my knowledge and belief.

SIGNATURE *Tercio Manguez* NAME (PRINT OR TYPE) *Tercio Manguez* DATE *2-26-18* PHONE NUMBER *806-934-5803*  
ADDRESS *P.O. Box 1356* CITY *Dumas* STATE *TX* ZIP *79029* EMAIL ADDRESS *T.Manguez@BKEP.Com*

Give formation names and tops, if available, or descriptions and thickness of formations drilled through. Show intervals cored or drillstem tested.

NAMES OF FORMATIONS		TOP

## 2) Reject Codes

Were unusual drilling circumstances encountered? \_\_\_\_\_ yes \_\_\_\_\_ no  
If yes, briefly explain below

WIC ORDER 547483

[illegible]

**640 Acres**

A blank 10x10 grid for graphing. The grid is composed of 10 columns and 10 rows of squares. A thick vertical line runs down the center, separating the first five columns from the last five columns. A thick horizontal line runs across the middle, separating the first five rows from the last five rows. The grid is used for plotting the graph of the function  $y = \frac{1}{2}x^2$ .

SEC	TWP	RGE	COUNTY
Spot Location		Feet From 1/4 Sec Lines	FSL
1/4	1/4	1/4	1/4
Measured Total Depth	True Vertical Depth	BHL From Lease, Unit, or Property Line:	

LATERAL #1							
SEC	TWP	RGE	COUNTY				
Spot Location					Feet From 1/4 Sec Lines	FSL	FWL
1/4		1/4		1/4			
Depth of Deviation		Radius of Turn		Direction		Total Length	
Measured Total Depth		True Vertical Depth		BHL From Lease, Unit, or Property Line:			

LATERAL #2						
SEC	TWP	RGE	COUNTY			
Spot Location				Feet From 1/4 Sec Lines	FSL	FWL
1/4		1/4	1/4			
Depth of Deviation		Radius of Turn	Direction		Total Length	
Measured Total Depth		True Vertical Depth	BHL From Lease, Unit, or Property Line:			

LATERAL #3						
SEC		TWP		RGE		COUNTY
Spot Location				Feet From 1/4 Sec Lines		FSL
1/4		1/4		1/4		FWL
Depth of Deviation		Radius of Turn		Direction		Total Length
Measured Total Depth		True Vertical Depth		BHL From Lease, Unit, or Property Line:		