

Oklahoma Corporation Commission
Oil & Gas Conservation Division
Post Office Box 52000
Oklahoma City, Oklahoma 73152-2000
Rule 165: 10-3-25

Form 1002A

API No.: 35103247680000

Completion Report

Spud Date: February 17, 2020

OTC Prod. Unit No.: 103-226853-0-0000

Drilling Finished Date: March 09, 2020

1st Prod Date: August 03, 2020

Completion Date: February 01, 2021

Drill Type: HORIZONTAL HOLE

Min Gas Allowable: Yes

Well Name: GLEASON 2-31-30XH

Purchaser/Measurer: ETC TEXAS PIPELINE LTD

Location: NOBLE 6 20N 1W
SE NW NW NW
600 FNL 555 FWL of 1/4 SEC
Latitude: 36.244414 Longitude: -97.351761
Derrick Elevation: 1128 Ground Elevation: 1111

First Sales Date: 08/08/2020

Operator: CHARTER OAK PRODUCTION CO LLC 21672

13929 QUAIL POINTE DR
OKLAHOMA CITY, OK 73134-1037

Completion Type		Location Exception		Increased Density	
X	Single Zone	Order No		Order No	
	Multiple Zone	714585		707512	
	Commingled				

Casing and Cement							
Type	Size	Weight	Grade	Feet	PSI	SAX	Top of CMT
CONDUCTOR	2-			-9			SURFACE
SURFACE	10 3/4	40	J-55	340		235	SURFACE
INTERMEDIATE	7 5/8	29.7 & 26.4	P-110	5087		425	3900
PRODUCTION	5 1/2 & 4 1/2	20 & 13.5	P-110	12025		1010	3654

Liner								
Type	Size	Weight	Grade	Length	PSI	SAX	Top Depth	Bottom Depth
There are no Liner records to display.								

Total Depth: 12033

Packer	
Depth	Brand & Type
There are no Packer records to display.	

Plug	
Depth	Plug Type
There are no Plug records to display.	

Initial Test Data

Test Date	Formation	Oil BBL/Day	Oil-Gravity (API)	Gas MCF/Day	Gas-Oil Ratio Cu FT/BBL	Water BBL/Day	Pumpin or Flowing	Initial Shut-In Pressure	Choke Size	Flow Tubing Pressure
Feb 01, 2021	BIG LIME	140	42.1	247	1764	799	PUMPING	1688	35/64	

Completion and Test Data by Producing Formation

Formation Name: BIG LIME

Code: 404BGLM

Class: OIL

Spacing Orders

Order No	Unit Size
692851	480

Perforated Intervals

From	To
5170	12011

Acid Volumes

420,000 GALLONS 20% HCL

Fracture Treatments

155,770 BARRELS SLICK WATER, 708,970 POUNDS 40/70 SAND, 1,823,430 POUNDS 30/50 SAND

Formation	Top
BIG LIME	5010

Were open hole logs run? No
Date last log run:

Were unusual drilling circumstances encountered? No
Explanation:

Other Remarks
OCC - SPACING ORDER 692851 CREATED AN IRREGULAR 480 ACRE HORIZONTAL UNIT COMPRISING OF SW/4 SECTION 30 AND W/2 SECTION 31-21N-1W.

Lateral Holes
Sec: 30 TWP: 21N RGE: 1W County: NOBLE NE SW NE SW 806 FNL 900 FEL of 1/4 SEC Depth of Deviation: 2565 Radius of Turn: 1978 Direction: 358 Total Length: 6809 Measured Total Depth: 12033 True Vertical Depth: 4535 End Pt. Location From Release, Unit or Property Line: 806

FOR COMMISSION USE ONLY
Status: Accepted
1146141

OIL AND GAS CONSERVATION DIVISION
P.O. Box 52000
Oklahoma City, OK 73152-2000
405-522-0577
occcentralprocessing@occ.ok.gov



Form 1002A
Rev. 2009

API NO. 35-103-24768
OTC PROD. UNIT NO. 103-226853

☒ ORIGINAL
☐ AMENDED (Reason) _____

WELL COMPLETION REPORT
OAC 165:10-3-25 (PLEASE TYPE OR USE BLACK INK ONLY)

TYPE OF DRILLING OPERATION
☐ STRAIGHT HOLE ☐ DIRECTIONAL HOLE ☒ HORIZONTAL HOLE

SPUD DATE 2/17/20
DRLG FINISHED DATE 3/9/20
DATE OF WELL COMPLETION 2/1/21
1st PROD DATE 8/3/20
RECOMP DATE _____

COUNTY Noble SEC 06 TWP 20N RGE 01W
LEASE NAME Gleason WELL NO. 2-31-30XH
SE 1/4 NW 1/4 NW 1/4 NW 1/4 1/4 SEC 600' FNL 1/4 SEC 555'
ELEVATION Derrick FL 1128' Ground 1111' Latitude (if known) 36.244414 Longitude (if known) -97.351761
OPERATOR NAME Charter Oak Production Co., LLC OTC / OCC OPERATOR NO. 21672
ADDRESS 13929 Quail Pointe Dr.
CITY Oklahoma City STATE OK ZIP 73134

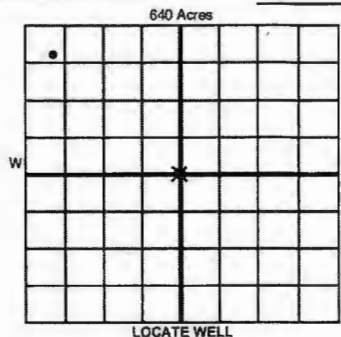

COMPLETION TYPE
☒ SINGLE ZONE
☐ MULTIPLE ZONE
☐ COMMINGLED
LOCATION EXCEPTION ORDER NO. 706957 714585 FO
INCREASED DENSITY ORDER NO. 707512 ID

TYPE	SIZE	WEIGHT	GRADE	FEET	PSI	SAX	TOP OF CMT
CONDUCTOR	20"			80'			Surface
SURFACE	10 3/4"	40#	J-55	340'		235	Surface
INTERMEDIATE	7 5/8"	28.7# & 28.4#	P-110	5087'		425	3900'
PRODUCTION	5 1/2 4 1/2"	20# 13.5#	P-110	12,025'		1010	3654'
LINER							

PACKER @ _____ BRAND & TYPE _____ PLUG @ _____ TYPE _____ PLUG @ _____ TYPE _____
PACKER @ _____ BRAND & TYPE _____ PLUG @ _____ TYPE _____ PLUG @ _____ TYPE _____

TOTAL DEPTH 12,060'

12,033 Per survey
+ BBHL
+ exhibits LE

COMPLETION & TEST DATA BY PRODUCING FORMATION

FORMATION	Big Lime					
SPACING & SPACING ORDER NUMBER	480 Ac. - 692851					
CLASS: Oil, Gas, Dry, Int, Disp, Comm Disp, Svc	Oil					
PERFORATED INTERVALS	5170' - 12,011' O.A.					
ACID/VOLUME	420,000 Gal 20% HCl					
FRACTURE TREATMENT (Fluids/Prop Amounts)	155,770 BBL slick water 708,970# 40/70 sand 1,823,430# 30/50 sand					

RECEIVED

MAR 01 2021

Oklahoma Corporation
Commission

Reported to
Frac Focus

Min Gas Allowable (165:10-17-7) Gas Purchaser/Measurer ETC Texas Pipeline, LTD
OR First Sales Date 9/8/20
Oil Allowable (165:10-13-3)

INITIAL TEST DATE	2/1/21					
OIL-BBL/DAY	140					
OIL-GRAVITY (API)	42.1					
GAS-MCF/DAY	247					
GAS-OIL RATIO CU FT/BBL	1764					
WATER-BBL/DAY	799					
PUMPING OR FLOWING	Pumping					
INITIAL SHUT-IN PRESSURE	1688 psi					
CHOKE SIZE	35/64					
FLOW TUBING PRESSURE	N/A					

A record of the formations drilled through, and pertinent remarks are presented on the reverse. I declare that I have knowledge of the contents of this report and am authorized by my organization to make this report, which was prepared by me or under my supervision and direction, with the data and facts stated herein to be true, correct, and complete to the best of my knowledge and belief.

JC Brevetti, Engineering Tech. 2/24/21 (405) 286-0361
SIGNATURE NAME (PRINT OR TYPE) DATE PHONE NUMBER
13929 Quail Pointe Dr. Oklahoma City OK 73134 brevetti@charteroakproduction.com
ADDRESS CITY STATE ZIP EMAIL ADDRESS

PLEASE TYPE OR USE BLACK INK ONLY
FORMATION RECORD

Give formation names and tops, if available, or descriptions and thickness of formations drilled through. Show intervals cored or drillstem tested.

NAMES OF FORMATIONS	TOP
Big Lime	5010'

LEASE NAME Gleason

WELL NO. 2-31-302N

FOR COMMISSION USE ONLY	
ITD on file	<input type="checkbox"/> YES <input type="checkbox"/> NO
APPROVED	DISAPPROVED
2) Reject Codes	

Were open hole logs run?	<input type="checkbox"/> yes <input checked="" type="checkbox"/> no
Date Last log was run	
Was CO ₂ encountered?	<input type="checkbox"/> yes <input checked="" type="checkbox"/> no at what depths?
Was H ₂ S encountered?	<input type="checkbox"/> yes <input checked="" type="checkbox"/> no at what depths?
Were unusual drilling circumstances encountered?	<input type="checkbox"/> yes <input checked="" type="checkbox"/> no
If yes, briefly explain below	

Other remarks:

OCC - spacing order 692851 created an irregular 480 acre horizontal unit comprised of SW 1/4 Sec 30 + W 1/2 Sec 31 - 41N-1W

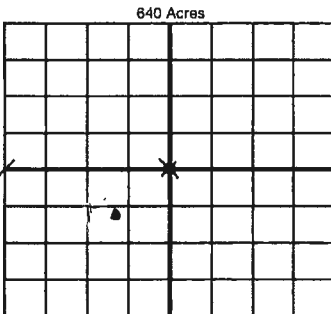

If more than three drainholes are proposed, attach a separate sheet indicating the necessary information.

Direction must be stated in degrees azimuth. Please note, the horizontal drainhole and its end point must be located within the boundaries of the lease or spacing unit.

Directional surveys are required for all drainholes and directional wells.

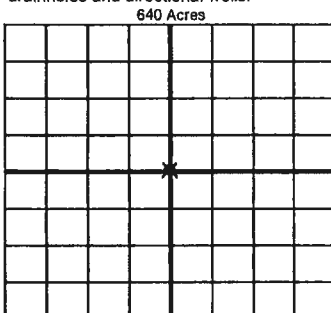

BOTTOM HOLE LOCATION FOR DIRECTIONAL HOLE

SEC	TWP	RGE	COUNTY
Spot Location			
1/4	1/4	1/4	1/4
Measured Total Depth		True Vertical Depth	BHL From Lease, Unit, or Property Line:

BOTTOM HOLE LOCATION FOR HORIZONTAL HOLE: (LATERALS)

LATERAL #1			
SEC	TWP	RGE	COUNTY
30	21N	01W	Noble
Spot Location			
SW 1/4	1/4 SW	1/4 NE	1/4 SW
Depth of Deviation		Radius of Turn	Direction
2565'		1978'	358.7°
Measured Total Depth		True Vertical Depth	BHL From Lease, Unit, or Property Line:
12,033'		4535'	794' 806'

LATERAL #2			
SEC	TWP	RGE	COUNTY
Spot Location			
1/4	1/4	1/4	1/4
Depth of Deviation		Radius of Turn	Direction
Measured Total Depth		True Vertical Depth	BHL From Lease, Unit, or Property Line:

LATERAL #3			
SEC	TWP	RGE	COUNTY
Spot Location			
1/4	1/4	1/4	1/4
Depth of Deviation		Radius of Turn	Direction
Measured Total Depth		True Vertical Depth	BHL From Lease, Unit, or Property Line: