

Oklahoma Corporation Commission
Oil & Gas Conservation Division
Post Office Box 52000
Oklahoma City, Oklahoma 73152-2000
Rule 165: 10-3-25

Form 1002A

API No.: 35011219150003

Completion Report

Spud Date: December 11, 1983

OTC Prod. Unit No.: 011-18444-3

Drilling Finished Date: January 19, 1984

Amended

1st Prod Date: March 22, 1984

Amend Reason: RECLASSIFY TO GAS / NEW INITIAL TEST DATA

Completion Date: March 19, 1984

Recomplete Date: May 02, 2019

Drill Type: STRAIGHT HOLE

Well Name: CHEYENNE ARAPAHO TRIBAL LANDS 4-6

Purchaser/Measurer:

Location: BLAINE 6 18N 13W
E2 SW NW NE
990 FNL 2080 FEL of 1/4 SEC
Derrick Elevation: 1714 Ground Elevation: 1699

First Sales Date:

Operator: TECHNICAL ENERGY SERVICES INC 18785
PO BOX 720069
6301 E CEDAR AVE
NORMAN, OK 73070-4053

Completion Type		Location Exception		Increased Density	
X	Single Zone	Order No		Order No	
	Multiple Zone	701407		There are no Increased Density records to display.	
	Commingled				

Casing and Cement							
Type	Size	Weight	Grade	Feet	PSI	SAX	Top of CMT
SURFACE	8 5/8	24	K-55	1525		825	SURFACE
PRODUCTION	4 1/2	11.6	N-80	9917		475	7794

Liner								
Type	Size	Weight	Grade	Length	PSI	SAX	Top Depth	Bottom Depth
There are no Liner records to display.								

Total Depth: 9917

Packer		Plug	
Depth	Brand & Type	Depth	Plug Type
8811	AS1-X	There are no Plug records to display.	

Initial Test Data

Test Date	Formation	Oil BBL/Day	Oil-Gravity (API)	Gas MCF/Day	Gas-Oil Ratio Cu FT/BBL	Water BBL/Day	Pumpin or Flowing	Initial Shut-In Pressure	Choke Size	Flow Tubing Pressure
Mar 19, 1984	MORROW	97		1800			FLOWING		18/64	1350
Jan 22, 2020	MISSISSIPPI	3	46.7	67	22333	2	FLOWING	1800	0	60

Completion and Test Data by Producing Formation									
Formation Name: MORROW				Code: 402MRRW			Class: TA		
Spacing Orders				Perforated Intervals					
Order No		Unit Size		From			To		
100283		80		8610			8709		
Acid Volumes				Fracture Treatments					
NONE				1,304 BARRELS LEASE CRUDE WITH 55,944 POUNDS 20/40 SAND					
Formation Name: MISSISSIPPI				Code: 351MISS			Class: GAS		
Spacing Orders				Perforated Intervals					
Order No		Unit Size		From			To		
696236		640		9640			9831		
Acid Volumes				Fracture Treatments					
1,500 GALLONS				There are no Fracture Treatments records to display.					

Formation	Top
OSWEGO	7862
PRUE	8062
SKINNER	8122
UPPER RED FORK	8210
LOWER RED FORK	8232
BIG LIME	8306
ATOKA SHALE	8390
MORROW "A"	8595
MORROW "B"	8625
MORROW "C"	8639
CHESTER	8776
MISSISSIPPI	9684

Were open hole logs run? No
Date last log run: January 21, 1984

Were unusual drilling circumstances encountered? No
Explanation:

Other Remarks
NEW TEST DATA RECLASSIFIES WELL AS GAS WELL. MISSISSIPPI PRODUCING FROM BELOW PACKER / MORROW PRODUCTION IS TEMPORARILY ABANDONED PER OPERATOR DATA.

Status: Accepted

API NO. 01121915

OTC PROD. UNIT NO. 011-18444-3

(PLEASE TYPE OR USE BLACK INK ONLY)

OKLAHOMA CORPORATION COMMISSION

Oil & Gas Conservation Division
Post Office Box 52000
Oklahoma City, Oklahoma 73152-2000
Rule 165:10-3-25

Form 1002A
Rev. 2009

☐ ORIGINAL

☒ AMENDED (Reason)

Temporarily Abandon Morrow & Produce only Mississippi

COMPLETION REPORT

TYPE OF DRILLING OPERATION

☒ STRAIGHT HOLE

☐ DIRECTIONAL HOLE

☐ HORIZONTAL HOLE

☐ SERVICE WELL

If directional or horizontal, see reverse for bottom hole location.

COUNTY Blaine

SEC 6

TWP 18N

RGE 13W

LEASE NAME Cheyenne Arapaho Tribal Lands

WELL NO. #4-6

1/4 SW 1/4 NW 1/4 NE 1/4

FSL OF 1/4 SEC

FWL OF 1/4 SEC

ELEVATION Derrick FL 1714

Ground 1699

Latitude (if known)

Longitude (if known)

OPERATOR NAME Technical Energy Services, Inc.

OTC / OCC OPERATOR NO. 18785

ADDRESS P.O. Box 720069

CITY Norman

STATE Ok.

ZIP 73070

640 Acres

W

E

LOCATE WELL

COMPLETION TYPE

☒ SINGLE ZONE

☐ MULTIPLE ZONE

☐ COMMINGLED

LOCATION EXCEPTION ORDER NO.

INCREASED DENSITY ORDER NO.

CASING & CEMENT (Attach Form 1002C)

TYPE	SIZE	WEIGHT	GRADE	FEET	PSI	SAX	TOP OF CMT
CONDUCTOR							
SURFACE	8 5/8	24	K-55	1525		825	Surface
INTERMEDIATE							
PRODUCTION	4 1/2	11.6	N-80	9917		475	7794
LINER							

PACKER @ 8811'

BRAND & TYPE

PLUG @

TYPE

PLUG @

TYPE

TOTAL DEPTH 9,917

PACKER @

BRAND & TYPE AS1-X

PLUG @

TYPE

PLUG @

TYPE

COMPLETION & TEST DATA BY PRODUCING FORMATION

FORMATION	Morrow "C"	Mississippi				
SPACING & SPACING ORDER NUMBER	100283	696236				
CLASS: Oil, Gas, Dry, Inj, Disp, Comm Disp, Svc	Oil	Gas				
PERFORATED INTERVALS	8610 - 8709	9640 - 9831				
ACID/VOLUME	None	1,500 gal.'s				
FRACTURE TREATMENT (Fluids/Prop Amounts)	1,304 bbls lease crude					
	w/ 55,944 lbs 20-40 sd					

☐ Min Gas Allowable (165:10-17-7)

OR

☐ Oil Allowable (165:10-13-3)

Gas Purchaser/Measurer

First Sales Date

INITIAL TEST DATA

INITIAL TEST DATE	3/19/1984	1/22/2020			
OIL-BBL/DAY	97	3			
OIL-GRAVITY (API)		46.7			
GAS-MCF/DAY	1,800	67			
GAS-OIL RATIO CU FT/BBL		22333:1			
WATER-BBL/DAY	trace	2 bbls load wtr.			
PUMPING OR FLOWING	flowing	flowing			
INITIAL SHUT-IN PRESSURE		1800			
CHOKE SIZE	18/64	0			
FLOW TUBING PRESSURE	1,350	60			

A record of the formations drilled through, and pertinent remarks are presented on the reverse. I declare that I have knowledge of the contents of this report and am authorized by my organization to make this report, which was prepared by me or under my supervision and direction, with the data and facts stated herein to be true, correct, and complete to the best of my knowledge and belief.

William A. Hicks

SIGNATURE

P. O. Box 720069

ADDRESS

William A. Hicks

NAME (PRINT OR TYPE)

Norman

CITY

OK

STATE

73070

ZIP

4-22-20

DATE

(405) 329-8196

PHONE NUMBER

bill@technicalenergy.com

EMAIL ADDRESS

PLEASE TYPE OR USE BLACK INK ONLY
FORMATION RECORD

Give formation names and tops, if available, or descriptions and thickness of formations drilled through. Show intervals cored or drillstem tested.

LEASE NAME Cheyenne Arapaho Tribal Lands WELL NO. #4-6

NAMES OF FORMATIONS	TOP
Mississippi	9,684
Chester	8,776
Morrow "A"	8,595
Morrow "B"	8,625
Morrow "C"	8,639
Atoka Shale	8,390
Big Lime	8,306
Lower Redfork	8,232
Upper Redfork	8,210
Skinner	8,122
Prue	8,062
Oswego	7,862

FOR COMMISSION USE ONLY

ITD on file ☐ YES ☐ NO

APPROVED _____ DISAPPROVED _____

2) Reject Codes

Were open hole logs run? _____ yes ☒ no

Date Last log was run 1/21/1984

Was CO₂ encountered? _____ yes ☒ no at what depths? _____

Was H₂S encountered? _____ yes ☒ no at what depths? _____

Were unusual drilling circumstances encountered? _____ yes ☒ no

If yes, briefly explain below

Other remarks:

640 Acres

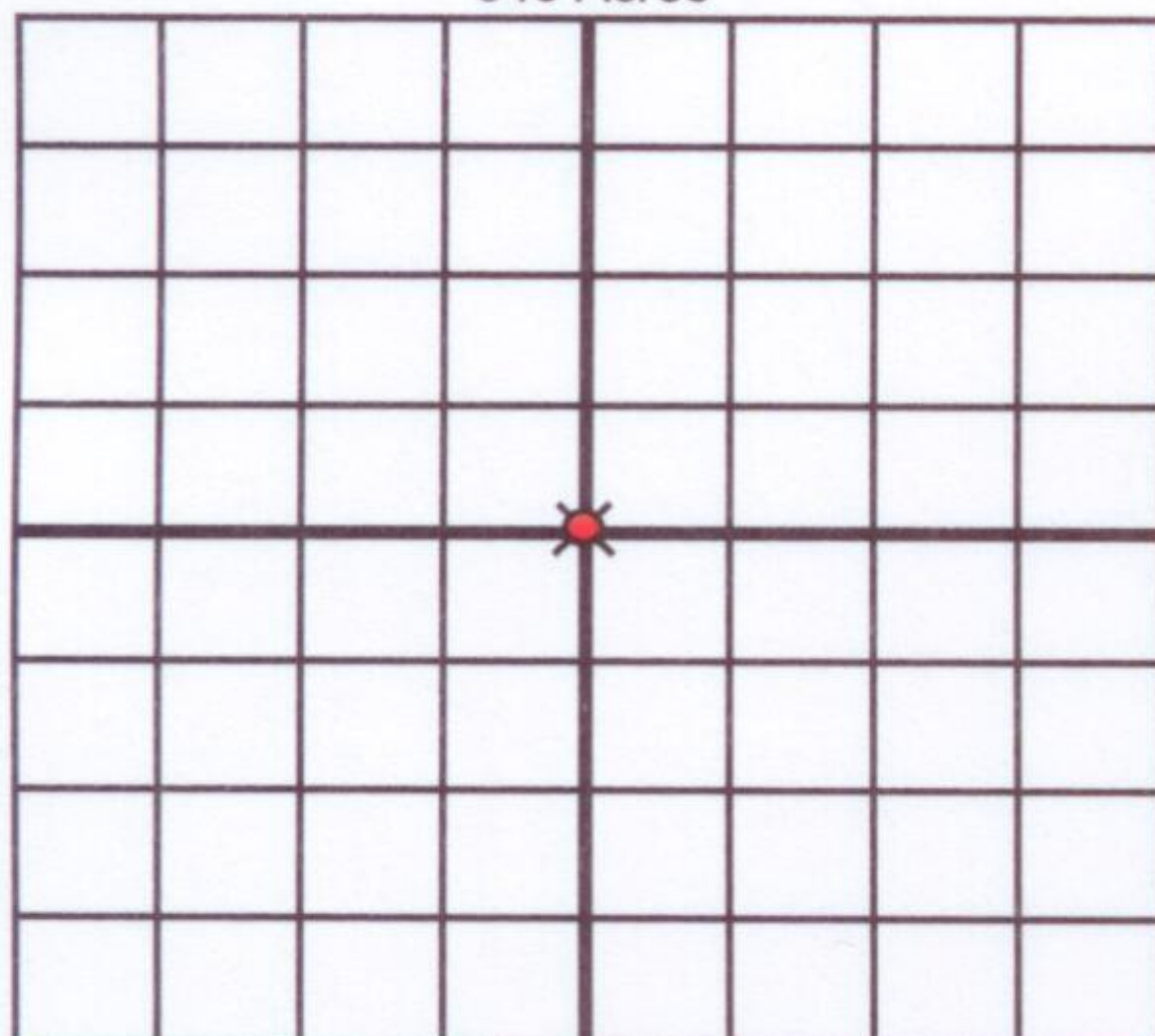

If more than three drainholes are proposed, attach a separate sheet indicating the necessary information.

Direction must be stated in degrees azimuth.
Please note, the horizontal drainhole and its end point must be located within the boundaries of the lease or spacing unit.

Directional surveys are required for all drainholes and directional wells.

640 Acres

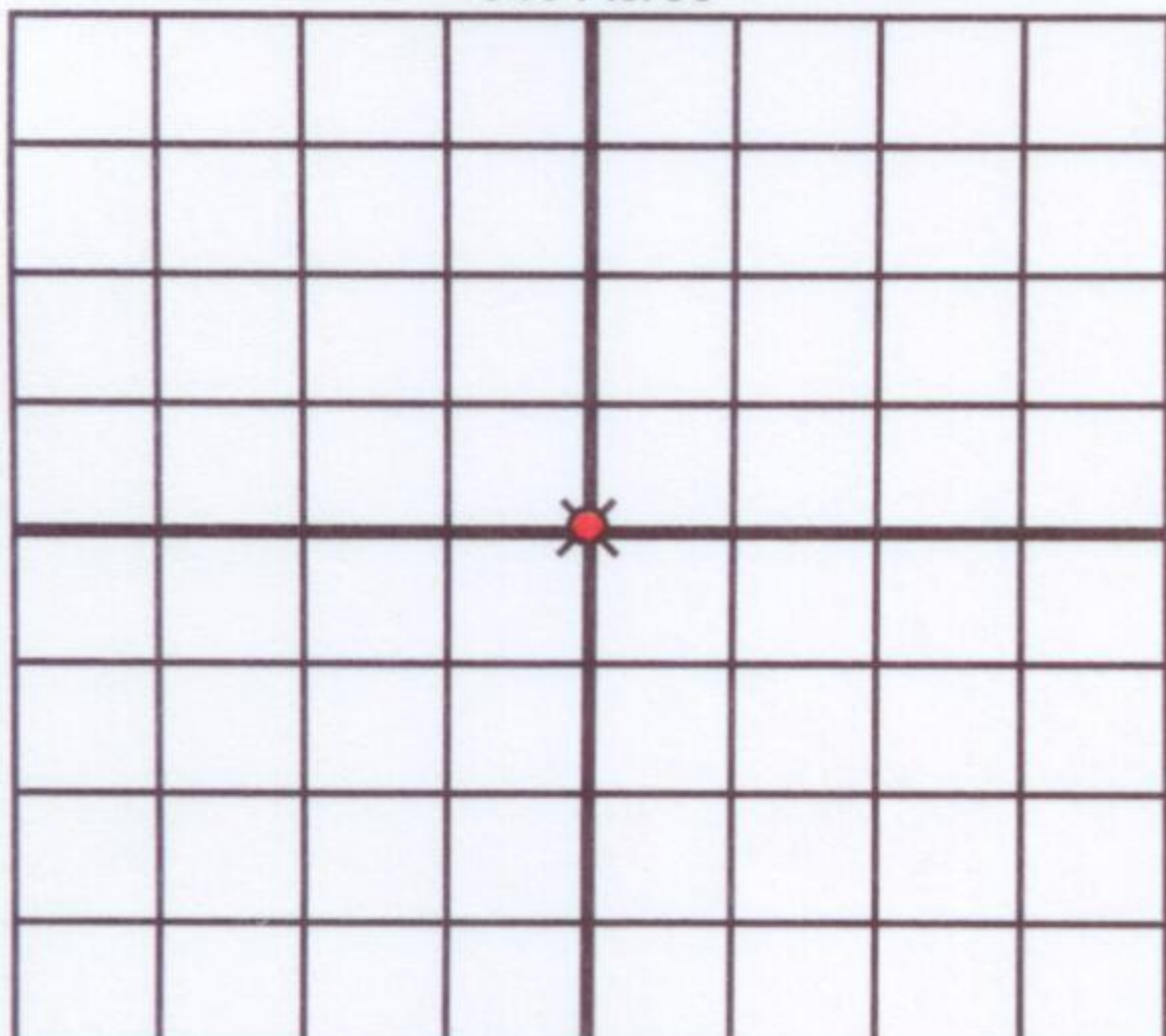

BOTTOM HOLE LOCATION FOR DIRECTIONAL HOLE

SEC	TWP	RGE	COUNTY		
Spot Location 1/4 1/4 1/4			Feet From 1/4 Sec Lines	FSL	FWL
Measured Total Depth		True Vertical Depth	BHL From Lease, Unit, or Property Line:		

BOTTOM HOLE LOCATION FOR HORIZONTAL HOLE: (LATERALS)

LATERAL #1

SEC	TWP	RGE	COUNTY		
Spot Location 1/4 1/4 1/4			Feet From 1/4 Sec Lines	FSL	FWL
Depth of Deviation		Radius of Turn	Direction	Total Length	
Measured Total Depth		True Vertical Depth	BHL From Lease, Unit, or Property Line:		

LATERAL #2

SEC	TWP	RGE	COUNTY		
Spot Location 1/4 1/4 1/4			Feet From 1/4 Sec Lines	FSL	FWL
Depth of Deviation		Radius of Turn	Direction	Total Length	
Measured Total Depth		True Vertical Depth	BHL From Lease, Unit, or Property Line:		

LATERAL #3

SEC	TWP	RGE	COUNTY		
Spot Location 1/4 1/4 1/4			Feet From 1/4 Sec Lines	FSL	FWL
Depth of Deviation		Radius of Turn	Direction	Total Length	
Measured Total Depth		True Vertical Depth	BHL From Lease, Unit, or Property Line:		

PLEASE TYPE OR USE BLACK INK ONLY
FORMATION RECORD

Give formation names and tops, if available, or descriptions and thickness of formations drilled through. Show intervals cored or drillstem tested.

NAMES OF FORMATIONS	TOP
Mississippi	9,684
Chester	8,776
Morrow "A"	8,595
Morrow "B"	8,625
Morrow "C"	8,639
Atoka Shale	8,390
Big Lime	8,306
Lower Redfork	8,232
Upper Redfork	8,210
Skinner	8,122
Prue	8,062
Oswego	7,862

LEASE NAME Cheyenne Arapaho Tribal Lands

WELL NO. #4-6

FOR COMMISSION USE ONLY	
ITD on file <input type="checkbox"/> YES <input type="checkbox"/> NO	
APPROVED _____	DISAPPROVED _____
2) Reject Codes	

Were open hole logs run?	yes <input type="checkbox"/> no <input checked="" type="checkbox"/>
Date Last log was run	<u>1/21/1984</u>
Was CO ₂ encountered?	yes <input type="checkbox"/> no <input checked="" type="checkbox"/> at what depths? _____
Was H ₂ S encountered?	yes <input type="checkbox"/> no <input checked="" type="checkbox"/> at what depths? _____
Were unusual drilling circumstances encountered?	yes <input type="checkbox"/> no <input checked="" type="checkbox"/>
If yes, briefly explain below _____	

Other remarks: _____

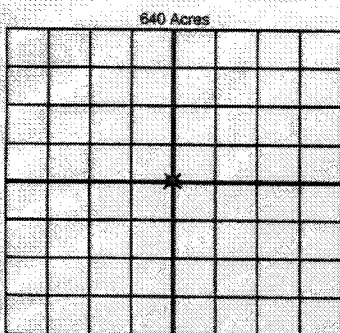

If more than three drainholes are proposed, attach a separate sheet indicating the necessary information.

Direction must be stated in degrees azimuth. Please note, the horizontal drainhole and its end point must be located within the boundaries of the lease or spacing unit.

Directional surveys are required for all drainholes and directional wells.

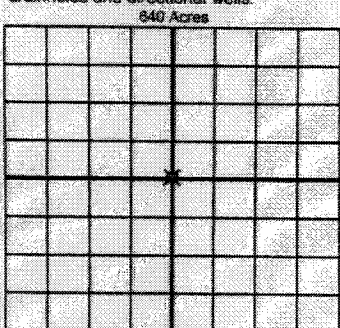

BOTTOM HOLE LOCATION FOR DIRECTIONAL HOLE

SEC	TWP	RGE	COUNTY
Spot Location			
1/4	1/4	1/4	1/4
Measured Total Depth		True Vertical Depth	BHL From Lease, Unit, or Property Line:

BOTTOM HOLE LOCATION FOR HORIZONTAL HOLE: (LATERALS)

SEC	TWP	RGE	COUNTY
Spot Location			
1/4	1/4	1/4	1/4
Measured Total Depth		True Vertical Depth	BHL From Lease, Unit, or Property Line:

LATERAL #2

SEC	TWP	RGE	COUNTY
Spot Location			
1/4	1/4	1/4	1/4
Measured Total Depth		True Vertical Depth	BHL From Lease, Unit, or Property Line:

LATERAL #3

SEC	TWP	RGE	COUNTY
Spot Location			
1/4	1/4	1/4	1/4
Measured Total Depth		True Vertical Depth	BHL From Lease, Unit, or Property Line:

API NO. 01121915
OTC PROD. UNIT NO. 011-18444-3

(PLEASE TYPE OR USE BLACK INK ONLY)

OKLAHOMA CORPORATION COMMISSION
Oil & Gas Conservation Division
Post Office Box 52000
Oklahoma City, Oklahoma 73152-2000
Rule 165:10-3-25

RECEIVED

Form 1002A
Rev. 2009

APR 03 2019

OKLAHOMA CORPORATION
COMMISSION

ORIGINAL
☒ AMENDED (Reason) Comingled Mississippi & Morrow "C"

COMPLETION REPORT

TYPE OF DRILLING OPERATION
☒ STRAIGHT HOLE ☐ DIRECTIONAL HOLE ☐ HORIZONTAL HOLE
☐ SERVICE WELL
If directional or horizontal, see reverse for bottom hole location.

SPUD DATE 12/11/1983
DRLG FINISHED DATE 01/19/1984
DATE OF WELL COMPLETION 03/19/1984
1st PROD DATE 03/22/1984
RECOMP DATE 1/1/2002
ELEVATION Derrick FL 1714 Ground 1699
Latitude (if known) Longitude (if known)
OPERATOR NAME Technical Energy Services, Inc. OTC / OCC OPERATOR NO. 18785
ADDRESS P.O. Box 720069
CITY Norman STATE Ok. ZIP 73070

640 Acres
LOCATE WELL

COMPLETION TYPE

SINGLE ZONE
MULTIPLE ZONE
Application Date
COMINGLED
Application Date See Attached
LOCATION EXCEPTION
ORDER NO.
INCREASED DENSITY
ORDER NO.

CASING & CEMENT (Attach Form 1002C)

TYPE	SIZE	WEIGHT	GRADE	FEET	PSI	SAX	TOP OF CMT
CONDUCTOR							
SURFACE	8 5/8	24	K-55	1525		825	Surface
INTERMEDIATE							
PRODUCTION	4 1/2	11.6	N-80	9917		475	7794
LINER							
TOTAL DEPTH						9,917	

PACKER @ BRAND & TYPE PLUG @ TYPE PLUG @ TYPE
PACKER @ BRAND & TYPE PLUG @ TYPE PLUG @ TYPE

COMPLETION & TEST DATA BY PRODUCING FORMATION

FORMATION	Morrow ("C")	Mississippi				
SPACING & SPACING ORDER NUMBER	100283 (80)	N/S				
CLASS: Oil, Gas, Dry, Inj, Disp, Comm Disp, Svc	Oil	Oil				
PERFORATED INTERVALS	8610 - 8709	9640 - 9831				
ACID/VOLUME	None	3,000 gal.'s				
FRACTURE TREATMENT (Fluids/Prop Amounts)	1,304 bbls lease crude w/ 55,944 lbs 20-40 sd	4950 bbls wtr				

Min Gas Allowable (165:10-17-7)

Gas Purchaser/Measurer

OR
Oil Allowable (165:10-13-3)

First Sales Date

INITIAL TEST DATA

INITIAL TEST DATE	3/19/1984	2/2/1984			
OIL-BBL/DAY	97	30			
OIL-GRAVITY (API)					
GAS-MCF/DAY	1,800	210			
GAS-OIL RATIO CU FT/BBL					
WATER-BBL/DAY	trace	50 bbls load wtr.			
PUMPING OR FLOWING	flowing	flowing			
INITIAL SHUT-IN PRESSURE					
CHOKE SIZE	18/64	14/64			
FLOW TUBING PRESSURE	1,350	350			

A record of the formations drilled through, and pertinent remarks are presented on the reverse. I declare that I have knowledge of the contents of this report and am authorized by my organization to make this report, which was prepared by me or under my supervision and direction, with the data and facts stated herein to be true, correct, and complete to the best of my knowledge and belief.

William A. Hicks

4-5-19 (405) 329-8196

PLEASE TYPE OR USE BLACK INK ONLY

FORMATION RECORD

Give formation names and tops, if available, or descriptions and thickness of formations drilled through. Show intervals cored or drillstem tested.

LEASE NAME Cheyenne Arapaho Tribal Lands

WELL NO. #4-6

NAMES OF FORMATIONS	TOP
Mississippi	9,684
Chester	8,776
Morrow "A"	8,595
Morrow "B"	8,625
Morrow "C"	8,639
Atoka Shale	8,390
Big Lime	8,306
Lower Redfork	8,232
Upper Redfork	8,210
Skinner	8,122
Prue	8,062
Oswego	7,862

*Linda Reverse
the order of
these Tops
Li*

Other remarks:

FOR COMMISSION USE ONLY

ITD on file ☐ YES ☐ NO

APPROVED _____ DISAPPROVED _____

2) Reject Codes _____

Were open hole logs run? ____ yes X no

Date Last log was run 1/21/1984

was CO₂ encountered? ____ yes X no at what depths? _____

was H₂S encountered? ____ yes X no at what depths? _____

Were unusual drilling circumstances encountered? ____ yes X no

If yes, briefly explain below _____

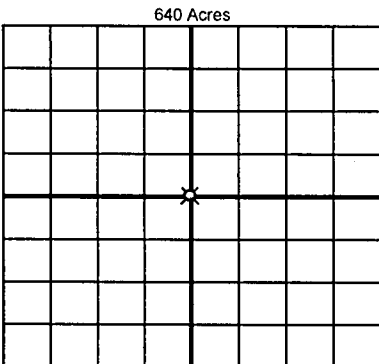

If more than three drainholes are proposed, attach a separate sheet indicating the necessary information.

Direction must be stated in degrees azimuth. Please note, the horizontal drainhole and its end point must be located within the boundaries of the lease or spacing unit.

Directional surveys are required for all drainholes and directional wells.

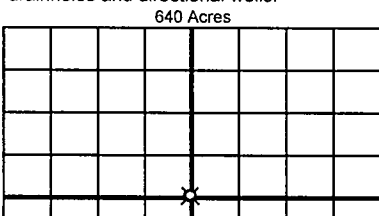

BOTTOM HOLE LOCATION FOR DIRECTIONAL HOLE

SEC	TWP	RGE	COUNTY
Spot Location		Feet From 1/4 Sec Lines	
1/4	1/4	1/4	1/4
Measured Total Depth		True Vertical Depth	
		BHL From Lease, Unit, or Property Line:	

BOTTOM HOLE LOCATION FOR HORIZONTAL HOLE: (LATERALS)

LATERAL #1

SEC	TWP	RGE	COUNTY
Spot Location		Feet From 1/4 Sec Lines	
1/4	1/4	1/4	1/4
Depth of Deviation		Radius of Turn	Direction
		Total Length	
Measured Total Depth		True Vertical Depth	
		BHL From Lease, Unit, or Property Line:	

LATERAL #2

SEC	TWP	RGE	COUNTY
Spot Location		Feet From 1/4 Sec Lines	
1/4	1/4	1/4	1/4
Depth of Deviation		Radius of Turn	Direction
		Total Length	
Measured Total Depth		True Vertical Depth	
		BHL From Lease, Unit, or Property Line:	

LATERAL #3

SEC	TWP	RGE	COUNTY
Spot Location		Feet From 1/4 Sec Lines	
1/4	1/4	1/4	1/4