

Oklahoma Corporation Commission  
Oil & Gas Conservation Division  
Post Office Box 52000  
Oklahoma City, Oklahoma 73152-2000  
Rule 165: 10-3-25

Form 1002A

API No.: 35011240020000

**Completion Report**

Spud Date: July 12, 2018

OTC Prod. Unit No.:

Drilling Finished Date: July 12, 2018

1st Prod Date:

Completion Date: December 10, 2021

**Drill Type: STRAIGHT HOLE**

Well Name: BLACKBIRD 3-14H

Purchaser/Measurer:

Location: BLAINE 11 16N 11W  
SE SE SW SW  
234 FSL 1315 FWL of 1/4 SEC  
Latitude: 35.870677181 Longitude: -98.343842258  
Derrick Elevation: 1601 Ground Elevation: 1576

First Sales Date:

Operator: BRICKTOWN ENERGY LLC 24520

3030 NW EXPRESSWAY STE 900  
OKLAHOMA CITY, OK 73112-5468

Completion Type		Location Exception		Increased Density	
	Single Zone	Order No		Order No	
	Multiple Zone	There are no Location Exception records to display.		There are no Increased Density records to display.	
	Commingled				

Casing and Cement							
Type	Size	Weight	Grade	Feet	PSI	SAX	Top of CMT
CONDUCTOR	20			0			SURFACE
SURFACE	13.375			1477	870		SURFACE

Liner								
Type	Size	Weight	Grade	Length	PSI	SAX	Top Depth	Bottom Depth
There are no Liner records to display.								

**Total Depth: 1486**

Packer	
Depth	Brand & Type
There are no Packer records to display.	

Plug	
Depth	Plug Type
There are no Plug records to display.	

Initial Test Data										
Test Date	Formation	Oil BBL/Day	Oil-Gravity (API)	Gas MCF/Day	Gas-Oil Ratio Cu FT/BBL	Water BBL/Day	Pumpin or Flowing	Initial Shut-In Pressure	Choke Size	Flow Tubing Pressure
There are no Initial Data records to display.										

**Completion and Test Data by Producing Formation**

Formation Name: NONE

Code: 999NONE

Class: PLUG AND ABANDON

Formation	Top
NONE	0

Were open hole logs run? No

Date last log run:

Were unusual drilling circumstances encountered? No

Explanation:

**Other Remarks**

SURFACE WAS DRILLED AND SET BY ECHO E & P (23925) IN 2018. BRICKTOWN ENERGY (24520) TOOK OVER OPERATIONS IN OCTOBER, 2020. DRILLING NEVER FINISHED BY ECHO E & P. BRICKTOWN ENERGY PLUGGED SURFACE HOLE DECEMBER, 2021.

**FOR COMMISSION USE ONLY**

1147488

Status: Accepted

RECEIVED

API NO. 35-011-24002  
OTC PROD.  
UNIT NO.

Oil and Gas Conservation Division  
P.O. Box 52000  
Oklahoma City, OK 73152-2000  
405-521-2331  
OCCentralProcessing@OCC.OK.GOV



**OKLAHOMA**  
Corporation  
Commission

JAN 26 2022

Form 1002A  
Rev. 2021

☒ ORIGINAL  
☐ AMENDED (Reason) \_\_\_\_\_

Rule 165:10-3-25  
COMPLETION REPORT

OKLAHOMA CORPORATION  
COMMISSION

TYPE OF DRILLING OPERATION

☒ STRAIGHT HOLE ☐ DIRECTIONAL HOLE ☐ HORIZONTAL HOLE  
☐ SERVICE WELL

If directional or horizontal, see reverse for bottom hole location.

COUNTY Blaine SEC 11 TWP 16N RGE 11W

LEASE NAME Blackbird

WELL NO. 3-14H

SPUD DATE 7/12/2018

DRLG FINISHED DATE 7/12/2018

DATE OF WELL COMPLETION 12-10-2021

1st PROD DATE

RECOMP DATE

ELEVATION 1601 Ground 1576

Latitude 35.870677181° N

Longitude -98.343842258° W

OPERATOR NAME BRICKTOWN ENERGY

OTC/OCC OPERATOR NO. 24520

ADDRESS 3030 NW Expressway #900

CITY OKC

STATE OK

ZIP 73112-5468

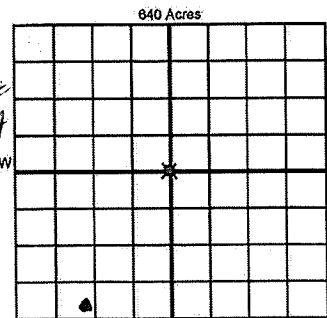

COMPLETION TYPE

☐ SINGLE ZONE  
☐ MULTIPLE ZONE  
☐ COMMINGLED  
☐ LOCATION EXCEPTION  
ORDER NO.  
MULTIUNIT ORDER NO.  
INCREASED DENSITY  
ORDER NO.

CASING & CEMENT (Attach Form 1002C)

TYPE	SIZE	WEIGHT	GRADE	FEET	PSI	SAX	TOP OF CMT
CONDUCTOR	20						Surface
SURFACE	13.375	NA	NA	1477	870		Surface
INTERMEDIATE							
PRODUCTION							
LINER							

PACKER @ \_\_\_\_\_ BRAND & TYPE \_\_\_\_\_ PLUG @ \_\_\_\_\_ TYPE \_\_\_\_\_ PLUG @ \_\_\_\_\_ TYPE \_\_\_\_\_  
PACKER @ \_\_\_\_\_ BRAND & TYPE \_\_\_\_\_ PLUG @ \_\_\_\_\_ TYPE \_\_\_\_\_ PLUG @ \_\_\_\_\_ TYPE \_\_\_\_\_

TOTAL DEPTH 1486

COMPLETION & TEST DATA BY PRODUCING FORMATION

FORMATION						
SPACING & SPACING ORDER NUMBER	673566					
CLASS: Oil, Gas, Dry, Inj, Disp, Comm Disp, Svc	Dry P+ A					
PERFORATED INTERVALS	None					
ACID/VOLUME						
FRACTURE TREATMENT (Fluids/Prop Amounts)	None					

Min Gas Allowable (165:10-17-7)

OR

Oil Allowable (165:10-13-3)

Purchaser/Measurer

First Sales Date

INITIAL TEST DATA

INITIAL TEST DATE	NA					
OIL-BBL/DAY						
OIL-GRAVITY (API)						
GAS-MCF/DAY						
GAS-OIL RATIO CU FT/88L						
WATER-BBL/DAY						
PUMPING OR FLOWING						
INITIAL SHUT-IN PRESSURE						
CHOKE SIZE						
FLOW TUBING PRESSURE						

A record of the formations drilled through, and pertinent remarks are presented on the reverse. I declare that I have knowledge of the contents of this report and am authorized by my organization to make this report, which was prepared by me or under my supervision and direction, with the data and facts stated herein to be true, correct, and complete to the best of my knowledge and belief.

*Kevin R Fischer*  
SIGNATURE

Kevin R Fischer

NAME (PRINT OR TYPE)

1/26/2022

405-208-8667

DATE

PHONE NUMBER

3030 NW Expressway #900

OKC

OK

73112

kfisher@rbluff.com

ADDRESS

CITY

STATE

ZIP

EMAIL ADDRESS

## FORMATION RECORD

LEASE NAME Blackbird WELL NO. 2-14H

Drilled through. Show intervals cored or Grinlstein tested.	
NAMES OF FORMATIONS	TOP

FOR COMMISSION USE ONLY	
ITD on file	<input type="checkbox"/> YES <input type="checkbox"/> NO
APPROVED	DISAPPROVED
2) Reject Codes	

Were open hole logs run? ☐ yes ☒ no

Date Last log was run \_\_\_\_\_

Was CO<sub>2</sub> encountered? ☐ yes ☒ no at what depths? \_\_\_\_\_

Was H<sub>2</sub>S encountered? ☐ yes ☒ no at what depths? \_\_\_\_\_

Were unusual drilling circumstances encountered? ☐ yes ☒ no

If yes, briefly explain below

Other remarks: Surface was drilled and set by Echo E&P (23925) in 2018. Bricktown Energy (24520) took over operations in 10/2020. Drilling never finished by Echo E&P. Bricktown Energy plugged surface hole 12/2021.

640 Acres

**Directional surveys are required for all drainholes and directional wells**

SEC	TWP	RGE	COUNTY			
1/4	1/4	1/4	1/4	Feet From 1/4 Sec Lines		
Measured Total Depth		True Vertical Depth		BHL From Lease, Unit, or Property Line:		

LATERAL #1						
SEC	TWP	RGE	COUNTY			
1/4	1/4	1/4	1/4	Feet From 1/4 Sec Lines		
Depth of Deviation		Radius of Turn	Direction	Total Length		
Measured Total Depth		True Vertical Depth	BHL From Lease, Unit, or Property Line:			

LATERAL #2					
SEC	TWP	RGE	COUNTY		
1/4		1/4	1/4	1/4	Feet From 1/4 Sec Lines
Depth of Deviation		Radius of Turn	Direction		Total Length
Measured Total Depth		True Vertical Depth	BHL From Lease, Unit, or Property Line:		

LATERAL #3						
SEC	TWP	RGE	COUNTY			
1/4		1/4		1/4		1/4
Depth of Deviation				Feet From 1/4 Sec Lines		
Measured Total Depth		Radius of Turn		Direction		Total Length
		True Vertical Depth		BHL From Lease, Unit, or Property Line:		