

Oklahoma Corporation Commission
Oil & Gas Conservation Division
Post Office Box 52000
Oklahoma City, Oklahoma 73152-2000
Rule 165: 10-3-25

Form 1002A

API No.: 35093252610000

Completion Report

Spud Date: November 05, 2021

OTC Prod. Unit No.: 093-227570-0-0000

Drilling Finished Date: November 11, 2021

1st Prod Date: December 29, 2021

Completion Date: December 15, 2021

Drill Type: STRAIGHT HOLE

Min Gas Allowable: Yes

Well Name: CHEVAL 4-3

Purchaser/Measurer: ENERGY TRANSFER
(SUNOCO)

First Sales Date:

Location: MAJOR 33 22N 14W
NW NW SW SW
1269 FSL 200 FWL of 1/4 SEC
Latitude: 36.3365 Longitude: -98.71063
Derrick Elevation: 0 Ground Elevation: 1435

Operator: KIRKPATRICK OIL COMPANY INC 19792

1001 W WILSHIRE BLVD STE 202
OKLAHOMA CITY, OK 73116-7017

Completion Type		Location Exception		Increased Density	
X	Single Zone	Order No		Order No	
	Multiple Zone	There are no Location Exception records to display.		There are no Increased Density records to display.	
	Commingled				

Casing and Cement							
Type	Size	Weight	Grade	Feet	PSI	SAX	Top of CMT
SURFACE	9 5/8	36	J-55	628		250	SURFACE
PRODUCTION	5 1/2	17	N-80	7042		210	6020

Liner								
Type	Size	Weight	Grade	Length	PSI	SAX	Top Depth	Bottom Depth
There are no Liner records to display.								

Total Depth: 7040

Packer		Plug	
Depth	Brand & Type	Depth	Plug Type
There are no Packer records to display.		There are no Plug records to display.	

Initial Test Data

Test Date	Formation	Oil BBL/Day	Oil-Gravity (API)	Gas MCF/Day	Gas-Oil Ratio Cu FT/BBL	Water BBL/Day	Pumpin or Flowing	Initial Shut-In Pressure	Choke Size	Flow Tubing Pressure
Dec 31, 2021	CHEROKEE SAND	5				40	PUMPING			

Completion and Test Data by Producing Formation									
Formation Name: CHEROKEE SAND				Code: 404CHRKS			Class: OIL		
Spacing Orders				Perforated Intervals					
Order No		Unit Size		From			To		
64660		UNIT		6865			6884		
Acid Volumes				Fracture Treatments					
There are no Acid Volume records to display.				2,972 BARRELS IN SLICKWATER, AND 15 POUNDS LINEAR AND BORATE X-LINKED GEL, 42,910 POUNDS 40/70 AND 112,880 POUNDS 20/40					

Formation	Top
CHEROKEE SAND	6800

Were open hole logs run? Yes

Date last log run: November 10, 2021

Were unusual drilling circumstances encountered? No

Explanation:

Other Remarks
OCC - OPERATOR SET D-V TOOL AT 5,516', USED 550 SACKS CEMENT

FOR COMMISSION USE ONLY
<div>Status: Accepted</div> <div>1147494</div>

API NO. 35-093-25261
OTC PROD. UNIT NO. 093-227570

Oil and Gas Conservation Division
P.O. Box 52000
Oklahoma City, OK 73152-2000
405-521-2331
OCCCentralProcessing@OCC.OK.GOV



OKLAHOMA
Corporation
Commission

Form 1002A
Rev. 2020

ORIGINAL
AMENDED (Reason)

Rule 165:10-3-25

COMPLETION REPORT

TYPE OF DRILLING OPERATION

☒ STRAIGHT HOLE ☐ DIRECTIONAL HOLE ☐ HORIZONTAL HOLE
☐ SERVICE WELL

If directional or horizontal, see reverse for bottom hole location.

COUNTY	Major	SEC	33	TWP	22N	RGE	14W	SPUD DATE	11/05/2021
LEASE NAME	Cheval			WELL NO.	4-3			DRLG FINISHED DATE	11/11/2021
NW 1/4 NW 1/4 SW 1/4 SW 1/4	FSL 1269 FWL 200			DATE OF WELL COMPLETION	12/15/2021				
ELEVATION	Ground	1435	Latitude	36.3365	Longitude	-98.71063			
OPERATOR NAME	Kirkpatrick Oil Company, Inc.			OTC / OCC OPERATOR NO.	19792				
ADDRESS	1001 W Wilshire Blvd, Ste 202								
CITY	Oklahoma City	STATE	OK	ZIP	73116				

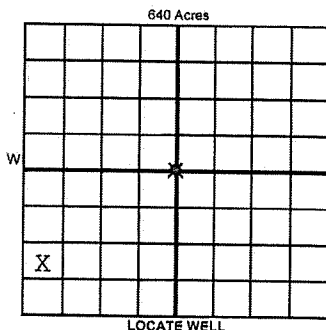

COMPLETION TYPE

<input checked="" type="radio"/> SINGLE ZONE	
<input type="radio"/> MULTIPLE ZONE	
<input type="radio"/> COMMINGLED	
LOCATION EXCEPTION ORDER NO.	
MULTIUNIT ORDER NO.	
INCREASED DENSITY ORDER NO.	

CASING & CEMENT (Attach Form 1002C)

TYPE	SIZE	WEIGHT	GRADE	FEET	PSI	SAX	TOP OF CMT
CONDUCTOR							
SURFACE	9 5/8	36	J55	628		250	Surface
INTERMEDIATE							
PRODUCTION	5 1/2	17	N80	7042		210	6020
LINER							

PACKER @ _____ BRAND & TYPE _____ PLUG @ _____ TYPE _____ PLUG @ _____ TYPE _____ TOTAL DEPTH 7040'
PACKER @ _____ BRAND & TYPE _____ PLUG @ _____ TYPE _____ PLUG @ _____ TYPE _____

COMPLETION & TEST DATA BY PRODUCING FORMATION

404 CHRS

FORMATION	Cherokee Sand					Reported to Frac Pool
SPACING & SPACING ORDER NUMBER	64660 (unit)					
CLASS: Oil, Gas, Dry, Inj, Disp, Comm Disp, Svc	Oil					
PERFORATED INTERVALS	6865'-6884'					
ACID/VOLUME						
FRACTURE TREATMENT (Fluids/Prop Amounts)	2972 bbls in slick water & 15# linear and Borate X-linked gel 42,910 lbs 40/70 & 112,880 lbs 20/40					



Min Gas Allowable (165:10-17-7)

OR

Oil Allowable (165:10-13-3)

Purchaser/Measurer
First Sales Date

Energy Transfer (Sunoco)

INITIAL TEST DATA

INITIAL TEST DATE	12/31/21					
OIL-BBL/DAY	5					
OIL-GRAVITY (API)						
GAS-MCF/DAY	0					
GAS-OIL RATIO CU FT/BBL	0					
WATER-BBL/DAY	40					
PUMPING OR FLOWING	Pumping					
INITIAL SHUT-IN PRESSURE						
CHOKE SIZE						
FLOW TUBING PRESSURE						

A record of the formations drilled through, and pertinent remarks are presented on the reverse. I declare that I have knowledge of the contents of this report and am authorized by my organization to make this report, which was prepared by me or under my supervision and direction, with the data and facts stated herein to be true, correct, and complete to the best of my knowledge and belief.

Cindy Kyle	Cindy Kyle, President & CFO	01/13/2022	405-840-2882
1001 W Wilshire Blvd, Ste 202	Oklahoma City OK 73116	DATE	PHONE NUMBER
ADDRESS	CITY STATE ZIP	EMAIL ADDRESS	

PLEASE TYPE OR USE BLACK INK ONLY
FORMATION RECORD

Give formation names and tops, if available, or descriptions and thickness of formations drilled through. Show intervals cored or drillstem tested.

NAMES OF FORMATIONS	TOP
Cherokee Sand	6800

LEASE NAME Cheval WELL NO. 4-3

FOR COMMISSION USE ONLY	
ITD on file <input type="checkbox"/> YES <input type="checkbox"/> NO	
APPROVED _____	DISAPPROVED _____
2) Reject Codes	

Were open hole logs run?	<input checked="" type="radio"/> yes <input type="radio"/> no
Date Last log was run	<u>11/10/2021</u>
Was CO ₂ encountered?	<input type="radio"/> yes <input checked="" type="radio"/> no at what depths? _____
Was H ₂ S encountered?	<input type="radio"/> yes <input checked="" type="radio"/> no at what depths? _____
Were unusual drilling circumstances encountered? If yes, briefly explain below	<input type="radio"/> yes <input checked="" type="radio"/> no

Other remarks:

OCC - Operator set D-V tool at 5516 used 550 sacks cement

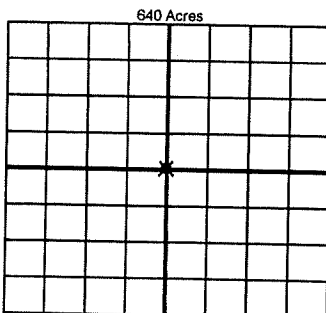

If more than three drainholes are proposed, attach a separate sheet indicating the necessary information.

Direction must be stated in degrees azimuth. Please note, the horizontal drainhole and its end point must be located within the boundaries of the lease or spacing unit.

Directional surveys are required for all drainholes and directional wells

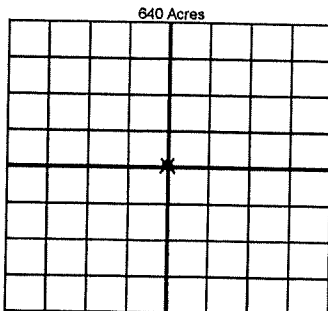

BOTTOM HOLE LOCATION FOR DIRECTIONAL HOLE

SEC	TWP	RGE	COUNTY
1/4	1/4	1/4	1/4
Measured Total Depth	True Vertical Depth	Feet From 1/4 Sec Lines	FSL FEL
BHL From Lease, Unit, or Property Line:			

BOTTOM HOLE LOCATION FOR HORIZONTAL HOLE: (LATERALS)

LATERAL #1			
SEC	TWP	RGE	COUNTY
1/4	1/4	1/4	1/4
Depth of Deviation	Radius of Turn	Direction	Total Length
Measured Total Depth	True Vertical Depth	BHL From Lease, Unit, or Property Line:	

LATERAL #2			
SEC	TWP	RGE	COUNTY
1/4	1/4	1/4	1/4
Depth of Deviation	Radius of Turn	Direction	Total Length
Measured Total Depth	True Vertical Depth	BHL From Lease, Unit, or Property Line:	

LATERAL #3			
SEC	TWP	RGE	COUNTY
1/4	1/4	1/4	1/4
Depth of Deviation	Radius of Turn	Direction	Total Length
Measured Total Depth	True Vertical Depth	BHL From Lease, Unit, or Property Line:	