

Oklahoma Corporation Commission
Oil & Gas Conservation Division
Post Office Box 52000
Oklahoma City, Oklahoma 73152-2000
Rule 165: 10-3-25

Form 1002A

API No.: 35051247630000

Completion Report

Spud Date: February 16, 2020

OTC Prod. Unit No.: 051-227111-0-0000

Drilling Finished Date: March 24, 2020

1st Prod Date: March 16, 2021

Completion Date: March 14, 2021

Drill Type: HORIZONTAL HOLE

Well Name: ANGELA 4-27X22X21X16H

Purchaser/Measurer: WEX

Location: GRADY 27 4N 6W
NE NE NE SW
2339 FSL 2376 FWL of 1/4 SEC
Latitude: 34.789526288 Longitude: -97.818189
Derrick Elevation: 0 Ground Elevation: 1236

First Sales Date: 03/16/2021

Operator: GULFPORT MIDCON LLC 24020

3001 QUAIL SPRINGS PKWY
OKLAHOMA CITY, OK 73134-2640

Completion Type	
X	Single Zone
	Multiple Zone
	Commingle

Location Exception
Order No
718632

Increased Density
Order No
707509
707883
707884

Casing and Cement							
Type	Size	Weight	Grade	Feet	PSI	SAX	Top of CMT
CONDUCTOR	30		SEAMPIPE	120			SURFACE
SURFACE	13.375	54.4	J-55	1474		1000	SURFACE
INTERMEDIATE	9.625	40	P-110HC	12381		830	7701
PRODUCTION	5.5	23	P-110EC	24868		3165	8668

Liner								
Type	Size	Weight	Grade	Length	PSI	SAX	Top Depth	Bottom Depth
There are no Liner records to display.								

Total Depth: 24895

Packer	
Depth	Brand & Type
There are no Packer records to display.	

Plug	
Depth	Plug Type
There are no Plug records to display.	

Initial Test Data

Test Date	Formation	Oil BBL/Day	Oil-Gravity (API)	Gas MCF/Day	Gas-Oil Ratio Cu FT/BBL	Water BBL/Day	Pumpin or Flowing	Initial Shut-In Pressure	Choke Size	Flow Tubing Pressure
Apr 13, 2021	WOODFORD	145	59	23185	159897	3482	FLOWING		36	

Completion and Test Data by Producing Formation

Formation Name: WOODFORD

Code: 319WDFD

Class: GAS

Spacing Orders

Order No	Unit Size
204660	640
389619	640
391535	640
652814	640
653228	640 NPT
718629	MULTIUNIT

Perforated Intervals

From	To
14990	24774

Acid Volumes

1,716 BARRELS ACID

Fracture Treatments

549,484 BARRELS FLUID, 27,090,490 POUNDS PROPPANT

Formation	Top
WOODFORD	14746

Were open hole logs run? No

Date last log run:

Were unusual drilling circumstances encountered? No

Explanation:

Other Remarks

There are no Other Remarks.

Lateral Holes

Sec: 16 TWP: 4N RGE: 6W County: GRADY

NW NW SW SE

1013 FSL 2437 FEL of 1/4 SEC

Depth of Deviation: 14000 Radius of Turn: 531 Direction: 327 Total Length: 10364

Measured Total Depth: 24895 True Vertical Depth: 15465 End Pt. Location From Release, Unit or Property Line: 1013

FOR COMMISSION USE ONLY

1147490

Status: Accepted

RECEIVED

JAN 21 2022

API NO. 35-051-24763
 OTC PROD. UNIT NO. 05122711100000

Oil and Gas Conservation Division
 P.O. Box 52000
 Oklahoma City, OK 73152-2000
 405-521-2331
 OCCCentralProcessing@OCC.OK.GOV



Form 1002A
 OKLAHOMA CORPORATION
 COMMISSION

☒ ORIGINAL
☐ AMENDED (Reason) _____

Rule 165:10-3-25

COMPLETION REPORT

TYPE OF DRILLING OPERATION

☐ STRAIGHT HOLE ☐ DIRECTIONAL HOLE ☒ HORIZONTAL HOLE
☐ SERVICE WELL

If directional or horizontal, see reverse for bottom hole location.

COUNTY Grady SEC 27 TWP 04N RGE 06W
 LEASE NAME ANGELA (4-27X22X21X16)
 NE 1/4 NE 1/4 NE 1/4 SW 1/4 FSL 2339 FWL 2376
 ELEVATION Ground 1236 Latitude 34.78956288 Longitude -97.81818900
 OPERATOR NAME GULFPORT MIDCON LLC OTC / OCC OPERATOR NO. 24020
 ADDRESS 3001 QUAIL SPRINGS PARKWAY
 CITY OKLAHOMA CITY STATE OK ZIP 73134

SPUD DATE 2/16/2020
 DRLG FINISHED DATE 3/24/2020
 DATE OF WELL COMPLETION 3/14/2021
 1st PROD DATE 3/16/2021
 RECOMP DATE

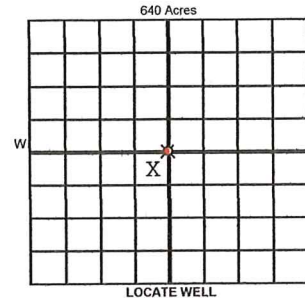

COMPLETION TYPE

☒ SINGLE ZONE
☐ MULTIPLE ZONE
☐ COMMINGLED
 LOCATION EXCEPTION ORDER NO. 718632 FO
 MULTIUNIT ORDER NO. 718629 FO
 INCREASED DENSITY ORDER NO. 707509/707883/707884

CASING & CEMENT (Attach Form 1002C)

TYPE	SIZE	WEIGHT	GRADE	FEET	PSI	SAX	TOP OF CMT
CONDUCTOR	30		SEAMPIPE	120			SURFACE
SURFACE	13.375	54.4LBS	J55	1,474		1000	SURFACE
INTERMEDIATE	9.625	40LBS	P110HC	12,381		830	7701
PRODUCTION	5.5	23LBS	P110EC	24868		3165	8668
LINER							

PACKER @ _____ BRAND & TYPE _____ PLUG @ _____ TYPE _____ PLUG @ _____ TYPE _____ TOTAL DEPTH 24895
 PACKER @ _____ BRAND & TYPE _____ PLUG @ _____ TYPE _____ PLUG @ _____ TYPE _____

COMPLETION & TEST DATA BY PRODUCING FORMATION

FORMATION	Woodford	Woodford	Woodford	Woodford	Reported to Frac Focus
SPACING & SPACING ORDER NUMBER	652814 (640)	389619 (640)	391535 (640)	204660 (640)	
CLASS: Oil, Gas, Dry, Inj, Disp, Comm Disp, Svc	Gas	Gas	Gas	Gas	
PERFORATED INTERVALS	14,990-24774				
ACID/VOLUME	1,716bbl Acid				
FRACTURE TREATMENT (Fluids/Prop Amounts)	549,484bbl Fluid 27,090,490lbs Proppant				

Min Gas Allowable (165:10-17-7)

OR

Oil Allowable (165:10-13-3)

Purchaser/Measurer

First Sales Date

WEX

3/16/2021

INITIAL TEST DATA

INITIAL TEST DATE	4/13/2021				
OIL-BBL/DAY	145				
OIL-GRAVITY (API)	59				
GAS-MCF/DAY	23185				
GAS-OIL RATIO CU FT/BBL	159897				
WATER-BBL/DAY	3482				
PUMPING OR FLOWING	Flowing				
INITIAL SHUT-IN PRESSURE					
CHOKE SIZE	36				
FLOW TUBING PRESSURE	N/A				

A record of the formations drilled through, and pertinent remarks are presented on the reverse. I declare that I have knowledge of the contents of this report and am authorized by my organization to make this report, which was prepared by me or under my supervision and direction, with the data and facts stated herein to be true, correct, and complete to the best of my knowledge and belief.

SIGNATURE Monica Pickens 1/20/2022 4052524703
 NAME (PRINT OR TYPE) DATE PHONE NUMBER
 3001 Quail Springs Parkway Oklahoma City OK 73134 mpickens@gulfportenergy.com
 ADDRESS CITY STATE ZIP EMAIL ADDRESS

PLEASE TYPE OR USE BLACK INK ONLY
FORMATION RECORD

Give formation names and tops, if available, or descriptions and thickness of formations drilled through. Show intervals cored or drillstem tested.

LEASE NAME Angela

WELL NO. 4-27X22X21X16H

NAMES OF FORMATIONS	TOP
Wooford	14746

FOR COMMISSION USE ONLY	
ITD on file <input type="checkbox"/> YES <input type="checkbox"/> NO	
APPROVED <input type="checkbox"/> DISAPPROVED <input type="checkbox"/>	2) Reject Codes
<div></div> <div></div> <div></div> <div></div>	

Were open hole logs run?	<input type="radio"/> yes <input checked="" type="radio"/> no
Date Last log was run	
Was CO ₂ encountered?	<input type="radio"/> yes <input checked="" type="radio"/> no at what depths? <div></div>
Was H ₂ S encountered?	<input type="radio"/> yes <input checked="" type="radio"/> no at what depths? <div></div>
Were unusual drilling circumstances encountered?	<input type="radio"/> yes <input checked="" type="radio"/> no
If yes, briefly explain below	

Other remarks:

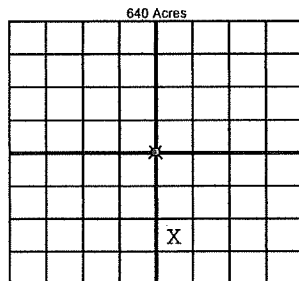

If more than three drainholes are proposed, attach a separate sheet indicating the necessary information.

Direction must be stated in degrees azimuth. Please note, the horizontal drainhole and its end point must be located within the boundaries of the lease or spacing unit.

Directional surveys are required for all drainholes and directional wells

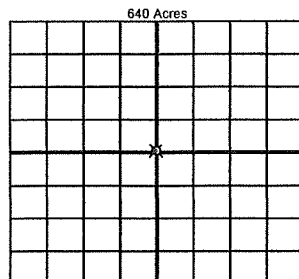

BOTTOM HOLE LOCATION FOR DIRECTIONAL HOLE

SEC	TWP	RGE	COUNTY
1/4		1/4	1/4
Measured Total Depth		True Vertical Depth	Feet From 1/4 Sec Lines BHL From Lease, Unit, or Property Line:

BOTTOM HOLE LOCATION FOR HORIZONTAL HOLE: (LATERALS)

LATERAL #1			
SEC	TWP	RGE	COUNTY
16	04N	06W	Grady
NW 1/4 NW 1/4 SW 1/4 SE 1/4		Feet From 1/4 Sec Lines FSL 1013 FEL 2437	
Depth of Deviation 14865		Radius of Turn 531	Direction 327
Measured Total Depth 24895		True Vertical Depth 15465	Total Length 10364
		BHL From Lease, Unit, or Property Line: 1013	

LATERAL #2			
SEC	TWP	RGE	COUNTY
1/4		1/4	1/4
Depth of Deviation		Radius of Turn	Direction
Measured Total Depth		True Vertical Depth	Total Length
		BHL From Lease, Unit, or Property Line:	

LATERAL #3			
SEC	TWP	RGE	COUNTY
1/4		1/4	1/4
Depth of Deviation		Radius of Turn	Direction
Measured Total Depth		True Vertical Depth	Total Length
		BHL From Lease, Unit, or Property Line:	

2/1/22

Oklahoma Corporation Commission
Oil & Gas Conservation Division
Post Office Box 52000
Oklahoma City, Oklahoma 73152-2000
Rule 165: 10-3-25

Form 1002A

1002A
Addendum

API No.: 35051247630000

Completion Report

Spud Date: February 16, 2020

OTC Prod. Unit No.: 051-227111-0-0000

Drilling Finished Date: March 24, 2020

1st Prod Date: March 16, 2021

Completion Date: March 14, 2021

Drill Type: HORIZONTAL HOLE

Well Name: ANGELA 4-27X22X21X16H

Purchaser/Measurer: WEX

Location: GRADY 27 4N 6W
NE NE NE SW
2339 FSL 2376 FWL of 1/4 SEC
Latitude: 34.789526288 Longitude: -97.818189
Derrick Elevation: 0 Ground Elevation: 1236

First Sales Date: 03/16/2021

Operator: GULFPORT MIDCON LLC 24020

3001 QUAIL SPRINGS PKWY
OKLAHOMA CITY, OK 73134-2640

Multiunit:

Sec. 27: 26% 227111 I
Sec. 22: 26% 227111A I
Sec. 21: 37% 227111B I
Sec. 16: 11% 227111C I

Completion Type	
X	Single Zone
	Multiple Zone
	Commingled

Location Exception	
Order No	
718632	

Increased Density	
Order No	
707509	
707883	
707884	

MUFO 718629
SA 710954 (Sec. 27)
SA 710953 (Sec. 22)
SA 710036 (Sec. 21)
SA 710035 (Sec. 16)

Casing and Cement							
Type	Size	Weight	Grade	Feet	PSI	SAX	Top of CMT
CONDUCTOR	30		SEAMPIPE	120			SURFACE
SURFACE	13.375	54.4	J-55	1474		1000	SURFACE
INTERMEDIATE	9.625	40	P-110HC	12381		830	7701
PRODUCTION	5.5	23	P-110EC	24868		3165	8668

Liner								
Type	Size	Weight	Grade	Length	PSI	SAX	Top Depth	Bottom Depth
There are no Liner records to display.								

Total Depth: 24895

Packer	
Depth	Brand & Type
There are no Packer records to display.	

Plug	
Depth	Plug Type
There are no Plug records to display.	

Initial Test Data

January 28, 2022

Rec'd. 1/21/22

4/13/24

319WDFD

1 x MT-shale

1 of 2