

Oklahoma Corporation Commission
Oil & Gas Conservation Division
Post Office Box 52000
Oklahoma City, Oklahoma 73152-2000
Rule 165: 10-3-25

Form 1002A

API No.: 35137143220001

Completion Report

Spud Date: December 14, 1925

OTC Prod. Unit No.: 137-107760-0-0000

Drilling Finished Date: April 14, 1926

Amended

1st Prod Date:

Amend Reason: RE-ACTIVATED WELL

Completion Date: April 14, 1926

Recomplete Date: May 19, 2018

Drill Type: STRAIGHT HOLE

Well Name: FRANKLIN WIRT WEST 26

Purchaser/Measurer:

Location: STEPHENS 34 1S 5W
C SW SW SE
330 FSL 330 FWL of 1/4 SEC
Latitude: 34.333942 Longitude: -97.85656
Derrick Elevation: 0 Ground Elevation: 1143

First Sales Date:

Operator: CITATION OIL & GAS CORPORATION 14156

14077 CUTTEN RD
HOUSTON, TX 77069-2212

Completion Type		Location Exception		Increased Density	
X	Single Zone	Order No		Order No	
	Multiple Zone	There are no Location Exception records to display.		There are no Increased Density records to display.	
	Commingled				

Casing and Cement							
Type	Size	Weight	Grade	Feet	PSI	SAX	Top of CMT
SURFACE	12.5			39			
PRODUCTION	8.25			1559		150	1400

Liner								
Type	Size	Weight	Grade	Length	PSI	SAX	Top Depth	Bottom Depth
There are no Liner records to display.								

Total Depth: 2730

Packer		Plug	
Depth	Brand & Type	Depth	Plug Type
There are no Packer records to display.		1468	CIBP

Initial Test Data

Test Date	Formation	Oil BBL/Day	Oil-Gravity (API)	Gas MCF/Day	Gas-Oil Ratio Cu FT/BBL	Water BBL/Day	Pumpin or Flowing	Initial Shut-In Pressure	Choke Size	Flow Tubing Pressure
May 21, 2018	PERMIAN	3	27			87	PUMPING			

Completion and Test Data by Producing Formation									
Formation Name: PERMIAN				Code: 459PRMN			Class: OIL		
Spacing Orders				Perforated Intervals					
Order No		Unit Size		From			To		
There are no Spacing Order records to display.				331			738		
Acid Volumes				Fracture Treatments					
N/A				N/A					

Formation	Top
PERMIAN	331

Were open hole logs run? No

Date last log run:

Were unusual drilling circumstances encountered? No

Explanation:

Other Remarks
THE FRANKLIN WIRT WEST 26 (AKA WIRT FRANKLIN 26) WAS RECOMPLETED TO THE PERMIAN IN MAY OF 1988. A CIBP WAS SET AT 1,468' WITH 2 SACKS OF CEMENT ON TOP. PBTD @ 2,730'. WELL WAS RE-ACTIVATED IN MAY OF 2018 AND IS CURRENTLY PRODUCING.

FOR COMMISSION USE ONLY
<div>Status: Accepted</div> <div>1145088</div>

API NO. 3513714322
OTC PROD. UNIT NO. 137-107760

(PLEASE TYPE OR USE BLACK INK ONLY)

OKLAHOMA CORPORATION COMMISSION
Oil & Gas Conservation Division
Post Office Box 52000
Oklahoma City, Oklahoma 73152-2000
Rule 165:10-3-25

Form 1002A
Rev. 2009

☐ ORIGINAL
☒ AMENDED (Reason) Reactivated Well

COMPLETION REPORT

TYPE OF DRILLING OPERATION

☒ STRAIGHT HOLE ☐ DIRECTIONAL HOLE ☐ HORIZONTAL HOLE
☐ SERVICE WELL

If directional or horizontal, see reverse for bottom hole location.

COUNTY	Stephens	SEC	34	TWP	01S	RGE	05W
LEASE NAME	Franklin Wirt West			WELL NO.	26		
C	1/4 SW	1/4 SW	1/4 SE	1/4	FSL OF 1/4 SEC	330	FWL OF 1/4 SEC 330
ELEVATION Derrick FL	Ground 1143			Latitude (if known)	34.333942		
OPERATOR NAME	Citation Oil & Gas Corp.			OTC / OCC OPERATOR NO.	14156		
ADDRESS	14077 Cutten Rd						
CITY	Houston			STATE	Texas		ZIP
							77069-2212

SPUD DATE 12/14/1925

DRLG FINISHED DATE 4/14/1926

DATE OF WELL COMPLETION 4/14/1926

1st PROD DATE NA

RECOMP DATE 5/19/2018

Longitude (if known) -97.85656

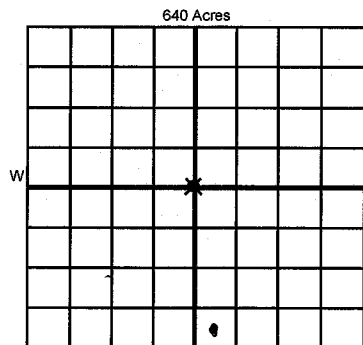

COMPLETION TYPE

<input checked="" type="checkbox"/>	SINGLE ZONE	PERMIAN
<input type="checkbox"/>	MULTIPLE ZONE	
	Application Date	
<input type="checkbox"/>	COMMINGLED	
	Application Date	
<input type="checkbox"/>	LOCATION EXCEPTION	
	ORDER NO.	
<input type="checkbox"/>	INCREASED DENSITY	
	ORDER NO.	

CASING & CEMENT (Attach Form 1002C)

TYPE	SIZE	WEIGHT	GRADE	FEET	PSI	SAX	TOP OF CMT
CONDUCTOR							
SURFACE	12.5	NA	NA	39	NA	NA	NA
INTERMEDIATE							
PRODUCTION	8.25	NA	NA	1559	NA	150	1400
LINER							
TOTAL DEPTH							2730

PACKER @ NA BRAND & TYPE PLUG @ 1468 TYPE CIBP PLUG @ TYPE
PACKER @ BRAND & TYPE PLUG @ TYPE PLUG @ TYPE

COMPLETION & TEST DATA BY PRODUCING FORMATION

FORMATION	Permian					
SPACING & SPACING ORDER NUMBER						
CLASS: Oil, Gas, Dry, Inj, Disp, Comm Disp, Svc	OIL					
PERFORATED INTERVALS	331-738					
ACID/VOLUME	NA					
FRACTURE TREATMENT (Fluids/Prop Amounts)	NA					

RECEIVED
APR 2 2020
Oklahoma Corporation
Commission

☐ Min Gas Allowable (165:10-17-7)
OR
☐ Oil Allowable (165:10-13-3)

Gas Purchaser/Measurer
First Sales Date

INITIAL TEST DATA

INITIAL TEST DATE	5/21/2018					
OIL-BBL/DAY	3					
OIL-GRAVITY (API)	27					
GAS-MCF/DAY	0					
GAS-OIL RATIO CU FT/BBL	NA					
WATER-BBL/DAY	87					
PUMPING OR FLOWING	PUMPING					
INITIAL SHUT-IN PRESSURE	NA					
CHOKE SIZE	NA					
FLOW TUBING PRESSURE	NA					

A record of the formations drilled through, and pertinent remarks are presented on the reverse. I declare that I have knowledge of the contents of this report and am authorized by my organization to make this report, which was prepared by me or under my supervision and direction, with the data and facts stated herein to be true, correct, and complete to the best of my knowledge and belief.

Sharon Ward
SIGNATURE

Sharon Ward

NAME (PRINT OR TYPE)

DATE PHONE NUMBER

14077 Cutten Rd

Houston Texas 77069

sward@cogc.com

ADDRESS

CITY

STATE

ZIP

EMAIL ADDRESS

PLEASE TYPE OR USE BLACK INK ONLY

FORMATION RECORD

Give formation names and tops, if available, or descriptions and thickness of formations drilled through. Show intervals cored or drillstem tested.

LEASE NAME FRANKLIN WIRT WEST

WELL NO. 26

NAMES OF FORMATIONS	TOP
PERMIAN	331

FOR COMMISSION USE ONLY	
ITD on file <input type="checkbox"/> YES <input type="checkbox"/> NO	
APPROVED _____	DISAPPROVED _____
2) Reject Codes	

Were open hole logs run?	_____ yes _____ no
Date Last log was run	_____
Was CO ₂ encountered?	_____ yes _____ no at what depths? _____
Was H ₂ S encountered?	_____ yes _____ no at what depths? _____
Were unusual drilling circumstances encountered?	_____ yes _____ no
If yes, briefly explain below	

Other remarks: The Franklin Wirt West 26 was recompleted to the Permian in May of 1988.

A CIBP was set at 1468' with 2 sacks of cement on top. PBTD @ 2730'.

Well was reactivated in May of 2018 and is currently producing.

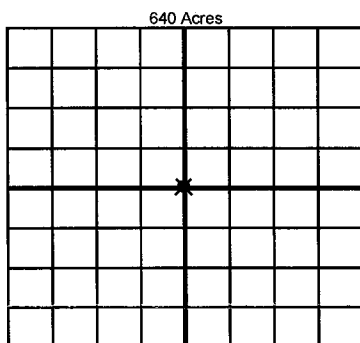

If more than three drainholes are proposed, attach a separate sheet indicating the necessary information.

Direction must be stated in degrees azimuth. Please note, the horizontal drainhole and its end point must be located within the boundaries of the lease or spacing unit.

Directional surveys are required for all drainholes and directional wells.

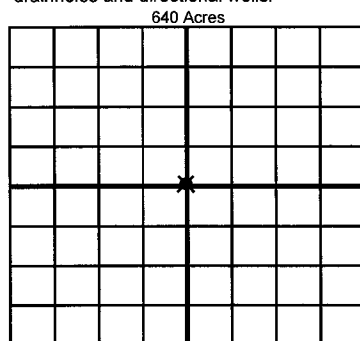

BOTTOM HOLE LOCATION FOR DIRECTIONAL HOLE

SEC	TWP	RGE	COUNTY		
Spot Location			Feet From 1/4 Sec Lines	FSL	FWL
1/4 1/4 1/4					
Measured Total Depth		True Vertical Depth	BHL From Lease, Unit, or Property Line:		

BOTTOM HOLE LOCATION FOR HORIZONTAL HOLE: (LATERALS)

LATERAL #1					
SEC	TWP	RGE	COUNTY		
Spot Location			Feet From 1/4 Sec Lines	FSL	FWL
1/4 1/4 1/4					
Depth of Deviation		Radius of Turn	Direction	Total Length	
Measured Total Depth		True Vertical Depth	BHL From Lease, Unit, or Property Line:		

LATERAL #2					
SEC	TWP	RGE	COUNTY		
Spot Location			Feet From 1/4 Sec Lines	FSL	FWL
1/4 1/4 1/4					
Depth of Deviation		Radius of Turn	Direction	Total Length	
Measured Total Depth		True Vertical Depth	BHL From Lease, Unit, or Property Line:		

LATERAL #3					
SEC	TWP	RGE	COUNTY		
Spot Location			Feet From 1/4 Sec Lines	FSL	FWL
1/4 1/4 1/4					
Depth of Deviation		Radius of Turn	Direction	Total Length	
Measured Total Depth		True Vertical Depth	BHL From Lease, Unit, or Property Line:		