

Oklahoma Corporation Commission
Oil & Gas Conservation Division
Post Office Box 52000
Oklahoma City, Oklahoma 73152-2000
Rule 165: 10-3-25

Form 1002A

API No.: 35139224740001

Completion Report

Spud Date: June 13, 1993

OTC Prod. Unit No.: 139-014918-0-0000

Drilling Finished Date: June 23, 1993

Amended

1st Prod Date: July 29, 1993

Amend Reason: RECOMPLETION

Completion Date: July 17, 1993

Recomplete Date: September 26, 2018

Drill Type: STRAIGHT HOLE

Well Name: PUCKETT 2-R

Purchaser/Measurer:

Location: TEXAS 7 1N 16E CM
C SW
1320 FSL 1320 FWL of 1/4 SEC
Latitude: 36.5620977 Longitude: -101.3801229
Derrick Elevation: 2996 Ground Elevation: 2985

First Sales Date:

Operator: SCOUT ENERGY MANAGEMENT LLC 23138

4901 LBJ FWY STE 300
DALLAS, TX 75244-6107

Completion Type		Location Exception		Increased Density	
X	Single Zone	Order No		Order No	
	Multiple Zone	There are no Location Exception records to display.		There are no Increased Density records to display.	
	Commingled				

Casing and Cement							
Type	Size	Weight	Grade	Feet	PSI	SAX	Top of CMT
CONDUCTOR	20			53			
SURFACE	8.625	24	J-55	1499		750	SURFACE
PRODUCTION	5.5	17	J-55	6812		225	5350

Liner								
Type	Size	Weight	Grade	Length	PSI	SAX	Top Depth	Bottom Depth
There are no Liner records to display.								

Total Depth: 6820

Packer		Plug	
Depth	Brand & Type	Depth	Plug Type
5715	PACKER	6271	COMPOSITE

Initial Test Data

Test Date	Formation	Oil BBL/Day	Oil-Gravity (API)	Gas MCF/Day	Gas-Oil Ratio Cu FT/BBL	Water BBL/Day	Pumpin or Flowing	Initial Shut-In Pressure	Choke Size	Flow Tubing Pressure
Sep 30, 2018	OSWEGO			2221			FLOWING	1800		

Completion and Test Data by Producing Formation

Formation Name: MORROW

Code: 402MRRW

Class: DRY

Spacing Orders

Order No	Unit Size
58465	640

Perforated Intervals

From	To
6296	6312

Acid Volumes

There are no Acid Volume records to display.

Fracture Treatments

There are no Fracture Treatments records to display.

Formation Name: OSWEGO

Code: 404OSWG

Class: GAS

Spacing Orders

Order No	Unit Size
There are no Spacing Order records to display.	

Perforated Intervals

From	To
5765	5783

Acid Volumes

1,000 GALLONS 15% HCL

Fracture Treatments

40,000 POUNDS 16/30 SAND, 70Q 20 POUNDS XL @ 40 BPM

Formation	Top
BASE STONE CORRAL	1518
RED CAVE	1619
ANHYDRITE MARKER	2381
HERINGTON	2564
KRIDER	2690
WINFIELD	2770
FT. RILEY	2867
COUNCIL GROVE	2967
COTTONWOOD	3131
NEVA	3210
DOUGLAS MARKER	4305
OSWEGO	5731
THIRTEEN FINGER	6136
MORROW SHALE	6242
UPPER MORROW	6295

Were open hole logs run? No

Date last log run: June 22, 1993

Were unusual drilling circumstances encountered? No

Explanation:

Other Remarks

There are no Other Remarks.

FOR COMMISSION USE ONLY

1141072

Status: Accepted

API NO. 35-139-22474
OTC PROD. UNIT NO. 139-014918-0-0000

(PLEASE TYPE OR USE BLACK INK ONLY)

OKLAHOMA CORPORATION COMMISSION

Oil & Gas Conservation Division

Post Office Box 52000

Oklahoma City, Oklahoma 73152-2000

Rule 165:10-3-25

RECEIVED

OCT 11 2018

OKLAHOMA CORPORATION COMMISSION

Form 1002A

Rev. 2009

ORIGINAL
☒ AMENDED (Reason) Recompletion

TYPE OF DRILLING OPERATION

☒ STRAIGHT HOLE ☐ DIRECTIONAL HOLE ☐ HORIZONTAL HOLE
☐ SERVICE WELL

If directional or horizontal, see reverse for bottom hole location.

COUNTY Texas SEC 7 TWP 1N RGE 16ECM
LEASE NAME Puckett WELL NO. 2-R
C 1/4 SW 1/4 1/4 1/4 FSL OF 1/4 SEC 1320' FWL OF 1/4 SEC 1320'
ELEVATION 2996' KB Ground 2985' Latitude (if known) 36.5620977 Longitude (if known) -101.3801229
OPERATOR NAME Scout Energy Management LLC OTC/OCC OPERATOR NO. 23138
ADDRESS 4901 LBJ Freeway, Ste 300
CITY Dallas STATE TX ZIP 75244

SPUD DATE 06/13/1093
DRLG FINISHED DATE 06/23/1993
DATE OF WELL COMPLETION 07/17/1993
1st PROD DATE 07/29/1993
RECOMP DATE 09/26/2018

640 Acres
W E
LOCATE WELL

COMPLETION TYPE

☒ SINGLE ZONE
☐ MULTIPLE ZONE
☐ COMMINGLED
☐ LOCATION EXCEPTION
☐ ORDER NO.
☐ INCREASED DENSITY
☐ ORDER NO.

CASING & CEMENT (Form 1002C must be attached)

TYPE	SIZE	WEIGHT	GRADE	FEET	PSI	SAX	TOP OF CMT
CONDUCTOR	20			53		0	
SURFACE	8.625	24	J-55	1499'		750	Surface
INTERMEDIATE							
PRODUCTION	5.5	17	J-55	6812'		225	5350'
LINER							

PACKER @ 5715' BRAND & TYPE Composite PLUG @ 6271' TYPE Composite PLUG @ 6271' TYPE Composite
PACKER @ 5715' BRAND & TYPE Composite PLUG @ 6271' TYPE Composite PLUG @ 6271' TYPE Composite
TOTAL DEPTH 6820'

COMPLETION & TEST DATA BY PRODUCING FORMATION

FORMATION Morrow Oswego
SPACING & SPACING ORDER NUMBER 640 Acre - 58465 unspaced
CLASS: Oil, Gas, Dry, Inj. below Gas Dry Gas
Disp, Comm Disp, Svc plug 6296'-6312' 5765'-5783'
PERFORATED INTERVALS
ACID/VOLUME 1000 gal. 15% HCl
FRACTURE TREATMENT (Fluids/Prop Amounts) 40,000 lbs of 16/30 sand 70Q 20# XL @ 40 bpm

INITIAL TEST DATA

INITIAL TEST DATE 09/30/2018
OIL-BBL/DAY 0
OIL-GRAVITY (API) -
GAS-MCF/DAY 2221
GAS-OIL RATIO CU FT/BBL -
WATER-BBL/DAY 0
PUMPING OR FLOWING Flowing
INITIAL SHUT-IN PRESSURE 1800
CHOKE SIZE -
FLOW TUBING PRESSURE -

AS SUBMITTED

A record of the formations drilled through, and pertinent remarks are presented on the reverse. I declare that I have knowledge of the contents of this report and am authorized by my organization to make this report, which was prepared by me or under my supervision and direction, with the data and facts stated herein to be true, correct, and complete to the best of my knowledge and belief.

SIGNATURE Emily J. Van Der Gryp NAME (PRINT OR TYPE) Emily J. Van Der Gryp
ADDRESS 4901 LBJ Freeway, Ste 300 CITY Dallas STATE TX ZIP 75244
DATE 10/10/2018 PHONE NUMBER (972) 325-1146
EMAIL ADDRESS evandergryp@scoutep.com

Give formation names and tops, if available, or descriptions and thickness of formations drilled through. Show intervals cored or drillstem tested.

WELL NO. 2-R

FOR COMMISSION USE ONLY	
ITD on file	<input type="checkbox"/> YES <input type="checkbox"/> NO
APPROVED	DISAPPROVED
2) Reject Codes _____ _____ _____ _____ _____	

Other remarks:

If more than three drainholes are proposed, attach a separate sheet indicating the necessary information.

Direction must be stated in degrees azimuth.
Please note, the horizontal drainhole and its end
point must be located within the boundaries of the
lease or spacing unit.

Directional surveys are required for all drainholes and directional wells.

BOTTOM HOLE LOCATION FOR DIRECTIONAL HOLE

BOTTOM HOLE LOCATION FOR HORIZONTAL HOLE: (LATERALS)

LATERAL #1

LATERAL #2

LATERAL #3

SEC	TWP	RGE	COUNTY			
Spot Location						
1/4	1/4	1/4	1/4	Feet From 1/4 Sec Lines	FSL	FWL
Depth of Deviation		Radius of Turn		Direction	Total Length	
Measured Total Depth		True Vertical Depth		BHL From Lease, Unit, or Property Line:		

9/26/18

RECEIVED

Form 1002A
Rev. 2009

API NO. 35-139-22474
OTC PROD. UNIT NO. 139-014918A

(PLEASE TYPE OR USE BLACK INK ONLY)

OKLAHOMA CORPORATION COMMISSION
Oil & Gas Conservation Division
Post Office Box 52000
Oklahoma City, Oklahoma 73152-2000
Rule 165:10-3-25

OCT 11 2018

OKLAHOMA CORPORATION COMMISSION

1016EZ

☒ ORIGINAL
☒ AMENDED (Reason)

Recompletion

COMPLETION REPORT

TYPE OF DRILLING OPERATION

☒ STRAIGHT HOLE ☐ DIRECTIONAL HOLE ☐ HORIZONTAL HOLE
☐ SERVICE WELL

If directional or horizontal, see reverse for bottom hole location.

COUNTY Texas SEC 7 TWP 1N RGE 16ECM

LEASE NAME Puckett

C 1/4 SW 1/4 1/4 1/4 FSL OF 1/4 SEC 1320' FWL OF 1/4 SEC 1320'

ELEVATION 2996' KB Ground 2985'

Latitude (if known) 36.5620977

Longitude (if known) -101.3801229

OPERATOR NAME Scout Energy Management LLC

OTC/OCC OPERATOR NO. 23138

ADDRESS 4901 LBJ Freeway, Ste 300

CITY Dallas

STATE TX

ZIP 75244

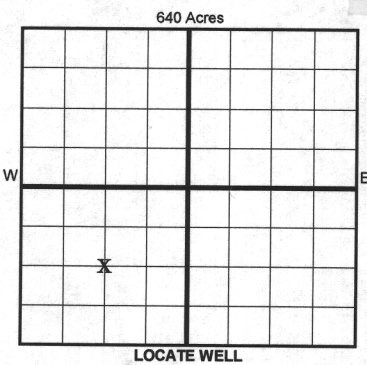

LOCATE WELL

COMPLETION TYPE

☒ SINGLE ZONE
☐ MULTIPLE ZONE
Application Date
☐ COMMINGLED
Application Date
LOCATION EXCEPTION
ORDER NO.
INCREASED DENSITY
ORDER NO.

CASING & CEMENT (Form 1002C must be attached)

TYPE	SIZE	WEIGHT	GRADE	FEET	PSI	SAX	TOP OF CMT
CONDUCTOR	20			53		0	
SURFACE	8.625	24	J-55	1499'		750	Surface
INTERMEDIATE							
PRODUCTION	5.5	17	J-55	6812'		225	5350'
LINER							

PACKER @ 5715' BRAND & TYPE

PLUG @ 6271' TYPE Composite

PLUG @ TYPE

TOTAL DEPTH 6820'

COMPLETION & TEST DATA BY PRODUCING FORMATION

FORMATION	SPACING & SPACING ORDER NUMBER	CLASS: Oil, Gas, Dry, Inj, Disp, Comm Disp, Svc	PERFORATED INTERVALS	ACID/VOLUME	FRACTURE TREATMENT (Fluids/Prop Amounts)
Morrow	640 Acre - 58465	below prod Gas Dry	6296' - 6312'	1000 gal. 15% HCl	40,000 lbs of 16/30 sand 70Q 20# XL @ 40 bpm
Oswego	unspaced	Gas	5765' - 5783'		

PBTD: 6271'

Reported to FracFocus

INITIAL TEST DATA

INITIAL TEST DATE	09/30/2018
OIL-BBL/DAY	0
OIL-GRAVITY (API)	-
GAS-MCF/DAY	2221
GAS-OIL RATIO CU FT/BBL	-
WATER-BBL/DAY	0
PUMPING OR FLOWING	Flowing
INITIAL SHUT-IN PRESSURE	1800
CHOKE SIZE	-
FLOW TUBING PRESSURE	-

AS SUBMITTED

A record of the formations drilled through, and pertinent remarks are presented on the reverse. I declare that I have knowledge of the contents of this report and am authorized by my organization to make this report, which was prepared by me or under my supervision and direction, with the data and facts stated herein to be true, correct, and complete to the best of my knowledge and belief.

Signature of Emily J. Van Der Gryp

Emily J. Van Der Gryp

10/10/2018 (972) 325-1146

4901 LBJ Freeway, Ste 300

Dallas

TX

75244

evandergryp@scoutep.com

EL

DR

SCANNED