

Oklahoma Corporation Commission
Oil & Gas Conservation Division
Post Office Box 52000
Oklahoma City, Oklahoma 73152-2000
Rule 165: 10-3-25

Form 1002A

API No.: 35109221230002

Completion Report

Spud Date: April 03, 2021

OTC Prod. Unit No.:

Drilling Finished Date: April 11, 2021

1st Prod Date: May 13, 2021

Completion Date: May 04, 2021

Amended

Amend Reason: SIDETRACK WELL SET NEW 5 1/2" CASING / COMPLETE NEW WELLBORE

Drill Type: DIRECTIONAL HOLE

Min Gas Allowable: Yes

Well Name: OKC SOUTH WILCOX UNIT 11-4

Purchaser/Measurer:

Location: OKLAHOMA 35 11N 3W
SW NE NE NE
2209 FSL 1983 FWL of 1/4 SEC
Derrick Elevation: 1288 Ground Elevation: 1270

First Sales Date:

Operator: STEPHENS & JOHNSON OPERATING CO 19113
PO BOX 2249
811 6TH ST STE 300
WICHITA FALLS, TX 76307-2249

Completion Type		Location Exception		Increased Density	
X	Single Zone	Order No		Order No	
	Multiple Zone	There are no Location Exception records to display.		There are no Increased Density records to display.	
	Commingle				

Casing and Cement							
Type	Size	Weight	Grade	Feet	PSI	SAX	Top of CMT
CONDUCTOR	16	40	J-55	45		5	SURFACE
SURFACE	8 5/8	24	J-55	1177		630	SURFACE
PRODUCTION	5 1/2	17	J-55	7020		1100	SURFACE

Liner								
Type	Size	Weight	Grade	Length	PSI	SAX	Top Depth	Bottom Depth
There are no Liner records to display.								

Total Depth: 7025

Packer	
Depth	Brand & Type
There are no Packer records to display.	

Plug	
Depth	Plug Type
There are no Plug records to display.	

Initial Test Data

Test Date	Formation	Oil BBL/Day	Oil-Gravity (API)	Gas MCF/Day	Gas-Oil Ratio Cu FT/BBL	Water BBL/Day	Pumpin or Flowing	Initial Shut-In Pressure	Choke Size	Flow Tubing Pressure
May 21, 2021	WILCOX	20	40			270	PUMPING	50	N/A	

Completion and Test Data by Producing Formation

Formation Name: WILCOX

Code: 202WLCX

Class: OIL

Spacing Orders

Order No	Unit Size
30116	UNIT
30775	UNIT

Perforated Intervals

From	To
6526	6542

Acid Volumes

750 GALLONS 7.5%

Fracture Treatments

20,000 POUNDS 20/40 SAND IN 14,532 GALLONS KCL WATER

Formation	Top
OSWEGO	6320
PRUE SAND	6380
WILCOX SAND	6526
TULIP CREEK	6656
MCLISH	6756

Were open hole logs run? Yes

Date last log run: March 08, 2014

Were unusual drilling circumstances encountered? No

Explanation:

Other Remarks

ORIGINALLY DRILLED IN 2002. SET CIBP @ 6,500' WITH 3 SACKS CEMENT. TESTED CASING TO 500 PSI, CUT 5 1/2" CASING @ 1,618' AND PULLED. SET 250 SACKS CEMENT PLUG TO KICK WELL OFF. RU DIRECTIONAL TOOLS AND KICKED WELL OFF @ 1,277'. DIRECTIONALLY DRILLED WELL TO BOTTOM HOLE LOCATION 289.15' NORTH AND 387.96' EAST OF SURFACE LOCATION. WILCOX SAND TOP IS 285' NORTH AND 356' EAST OF SURFACE LOCATION. CEMENTED CASING WITH 350 SACKS ON FIRST STAGE WITH DV TOOL SET @ 4,848', CEMENTED SECOND STAGE WITH 750 SACKS. CEMENT CIRCULATED

Bottom Holes

Sec: 35 TWP: 11N RGE: 3W County: OKLAHOMA

NW NE NE NE

2498 FSL 2370 FWL of 1/4 SEC

Depth of Deviation: 0 Radius of Turn: 0 Direction: 0 Total Length: 0

Measured Total Depth: 7025 True Vertical Depth: 6998 End Pt. Location From Release, Unit or Property Line: 2370

FOR COMMISSION USE ONLY

1146607

Status: Accepted

API NO. 35-109-22123
OTC PROD. UNIT NO.

Oil and Gas Conservation Division
P.O. Box 52000
Oklahoma City, OK 73152-2000
405-522-0577
OCCCentralProcessing@OCC.OK.GOV



OKLAHOMA
Corporation
Commission

Form 1002A
Rev. 2020

☐ ORIGINAL
☒ AMENDED (Reason) **RECOMPLETE SAME WELLBORE** Rule 165:10-3-25
Side track well set New 5 1/2" casing COMPLETION REPORT

TYPE OF DRILLING OPERATION
☐ STRAIGHT HOLE ☒ DIRECTIONAL HOLE ☐ HORIZONTAL HOLE
☐ SERVICE WELL

If directional or horizontal, see reverse for bottom hole location.

COUNTY	OKLAHOMA	SEC	35	TWP	11N	RGE	3W	SPUD DATE	4-3/21
LEASE NAME	OKC SO WILCOX UNIT			WELL NO.	11-4	DATE OF WELL COMPLETION	5-4-21	DRLG FINISHED DATE	4-11-21
SW 1/4 NE 1/4 NE 1/4 NE 1/4	FSL	2209	PWL	1983	1st PROD DATE	5-13-21	RECOMP DATE		
ELEVATION	1288	Ground	1270	Latitude		Longitude			
OPERATOR NAME	STEPHENS & JOHNSON OPERATING CO				OTC / OCC OPERATOR NO.	19113-0			
ADDRESS	P O BOX 2249								
CITY	WICHITA FALLS			STATE	TX	ZIP	76307		

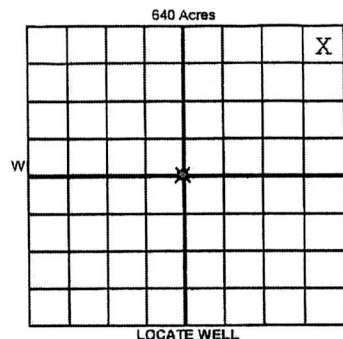

<input checked="" type="radio"/> SINGLE ZONE	
<input type="radio"/> MULTIPLE ZONE	
<input type="radio"/> Application Date	
<input type="radio"/> COMMINGLED	
<input type="radio"/> Application Date	
LOCATION EXCEPTION ORDER NO.	
MULTIUNIT ORDER NO.	
INCREASED DENSITY ORDER NO.	

CASING & CEMENT (Attach Form 1002C)							
TYPE	SIZE	WEIGHT	GRADE	FEET	PSI	SAX	TOP OF CMT
CONDUCTOR	16"	40	J-55	45'		4.75 YD	SURF
SURFACE	8 5/8"	24	J-55	1177'		630	SURF
INTERMEDIATE							
PRODUCTION	5 1/2"	17	J-55	7020'		1100	SURF
LINER							

PACKER @ _____ BRAND & TYPE _____ PLUG @ _____ TYPE _____ PLUG @ _____ TYPE _____ TOTAL DEPTH 7025
PACKER @ _____ BRAND & TYPE _____ PLUG @ _____ TYPE _____ PLUG @ _____ TYPE _____

FORMATION	WILCOX						
SPACING & SPACING ORDER NUMBER	30116 (unit) 30775 (unit)						
CLASS: Oil, Gas, Dry, Inj, Disp, Comm Disp, Svc	Oil						
	6526-42						
PERFORATED INTERVALS							
ACID/VOLUME	750 GALS 7.5%						
FRACTURE TREATMENT (Fluids/Prop Amounts)	20,000 LBS 20/40 SAND IN 14532 GALS KCL WATER						

Min Gas Allowable (165:10-17-7) ☒ OR Oil Allowable (165:10-13-3) Purchaser/Mesurer First Sales Date

INITIAL TEST DATA	5/21/21						
OIL-BBL/DAY	20						
OIL-GRAVITY (API)	40						
GAS-MCF/DAY	0						
GAS-OIL RATIO CU FT/BBL	0						
WATER-BBL/DAY	270						
PUMPING OR FLOWING	PUMPING						
INITIAL SHUT-IN PRESSURE	50						
CHOKE SIZE	NA						
FLOW TUBING PRESSURE							

RECEIVED

JUN 24 2021

Oklahoma Corporation
Commission

A record of the formations drilled through, and pertinent remarks are presented on the reverse. I declare that I have knowledge of the contents of this report and am authorized by my organization to make this report, which was prepared by me or under my supervision and direction, with the data and facts stated herein to be true, correct, and complete to the best of my knowledge and belief.

SIGNATURE **BOB GILMORE** NAME (PRINT OR TYPE) **BOB GILMORE** DATE **6/11/21** PHONE NUMBER **940-723-2166**
ADDRESS **P O Box 2249** CITY **Wichita Falls** STATE **TX** ZIP **76307** EMAIL ADDRESS **bgilmore@sjoc.net**

PLEASE TYPE OR USE BLACK INK ONLY

FORMATION RECORD

Give formation names and tops, if available, or descriptions and thickness of formations drilled through. Show intervals cored or drillstem tested.

NAMES OF FORMATIONS	TOP
OSWEGO	6320
PRUE SD	6380
WILCOX SD	6526
TULIP CREEK	6656
McCLISH	6756

LEASE NAME OKC SO WILCOX UNIT

WELL NO. 11-4

FOR COMMISSION USE ONLY	
ITD on file	<input type="checkbox"/> YES <input type="checkbox"/> NO
APPROVED	DISAPPROVED
2) Reject Codes	

Were open hole logs run?	<input checked="" type="radio"/> yes <input type="radio"/> no
Date Last log was run	3-8-2014
Was CO ₂ encountered?	<input type="radio"/> yes <input checked="" type="radio"/> no at what depths?
Was H ₂ S encountered?	<input type="radio"/> yes <input checked="" type="radio"/> no at what depths?
Were unusual drilling circumstances encountered?	<input type="radio"/> yes <input checked="" type="radio"/> no
If yes, briefly explain below	

Other remarks: Originally drilled in 2002. Set CIBP @ 6500 with 3 sx cement. Tested csg to 500 psi, cut 5 1/2" csg @ 1618' and pulled. Set 250sx cement plug to kick well off. RU directional tools and kicked well off @ 1277'. Directionally drilled well to bottom hole location 289.15' north and 387.96' east of surface location. Wilcox Sd top is 285' north and 356' east of surface location. Cemented csg with 350 sx on 1st stage with DV Tool set @ 4848', cemented 2nd stage with 750 sx. Cement circ

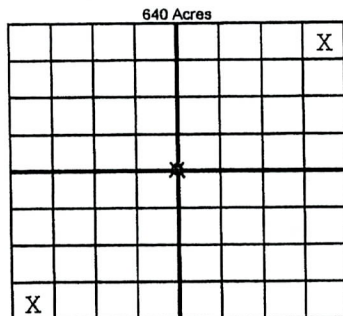

If more than three drainholes are proposed, attach a separate sheet indicating the necessary information.

Direction must be stated in degrees azimuth. Please note, the horizontal drainhole and its end point must be located within the boundaries of the lease or spacing unit.

Directional surveys are required for all drainholes and directional wells

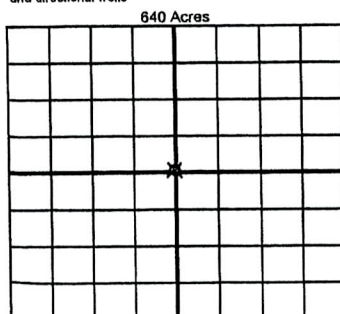

BOTTOM HOLE LOCATION FOR DIRECTIONAL HOLE

SEC 35	TWP 11N	RGE 3W	COUNTY OKLAHOMA
NW 1/4	NE 1/4	NE 1/4	NE 1/4
Measured Total Depth	7025	True Vertical Depth	6998
Feet From 1/4 Sec Lines		FSL 2498	PWL 2370
BHL From Lease, Unit, or Property Line:		2370'	

BOTTOM HOLE LOCATION FOR HORIZONTAL HOLE: (LATERALS)

LATERAL #1			
SEC	TWP	RGE	COUNTY
1/4	1/4	1/4	1/4
Feet From 1/4 Sec Lines			
Depth of Deviation	Radius of Turn	Direction	Total Length
Measured Total Depth	True Vertical Depth	BHL From Lease, Unit, or Property Line:	

LATERAL #2			
SEC	TWP	RGE	COUNTY
1/4	1/4	1/4	1/4
Feet From 1/4 Sec Lines			
Depth of Deviation	Radius of Turn	Direction	Total Length
Measured Total Depth	True Vertical Depth	BHL From Lease, Unit, or Property Line:	

LATERAL #3			
SEC	TWP	RGE	COUNTY
1/4	1/4	1/4	1/4
Feet From 1/4 Sec Lines			
Depth of Deviation	Radius of Turn	Direction	Total Length
Measured Total Depth	True Vertical Depth	BHL From Lease, Unit, or Property Line:	