

Oklahoma Corporation Commission
Oil & Gas Conservation Division
Post Office Box 52000
Oklahoma City, Oklahoma 73152-2000
Rule 165: 10-3-25

Form 1002A

API No.: 35057201210001

Completion Report

Spud Date: September 19, 2019

OTC Prod. Unit No.: 057-226485-0-0000

Drilling Finished Date: September 25, 2019

1st Prod Date: December 31, 2019

Completion Date: June 08, 2021

Drill Type: STRAIGHT HOLE

Min Gas Allowable: Yes

Well Name: SEARCEY 1-22

Purchaser/Measurer:

Location: HARMON 22 2N 24W
C S2 S2 NE
330 FSL 1320 FEL of 1/4 SEC
Latitude: 34.631264 Longitude: -99.705741
Derrick Elevation: 1548 Ground Elevation: 1533

First Sales Date: 09/06/2020

Operator: CHARTER OAK PRODUCTION CO LLC 21672

13929 QUAIL POINTE DR
OKLAHOMA CITY, OK 73134-1037

Completion Type		Location Exception		Increased Density	
X	Single Zone	Order No		Order No	
	Multiple Zone	There are no Location Exception records to display.		There are no Increased Density records to display.	
	Commingled				

Casing and Cement							
Type	Size	Weight	Grade	Feet	PSI	SAX	Top of CMT
CONDUCTOR	16			85			SURFACE
SURFACE	8 5/8	24	J-55	376		250	SURFACE
PRODUCTION	5 1/2	17 & 15.5	N-80 / K-55	7094		175	6200

Liner								
Type	Size	Weight	Grade	Length	PSI	SAX	Top Depth	Bottom Depth
There are no Liner records to display.								

Total Depth: 7100

Packer		Plug	
Depth	Brand & Type	Depth	Plug Type
There are no Packer records to display.		6940	CIBP

Initial Test Data

Test Date	Formation	Oil BBL/Day	Oil-Gravity (API)	Gas MCF/Day	Gas-Oil Ratio Cu FT/BBL	Water BBL/Day	Pumpin or Flowing	Initial Shut-In Pressure	Choke Size	Flow Tubing Pressure
Dec 31, 2019	MISSISSIPPIAN	9				18	PUMPING	4853	12/64	
Jun 08, 2021	MISSISSIPPIAN	1	40.8			10	PUMPING	2752	64/64	

Completion and Test Data by Producing Formation										
Formation Name: MISSISSIPPIAN				Code: 359MSSP				Class: OIL		
Spacing Orders				Perforated Intervals						
Order No		Unit Size		From			To			
UNSPACED		160		6950			6994			
Acid Volumes				Fracture Treatments						
4,653 BARRELS 2% KCL				87,203 POUNDS 20/40 SAND						

Formation Name: MISSISSIPPIAN		Code: 359MSSP		Class: OIL	
Spacing Orders		Perforated Intervals			
Order No	Unit Size	From	To		
UNSPACED	160	6805	6811		
		6868	6872		
Acid Volumes		Fracture Treatments			
15,000 GALLONS ACID		25,227 POUNDS 40/70 SAND, 67,052 POUNDS 30/50 SAND, 6,910 BARRELS SLICK WATER			

Formation	Top
MISSISSIPPIAN	6409

Were open hole logs run? Yes
Date last log run: September 26, 2019

Were unusual drilling circumstances encountered? No
Explanation:

Other Remarks
There are no Other Remarks.

FOR COMMISSION USE ONLY
<div>Status: Accepted</div> <div>1146606</div>

API NO. 35-057-20121
OTC PROD. UNIT NO. 057-226485

Oil and Gas Conservation Division
P.O. Box 52000
Oklahoma City, OK 73152-2000
405-522-0577
OCCCentralProcessing@OCC.OK.GOV



OKLAHOMA
Corporation
Commission

Form 1002A
Rev. 2020

☒ ORIGINAL
☐ AMENDED (Reason)

Rule 165:10-3-25

COMPLETION REPORT

TYPE OF DRILLING OPERATION

☒ STRAIGHT HOLE ☐ DIRECTIONAL HOLE ☐ HORIZONTAL HOLE

If directional or horizontal, see reverse for bottom hole location.

COUNTY Harmon SEC 22 TWP 02N RGE 24W

LEASE NAME Searchey

WELL NO. 1-22

SPUD DATE 9/19/19

DRLG FINISHED DATE 9/25/19

DATE OF WELL COMPLETION 6/8/21

1st PROD DATE 12/31/19

RECOMP DATE

C 1/4 S2 1/4 S2 1/4 NE 1/4 FSL 330' FEL 1320'

ELEVATION Derrick FL 1548' Ground 1533' Latitude 34.631264

Longitude -99.705741

OPERATOR NAME Charter Oak Production Co., LLC

OTC / OCC OPERATOR NO. 21672

ADDRESS 13929 Quail Pointe Drive

CITY Oklahoma City

STATE OK

ZIP 73134

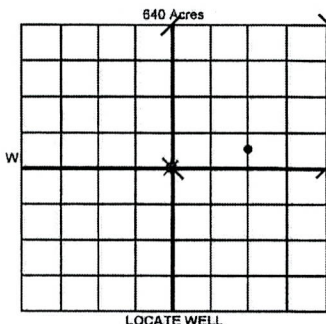

COMPLETION TYPE

<input checked="" type="checkbox"/> SINGLE ZONE	
<input type="checkbox"/> MULTIPLE ZONE	
Application Date	
<input type="checkbox"/> COMMINGLED	
Application Date	
LOCATION EXCEPTION ORDER NO.	N/A
MULTIUNIT ORDER NO.	N/A
INCREASED DENSITY ORDER NO.	N/A

CASING & CEMENT (Attach Form 1002C)

TYPE	SIZE	WEIGHT	GRADE	FEET	PSI	SAX	TOP OF CMT
CONDUCTOR	16"			85'			Surface
SURFACE	8 5/8"	24#	J-55	376'		250	Surface
INTERMEDIATE							
PRODUCTION	5 1/2"	17# & 15.5#	N-80/K-55	7094'		175	6200'
LINER							

PACKER @ _____ BRAND & TYPE _____ PLUG @ 6840' TYPE CIBP PLUG @ _____ TYPE _____ TOTAL DEPTH 7100'

COMPLETION & TEST DATA BY PRODUCING FORMATION

FORMATION	Mississippian	Mississippian					Both Frac's Reported to Frac Faces
SPACING & SPACING ORDER NUMBER	160 Ac. - Unspaced	160 Ac. - Unspaced					
CLASS: Oil, Gas, Dry, Inj, Disp, Comm Disp, Svc	Oil	Oil					
PERFORATED INTERVALS	6950' - 6994' O.A.	6805' - 6811'					
		6868' - 6872'					
ACID/VOLUME	4653 BBL 2% KCl	15,000 Gal acid					
FRACTURE TREATMENT (Fluids/Prop Amounts)	87,203# 20/40 sand	25,227# 40/70 sand 67,052# 30/50 sand 6910 BBL slick water					



Min Gas Allowable (165:10-17-7)

OR

Oil Allowable (165:10-13-3)

Purchaser/Measurer

N/A

First Sales Date

9/6/20

INITIAL TEST DATA

INITIAL TEST DATE	12/31/19	6/8/21				
OIL-BBL/DAY	9	1				
OIL-GRAVITY (API)	N/A	40.8				
GAS-MCF/DAY	0	0				
GAS-OIL RATIO CU FT/BBL	0	0				
WATER-BBL/DAY	18	10				
PUMPING OR FLOWING	Pumping	Pumping				
INITIAL SHUT-IN PRESSURE	4853 psi	2752 psi				
CHOKE SIZE	12/64"	64/64"				
FLOW TUBING PRESSURE	N/A	N/A				

RECEIVED

JUN 25 2021

Oklahoma Corporation
Commission

A record of the formations drilled through, and pertinent remarks are presented on the reverse. I declare that I have knowledge of the contents of this report and am authorized by my organization to make this report, which was prepared by me or under my supervision and direction, with the data and facts stated herein to be true, correct, and complete to the best of my knowledge and belief.

Joseph C. Brevetti
SIGNATURE

JC Brevetti, Engineering Tech.

6/24/21

(405) 286-0361

NAME (PRINT OR TYPE)

DATE

PHONE NUMBER

13929 Quail Pointe Drive

Oklahoma City

OK

73134

brevetti@charteroakproduction.com

ADDRESS

CITY

STATE

ZIP

EMAIL ADDRESS

PLEASE TYPE OR USE BLACK INK ONLY

FORMATION RECORD

Give formation names and tops, if available, or descriptions and thickness of formations drilled through. Show intervals cored or drillstem tested.

NAMES OF FORMATIONS	TOP
Mississippian	6409'

LEASE NAME Searcey

WELL NO. 1-22

FOR COMMISSION USE ONLY

ITD on file ☐ YES ☐ NO

APPROVED _____ DISAPPROVED _____

2) Reject Codes

Were open hole logs run?

☒ yes ☐ no

Date Last log was run

September 26, 2019

Was CO₂ encountered?

☐ yes ☒ no at what depths? _____

Was H₂S encountered?

☐ yes ☒ no at what depths? _____

Were unusual drilling circumstances encountered?

☐ yes ☒ no

If yes, briefly explain below

Other remarks:

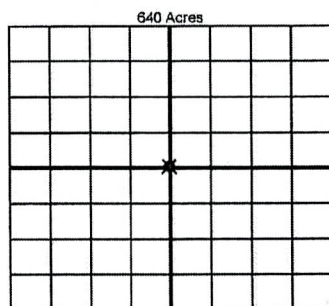

If more than three drainholes are proposed, attach a separate sheet indicating the necessary information.

Direction must be stated in degrees azimuth.
Please note, the horizontal drainhole and its end point must be located within the boundaries of the lease or spacing unit.

Directional surveys are required for all drainholes and directional wells

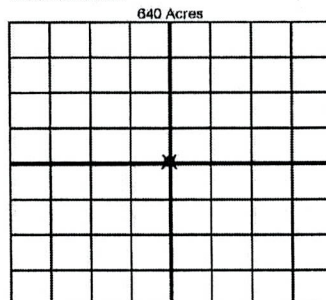

BOTTOM HOLE LOCATION FOR DIRECTIONAL HOLE

SEC	TWP	RGE	COUNTY
1/4	1/4	1/4	1/4
Measured Total Depth	True Vertical Depth	BHL From Lease, Unit, or Property Line:	

BOTTOM HOLE LOCATION FOR HORIZONTAL HOLE: (LATERALS)

LATERAL #1

SEC	TWP	RGE	COUNTY
1/4	1/4	1/4	1/4
Depth of Deviation	Radius of Turn	Direction	Total Length
Measured Total Depth	True Vertical Depth	BHL From Lease, Unit, or Property Line:	

LATERAL #2

SEC	TWP	RGE	COUNTY
1/4	1/4	1/4	1/4
Depth of Deviation	Radius of Turn	Direction	Total Length
Measured Total Depth	True Vertical Depth	BHL From Lease, Unit, or Property Line:	

LATERAL #3

SEC	TWP	RGE	COUNTY
1/4	1/4	1/4	1/4
Depth of Deviation	Radius of Turn	Direction	Total Length
Measured Total Depth	True Vertical Depth	BHL From Lease, Unit, or Property Line:	