

Oklahoma Corporation Commission
Oil & Gas Conservation Division
Post Office Box 52000
Oklahoma City, Oklahoma 73152-2000
Rule 165: 10-3-25

Form 1002A

API No.: 35101216360001

Completion Report

Spud Date: August 03, 1982

OTC Prod. Unit No.:

Drilling Finished Date: August 11, 1982

Amended

1st Prod Date: August 16, 1982

Amend Reason: CHANGED TO DISPOSAL WELL

Completion Date: August 20, 1982

Recomplete Date: November 10, 2018

Drill Type: STRAIGHT HOLE

SERVICE WELL

Well Name: AUSTIN WHITE 3

Purchaser/Measurer:

Location: MUSKOGEE 18 14N 16E
C SE SE NW
330 FSL 2310 FWL of 1/4 SEC
Derrick Elevation: 0 Ground Elevation: 606

First Sales Date:

Operator: C & T ENERGY LLC 20636

21735 BALD HILL RD
MORRIS, OK 74445-2667

Completion Type		Location Exception		Increased Density	
X	Single Zone	Order No		Order No	
	Multiple Zone	There are no Location Exception records to display.		There are no Increased Density records to display.	
	Commingled				

Casing and Cement							
Type	Size	Weight	Grade	Feet	PSI	SAX	Top of CMT
SURFACE	8 5/8			246		150	SURFACE
PRODUCTION	4 1/2			2487		450	752

Liner								
Type	Size	Weight	Grade	Length	PSI	SAX	Top Depth	Bottom Depth
There are no Liner records to display.								

Total Depth: 2490

Packer		Plug	
Depth	Brand & Type	Depth	Plug Type
2375	ARROW	There are no Plug records to display.	

Initial Test Data

Test Date	Formation	Oil BBL/Day	Oil-Gravity (API)	Gas MCF/Day	Gas-Oil Ratio Cu FT/BBL	Water BBL/Day	Pumpin or Flowing	Initial Shut- In Pressure	Choke Size	Flow Tubing Pressure
-----------	-----------	----------------	----------------------	----------------	----------------------------	------------------	----------------------	---------------------------------	---------------	-------------------------

There are no Initial Data records to display.

Completion and Test Data by Producing Formation

Formation Name: WILCOX

Code: 202WLCX

Class: DISP

Spacing Orders	
Order No	Unit Size
There are no Spacing Order records to display.	
Acid Volumes	
NONE	

Perforated Intervals	
From	To
2425	2435
Fracture Treatments	
NONE	

Formation	Top
REFER TO ORIGINAL COMPLETION REPORT	0

Were open hole logs run? No

Date last log run:

Were unusual drilling circumstances encountered? No

Explanation:

Other Remarks
CONVERTED TO DISPOSAL WELL PER UIC PERMIT NUMBER 1903490056

FOR COMMISSION USE ONLY

Status: Accepted

1141951

API NO. 10121636
OTC PROD. UNIT NO.

(PLEASE TYPE OR USE BLACK INK ONLY)

OKLAHOMA CORPORATION COMMISSION
Oil & Gas Conservation Division
Post Office Box 52000
Oklahoma City, Oklahoma 73152-2000
Rule 165-10-3-25

RECEIVED

JAN 28 2019

Form 1002A
Rev. 2009

OKLAHOMA CORPORATION COMMISSION

ORIGINAL
☒ AMENDED (Reason)

Changed to disp well

COMPLETION REPORT

TYPE OF DRILLING OPERATION

☒ STRAIGHT HOLE ☐ DIRECTIONAL HOLE ☐ HORIZONTAL HOLE
☒ SERVICE WELL

If directional or horizontal, see reverse for bottom hole location.

COUNTY MUSKOGEE SEC 18 TWP 14N RGE 16E
LEASE NAME AUSTIN WHITE WELL NO. 3
C 1/4 SE 1/4 SE 1/4 NW 1/4 FSL OF 1/4 SEC 330 FWL OF 1/4 SEC 2310
ELEVATION Derrick FL Ground 606 Latitude (if known) Longitude (if known)
OPERATOR NAME C&T ENERGY LLC OTC/OCC OPERATOR NO. 20636
ADDRESS 21735 BALD HILL RD
CITY MORRIS STATE OK ZIP 74445

SPUD DATE 8/3/1982
DRLG FINISHED DATE 8/11/1982
DATE OF WELL COMPLETION 8/20/1982
1st PROD DATE 8/16/1982
RECOMP DATE 11/10/2018

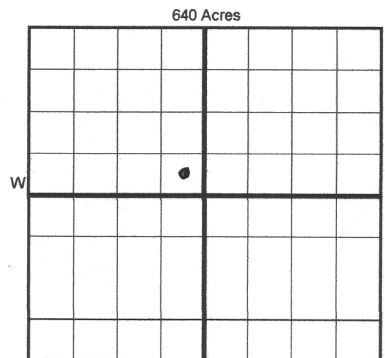

COMPLETION TYPE

☒ SINGLE ZONE
☐ MULTIPLE ZONE
Application Date
COMINGLED
Application Date
LOCATION EXCEPTION
ORDER NO.
INCREASED DENSITY
ORDER NO.

CASING & CEMENT (Form 1002C must be attached)

TYPE	SIZE	WEIGHT	GRADE	FEET	PSI	SAX	TOP OF CMT
CONDUCTOR							
SURFACE	8 5/8"			246 FT		150	SURFACE
INTERMEDIATE							
PRODUCTION	4 1/2"			2487		450	752 FT
LINER							

PACKER @ 2,375 BRAND & TYPE ARROW

PLUG @ TYPE PLUG @ TYPE
PLUG @ TYPE PLUG @ TYPE

TOTAL DEPTH 2,487

2490
per original
1002A

COMPLETION & TEST DATA BY PRODUCING FORMATION

FORMATION	WILCOX						No Frac
SPACING & SPACING ORDER NUMBER	NA-DISP WELL						
CLASS: Oil, Gas, Dry, Inj, Disp, Comm Disp, Svc	DISPOSAL						
	2425-2435						
PERFORATED INTERVALS							
ACID/VOLUME	none						
	NA						
FRACTURE TREATMENT (Fluids/Prop Amounts)	none NA						

Min Gas Allowable (165:10-17-7)

Gas Purchaser/Measurer

☐

OR

First Sales Date

INITIAL TEST DATA

Oil Allowable (165:10-13-3)

INITIAL TEST DATE	NA-DISP WELL					
OIL-BBL/DAY						
OIL-GRAVITY (API)						
GAS-MCF/DAY						
GAS-OIL RATIO CU FT/BBL						
WATER-BBL/DAY						
PUMPING OR FLOWING						
INITIAL SHUT-IN PRESSURE						
CHOKE SIZE						
FLOW TUBING PRESSURE						

AS SUBMITTED

A record of the formations drilled through, and pertinent remarks are presented on the reverse. I declare that I have knowledge of the contents of this report and am authorized by my organization to make this report, which was prepared by me or under my supervision and direction, with the data and facts stated herein to be true, correct, and complete to the best of my knowledge and belief.

SALEEM NIZAMI-CONSULTANT

1/25/2019

405-513-6055

SIGNATURE

NAME (PRINT OR TYPE)

DATE

PHONE NUMBER

2252 NW 164TH ST.

EDMOND

OK

73013

APECAPEC@MSN.COM

ADDRESS

CITY

STATE

ZIP

EMAIL ADDRESS

PLEASE TYPE OR USE BLACK INK ONLY

FORMATION RECORD

Give formation names and tops, if available, or descriptions and thickness of formations drilled through. Show intervals cored or drillstem tested.

NAMES OF FORMATIONS	TOP
PLEASE REFER THE ORIGINAL COMP REPORT	

LEASE NAME AUSTIN WHITE WELL NO. 3

FOR COMMISSION USE ONLY	
ITD on file <input type="checkbox"/> YES <input type="checkbox"/> NO	
APPROVED _____	DISAPPROVED _____
2) Reject Codes	

Were open hole logs run?	_____ yes _____ no	
Date Last log was run	_____	
Was CO ₂ encountered?	_____ yes _____ no	at what depths? _____
Was H ₂ S encountered?	_____ yes _____ no	at what depths? _____
Were unusual drilling circumstances encountered?	_____ yes _____ no	
If yes, briefly explain below:		

Other remarks:	CONVERTED TO DISPOSAL WELL PER UIC PERMIT 1903490056

640 Acres

If more than three drainholes are proposed, attach a separate sheet indicating the necessary information.

Direction must be stated in degrees azimuth.
Please note, the horizontal drainhole and its end point must be located within the boundaries of the lease or spacing unit.

Directional surveys are required for all drainholes and directional wells.

640 Acres

BOTTOM HOLE LOCATION FOR DIRECTIONAL HOLE

SEC	TWP	RGE	COUNTY			
Spot Location				1/4	1/4	1/4
Measured Total Depth				True Vertical Depth		BHL From Lease, Unit, or Property Line:

BOTTOM HOLE LOCATION FOR HORIZONTAL HOLE: (LATERALS)

LATERAL #1

SEC	TWP	RGE	COUNTY			
Spot Location				1/4	1/4	1/4
Depth of Deviation				Radius of Turn		Direction
Measured Total Depth				True Vertical Depth		BHL From Lease, Unit, or Property Line:

LATERAL #2

SEC	TWP	RGE	COUNTY			
Spot Location				1/4	1/4	1/4
Depth of Deviation				Radius of Turn		Direction
Measured Total Depth				True Vertical Depth		BHL From Lease, Unit, or Property Line:

LATERAL #3

SEC	TWP	RGE	COUNTY			
Spot Location				1/4	1/4	1/4
Depth of Deviation				Radius of Turn		Direction
Measured Total Depth				True Vertical Depth		BHL From Lease, Unit, or Property Line: