

Oklahoma Corporation Commission
Oil & Gas Conservation Division
Post Office Box 52000
Oklahoma City, Oklahoma 73152-2000
Rule 165: 10-3-25

Form 1002A

API No.: 35093224190002

Completion Report

Spud Date: September 27, 1981

OTC Prod. Unit No.: 093-043066

Drilling Finished Date: October 22, 1981

1st Prod Date: December 16, 1981

Amended

Completion Date: January 11, 1982

Amend Reason: RECOMPLETE

Recomplete Date: November 19, 2018

Drill Type: STRAIGHT HOLE

Min Gas Allowable: Yes

Well Name: SUTTER 2-30

Purchaser/Measurer: CIMARRON PIPELINE

Location: MAJOR 30 22N 13W
SE SE NW SW
1497 FSL 1310 FWL of 1/4 SEC
Latitude: 36.35177 Longitude: -98.635591
Derrick Elevation: 1350 Ground Elevation: 1340

First Sales Date: 11/21/2018

Operator: BLAKE PRODUCTION COMPANY INC 18119

1601 NW EXPRESSWAY STE 777
OKLAHOMA CITY, OK 73118-1446

| Completion Type | | Location Exception | | Increased Density | | | |
|-----------------|---------------|--------------------|--|-------------------|--|--|--|
| | Single Zone | Order No | | Order No | | | |
| | Multiple Zone | 525508 | | 525507 | | | |
| X | Commingled | 545779 | | 545782 | | | |
| | | 689826 | | | | | |

| Casing and Cement | | | | | | | |
|-------------------|-------|-----------|-------|------|-----|-----|------------|
| Type | Size | Weight | Grade | Feet | PSI | SAX | Top of CMT |
| SURFACE | 8 5/8 | 24 | K-55 | 1000 | | 800 | SURFACE |
| PRODUCTION | 5 1/2 | 15.5 / 17 | K-55 | 8157 | | 400 | 5656 |

| Liner | | | | | | | | |
|--|------|--------|-------|--------|-----|-----|-----------|--------------|
| Type | Size | Weight | Grade | Length | PSI | SAX | Top Depth | Bottom Depth |
| There are no Liner records to display. | | | | | | | | |

Total Depth: 8530

| Packer | | Plug | |
|--------|--------------|---------------------------------------|-----------|
| Depth | Brand & Type | Depth | Plug Type |
| 5790 | MODEL R | There are no Plug records to display. | |

| Initial Test Data |
|-------------------|
| |

| Test Date | Formation | Oil BBL/Day | Oil-Gravity (API) | Gas MCF/Day | Gas-Oil Ratio Cu FT/BBL | Water BBL/Day | Pumpin or Flowing | Initial Shut-In Pressure | Choke Size | Flow Tubing Pressure |
|--------------|-------------------|-------------|-------------------|-------------|-------------------------|---------------|-------------------|--------------------------|------------|----------------------|
| Nov 21, 2018 | RED FORK | 1 | | 20 | 20000 | 30 | PLUNGER | 200 | | 20 |
| Nov 21, 2018 | MISSISSIPPI SOLID | 0.25 | | 25 | 100000 | 2 | PLUNGER | | 18/64 | 575 |
| Nov 21, 2018 | INOLA | | | 5 | | | PLUNGER | | | |

Completion and Test Data by Producing Formation

Formation Name: RED FORK

Code: 404RDFK

Class: GAS

Spacing Orders

| Order No | Unit Size |
|----------|-----------|
| 60528 | 640 |

Perforated Intervals

| From | To |
|------|------|
| 6699 | 6705 |

Acid Volumes

NO

Fracture Treatments

425 BARRELS, 15,000 POUNDS

Formation Name: MISSISSIPPI SOLID

Code: 351MSSSD

Class: GAS

Spacing Orders

| Order No | Unit Size |
|----------|-----------|
| 78330 | 640 |

Perforated Intervals

| From | To |
|------|------|
| 7074 | 8056 |

Acid Volumes

YES

Fracture Treatments

YES

Formation Name: INOLA

Code: 404INOL

Class: GAS

Spacing Orders

| Order No | Unit Size |
|----------|-----------|
| 330316 | 640 |

Perforated Intervals

| From | To |
|------|------|
| 6747 | 6754 |

Acid Volumes

1,000 GALLONS

Fracture Treatments

385 BARRELS

| Formation | Top |
|-------------|------|
| BIG LIME | 6418 |
| OSWEGO | 6474 |
| RED FORK | 6674 |
| INOLA | 6754 |
| CHESTER | 6818 |
| MISSISSIPPI | 7388 |
| HUNTON | 8130 |

Were open hole logs run? No

Date last log run:

Were unusual drilling circumstances encountered? No

Explanation:

Other Remarks

There are no Other Remarks.

FOR COMMISSION USE ONLY

1141924

Status: Accepted

(PLEASE TYPE OR USE BLACK INK ONLY)

Oil & Gas Conservation Division

Post Office Box 52000

Oklahoma City, Oklahoma 73152-2000

Rule 165:10-3-25

COMPLETION REPORT

| | |
|-------------------------------------|------------------|
| <input type="checkbox"/> | ORIGINAL |
| <input checked="" type="checkbox"/> | AMENDED (Reason) |

Recomplete

TYPE OF DRILLING OPERATION

☒ STRAIGHT HOLE ☐ DIRECTIONAL HOLE ☐ HORIZONTAL HOLE

If directional or horizontal, see reverse for bottom hole location.

| | | | | | | | | | |
|---------------------------------------|----------------------------|--------|--------|---------------------|-------|----------------|----------------------|-------------------------|------------|
| COUNTY | Major | SEC | 30 | TWP | 22N | RGE | 13W | DATE OF WELL COMPLETION | 1-11-82 |
| LEASE NAME | Sutter | | | | | WELL NO. | 2-30 | 1st PROD DATE | 12-16-81 |
| SE 1/4 | SE 1/4 | NW 1/4 | SW 1/4 | FSL OF 1/4 SEC | 1497 | FWL OF 1/4 SEC | 1310 | RECOMP DATE | 11-19-18 |
| ELEVATION Derrick FL | 1350 | Ground | 1340 | Latitude (if known) | | 36.351770 | | Longitude (if known) | -98.635591 |
| OPERATOR NAME | Blake Production Co., Inc. | | | | | | OTC/OCC OPERATOR NO. | 18119 | |
| ADDRESS 1601 NW Expressway, Suite 777 | | | | | | | | | |
| CITY | Oklahoma City | | | | STATE | OK | ZIP | 73118 | |

RECEIVED

JAN 23 2019

OKLAHOMA CORPORATION
COMMISSION

640 Acres

A 10x10 grid representing a 640-acre tract. The top edge is labeled "640 Acres". The left edge is labeled "W". The bottom edge is labeled "LOCATE WELL". An "X" is marked in the second column from the left and the third row from the bottom.

LOCATE WELL

COMPLETION TYPE

| | | |
|--------------------|-----------------------|-----------|
| | SINGLE ZONE | |
| | MULTIPLE ZONE | |
| | Application Date | |
| | COMMINGLED | |
| X | Application Date | 9/11/2018 |
| LOCATION EXCEPTION | | |
| ORDER NO. | 545779/ 689826 / 5255 | |
| INCREASED DENSITY | | |
| ORDER NO. | 545782 / 5255 | |

CASING & CEMENT (Form 1002C must be attached)

| TYPE | SIZE | WEIGHT | GRADE | FEET | PSI | SAX | TOP OF CMT |
|--------------|--------|----------|-------|-------------|-----|-------|------------|
| CONDUCTOR | | | | | | | |
| SURFACE | 8 5/8" | 24 | k-55 | 1000' | | 800 | Surface |
| INTERMEDIATE | | | | | | | |
| PRODUCTION | 5 1/2" | 15.5, 17 | k-55 | 8157' | | 400 | 5656' |
| LINER | | | | | | | |
| PLUG @ | TYPE | PLUG @ | TYPE | TOTAL DEPTH | | 8,530 | |

| | | | | | | | | | | | |
|----------|--------------|--------------|----------------|--------|-------|------|-------|--------|-------|------|-------|
| PACKER @ | <u>5790'</u> | BRAND & TYPE | <u>Model R</u> | PLUG @ | _____ | TYPE | _____ | PLUG @ | _____ | TYPE | _____ |
| PACKER @ | _____ | BRAND & TYPE | _____ | PLUG @ | _____ | TYPE | _____ | PLUG @ | _____ | TYPE | _____ |

| | |
|-------------|-------|
| TOTAL DEPTH | 8,530 |
|-------------|-------|

COMPLETION & TEST DATA BY PRODUCING FORMATION

| | | | | | | |
|--|-------------|-------------|--------------|--|--|-------------------------|
| FORMATION | Red Fork | Mississippi | Inola | | | Report to Flare Four |
| SPACING & SPACING ORDER NUMBER | 640 - 60528 | 640 - 78330 | 640 - 330316 | | | |
| CLASS: Oil, Gas, Dry, Inj, Disp, Comm Disp, Svc | Gas | Gas | Gas | | | |
| PERFORATED INTERVALS | 6699-6705 | 7074-8056 | 6747-6754 | | | |
| | | | | | | |
| | | | | | | |
| ACID/VOLUME | No | Yes | yes/1000 gal | | | |
| FRACTURE TREATMENT (Fluids/Prop Amounts) | 425 bbl | Yes | 385 bbl | | | |
| | 15k lbs | | | | | |
| | | | | | | |

☒ Min Gas Allowable (165:10-17-7)
OR
☐ Oil Allowable (165:10-13-3)

Gas Purchaser/Measurer
First Sales Date

Cimarron Pipeline
11/21/2018

INITIAL TEST DATA

| INITIAL TEST DATE | 11/21/2018 | 11/30/2017 | 11/21/18 | 11/30/2007 | 11-21-18 |
|--------------------------|------------|-----------------|----------|-----------------|----------|
| OIL-BBL/DAY | 1 | 68 1/4 | | 10 | |
| OIL-GRAVITY (API) | | | | | |
| GAS-MCF/DAY | 20 | 361 25 | | 57 5 | |
| GAS-OIL RATIO CU FT/BBL | 20,000 | 5.3 / 100,000 | | | |
| WATER-BBL/DAY | 30 | 104 2 | | .5 | |
| PUMPING OR FLOWING | Plunger | Plunger Flowing | | Flowing Plunger | |
| INITIAL SHUT-IN PRESSURE | 200 psi | | | | |
| CHOKE SIZE | N/A | 18/64 | | | |
| FLOW TUBING PRESSURE | 20 psi | 575 psi | | | |

AS SUBMITTED

A record of the formations drilled through, and pertinent remarks are presented on the reverse. I declare that I have knowledge of the contents of this report and am authorized by my organization to make this report, which was prepared by me or under my supervision and direction, with the data and facts stated herein to be true, correct, and complete to the best of my knowledge and belief.

SIGNATURE

Kody Ewing

1/21/2019

405-286-9800

1601 NW Expressway, Suite 777

Oklahoma City

NAME (PRINT OR TYPE)

OK

73118

kody.ewing@blakeproduction.com

ADDRESS

CITY

STATE

ZIF

EMAIL ADDRESS

Give formation names and tops, if available, or descriptions and thickness of formations drilled through. Show intervals cored or drillstem tested.

LEASE NAME Sutter WELL NO. 2-30

| NAMES OF FORMATIONS | TOP |
|---------------------|-------|
| Big Lime | 6,418 |
| Oswego | 6,474 |
| Red Fork | 6,674 |
| Inola | 6,754 |
| Chester | 6,818 |
| Miss | 7,388 |
| Hunton | 8,130 |
| TD | 8,530 |

| | |
|-------------------------|--|
| FOR COMMISSION USE ONLY | |
| ITD on file | <input type="checkbox"/> YES <input type="checkbox"/> NO |
| APPROVED | DISAPPROVED |
| <hr/> | <hr/> |
| | 2) Reject Codes |
| | <hr/> |
| | <hr/> |
| | <hr/> |
| | <hr/> |
| | <hr/> |

Were open hole logs run? yes X no

Date Last log was run _____

Was CO₂ encountered? yes X no at what depths? _____

Was H₂S encountered? yes X no at what depths? _____

Were unusual drilling circumstances encountered? yes X no

If yes, briefly explain below

Other remarks:

640 Acres

BOTTOM HOLE LOCATION FOR DIRECTIONAL HOLE

| | | | | | | |
|----------------------|-----|---------------------|--------|---|-----|-----|
| SEC | TWP | RGE | COUNTY | | | |
| Spot Location | | | | Feet From 1/4 Sec Lines | FSL | FWL |
| 1/4 | 1/4 | 1/4 | 1/4 | | | |
| Measured Total Depth | | True Vertical Depth | | BHL From Lease, Unit, or Property Line: | | |

BOTTOM HOLE LOCATION FOR HORIZONTAL HOLE: (LATERALS)

| LATERAL #1 | | | | | | |
|----------------------|-----|---------------------|---|-------------------------|-----|-----|
| SEC | TWP | RGE | COUNTY | | | |
| Spot Location | | | | Feet From 1/4 Sec Lines | FSL | FWL |
| 1/4 | 1/4 | 1/4 | 1/4 | | | |
| Depth of Deviation | | Radius of Turn | Direction | Total Length | | |
| Measured Total Depth | | True Vertical Depth | BHL From Lease, Unit, or Property Line: | | | |

LATERAL #2

| | | | | | | |
|----------------------|-----|---------------------|---|-------------------------|-----|-----|
| SEC | TWP | RGE | COUNTY | | | |
| Spot Location | | | | Feet From 1/4 Sec Lines | FSL | FWL |
| 1/4 | 1/4 | 1/4 | 1/4 | | | |
| Depth of Deviation | | Radius of Turn | Direction | Total Length | | |
| Measured Total Depth | | True Vertical Depth | BHL From Lease, Unit, or Property Line: | | | |

LATERAL #3

| | | | | | | |
|----------------------|-----|---------------------|---|-------------------------|-----|-----|
| SEC | TWP | RGE | COUNTY | | | |
| Spot Location | | | | Feet From 1/4 Sec Lines | FSL | FWL |
| 1/4 | 1/4 | 1/4 | 1/4 | | | |
| Depth of Deviation | | Radius of Turn | Direction | Total Length | | |
| Measured Total Depth | | True Vertical Depth | BHL From Lease, Unit, or Property Line: | | | |

If more than three drainholes are proposed, attach a separate sheet indicating the necessary information.

Direction must be stated in degrees azimuth.
Please note, the horizontal drainhole and its end point must be located within the boundaries of the lease or spacing unit.

Directional surveys are required for all drainholes and directional wells.

640 Acres

A blank 10x10 grid for graphing, with a horizontal and vertical axis intersecting at the center. The grid is divided into four quadrants by these axes.

API NO. 093-22419
OTC PROD UNIT NO. 093-043066

(PLEASE TYPE OR USE BLACK INK ONLY)

OKLAHOMA CORPORATION COMMISSION

Oil & Gas Conservation Division

Post Office Box 52000

Oklahoma City, Oklahoma 73152-2000

Rule 165:10-3-25

RECEIVED

Form 1002A

Rev. 2009

JAN 23 2019

1016EZ

A: 043066 #25

ORIGINAL
X AMENDED (Reason)

Recomplete

COMPLETION REPORT

TYPE OF DRILLING OPERATION

X STRAIGHT HOLE ☐ DIRECTIONAL HOLE ☐ HORIZONTAL HOLE
☐ SERVICE WELL

If directional or horizontal, see reverse for bottom hole location.

| | | | | | | | |
|----------------------|-------------------------------|--------|--------|----------------------|-----------|----------------|------|
| COUNTY | Major | SEC | 30 | TWP | 22N | RGE | 13W |
| LEASE NAME | Sutter | | | WELL NO. | 2-30 | | |
| SE 1/4 | SE 1/4 | NW 1/4 | SW 1/4 | FSL OF 1/4 SEC | 1497 | FWL OF 1/4 SEC | 1310 |
| ELEVATION Derrick FL | 1350 | Ground | 1340 | Latitude (if known) | 36.351770 | | |
| OPERATOR NAME | Blake Production Co., Inc. | | | OTC/OCC OPERATOR NO. | 18119 | | |
| ADDRESS | 1601 NW Expressway, Suite 777 | | | | | | |
| CITY | Oklahoma City | STATE | OK | ZIP | 73118 | | |

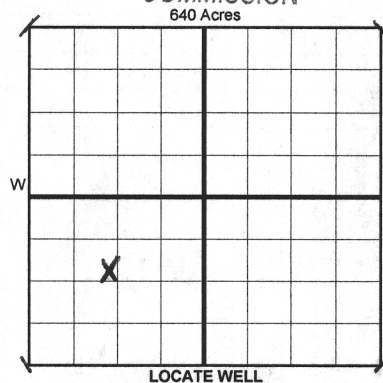

COMPLETION TYPE

| | |
|--------------------|----------------------|
| SINGLE ZONE | |
| MULTIPLE ZONE | |
| Application Date | |
| COMINGLED | 9/11/2018 |
| Application Date | |
| LOCATION EXCEPTION | |
| ORDER NO. | 545779/689826/525508 |
| INCREASED DENSITY | |
| ORDER NO. | 545782/525507 |

CASING & CEMENT (Form 1002C must be attached)

| TYPE | SIZE | WEIGHT | GRADE | FEET | PSI | SAX | TOP OF CMT |
|--------------|--------|----------|-------|-------|-----|-----|------------|
| CONDUCTOR | | | | | | | |
| SURFACE | 8 5/8" | 24 | k-55 | 1000' | | 800 | Surface |
| INTERMEDIATE | | | | | | | |
| PRODUCTION | 5 1/2" | 15.5, 17 | k-55 | 8157' | | 400 | 5656' |
| LINER | | | | | | | |

| | | | | | | | | |
|----------------|--------------|---------|--------|------|--------|------|-------------|-------|
| PACKER @ 5790' | BRAND & TYPE | Model R | PLUG @ | TYPE | PLUG @ | TYPE | TOTAL DEPTH | 8,530 |
| PACKER @ | BRAND & TYPE | | PLUG @ | TYPE | PLUG @ | TYPE | | |

COMPLETION & TEST DATA BY PRODUCING FORMATION

| FORMATION | Red Fork | Mississippi Solid | Inola | Report to |
|---|-------------|-------------------|--------------|------------|
| SPACING & SPACING ORDER NUMBER | 640 - 60528 | 640 - 78330 | 640 - 330316 | Face Folds |
| CLASS: Oil, Gas, Dry, Inj, Disp, Comm Disp, Svc | Gas | Gas | Gas | |
| PERFORATED INTERVALS | 6699-6705 | 7074-8056 | 6747-6754 | |
| ACID/VOLUME | No | Yes | yes/1000 gal | |
| FRACTURE TREATMENT (Fluids/Prop Amounts) | 425 bbl | Yes | 385 bbl | |
| | 15k lbs | | | |

| | | | | |
|--------------------------|---|---------------|------------------------|-------------------|
| INITIAL TEST DATA | <input checked="" type="checkbox"/> Min Gas Allowable OR <input type="checkbox"/> Oil Allowable | (165:10-17-7) | Gas Purchaser/Measurer | Cimarron Pipeline |
| INITIAL TEST DATE | 11/21/2018 | 11/21/2018 | First Sales Date | 11/21/2018 |
| OIL-BBL/DAY | 1 | 68 1/4 | | |
| OIL-GRAVITY (API) | | 1.0 | | |
| GAS-MCF/DAY | 20 | 381 25 | | |
| GAS-OIL RATIO CU FT/BBL | 20,000 | 5.3/100,000 | | |
| WATER-BBL/DAY | 30 | 104 2 | | |
| PUMPING OR FLOWING | Plunger | Flowing | | |
| INITIAL SHUT-IN PRESSURE | 200 psi | | | |
| CHOKE SIZE | N/A | 18/64 | | |
| FLOW TUBING PRESSURE | 20 psi | 575 psi | | |

AS SUBMITTED

| | | | |
|--|------------------------|--|--------------|
| A record of the formations drilled through, and pertinent remarks are presented on the reverse. I declare that I have knowledge of the contents of this report and am authorized by my organization to make this report, which was prepared by me or under my supervision and direction, with the data and facts stated herein to be true, correct, and complete to the best of my knowledge and belief. | | | |
| SIGNATURE | Kody Ewing | 1/21/2019 | 405-286-9800 |
| 1601 NW Expressway, Suite 777 | Oklahoma City OK 73118 | DATE | PHONE NUMBER |
| ADDRESS | CITY STATE ZIP | EMAIL ADDRESS kody.ewing@blakeproduction.com | |

SCANNED

Test Miss Solid Inola Form 1002A

ER

JK