

Oklahoma Corporation Commission
Oil & Gas Conservation Division
Post Office Box 52000
Oklahoma City, Oklahoma 73152-2000
Rule 165: 10-3-25

Form 1002A

API No.: 35049252130000

Completion Report

Spud Date: August 22, 2018

OTC Prod. Unit No.: 049-224381

Drilling Finished Date: September 30, 2018

1st Prod Date: November 13, 2018

Completion Date: November 05, 2018

Drill Type: HORIZONTAL HOLE

Min Gas Allowable: Yes

Well Name: MUSTANG 1-13USH

Purchaser/Measurer: WOODFORD EXPRESS

Location: GARVIN 12 3N 4W
SW SW NE SW
1514 FSL 1449 FWL of 1/4 SEC
Derrick Elevation: 0 Ground Elevation: 1160

First Sales Date: 11/13/2018

Operator: RIMROCK RESOURCE OPERATING LLC 23802

20 E 5TH ST STE 1300
TULSA, OK 74103-4462

Completion Type		Location Exception		Increased Density	
X	Single Zone	Order No		Order No	
	Multiple Zone	683174		There are no Increased Density records to display.	
	Commingled				

Casing and Cement							
Type	Size	Weight	Grade	Feet	PSI	SAX	Top of CMT
SURFACE	13 3/8	54.5	J-55	1521		815	SURFACE
INTERMEDIATE	9 5/8	40	P-110	10160		1435	10135
PRODUCTION	5 1/2	20	P-110	18371		1250	10202

Liner								
Type	Size	Weight	Grade	Length	PSI	SAX	Top Depth	Bottom Depth
There are no Liner records to display.								

Total Depth: 18374

Packer	
Depth	Brand & Type
There are no Packer records to display.	

Plug	
Depth	Plug Type
There are no Plug records to display.	

Initial Test Data

Test Date	Formation	Oil BBL/Day	Oil-Gravity (API)	Gas MCF/Day	Gas-Oil Ratio Cu FT/BBL	Water BBL/Day	Pumpin or Flowing	Initial Shut-In Pressure	Choke Size	Flow Tubing Pressure
Nov 21, 2018	MISSISSIPPIAN	614	50	2118	3450	1707	FLOWING	400	28/64	660

Completion and Test Data by Producing Formation

Formation Name: MISSISSIPPIAN

Code: 359MSSP

Class: OIL

Spacing Orders

Order No	Unit Size
660070	640

Perforated Intervals

From	To
13450	18321

Acid Volumes

33,000 GALLONS 15% HCL

Fracture Treatments

268,000 BARRELS, 11,264,000 POUNDS PROPPANT

Formation	Top
HOGSHOOTER	7393
CHECKERBOARD	7845
2ND DEESE	8164
GIBSON	8482
HART	8721
OSBORN	9077
PRIMROSE	9545
CUNNINGHAM	9890
CANEY	12016
MAYES	12069
SYCAMORE	12118

Were open hole logs run? Yes

Date last log run: September 11, 2018

Were unusual drilling circumstances encountered? No

Explanation:

Other Remarks

OCC - THIS DOCUMENT IS ACCEPTED BASED ON THE DATA SUBMITTED THE FINAL LOCATION EXCEPTION HAS NOT BEEN ISSUED.

Lateral Holes

Sec: 13 TWP: 3N RGE: 4W County: GARVIN

SW SW

166 FSL 740 FWL of 1/4 SEC

Depth of Deviation: 9268 Radius of Turn: 1050 Direction: 185 Total Length: 9106

Measured Total Depth: 18374 True Vertical Depth: 12394 End Pt. Location From Release, Unit or Property Line: 166

FOR COMMISSION USE ONLY

Status: Accepted

1141946

API NO. 049-25213
OTC PROD. UNIT NO. 049-224381

PLEASE TYPE OR USE BLACK INK ONLY

NOTE:

Attach copy of original 1002A
if recompletion or reentry.

OKLAHOMA CORPORATION COMMISSION
Oil & Gas Conservation Division
Post Office Box 52000
Oklahoma City, Oklahoma 73152-2000
Rule 165:10-3-25

RECEIVED

JAN 28 2019

Oklahoma Corporation
Commission

Form 1002A
Rev. 2009

☒ ORIGINAL
☐ AMENDED (Reason)

COMPLETION REPORT

TYPE OF DRILLING OPERATION

☐ STRAIGHT HOLE ☐ DIRECTIONAL HOLE ☒ HORIZONTAL HOLE
SERVICE WELL

If directional or horizontal, see reverse for bottom hole location.

COUNTY	Garvin	SEC	12	TWP	3N	RGE	4W	SPUD DATE	8/22/2018
LEASE NAME	Mustang	WELL NO.	1-13 USH	DATE OF WELL COMPLETION	11/5/2018	DATE	9/30/2018	DATE OF WELL COMPLETION	11/13/2018
SW 1/4 SW 1/4 NE 1/4 SW 1/4	FSL OF 1/4 SEC	1514	FWL 1/4 SEC	1449	RECOMP DATE				
ELEVATION	Ground	1160	Latitude (if known)		Longitude (if known)				
OPERATOR NAME	Rimrock Resource Operating, LLC	OTC/OCC OPERATOR NO.	23802						
ADDRESS	20 East 5th Street, Suite 1300								
CITY	Tulsa	STATE	OK	ZIP	74103				

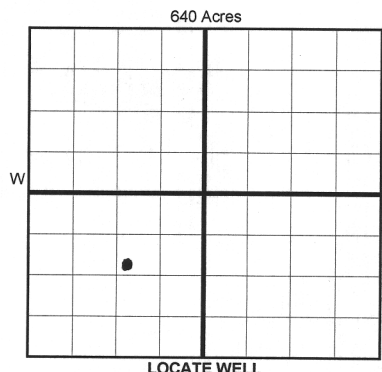

COMPLETION TYPE

<input checked="" type="checkbox"/> SINGLE ZONE
<input type="checkbox"/> MULTIPLE ZONE
Application Date
COMINGLED
Application Date
LOCATION
EXCEPTION ORDER
INCREASED DENSITY
ORDER NO.

6831742.0

CASING & CEMENT (Form 1002C must be attached)

TYPE	SIZE	WEIGHT	GRADE	FEET	PSI	SAX	TOP OF CMT
CONDUCTOR							
SURFACE	13 3/8	54.5#	J-55	1,521'		815	Surf.
INTERMEDIATE	9 5/8	40#	P-110	10,160'		1435	10,135'
PRODUCTION	5 1/2	20#	P-110	18,371'		1250	10,202'
LINER							
				TOTAL DEPTH	18,374'		

PACKER @ BRAND & TYPE PLUG @ TYPE PLUG @ TYPE
PACKER @ BRAND & TYPE PLUG @ TYPE PLUG @ TYPE

COMPLETION & TEST DATA BY PRODUCING FORMATION

FORMATION	Mississippian						
SPACING & SPACING ORDER NUMBER	660070 \ 640 ac.	#683174 LE					Reported To Frac Focus
CLASS: Oil, Gas, Dry, Inj, Disp, Comm Disp, Svc	Oil						
PERFORATED INTERVALS	13,450' - 18,321' (OA)						
ACID/VOLUME	33,000 gals 15% Hcl						
FRACTURE TREATMENT (Fluids/Prop Amounts)	268,000 bbls & 11,264,000 # proppant						

☒ Min Gas Allowable (165:10-17-7)
OR
Oil Allowable (165:10-13-3)

Gas Purchaser/Measurer
First Sales Date

Woodford Express
11/13/2018

INITIAL TEST DATA

INITIAL TEST DATE	11/21/2018				
OIL-BBL/DAY	614				
OIL-GRAVITY (API)	50.0				
GAS-MCF/DAY	2118				
GAS-OIL RATIO CU FT/BBL	3450:1				
WATER-BBL/DAY	1707				
PUMPING OR FLOWING	Flowing				
INITIAL SHUT-IN PRESSURE	400#				
CHOKE SIZE	28/64"				
FLOW TUBING PRESSURE	660#				

AS SUBMITTED

A record of the formations drilled through, and pertinent remarks are presented on the reverse. I declare that I have knowledge of the contents of this report and am authorized by my organization to make this report, which was prepared by me or under my supervision and direction, with the data and facts stated herein to be true, correct, and complete to the best of my knowledge and belief.

Signature: Paulette Kadow
NAME (PRINT OR TYPE): Paulette Kadow
DATE: 1/23/2019
PHONE NUMBER: 918-301-4717
ADDRESS: 20 East 5th Street, Suite 1300
CITY: OK STATE: 74103
EMAIL ADDRESS: pkadow@rimrockresource.com

Give formation names and tops, if available, or descriptions and thickness of formations drilled through. Show intervals cored or drillstem tested.

LEASE NAME Mustang

WELL NO. 1-13USH

NAMES OF FORMATIONS	TOP
Hogshooter	7,393'
Checkerboard	7,845'
2nd Deese	8,164'
Gibson	8,482'
Hart	8,721'
Osborn	9,077'
Primrose	9,545'
Cunningham	9,890'
Caney	12,016'
Mayes	12,069'
Sycamore	12,118'

FOR COMMISSION USE ONLY	
ITD on file	<input type="checkbox"/> YES <input type="checkbox"/> NO
APPROVED	DISAPPROVED
<div>2) Reject Codes</div> <div> <div></div> <div></div> <div></div> <div></div> <div></div> </div>	

Were open hole logs run? X yes _____ no

Date Last log was run 9/11/2018

Was CO₂ encountered? _____ yes X no at what depths? _____

Was H₂S encountered? _____ yes X no at what depths? _____

Were unusual drilling circumstances encountered? _____ yes X no

If yes, briefly explain below.

Other remarks:

640 Acres

A blank 10x10 grid with a bold cross dividing it into four 5x5 quadrants.

If more than three drainholes are proposed, attach a separate sheet indicating the necessary information.

Direction must be stated in degrees azimuth.
Please note, the horizontal drainhole and its end point must be located within the boundaries of the lease or spacing unit.

Directional surveys are required for all drainholes and directional wells.

640 Acres

A blank 8x8 grid for a crossword puzzle. The grid is composed of 8 columns and 8 rows of squares. The grid is divided into four quadrants by a thick horizontal line and a thick vertical line. The top-left quadrant is 4x4, the top-right is 4x4, the bottom-left is 4x4, and the bottom-right is 4x4. The thick lines are the 4th and 5th columns and the 4th and 5th rows.

BOTTOM HOLE LOCATION FOR DIRECTIONAL HOLE

SEC	TWP	RGE	COUNTY			
Spot Location				Feet From 1/4 Sec Lines	FSL	FWL
1/4		1/4	1/4			
Measured Total Depth		True Vertical Depth		BHL From Lease, Unit, or Property Line:		

BOTTOM HOLE LOCATION FOR HORIZONTAL HOLE: (LATERALS)

LATERAL #1

SEC 13	TWP 3N	RGE 4W	COUNTY Garvin		
Spot Location		1/4	1/4	SW 1/4	SW 1/4
Feet From 1/4 Sec Lines		FSL 166'		FWL 740'	
Depth of Deviation 9,268'		Radius of Turn 1050		Direction 185	
Measured Total Depth 18,374'		True Vertical Depth 12,394'		Total Length 9,106'	
				BHL From Lease, Unit, or Property Line: 166'	

LATERAL #2

SEC	TWP	RGE	COUNTY			
Spot Location						
1/4	1/4	1/4	1/4	Feet From 1/4 Sec Lines	FSL	FWL
Depth of Deviation		Radius of Turn		Direction	Total Length	
Measured Total Depth		True Vertical Depth		BHL From Lease, Unit, or Property Line:		

LATERAL #3

SEC	TWP	RGE	COUNTY			
Spot Location				Feet From 1/4 Sec Lines	FSL	FWL
1/4	1/4	1/4	1/4			
Depth of Deviation		Radius of Turn	Direction	Total Length		
Measured Total Depth		True Vertical Depth	BHL From Lease, Unit, or Property Line:			