

Oklahoma Corporation Commission
Oil & Gas Conservation Division
Post Office Box 52000
Oklahoma City, Oklahoma 73152-2000
Rule 165: 10-3-25

Form 1002A

API No.: 35019263770000

Completion Report

Spud Date: May 20, 2020

OTC Prod. Unit No.: 019-012538-0-5383

Drilling Finished Date: May 30, 2020

1st Prod Date: July 27, 2020

Completion Date: July 26, 2020

Drill Type: STRAIGHT HOLE

Min Gas Allowable: Yes

Well Name: SW WILDCAT JIM DEESE UNIT 14-2-I

Purchaser/Measurer: TARGA PIPELINE MID
CONTINENT

First Sales Date: N/A

Location: CARTER 7 2S 2W
SE NE SW NW
1837 FNL 1164 FWL of 1/4 SEC
Latitude: 34.40025 Longitude: -97.45359
Derrick Elevation: 0 Ground Elevation: 1045

Operator: MACK ENERGY CO 11739
PO BOX 400
1202 N 10TH ST
DUNCAN, OK 73534-0400

Completion Type		Location Exception		Increased Density	
X	Single Zone	Order No		Order No	
	Multiple Zone	There are no Location Exception records to display.		There are no Increased Density records to display.	
	Commingled				

Casing and Cement							
Type	Size	Weight	Grade	Feet	PSI	SAX	Top of CMT
SURFACE	9 5/8	36	K-55	1336		450	SURFACE
PRODUCTION	7	26	K-55	4234		430	200

Liner								
Type	Size	Weight	Grade	Length	PSI	SAX	Top Depth	Bottom Depth
There are no Liner records to display.								

Total Depth: 4250

Packer		Plug	
Depth	Brand & Type	Depth	Plug Type
There are no Packer records to display.		There are no Plug records to display.	

Initial Test Data

Test Date	Formation	Oil BBL/Day	Oil-Gravity (API)	Gas MCF/Day	Gas-Oil Ratio Cu FT/BBL	Water BBL/Day	Pumpin or Flowing	Initial Shut-In Pressure	Choke Size	Flow Tubing Pressure
Aug 08, 2020	DEESE	2	21	10	5000	179	PUMPING	560	N/A	

Completion and Test Data by Producing Formation

Formation Name: DEESE

Code: 404DEESS

Class: OIL

Spacing Orders

Order No	Unit Size
701901	UNIT

Perforated Intervals

From	To
3699	3740
3873	3878
3894	3902
3944	4017

Acid Volumes

There are no Acid Volume records to display.

Fracture Treatments

490 BARRELS, 20,500 POUNDS 16/30 SAND, 315 BARRELS, 6,500 POUNDS 16/30 SAND, 745 BARRELS, 36,500 POUNDS 16/30 SAND

Formation Name: DEESE

Code: 404DEESS

Class: OIL

Spacing Orders

Order No	Unit Size
701701	UNIT

Perforated Intervals

From	To
3627	3654

Acid Volumes

There are no Acid Volume records to display.

Fracture Treatments

440 BARRELS, 13,900 POUNDS 16/30 SAND

Formation Name: DEESE

Code: 404DEESS

Class: OIL

Spacing Orders

Order No	Unit Size
701901	UNIT

Perforated Intervals

From	To
3296	3305

Acid Volumes

There are no Acid Volume records to display.

Fracture Treatments

256 BARRELS, 4,700 POUNDS 16/30 SAND

Formation Name: DEESE

Code: 404DEESS

Class: OIL

Spacing Orders

Order No	Unit Size
701901	UNIT

Perforated Intervals

From	To
3082	3110

Acid Volumes

There are no Acid Volume records to display.

Fracture Treatments

418 BARRELS, 14,200 POUNDS 16/30 SAND

Formation	Top
DEESE	2820

Were open hole logs run? Yes

Date last log run: May 29, 2020

Were unusual drilling circumstances encountered? No

Explanation:

Other Remarks
There are no Other Remarks.

FOR COMMISSION USE ONLY	
Status: Accepted	1145497

API NO. 01926377
OTC PROD. 019-012538
UNIT NO. -0-5383

(PLEASE TYPE OR USE BLACK INK ONLY)

OKLAHOMA CORPORATION COMMISSION

Oil & Gas Conservation Division

Post Office Box 52000

Oklahoma City, Oklahoma 73152-2000

Rule 165:10-3-25

Form 1002A

Rev. 2009

☒ ORIGINAL
☐ AMENDED (Reason) _____

COMPLETION REPORT

TYPE OF DRILLING OPERATION

☒ STRAIGHT HOLE ☐ DIRECTIONAL HOLE ☐ HORIZONTAL HOLE
☐ SERVICE WELL

If directional or horizontal, see reverse for bottom hole location.

COUNTY	Carter	SEC	7	TWP	2S	RGE	2W	
LEASE NAME	SW Wildcat Jim			SW WJDU Deese Unit			WELL NO.	14-2-1
SE 1/4 NE 1/4 SW 1/4 NW 1/4	1/4 SEC 3443			1/4 SEC 1164			1st PROD DATE	7-27-20
ELEVATION	Ground	1045'	Latitude (if known)	34.40025			Longitude (if known)	~97.45359
OPERATOR NAME	Mack Energy Co.			OTC / OCC OPERATOR NO.			11739	
ADDRESS	P.O. Box 400							
CITY	Duncan		STATE	OK		ZIP	73533	

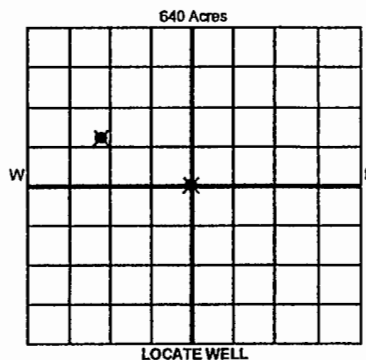

COMPLETION TYPE

<input checked="" type="checkbox"/> SINGLE ZONE	
<input type="checkbox"/> MULTIPLE ZONE	
Application Date	
COMMINGLED	
Application Date	
LOCATION EXCEPTION ORDER NO.	
INCREASED DENSITY ORDER NO.	

CASING & CEMENT (Attach Form 1002C)

TYPE	SIZE	WEIGHT	GRADE	FEET	PSI	SAX	TOP OF CMT
CONDUCTOR							
SURFACE	9 5/8"	36	K-55	1336'		450	Surf
INTERMEDIATE							
PRODUCTION	7"	26	K-55	4234'		430	200
LINER							

PACKER @ _____ BRAND & TYPE _____ PLUG @ _____ TYPE _____ PLUG @ _____ TYPE _____
PACKER @ _____ BRAND & TYPE _____ PLUG @ _____ TYPE _____ PLUG @ _____ TYPE _____

TOTAL DEPTH 4250'

COMPLETION & TEST DATA BY PRODUCING FORMATION

FORMATION	(Morris)	(Carpenter)	(Tussy)	(Eason)	← All Deese
SPACING & SPACING	10 acres	10 acres	10 acres	10 acres	
ORDER NUMBER	701901 (unit)	701901 (unit)	701901 (unit)	701901 (unit)	
CLASS: Oil, Gas, Dry, Inj, Disp, Comm Disp, Svc	Oil	Oil	Oil	Oil	
PERFORATED INTERVALS	3699-3740', 3894-3902', 3873-3878'	3627-3654'	3296-3305'	3082-3110'	
ACID/VOLUME	3944-4017'				
FRACTURE TREATMENT (Fluids/Prop Amounts)	490 bbl, 20500# 16/30 sd 315 bbls, 6500# 16/30 sd 745 bbls, 36500# 16/30 sd	440 bbl, 13900# 16/30 sd	256 bbls, 4700# 16/30 sd	418 bbls, 14200# 16/30 sd	

RECEIVED

AUG 13 2020

Oklahoma Corporation Commission

Reported to Fractures

☒

Min Gas Allowable (165:10-17-7)

OR

Oil Allowable (165:10-13-3)

Gas Purchaser/Measurer

First Sales Date

Targa Pipeline Mid Cont.

N/A

INITIAL TEST DATA

INITIAL TEST DATE	8/8/2020				
OIL-BBL/DAY	2				
OIL-GRAVITY (API)	21				
GAS-MCF/DAY	10				
GAS-OIL RATIO CU FT/BBL	5000				
WATER-BBL/DAY	179				
PUMPING OR FLOWING	Pumping				
INITIAL SHUT-IN PRESSURE	560 psi				
CHOKE SIZE	N/A				
FLOW TUBING PRESSURE	N/A				

A record of the formations drilled through, and pertinent remarks are presented on the reverse. I declare that I have knowledge of the contents of this report and am authorized by my organization to make this report, which was prepared by me or under my supervision and direction, with the data and facts stated herein to be true, correct, and complete to the best of my knowledge and belief.

<i>Dinah Mayes</i>	Dinah Mayes, Engineering Tech.	8/12/2020	580-856-3705
SIGNATURE	NAME (PRINT OR TYPE)	DATE	PHONE NUMBER
3730 Samedan Road	Ratliff City OK 73481	dmayes@mackenergy.com	
ADDRESS	CITY STATE ZIP	EMAIL ADDRESS	

PLEASE TYPE OR USE BLACK INK ONLY
FORMATION RECORD

Give formation names and tops, if available, or descriptions and thickness of formations drilled through. Show intervals cored or drillstem tested.

LEASE NAME SW WJDU

WELL NO. 14-2i

NAMES OF FORMATIONS	TOP
Deese	2820'

FOR COMMISSION USE ONLY

ITD on file ☐ YES ☐ NO

APPROVED _____ DISAPPROVED _____

2) Reject Codes _____

Were open hole logs run? ☒ yes ☐ no

Date Last log was run 5/29/2020

Was CO₂ encountered? ☐ yes ☒ no at what depths? _____

Was H₂S encountered? ☐ yes ☒ no at what depths? _____

Were unusual drilling circumstances encountered? ☐ yes ☒ no

If yes, briefly explain below _____

Other remarks: _____

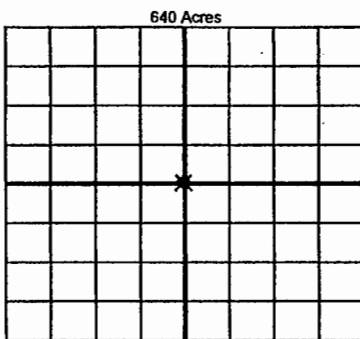

If more than three drainholes are proposed, attach a separate sheet indicating the necessary information.

Direction must be stated in degrees azimuth. Please note, the horizontal drainhole and its end point must be located within the boundaries of the lease or spacing unit.

Directional surveys are required for all drainholes and directional wells.

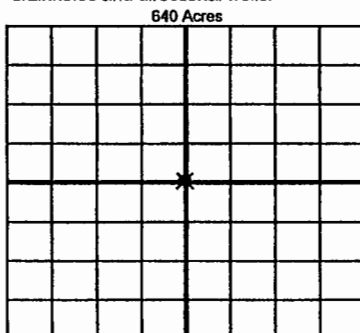

BOTTOM HOLE LOCATION FOR DIRECTIONAL HOLE

SEC	TWP	RGE	COUNTY
Spot Location		1/4	1/4
Measured Total Depth		True Vertical Depth	BHL From Lease, Unit, or Property Line:

BOTTOM HOLE LOCATION FOR HORIZONTAL HOLE: (LATERALS)

LATERAL #1

SEC	TWP	RGE	COUNTY
Spot Location		1/4	1/4
Depth of Deviation		Radius of Turn	Direction
Measured Total Depth		True Vertical Depth	BHL From Lease, Unit, or Property Line:

LATERAL #2

SEC	TWP	RGE	COUNTY
Spot Location		1/4	1/4
Depth of Deviation		Radius of Turn	Direction
Measured Total Depth		True Vertical Depth	BHL From Lease, Unit, or Property Line:

LATERAL #3

SEC	TWP	RGE	COUNTY
Spot Location		1/4	1/4
Depth of Deviation		Radius of Turn	Direction
Measured Total Depth		True Vertical Depth	BHL From Lease, Unit, or Property Line: