

Oklahoma Corporation Commission
Oil & Gas Conservation Division
Post Office Box 52000
Oklahoma City, Oklahoma 73152-2000
Rule 165: 10-3-25

Form 1002A

API No.: 35125239480000

Completion Report

Spud Date: September 05, 2019

OTC Prod. Unit No.: 125-226440-0-0000

Drilling Finished Date: September 10, 2019

1st Prod Date: December 01, 2019

Completion Date: November 14, 2019

Drill Type: STRAIGHT HOLE

Well Name: PEARCY 3-21

Purchaser/Measurer:

Location: POTTAWATOMIE 21 8N 3E
S2 NW NW NE
380 FNL 330 FWL of 1/4 SEC
Derrick Elevation: 0 Ground Elevation: 925

First Sales Date:

Operator: ARROWHEAD ENERGY INC 10239

2934 NW 156TH ST
EDMOND, OK 73013-2102

Completion Type		Location Exception		Increased Density	
X	Single Zone	Order No		Order No	
	Multiple Zone	There are no Location Exception records to display.		There are no Increased Density records to display.	
	Commingled				

Casing and Cement							
Type	Size	Weight	Grade	Feet	PSI	SAX	Top of CMT
SURFACE	8 5/8	24	J-55	200		155	SURFACE
PRODUCTION	5 1/2	17	K-55	5004		170	4050

Liner								
Type	Size	Weight	Grade	Length	PSI	SAX	Top Depth	Bottom Depth
There are no Liner records to display.								

Total Depth: 5004

Packer		Plug	
Depth	Brand & Type	Depth	Plug Type
There are no Packer records to display.		There are no Plug records to display.	

Initial Test Data										
Test Date	Formation	Oil BBL/Day	Oil-Gravity (API)	Gas MCF/Day	Gas-Oil Ratio Cu FT/BBL	Water BBL/Day	Pumpin or Flowing	Initial Shut-In Pressure	Choke Size	Flow Tubing Pressure
Dec 01, 2019	HUNTON	9.5	32.4			245	PUMPING			

Completion and Test Data by Producing Formation

Formation Name: HUNTON

Code: 269HNTN

Class: OIL

Spacing Orders

Order No	Unit Size
205029	40
213527	40

Perforated Intervals

From	To
4630	4718

Acid Volumes

There are no Acid Volume records to display.
--

Fracture Treatments

2,038 BARRELS SLICK WATER, 607 BARRELS 20 POUNDS X-LINKED GEL, 46,800 POUNDS 30/50 SAND

Formation	Top
OSAGE LAYTON	3100
CALVIN	3750
EARLSBORO	4350
PENN BASAL (BASAL PENN UNC)	4550
MAYES	4560
WOODFORD	4600
MISENER	4640
HUNTON	4650
VIOLA	5050

Were open hole logs run? Yes

Date last log run: September 11, 2019

Were unusual drilling circumstances encountered? No

Explanation:

Other Remarks

There are no Other Remarks.

FOR COMMISSION USE ONLY

1145262

Status: Accepted

API NO.	125 23948
OTC PROD. UNIT NO.	125 226440

(PLEASE TYPE OR USE BLACK INK ONLY)

OKLAHOMA CORPORATION COMMISSION
Oil & Gas Conservation Division
Post Office Box 52000
Oklahoma City, Oklahoma 73152-2000
Rule 165:10-3-25

Form 1002A
Rev. 2009

☒ ORIGINAL
☐ AMENDED (Reason) _____

COMPLETION REPORT

TYPE OF DRILLING OPERATION

☒ STRAIGHT HOLE ☐ DIRECTIONAL HOLE ☐ HORIZONTAL HOLE
☐ SERVICE WELL

If directional or horizontal, see reverse for bottom hole location.

COUNTY	Pottawatomie	SEC	21	TWP	08N	RGE	03E	
LEASE NAME	Percy			WELL NO.	3-21			
S2 1/4 NW 1/4 NW 1/4 NE 1/4	S&C OF 1/4 SEC 2348			FWL OF 1/4 SEC 330'				
ELEVATION	Ground			Latitude (if known)				
Derrick FL				Longitude (if known)				
OPERATOR NAME	Arrowhead Energy, Inc.			OTC / OCC OPERATOR NO.	10239			
ADDRESS	2934 NW 156th St.							
CITY	Edmond			STATE	OK		ZIP	73013

SPUD DATE	9/05/2019
DRLG FINISHED DATE	
DATE OF WELL COMPLETION	
1st PROD DATE	
RECOMP DATE	

840 Acres

LOCATE WELL

COMPLETION TYPE

<input checked="" type="checkbox"/> SINGLE ZONE	
<input type="checkbox"/> MULTIPLE ZONE	
Application Date	
COMINGLED	
Application Date	
LOCATION EXCEPTION ORDER NO.	
INCREASED DENSITY ORDER NO.	

CASING & CEMENT (Attach Form 1002C)

TYPE	SIZE	WEIGHT	GRADE	FEET	PSI	SAX	TOP OF CMT
CONDUCTOR							
SURFACE	8 5/8	24#	J55	200		155	Surface
INTERMEDIATE							
PRODUCTION	5 1/2	17#	K55	5004		170	4050
LINER							

PACKER @ _____ BRAND & TYPE _____ PLUG @ _____ TYPE _____ PLUG @ _____ TYPE _____
PACKER @ _____ BRAND & TYPE _____ PLUG @ _____ TYPE _____ PLUG @ _____ TYPE _____

TOTAL DEPTH 5,004

COMPLETION & TEST DATA BY PRODUCING FORMATION

FORMATION	Hunton						
SPACING & SPACING ORDER NUMBER	(40) 213527, 205029 (40)						
CLASS: Oil, Gas, Dry, Inj, Disp, Comm Disp, Svc	oil						
PERFORATED INTERVALS	4630-4648						
	4660-4690						
	4712-4718						
ACID/VOLUME							
FRACTURE TREATMENT (Fluids/Prop Amounts)	2038 bbls slick water						
	607 bbl 20# x-linked gel						
	46,800# 30/50 sand						

Reported to
Frac Focus

☐ Min Gas Allowable (165:10-17-7)
OR
☐ Oil Allowable (165:10-13-3)

Gas Purchaser/Measurer
First Sales Date _____

INITIAL TEST DATA

INITIAL TEST DATE							
OIL-BBL/DAY							
OIL-GRAVITY (API)							
GAS-MCF/DAY							
GAS-OIL RATIO CU FT/BBL							
WATER-BBL/DAY							
PUMPING OR FLOWING	pumping						
INITIAL SHUT-IN PRESSURE	NA						
CHOKE SIZE							
FLOW TUBING PRESSURE							

A record of the formations drilled through and pertinent remarks are presented on the reverse. I declare that I have knowledge of the contents of this report and am authorized by my organization to make this report, which was prepared by me or under my supervision and direction, with the data and facts stated herein to be true, correct, and complete to the best of my knowledge and belief.

William F. Varner

William F Varner

405-848-5777

SIGNATURE

NAME (PRINT OR TYPE)

DATE

PHONE NUMBER

2934 NW 156th St

Edmond

OK

73013

arrowhead@arrowheadenergy.com

ADDRESS

CITY

STATE

ZIP

EMAIL ADDRESS

PLEASE TYPE OR USE BLACK INK ONLY

FORMATION RECORD

Give formation names and tops, if available, or descriptions and thickness of formations drilled through. Show intervals cored or drillstem tested.

LEASE NAME _____ WELL NO. _____

NAMES OF FORMATIONS	TOP
Osage Layton	3,100
Calvin	3,750
Earlsboro	4350
Penn Basal (Basal Penn UNC)	4,550
Mayes	4,560
Woodford	4,600
Misener	4,640
Hunton	4,650
Viola	5,050

FOR COMMISSION USE ONLY	
ITD on file <input type="checkbox"/> YES <input type="checkbox"/> NO	
APPROVED _____ DISAPPROVED _____	2) Reject Codes
<div></div> <div></div> <div></div> <div></div> <div></div>	

Were open hole logs run?	<input checked="" type="checkbox"/> yes <input type="checkbox"/> no	<i>Per logs</i>
Date Last log was run	<i>10-18-2019</i>	
Was CO ₂ encountered?	<input type="checkbox"/> yes <input type="checkbox"/> no	at what depths? _____
Was H ₂ S encountered?	<input type="checkbox"/> yes <input type="checkbox"/> no	at what depths? _____
Were unusual drilling circumstances encountered?	<input type="checkbox"/> yes <input type="checkbox"/> no	
If yes, briefly explain below		

Other remarks:

640 Acres

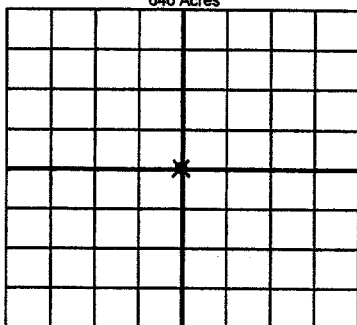

If more than three drainholes are proposed, attach a separate sheet indicating the necessary information.

Direction must be stated in degrees azimuth.

Please note, the horizontal drainhole and its end point must be located within the boundaries of the lease or spacing unit.

Directional surveys are required for all drainholes and directional wells.

640 Acres

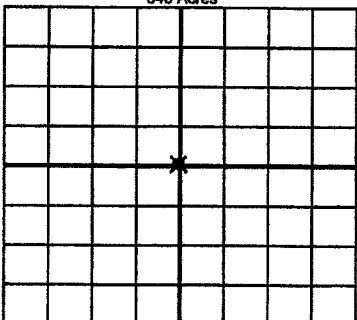

BOTTOM HOLE LOCATION FOR DIRECTIONAL HOLE

SEC	TWP	RGE	COUNTY
Spot Location			
1/4	1/4	1/4	1/4
Measured Total Depth		True Vertical Depth	BHL From Lease, Unit, or Property Line:

BOTTOM HOLE LOCATION FOR HORIZONTAL HOLE: (LATERALS)

SEC	TWP	RGE	COUNTY
Spot Location			
1/4	1/4	1/4	1/4
Depth of Deviation		Radius of Turn	Direction
Measured Total Depth		True Vertical Depth	BHL From Lease, Unit, or Property Line:

LATERAL #2

SEC	TWP	RGE	COUNTY
Spot Location			
1/4	1/4	1/4	1/4
Depth of Deviation		Radius of Turn	Direction
Measured Total Depth		True Vertical Depth	BHL From Lease, Unit, or Property Line:

LATERAL #3

SEC	TWP	RGE	COUNTY
Spot Location			
1/4	1/4	1/4	1/4
Depth of Deviation		Radius of Turn	Direction
Measured Total Depth		True Vertical Depth	BHL From Lease, Unit, or Property Line:

Image @ Original 1002A Corrected version

API NO. 125 23948
OTC PROD. UNIT NO. 125 226440

(PLEASE TYPE OR USE BLACK INK ONLY)

OKLAHOMA CORPORATION COMMISSION
Oil & Gas Conservation Division
Post Office Box 52000
Oklahoma City, Oklahoma 73152-2000
Rule 165-10-3-25

Form 1002A
Rev. 2009

☒ ORIGINAL
☐ AMENDED (Reason) _____

COMPLETION REPORT

TYPE OF DRILLING OPERATION

☒ STRAIGHT HOLE ☐ DIRECTIONAL HOLE ☐ HORIZONTAL HOLE
☐ SERVICE WELL

If directional or horizontal, see reverse for bottom hole location.

COUNTY	Pottawatomie	SEC	21	TWP	08N	RGE	03E	SPUD DATE	09/05/2019
LEASE NAME	Pearcy	WELL NO.	3-21	DATE OF WELL COMPLETION	11/14/2019	1st PROD DATE	12/01/2019		
S2 1/4 NW 1/4 NW 1/4 NE 1/4	FSL OF 1/4 SEC 2318'	FWL OF 1/4 SEC 330'		RECOMP DATE					
ELEVATION Derrick FL	Ground	Latitude (if known)		Longitude (if known)					
OPERATOR NAME	Arrowhead Energy, Inc.	OTC / OCC OPERATOR NO.	10239						
ADDRESS	2934 NW 156th St								
CITY	Edmond	STATE	OK	ZIP	73013				

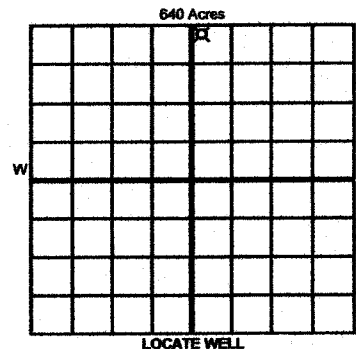

COMPLETION TYPE

<input checked="" type="checkbox"/> SINGLE ZONE	
<input type="checkbox"/> MULTIPLE ZONE	
<input type="checkbox"/> COMMINGLED	
<input type="checkbox"/> LOCATION EXCEPTION	
<input type="checkbox"/> ORDER NO.	
<input type="checkbox"/> INCREASED DENSITY	
<input type="checkbox"/> ORDER NO.	

CASING & CEMENT (Attach Form 1002C)

TYPE	SIZE	WEIGHT	GRADE	FEET	PSI	SAX	TOP OF CMT
CONDUCTOR							
SURFACE	8 5/8	24#	J55	200		155	Surface
INTERMEDIATE							
PRODUCTION	5 1/2	17#	K55	5004		170	4050
LINER							
						TOTAL DEPTH	5,004

PACKER @ _____ BRAND & TYPE _____ PLUG @ _____ TYPE _____ PLUG @ _____ TYPE _____
PACKER @ _____ BRAND & TYPE _____ PLUG @ _____ TYPE _____ PLUG @ _____ TYPE _____

COMPLETION & TEST DATA BY PRODUCING FORMATION

FORMATION	Hunton						
SPACING & SPACING ORDER NUMBER	(40) 213527, 205029 (40)						
CLASS: Oil, Gas, Dry, Inj, Disp, Comm Disp, Svc	oil						
PERFORATED INTERVALS	4630-4648						
	4660-4690						
	4712-4718						
ACID/VOLUME							
FRACTURE TREATMENT (Fluids/Prop Amounts)	2038 bbls slick water						
	607 bbl 20# x-linked gel						
	46,800# 30/50 sand						

Min Gas Allowable (165-10-17-7)

Gas Purchaser/Measurer

OR

First Sales Date

INITIAL TEST DATA

Oil Allowable (165-10-13-3)

INITIAL TEST DATE	12/1/2019						
OIL-BBL/DAY	9.5						
OIL-GRAVITY (API)	32.4						
GAS-MCF/DAY	0						
GAS-OIL RATIO CU FT/BBL	0						
WATER-BBL/DAY	245						
PUMPING OR FLOWING	Pumping						
INITIAL SHUT-IN PRESSURE	NA						
CHOKE SIZE							
FLOW TUBING PRESSURE							

A record of the formations drilled through, and pertinent remarks are presented on the reverse. I declare that I have knowledge of the contents of this report and am authorized by my organization to make this report, which was prepared by me or under my supervision and direction, with the data and facts stated herein to be true, correct, and complete to the best of my knowledge and belief.

SIGNATURE: 2934 NW 156th St
NAME (PRINT OR TYPE): William F Varner
CITY: Edmond
STATE: OK
ZIP: 73013
DATE: 6/19/2020
PHONE NUMBER: 405-848-5777
EMAIL ADDRESS: arrowhead@arrowheadenergy.com

Per email

PLEASE TYPE OR USE BLACK INK ONLY

FORMATION RECORD

Give formation names and tops, if available, or descriptions and thickness of formations drilled through. Show intervals cored or drillstem tested.

NAMES OF FORMATIONS	TOP
Osage Layton	3,100
Calvin	3,750
Earlsboro	4,350
Penn Basal (Basal Penn UNC)	4,550
Mayes	4,560
Woodford	4,600
Misener	4,640
Hunton	4,650
Viola	5,050

LEASE NAME _____ WELL NO. _____

FOR COMMISSION USE ONLY	
ITD on file <input type="checkbox"/> YES <input type="checkbox"/> NO	
APPROVED _____ DISAPPROVED _____	2) Reject Codes

Were open hole logs run?	<input checked="" type="checkbox"/> yes <input type="checkbox"/> no
Date Last log was run	9/11/2019
Was CO ₂ encountered?	<input type="checkbox"/> yes <input checked="" type="checkbox"/> no at what depths? _____
Was H ₂ S encountered?	<input type="checkbox"/> yes <input checked="" type="checkbox"/> no at what depths? _____
Were unusual drilling circumstances encountered?	<input type="checkbox"/> yes <input checked="" type="checkbox"/> no
If yes, briefly explain below	

Other remarks:

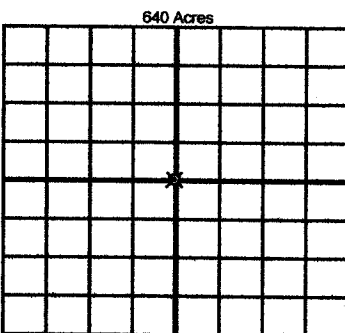

If more than three drainholes are proposed, attach a separate sheet indicating the necessary information.

Direction must be stated in degrees azimuth. Please note, the horizontal drainhole and its end point must be located within the boundaries of the lease or spacing unit.

Directional surveys are required for all drainholes and directional wells.

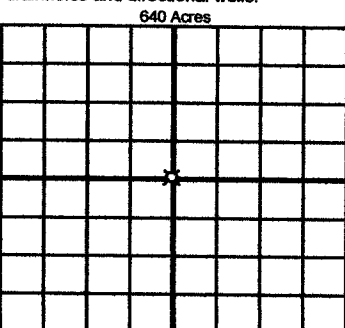

BOTTOM HOLE LOCATION FOR DIRECTIONAL HOLE

SEC	TWP	RGE	COUNTY
Spot Location			
1/4	1/4	1/4	1/4
Measured Total Depth		True Vertical Depth	BHL From Lease, Unit, or Property Line:

BOTTOM HOLE LOCATION FOR HORIZONTAL HOLE: (LATERALS)

LATERAL #1			
SEC	TWP	RGE	COUNTY
Spot Location			
1/4	1/4	1/4	1/4
Depth of Deviation		Radius of Turn	Direction
Measured Total Depth		True Vertical Depth	BHL From Lease, Unit, or Property Line:

LATERAL #2			
SEC	TWP	RGE	COUNTY
Spot Location			
1/4	1/4	1/4	1/4
Depth of Deviation		Radius of Turn	Direction
Measured Total Depth		True Vertical Depth	BHL From Lease, Unit, or Property Line:

LATERAL #3			
SEC	TWP	RGE	COUNTY
Spot Location			
1/4	1/4	1/4	1/4
Depth of Deviation		Radius of Turn	Direction
Measured Total Depth		True Vertical Depth	BHL From Lease, Unit, or Property Line: