

Oklahoma Corporation Commission
Oil & Gas Conservation Division
Post Office Box 52000
Oklahoma City, Oklahoma 73152-2000
Rule 165: 10-3-25

Form 1002A

API No.: 35019263460000

Completion Report

Spud Date: April 20, 2020

OTC Prod. Unit No.: 019-226592-0-5383

Drilling Finished Date: April 26, 2020

1st Prod Date: July 08, 2020

Completion Date: July 07, 2020

Drill Type: STRAIGHT HOLE

Well Name: SW WILDCAT JIM DEESE UNIT 10-4

Purchaser/Measurer: TARGA RESOURCES PART.

Location: CARTER 7 2S 2W
NW SE NW NW
854 FNL 891 FWL of 1/4 SEC
Latitude: 34.402956 Longitude: -97.45449
Derrick Elevation: 0 Ground Elevation: 1039

First Sales Date:

Operator: MACK ENERGY CO 11739
PO BOX 400
1202 N 10TH ST
DUNCAN, OK 73534-0400

Completion Type		Location Exception		Increased Density	
X	Single Zone	Order No		Order No	
	Multiple Zone	There are no Location Exception records to display.		There are no Increased Density records to display.	
	Commingled				

Casing and Cement							
Type	Size	Weight	Grade	Feet	PSI	SAX	Top of CMT
SURFACE	9 5/8	40	J-55	1320		450	SURFACE
PRODUCTION	7	26	J-55	4153		430	350

Liner								
Type	Size	Weight	Grade	Length	PSI	SAX	Top Depth	Bottom Depth
There are no Liner records to display.								

Total Depth: 4150

Packer		Plug	
Depth	Brand & Type	Depth	Plug Type
There are no Packer records to display.		There are no Plug records to display.	

Initial Test Data										
Test Date	Formation	Oil BBL/Day	Oil-Gravity (API)	Gas MCF/Day	Gas-Oil Ratio Cu FT/BBL	Water BBL/Day	Pumpin or Flowing	Initial Shut-In Pressure	Choke Size	Flow Tubing Pressure
Jul 08, 2020	DEESE	10	22			38	PUMPING	45	N/A	

Completion and Test Data by Producing Formation

Formation Name: DEESE

Code: 404DEESS

Class: OIL

Spacing Orders

Order No	Unit Size
701901	UNIT

Perforated Intervals

From	To
3982	3985
4008	4016
4028	4054

Acid Volumes

There are no Acid Volume records to display.

Fracture Treatments

3982-4016: WITH 454 BARRELS 12,000 POUNDS 16/30 SAND; 4028-4054: WITH 511 BARRELS 13,500 POUNDS 16/30 SAND ALL IN 1, 2, 3 PUMPING STAGES

Formation Name: DEESE

Code: 404DEESS

Class: OIL

Spacing Orders

Order No	Unit Size
701901	UNIT

Perforated Intervals

From	To
3554	3562

Acid Volumes

There are no Acid Volume records to display.

Fracture Treatments

312 BARRELS WITH 6,000 POUNDS 16/30 SAND IN 1, 2, 3 PUMPING STAGES

Formation Name: DEESE

Code: 404DEESS

Class: OIL

Spacing Orders

Order No	Unit Size
701901	UNIT

Perforated Intervals

From	To
3312	3316

Acid Volumes

There are no Acid Volume records to display.

Fracture Treatments

296 BARRELS WITH 6,000 POUNDS 16/30 SAND IN 1, 2, 3 PUMPING STAGES

Formation	Top
DEESE	2850

Were open hole logs run? Yes

Date last log run: April 25, 2020

Were unusual drilling circumstances encountered? No

Explanation:

Other Remarks

THIS WELL HAS BECOME PART OF THE NEWLY FORMED SW WILDCAT JIM DEESE UNIT (SW WJDU) APPROVED AS OF SEPTEMBER 9, 2019.

Status: Accepted

API NO. 019-26346
OTC PROD. 019-226592-
UNIT NO. 0-5383

(PLEASE TYPE OR USE BLACK INK ONLY)

OKLAHOMA CORPORATION COMMISSION

Oil & Gas Conservation Division

Post Office Box 52000

Oklahoma City, Oklahoma 73152-2000

Rule 165:10-3-25

Form 1002A

Rev. 2009

☒ ORIGINAL
☐ AMENDED (Reason) _____

COMPLETION REPORT

TYPE OF DRILLING OPERATION

☒ STRAIGHT HOLE ☐ DIRECTIONAL HOLE ☐ HORIZONTAL HOLE
☐ SERVICE WELL

If directional or horizontal, see reverse for bottom hole location.

COUNTY	Carter	SEC	7	TWP	2S	RGE	2W	SPUD DATE	4-20-20
LEASE NAME	SW Wildcat Jim SW-WJDU Deese unit							DATE OF WELL COMPLETION	7-7-20
NW 1/4 SE 1/4 NW 1/4 NW 1/4	FSL OF 1/4 SEC 4426-854							DATE OF 1st PROD DATE	7-8-20
ELEVATION	Ground	1039'	FWL OF 1/4 SEC		891'		RECOMP DATE		
Derrick FL	Latitude (if known) 34.402956							Longitude (if known) -97.45449	
OPERATOR NAME	Mack Energy Co.							OTC / OCC OPERATOR NO.	11739
ADDRESS	P.O. Box 400								
CITY	Duncan	STATE	OK	ZIP	73534				

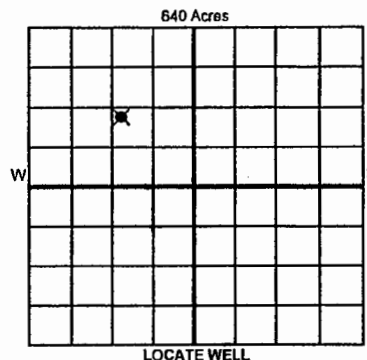

COMPLETION TYPE

<input checked="" type="checkbox"/> SINGLE ZONE	
<input type="checkbox"/> MULTIPLE ZONE	
Application Date	
<input type="checkbox"/> COMMINGLED	
Application Date	
LOCATION EXCEPTION ORDER NO.	
INCREASED DENSITY ORDER NO.	

CASING & CEMENT (Attach Form 1002C)

TYPE	SIZE	WEIGHT	GRADE	FEET	PSI	SAX	TOP OF CMT
CONDUCTOR							
SURFACE	9 5/8"	40#	J-55	1320'		450	Surf
INTERMEDIATE							
PRODUCTION	7"	26#	J-55	4153'		430	350'
LINER							
						TOTAL DEPTH	4150'

PACKER @ _____ BRAND & TYPE _____ PLUG @ _____ TYPE _____ PLUG @ _____ TYPE _____
PACKER @ _____ BRAND & TYPE _____ PLUG @ _____ TYPE _____ PLUG @ _____ TYPE _____

COMPLETION & TEST DATA BY PRODUCING FORMATION

FORMATION	(Morris)	(Carpenter)	(Tussy)	ALL Deese	Reported to FracFocus
SPACING & SPACING	10 acres	10 acres	10 acres		
ORDER NUMBER	201901 unit	201901 unit	201901 unit		
CLASS: Oil, Gas, Dry, Inj, Disp, Comm Disp, Svc	Oil	Oil	Oil		
PERFORATED INTERVALS	3982-3985'	3554-3562'	3312-16'		
	4008-16'				
	4028-54'				
ACID/VOLUME					
FRACTURE TREATMENT (Fluids/Prop Amounts)	3982-4016: w/454 bbls 12K# 16/30 sd 4028-54' w/511 bbls 13500# 16/30 sd all in 1,2,3 ppg stgs	312 bbls w/6K# 16/30 sd in 1,2,3 ppg stgs	296 bbls w/6K# 16/30 sd in 1,2,3, ppg stgs		

RECEIVED

SEP 18 2020

Oklahoma Corporation
Commission

Min Gas Allowable (165:10-17-7)



OR

Oil Allowable (165:10-13-3)

Gas Purchaser/Measurer

First Sales Date

Targa Resources Part

INITIAL TEST DATA

INITIAL TEST DATE	7/8/2020				
OIL-BBL/DAY	10				
OIL-GRAVITY (API)	22				
GAS-MCF/DAY	0				
GAS-OIL RATIO CU FT/BBL	0				
WATER-BBL/DAY	38				
PUMPING OR FLOWING	Pumping				
INITIAL SHUT-IN PRESSURE	45 psig				
CHOKE SIZE	N/A				
FLOW TUBING PRESSURE	N/A				

A record of the formations drilled through, and pertinent remarks are presented on the reverse. I declare that I have knowledge of the contents of this report and am authorized by my organization to make this report, which was prepared by me or under my supervision and direction, with the data and facts stated herein to be true, correct, and complete to the best of my knowledge and belief.

	Dinah Mayes	9-16-20	580-856-3705
SIGNATURE	NAME (PRINT OR TYPE)	DATE	PHONE NUMBER
3730 Samedan Rd.	Ratliff City OK 73481		dmayes@mackenergy.com
ADDRESS	CITY STATE ZIP		EMAIL ADDRESS

PLEASE TYPE OR USE BLACK INK ONLY
FORMATION RECORD

Give formation names and tops, if available, or descriptions and thickness of formations drilled through. Show intervals cored or drillstem tested.

LEASE NAME SW WJDU

WELL NO. 10-4

NAMES OF FORMATIONS	TOP
Deese	2850'

FOR COMMISSION USE ONLY

ITD on file ☐ YES ☐ NO

APPROVED _____ DISAPPROVED _____

2) Reject Codes _____

Were open hole logs run? ☒ yes ☐ no

Date Last log was run 4/25/2020

Was CO₂ encountered? ☐ yes ☒ no at what depths? _____

Was H₂S encountered? ☐ yes ☒ no at what depths? _____

Were unusual drilling circumstances encountered? ☐ yes ☒ no

If yes, briefly explain below _____

Other remarks: This well has become part of the newly formed SW Wildcat Jim Deese Unit (SW WJDU) approved as of 9-9-19

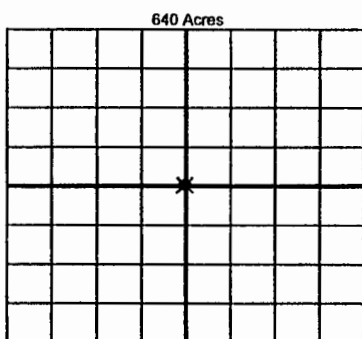

If more than three drainholes are proposed, attach a separate sheet indicating the necessary information.

Direction must be stated in degrees azimuth. Please note, the horizontal drainhole and its end point must be located within the boundaries of the lease or spacing unit.

Directional surveys are required for all drainholes and directional wells.

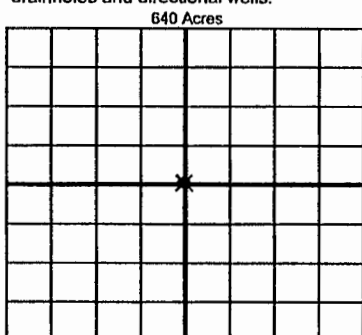

BOTTOM HOLE LOCATION FOR DIRECTIONAL HOLE

SEC	TWP	RGE	COUNTY
Spot Location			
1/4	1/4	1/4	1/4
Measured Total Depth		True Vertical Depth	BHL From Lease, Unit, or Property Line:

BOTTOM HOLE LOCATION FOR HORIZONTAL HOLE: (LATERALS)

LATERAL #1

SEC	TWP	RGE	COUNTY
Spot Location			
1/4	1/4	1/4	1/4
Depth of Deviation		Radius of Turn	Direction
Measured Total Depth		True Vertical Depth	BHL From Lease, Unit, or Property Line:

LATERAL #2

SEC	TWP	RGE	COUNTY
Spot Location			
1/4	1/4	1/4	1/4
Depth of Deviation		Radius of Turn	Direction
Measured Total Depth		True Vertical Depth	BHL From Lease, Unit, or Property Line:

LATERAL #3

SEC	TWP	RGE	COUNTY
Spot Location			
1/4	1/4	1/4	1/4
Depth of Deviation		Radius of Turn	Direction
Measured Total Depth		True Vertical Depth	BHL From Lease, Unit, or Property Line: