

Oklahoma Corporation Commission
Oil & Gas Conservation Division
Post Office Box 52000
Oklahoma City, Oklahoma 73152-2000
Rule 165: 10-3-25

Form 1002A

API No.: 35101229480000

Completion Report

Spud Date: June 27, 2019

OTC Prod. Unit No.:

Drilling Finished Date: July 04, 2019

1st Prod Date:

Completion Date: April 04, 2020

Drill Type: STRAIGHT HOLE

Well Name: TAYLOR "T" 29-14-1A

Purchaser/Measurer:

Location: MUSKOGEE 29 15N 15E
C NW SE SW
990 FSL 1650 FWL of 1/4 SEC
Derrick Elevation: 0 Ground Elevation: 583

First Sales Date:

Operator: J & J PRODUCTION COMPANY LLC 4183
PO BOX 561

OKEMAH, OK 74859-0561

Completion Type		Location Exception		Increased Density	
X	Single Zone	Order No		Order No	
	Multiple Zone	There are no Location Exception records to display.		There are no Increased Density records to display.	
	Commingled				

Casing and Cement							
Type	Size	Weight	Grade	Feet	PSI	SAX	Top of CMT
SURFACE	8.625	21	J-55	160		100	SURFACE
PRODUCTION	4.5	11.6	J-55	1803		150	1280

Liner								
Type	Size	Weight	Grade	Length	PSI	SAX	Top Depth	Bottom Depth
There are no Liner records to display.								

Total Depth: 3132

Packer		Plug	
Depth	Brand & Type	Depth	Plug Type
There are no Packer records to display.		1385	CIBP
		1670	CIBP

Initial Test Data

Test Date	Formation	Oil BBL/Day	Oil-Gravity (API)	Gas MCF/Day	Gas-Oil Ratio Cu FT/BBL	Water BBL/Day	Pumpin or Flowing	Initial Shut-In Pressure	Choke Size	Flow Tubing Pressure
Aug 26, 2019	GILCREASE					5	SWAB			
Aug 27, 2019	GILCREASE					10	SWAB			
Mar 28, 2020	GILCREASE					5	SWAB	60		

Completion and Test Data by Producing Formation

Formation Name: GILCREASE

Code: 403GLCR

Class: DRY

Spacing Orders

Order No	Unit Size
699852	40

Perforated Intervals

From	To
1722	1727

Acid Volumes

350 GALLONS HCL

Fracture Treatments

NONE

Formation Name: GILCREASE

Code: 403GLCR

Class: DRY

Spacing Orders

Order No	Unit Size
699852	40

Perforated Intervals

From	To
1616	1620

Acid Volumes

300 GALLONS HCL

Fracture Treatments

NONE

Formation Name: GILCREASE

Code: 403GLCR

Class: DRY

Spacing Orders

Order No	Unit Size
699852	40

Perforated Intervals

From	To
1351	1354

Acid Volumes

250 GALLONS HCL

Fracture Treatments

NONE

Formation	Top
BARTLESVILLE	715
GILCREASE	1350
MISSISSIPPIAN	1845
WOODFORD	2215
VIOLA	2255
WILCOX	2290
TYNER	2350
ARBUCKLE	2415

Were open hole logs run? Yes

Date last log run: August 19, 2019

Were unusual drilling circumstances encountered? No

Explanation:

Other Remarks
There are no Other Remarks.

FOR COMMISSION USE ONLY	
Status: Accepted	1148171

101-22948
API NO. 101252948
OTC PROD. UNIT NO.

Oil and Gas Conservation Division
P.O. Box 52000
Oklahoma City, OK 73152-2000
405-521-2331
OCCCentralProcessing@OCC.OK.GOV



OKLAHOMA
Corporation
Commission

Form 1002A
Rev. 2021



ORIGINAL
AMENDED (Reason)

Rule 165:10-3-25

COMPLETION REPORT

TYPE OF DRILLING OPERATION

☒ STRAIGHT HOLE ☐ DIRECTIONAL HOLE ☐ HORIZONTAL HOLE
☐ SERVICE WELL

If directional or horizontal, see reverse for bottom hole location.

COUNTY MUSKOGEE SEC 29 TWP 15N RGE 1SE
LEASE NAME Taylor T WELL NO. 29-14-1A DATE OF WELL COMPLETION 4-4-2020
C 1/4 NW 1/4 SE 1/4 SW 1/4 FSL 990 FWL 1650 1st PROD DATE
ELEVATION Derrick FL Ground 583 Latitude Longitude
OPERATOR NAME J&J Production Co., LLC OTC/OCC OPERATOR NO. 04183
ADDRESS P.O. Box 561
CITY OKEMAH STATE OK ZIP 74859

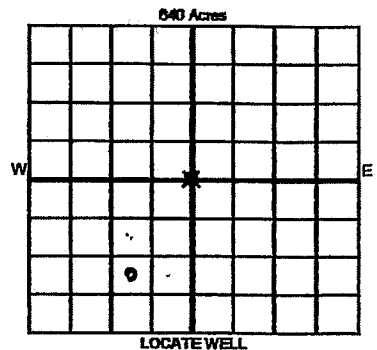

COMPLETION TYPE

☒ SINGLE ZONE
☐ MULTIPLE ZONE
☐ COMINGLED
LOCATION EXCEPTION ORDER NO.
MULTIUNIT ORDER NO.
INCREASED DENSITY ORDER NO.

CASING & CEMENT (Attach Form 1002C)

TYPE	SIZE	WEIGHT	GRADE	FEET	PSI	SAX	TOP OF CMT
CONDUCTOR							
SURFACE	8.625	21	J-55	160		100	Surface
INTERMEDIATE							
PRODUCTION	4.5	11.6	J-55	1803		150	1280
LINER							

PACKER @ BRAND & TYPE PLUG @ 1670' TYPE CIBP PLUG @ TYPE
PACKER @ BRAND & TYPE PLUG @ 1385' TYPE CIBP PLUG @ TYPE
COMPLETION & TEST DATA BY PRODUCING FORMATION 4036 LCR TOTAL DEPTH 3132'

FORMATION	<u>GILCREASE</u>	<u>GILCREASE</u>	<u>GILCREASE</u>	<u>No Frac</u>
SPACING & SPACING ORDER NUMBER	<u>699852 (40)</u>			
CLASS: Oil, Gas, Dry, Inf, Disp, Comm Disp, Svc	<u>Dry</u>	<u>Dry</u>	<u>Dry</u>	
PERFORATED INTERVALS	<u>1722'-27'</u>	<u>1616'-1620'</u>	<u>1351'-1354'</u>	
ACID/VOLUME	<u>350gal Hcl</u>	<u>300gal Hcl</u>	<u>250gal Hcl</u>	
FRACTURE TREATMENT (Fluids/Prop Amounts)	<u>NONE</u>	<u>NONE</u>	<u>NONE</u>	

RECEIVED

MAY 23 2022

OKLAHOMA CORPORATION
COMMISSION

☐ Min Gas Allowable (165:10-17-7) OR ☐ Oil Allowable (165:10-13-3) Purchaser/Measurer First Sales Date

INITIAL TEST DATA

INITIAL TEST DATE	<u>8-26-2019</u>	<u>8-27-2019</u>	<u>3-28-2020</u>
OIL-BBL/DAY	<u>0</u>	<u>0</u>	<u>SHOW</u>
OIL-GRAVITY (API)	<u>—</u>	<u>—</u>	<u>—</u>
GAS-MCF/DAY	<u>TRACE</u>	<u>TRACE</u>	<u>—</u>
GAS-OIL RATIO CU FT/BBL	<u>—</u>	<u>—</u>	<u>—</u>
WATER-BBL/DAY	<u>5</u>	<u>10</u>	<u>5</u>
PUMPING OR FLOWING	<u>SWAB</u>	<u>SWAB</u>	<u>SWAB</u>
INITIAL SHUT-IN PRESSURE	<u>0</u>	<u>0</u>	<u>60 #</u>
CHOKE SIZE	<u>—</u>	<u>—</u>	<u>—</u>
FLOW TUBING PRESSURE	<u>—</u>	<u>—</u>	<u>—</u>

A record of the formations drilled through, and pertinent remarks are presented on the reverse. I declare that I have knowledge of the contents of this report and am authorized by my organization to make this report, which was prepared by me or under my supervision and direction, with the data and facts stated herein to be true, correct, and complete to the best of my knowledge and belief.

SIGNATURE John Luckett NAME (PRINT OR TYPE) John Luckett DATE 5-2-2022 PHONE NUMBER 918-623-6363
ADDRESS P.O. Box 561 CITY OKEMAH STATE OK ZIP 74859 EMAIL ADDRESS johnluckett@yahoo.com

PLEASE TYPE OR USE BLACK INK ONLY

FORMATION RECORD

Give formation names and tops, if available, or descriptions and thickness of formations drilled through. Show intervals cored or drillstem tested.

NAMES OF FORMATIONS	TOP
Bartlesville	715
Gilcrease	1350
Mississippian	1845
Woodford	2215
Viola	2255
Wilcox	2290
Tyner	2350
Arbuckle	2415

LEASE NAME Taylor "T"

WELL NO. 29-14-1A

FOR COMMISSION USE ONLY

ITD on file ☐ YES ☐ NO

APPROVED ☐ DISAPPROVED ☐

2) Reject Codes

Were open hole logs run?

☒ yes ☐ no

Date Last log was run

8-19-79 Bond log

Was CO₂ encountered?

☐ yes ☒ no at what depths?

Was H₂S encountered?

☐ yes ☒ no at what depths?

Were unusual drilling circumstances encountered?

☐ yes ☒ no

If yes, briefly explain below

Other remarks:

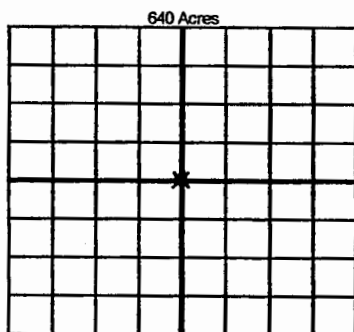

If more than three drainholes are proposed, attach a separate sheet indicating the necessary information.

Direction must be stated in degrees azimuth. Please note, the horizontal drainhole and its end point must be located within the boundaries of the lease or spacing unit.

Directional surveys are required for all drainholes and directional wells

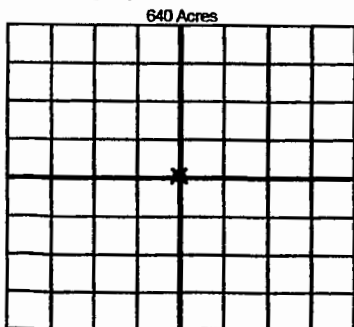

BOTTOM HOLE LOCATION FOR DIRECTIONAL HOLE

SEC	TWP	RGE	COUNTY
1/4	1/4	1/4	1/4
Measured Total Depth		True Vertical Depth	
		BHL From Lease, Unit, or Property Line:	

BOTTOM HOLE LOCATION FOR HORIZONTAL HOLE: (LATERALS)

LATERAL #1

SEC	TWP	RGE	COUNTY
1/4	1/4	1/4	1/4
Depth of Deviation		Radius of Turn	
Measured Total Depth		True Vertical Depth	
		BHL From Lease, Unit, or Property Line:	

LATERAL #2

SEC	TWP	RGE	COUNTY
1/4	1/4	1/4	1/4
Depth of Deviation		Radius of Turn	
Measured Total Depth		True Vertical Depth	
		BHL From Lease, Unit, or Property Line:	

LATERAL #3

SEC	TWP	RGE	COUNTY
1/4	1/4	1/4	1/4
Depth of Deviation		Radius of Turn	
Measured Total Depth		True Vertical Depth	
		BHL From Lease, Unit, or Property Line:	