

Oklahoma Corporation Commission
Oil & Gas Conservation Division
Post Office Box 52000
Oklahoma City, Oklahoma 73152-2000
Rule 165: 10-3-25

Form 1002A

API No.: 35087359070001

Completion Report

Spud Date: August 05, 1964

OTC Prod. Unit No.: 087-031109-0-5483

Drilling Finished Date: August 30, 1964

Amended

1st Prod Date: September 04, 1964

Amend Reason: UNITIZED, CHANGE LEASE NAME AND WELL NUMBER; HART
SQUEEZED OFF

Completion Date: September 30, 1964

Recomplete Date: April 21, 2022

Drill Type: STRAIGHT HOLE

Well Name: WEST GOLDSBY OSBORN UNIT (GOODRICH 1) T-5-W-2

Purchaser/Measurer:

Location: MCCLAIN 34 8N 3W
C SW SE NE
330 FSL 1650 FWL of 1/4 SEC
Latitude: 35.124619 Longitude: -97.49762
Derrick Elevation: 1269 Ground Elevation: 1258

First Sales Date:

Operator: TWISTED OAK OPERATING LLC 22261

700 NW 5TH ST
OKLAHOMA CITY, OK 73102-1604

Completion Type		Location Exception		Increased Density	
X	Single Zone	Order No		Order No	
	Multiple Zone	There are no Location Exception records to display.		There are no Increased Density records to display.	
	Commingled				

Casing and Cement							
Type	Size	Weight	Grade	Feet	PSI	SAX	Top of CMT
SURFACE	10 3/4	40.5		707		550	SURFACE
PRODUCTION	5 1/2	17		9350		400	

Liner								
Type	Size	Weight	Grade	Length	PSI	SAX	Top Depth	Bottom Depth
There are no Liner records to display.								

Total Depth: 9352

Packer		Plug	
Depth	Brand & Type	Depth	Plug Type
9130	BAKER MODEL D	There are no Plug records to display.	

Initial Test Data

Test Date	Formation	Oil BBL/Day	Oil-Gravity (API)	Gas MCF/Day	Gas-Oil Ratio Cu FT/BBL	Water BBL/Day	Pumpin or Flowing	Initial Shut- In Pressure	Choke Size	Flow Tubing Pressure
There are no Initial Data records to display.										
Completion and Test Data by Producing Formation										
Formation Name: OSBORN Code: 404OSBR Class: OIL										
Spacing Orders					Perforated Intervals					
Order No		Unit Size			From		To			
720130		UNIT			9196		9208			
					9212		9226			
Acid Volumes					Fracture Treatments					
There are no Acid Volume records to display.					There are no Fracture Treatments records to display.					

Formation	Top
GIBSON	8643
HART	8936
OSBORN	9190

Were open hole logs run? Yes
Date last log run:

Were unusual drilling circumstances encountered? No
Explanation:

Other Remarks
ORIGINAL WELL NAME GOODRICH 1. PRODUCTION UNIT NUMBER 087-31109. EFFECTIVE DATE OF UNITIZATION FEBRUARY 1, 2022. PREVIOUS HART PERFORATIONS SQUEEZED AS PER ATTACHED 1002C.

FOR COMMISSION USE ONLY	
Status: Accepted	1148159

API NO. 35-087-35907
OTC PROD. UNIT NO. TBD

Oil and Gas Conservation Division
P.O. Box 52000
Oklahoma City, OK 73152-2000
405-521-2331
OCCCentralProcessing@OCC.OK.GOV



OKLAHOMA
Corporation
Commission

RECEIVED
Form 1002A
Rev. 2021

MAY 13 2022

ORIGINAL
AMENDED (Reason) Unitized, change lease name & well #: Hart squeeze off

Rule 165:10-3-25

COMPLETION REPORT

TYPE OF DRILLING OPERATION

☒ STRAIGHT HOLE ☐ DIRECTIONAL HOLE ☐ HORIZONTAL HOLE
☐ SERVICE WELL

If directional or horizontal, see reverse for bottom hole location.

COUNTY	McClain	SP	27	TWP	8N	RGE	3W	SPUD DATE	08/05/1964
LEASE NAME	West Goldsby Osborn Unit			WELL NO.	T-5-W-2			DRLG FINISHED DATE	08/30/1964
C	1/4 SW	1/4 SE	1/4 NE	FSL	330	FWL	1650	DATE OF WELL COMPLETION	09/30/1964
ELEVATION	1269	Ground	1258	Latitude	35°7'31.56"N			1st PROD DATE	09/04/1964
Derrick FL				Longitude	97°29'52.11"W				
OPERATOR NAME	Twisted Oak Operating, LLC				OTC / OCC OPERATOR NO.	22261			
ADDRESS	700 NW 5th Street								
CITY	Oklahoma City			STATE	OK	ZIP	73102		

OKLAHOMA CORPORATION
COMMISSION

640 Acres

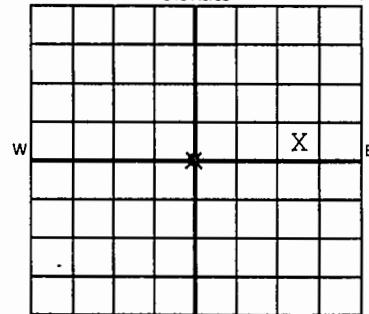

LOCATE WELL

COMPLETION TYPE

<input checked="" type="radio"/> SINGLE ZONE	
<input type="radio"/> MULTIPLE ZONE	
<input type="radio"/> COMMINGLED	
LOCATION EXCEPTION ORDER NO.	
MULTIUNIT ORDER NO.	
INCREASED DENSITY ORDER NO.	

CASING & CEMENT (Attach Form 1002C)

TYPE	SIZE	WEIGHT	GRADE	FEET	PSI	SAX	TOP OF CMT
CONDUCTOR							
SURFACE	10 3/4	40.5		707		550	surface
INTERMEDIATE							
PRODUCTION	5 1/2	17		9350		400	
LINER							

PACKER @ 9130' BRAND & TYPE Baker Model D PLUG @ TYPE PLUG @ TYPE
PACKER @ BRAND & TYPE PLUG @ TYPE PLUG @ TYPE

TOTAL DEPTH 9352

COMPLETION & TEST DATA BY PRODUCING FORMATION

FORMATION	Osborn
SPACING & SPACING ORDER NUMBER	Unit #720130, 1520 acres
CLASS: Oil, Gas, Dry, Inj, Disp, Comm Disp, Svc	Oil
PERFORATED INTERVALS	9196-9208 9212-9226
ACID/VOLUME	
FRACTURE TREATMENT (Fluids/Prop Amounts)	

Min Gas Allowable (165:10-17-7)

OR

Oil Allowable (165:10-13-3)

Purchaser/Measurer

First Sales Date

INITIAL TEST DATA

INITIAL TEST DATE	
OIL-BBL/DAY	
OIL-GRAVITY (API)	
GAS-MCF/DAY	
GAS-OIL RATIO CU FT/BBL	
WATER-BBL/DAY	
PUMPING OR FLOWING	
INITIAL SHUT-IN PRESSURE	
CHOKE SIZE	
FLOW TUBING PRESSURE	

A record of the formations drilled through, and pertinent remarks are presented on the reverse. I declare that I have knowledge of the contents of this report and am authorized by my organization to make this report, which was prepared by me or under my supervision and direction, with the data and facts stated herein to be true, correct, and complete to the best of my knowledge and belief.

CSwan

SIGNATURE

P.O. Box 35888

ADDRESS

Connie Swan

NAME (PRINT OR TYPE)

Tulsa

CITY

OK

STATE

74153

ZIP

5/16/2022

DATE

(918)621-6533

PHONE NUMBER

csswan@swanderlandok.com

EMAIL ADDRESS

PLEASE TYPE OR USE BLACK INK ONLY
FORMATION RECORD

Give formation names and tops, if available, or descriptions and thickness of formations drilled through. Show intervals cored or drillstem tested.

NAMES OF FORMATIONS	TOP
Gibson	8643
Hart	8936
Osborn	9190
More details available on previous 1002-A	

LEASE NAME West Goldsby Osborn Unit WELL NO. T-5-W-2

FOR COMMISSION USE ONLY	
ITD on file <input type="checkbox"/> YES <input type="checkbox"/> NO	
APPROVED _____	DISAPPROVED _____
2) Reject Codes	

Were open hole logs run?	<input checked="" type="radio"/> yes <input type="radio"/> no
Date Last log was run	Unknown
Was CO ₂ encountered?	<input type="radio"/> yes <input checked="" type="radio"/> no at what depths? _____
Was H ₂ S encountered?	<input type="radio"/> yes <input checked="" type="radio"/> no at what depths? _____
Were unusual drilling circumstances encountered?	<input type="radio"/> yes <input checked="" type="radio"/> no
If yes, briefly explain below	

Other remarks: Original well name Goodrich #1, Production Unit Number 087-31109.

Effective date of unitization 2/1/2022.

Previous Hart perms squeezed as per attached 1002C.

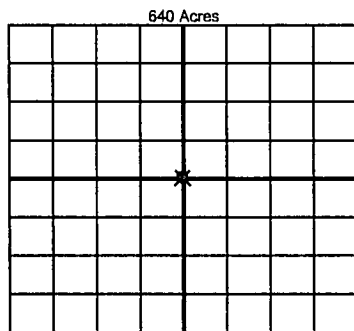

If more than three drainholes are proposed, attach a separate sheet indicating the necessary information.

Direction must be stated in degrees azimuth. Please note, the horizontal drainhole and its end point must be located within the boundaries of the lease or spacing unit.

Directional surveys are required for all drainholes and directional wells

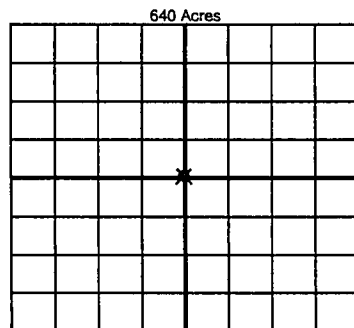

BOTTOM HOLE LOCATION FOR DIRECTIONAL HOLE

SEC	TWP	RGE	COUNTY
1/4	1/4	1/4	1/4
Measured Total Depth		True Vertical Depth	BHL From Lease, Unit, or Property Line:

BOTTOM HOLE LOCATION FOR HORIZONTAL HOLE: (LATERALS)

LATERAL #1			
SEC	TWP	RGE	COUNTY
1/4	1/4	1/4	1/4
Depth of Deviation		Radius of Turn	Direction
Measured Total Depth		True Vertical Depth	Total Length
		BHL From Lease, Unit, or Property Line:	

LATERAL #2			
SEC	TWP	RGE	COUNTY
1/4	1/4	1/4	1/4
Depth of Deviation		Radius of Turn	Direction
Measured Total Depth		True Vertical Depth	Total Length
		BHL From Lease, Unit, or Property Line:	

LATERAL #3			
SEC	TWP	RGE	COUNTY
1/4	1/4	1/4	1/4
Depth of Deviation		Radius of Turn	Direction
Measured Total Depth		True Vertical Depth	Total Length
		BHL From Lease, Unit, or Property Line:	