

Oklahoma Corporation Commission
Oil & Gas Conservation Division
Post Office Box 52000
Oklahoma City, Oklahoma 73152-2000
Rule 165: 10-3-25

Form 1002A

API No.: 35037184950001

Completion Report

Spud Date: October 09, 1924

OTC Prod. Unit No.:

Drilling Finished Date: November 27, 1924

Amended

1st Prod Date: December 03, 1924

Amend Reason: DEEPEN / SET 4 1/2" CASING

Completion Date: December 03, 1924

Recomplete Date: March 15, 2019

Drill Type: STRAIGHT HOLE

Well Name: GENERAL LEE 2

Purchaser/Measurer:

Location: CREEK 27 15N 10E
SW SE NW NE
1503 FSL 955 FWL of 1/4 SEC
Derrick Elevation: 0 Ground Elevation: 777

First Sales Date:

Operator: WFD OIL CORPORATION 17501

16800 CONIFER LN
EDMOND, OK 73012-0619

Completion Type		Location Exception		Increased Density	
X	Single Zone	Order No		Order No	
	Multiple Zone	There are no Location Exception records to display.		There are no Increased Density records to display.	
	Commingled				

Casing and Cement							
Type	Size	Weight	Grade	Feet	PSI	SAX	Top of CMT
SURFACE	7	23	USED	774			SURFACE
PRODUCTION	4 1/2	11.5	NEW	3120		75	2690

Liner								
Type	Size	Weight	Grade	Length	PSI	SAX	Top Depth	Bottom Depth
There are no Liner records to display.								

Total Depth: 3131

Packer	
Depth	Brand & Type
There are no Packer records to display.	

Plug	
Depth	Plug Type
There are no Plug records to display.	

Initial Test Data										
Test Date	Formation	Oil BBL/Day	Oil-Gravity (API)	Gas MCF/Day	Gas-Oil Ratio Cu FT/BBL	Water BBL/Day	Pumpin or Flowing	Initial Shut-In Pressure	Choke Size	Flow Tubing Pressure
Mar 01, 2019	WILCOX	15	40			5	PUMPING			

Completion and Test Data by Producing Formation

Formation Name: WILCOX

Code: 202WLCX

Class: OIL

Spacing Orders

Order No	Unit Size
NOT SPACED	

Perforated Intervals

From	To
There are no Perf. Intervals records to display.	

Acid Volumes

NONE

Fracture Treatments

NONE

Formation	Top
WOODFORD SHALE	3040
MISENER SS	3062
SYLVAN SHALE	3084
VIOLA LS	3105
WILCOX SS	3131

Were open hole logs run? Yes

Date last log run: January 24, 2019

Were unusual drilling circumstances encountered? No

Explanation:

Other Remarks

OCC - THIS WELL IS AN OPEN HOLE COMPLETION FROM BOTTOM OF THE 4 1/2" CASING AT 3,120' TO TOTAL DEPTH AT 3,131'. WELL NAME FORMERLY BEN SEWELL 1.

FOR COMMISSION USE ONLY

1142286

Status: Accepted

API NO. 037-18495
OTC PROD.
UNIT NO.

(PLEASE TYPE OR USE BLACK INK ONLY)

OKLAHOMA CORPORATION COMMISSION

Oil & Gas Conservation Division

Post Office Box 52000

Oklahoma City, Oklahoma 73152-2000

Rule 165:10-3-25

RECEIVED

MAR 11 2019

Form 1002A

Rev. 2009

☐ ORIGINAL
☒ AMENDED (Reason)

TYPE OF DRILLING OPERATION

☒ STRAIGHT HOLE ☐ DIRECTIONAL HOLE ☐ HORIZONTAL HOLE
☐ SERVICE WELL

If directional or horizontal, see reverse for bottom hole location.

COUNTY Creek SEC 27 TWP 15N RGE 10E
LEASE NAME General Lee
SW 1/4 SE 1/4 NW 1/4 NE 1/4 FSL 1503 FWL OF 1/4 SEC 955
ELEVATION Ground 777 Latitude (if known)
OPERATOR NAME WFD Oil Corporation OTC / OCC OPERATOR NO. 17501
ADDRESS 16800 Conifer Lane
CITY Edmond STATE OK ZIP 73012

COMPLETION REPORT

SPUD DATE 10-9-1924 12-2-18
DRLG FINISHED DATE 11-27-1924 1-18-19
DATE OF WELL COMPLETION 12-3-1924 2-25-19
1st PROD DATE 12-3-1924 3-15-19
RECOMP DATE 3-15-19

OKLAHOMA CORPORATION COMMISSION

640 Acres

LOCATE WELL

COMPLETION TYPE

☒ SINGLE ZONE
☐ MULTIPLE ZONE
Application Date
☐ COMMINGLED
Application Date
LOCATION EXCEPTION ORDER NO.
INCREASED DENSITY ORDER NO.

CASING & CEMENT (Attach Form 1002C)

TYPE	SIZE	WEIGHT	GRADE	FEET	PSI	SAX	TOP OF CMT
CONDUCTOR							
SURFACE	7	23	used	774	-	-	surface
INTERMEDIATE							
PRODUCTION	4 1/2	11.5	new	3120	-	75	2690
LINER							

PACKER @ BRAND & TYPE PLUG @ TYPE PLUG @ TYPE
PACKER @ BRAND & TYPE PLUG @ TYPE PLUG @ TYPE

TOTAL DEPTH 3131

see
Names of firms
2nd page

COMPLETION & TEST DATA BY PRODUCING FORMATION

FORMATION	Wilcox					No Frac
SPACING & SPACING ORDER NUMBER	NS					
CLASS: Oil, Gas, Dry, Inj, Disp, Comm Disp, Svc	Oil					
PERFORATED INTERVALS	Open Hole					
ACID/VOLUME	0 None					
FRACTURE TREATMENT (Fluids/Prop Amounts)	0 None					

Min Gas Allowable (165:10-17-7)

Gas Purchaser/Measurer

☐

OR

First Sales Date

INITIAL TEST DATA

Oil Allowable (165:10-13-3)

INITIAL TEST DATE	3/1/2019					
OIL-BBL/DAY	15					
OIL-GRAVITY (API)	40					
GAS-MCF/DAY	TSTM					
GAS-OIL RATIO CU FT/BBL	-					
WATER-BBL/DAY	5					
PUMPING OR FLOWING	Pumping					
INITIAL SHUT-IN PRESSURE						
CHOKE SIZE						
FLOW TUBING PRESSURE						

AS SUBMITTED

A record of the formations drilled through and pertinent remarks are presented on the reverse. I declare that I have knowledge of the contents of this report and am authorized by my organization to make this report, which was prepared by me or under my supervision and direction, with the data and facts stated herein to be true, correct, and complete to the best of my knowledge and belief.

William F. Dost, Jr.

3/15/2019

405-715-3130

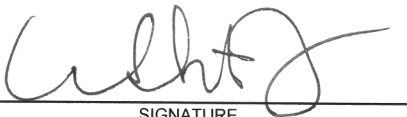

SIGNATURE

16800 Conifer Lane

ADDRESS



NAME (PRINT OR TYPE)

Edmond

CITY

OK

STATE

73012

ZIP



DATE

PHONE NUMBER

Bdost.wfd@coxinet.net

EMAIL ADDRESS

PLEASE TYPE OR USE BLACK INK ONLY

FORMATION RECORD

Give formation names and tops, if available, or descriptions and thickness of formations drilled through. Show intervals cored or drillstem tested.

NAMES OF FORMATIONS	TOP
Woodford SH	3,040
Misener SS	3,062
Sylvan SH	3,084
Viola LS	3,105
Wilcox SS	3,131
TD	3,131

LEASE NAME General Le WELL NO. 2

FOR COMMISSION USE ONLY	
ITD on file <input type="checkbox"/> YES <input type="checkbox"/> NO	
APPROVED _____ DISAPPROVED _____	2) Reject Codes

Were open hole logs run?	<input checked="" type="checkbox"/> yes <input type="checkbox"/> no
Date Last log was run	<u>1/24/2019</u>
Was CO ₂ encountered?	<input type="checkbox"/> yes <input checked="" type="checkbox"/> no at what depths? _____
Was H ₂ S encountered?	<input type="checkbox"/> yes <input checked="" type="checkbox"/> no at what depths? _____
Were unusual drilling circumstances encountered?	<input type="checkbox"/> yes <input checked="" type="checkbox"/> no
If yes, briefly explain below	

Other remarks: OCC - This well is an open hole completion from bottom of the 4 1/2" casing at 3120' to total depth at 3131'. OCC - formerly Ben Sewell #1

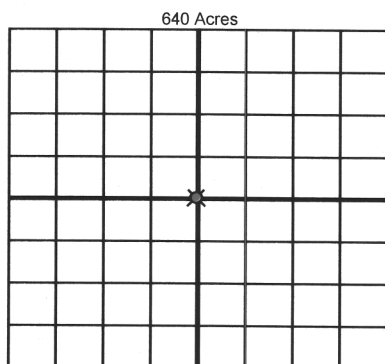

If more than three drainholes are proposed, attach a separate sheet indicating the necessary information.

Direction must be stated in degrees azimuth. Please note, the horizontal drainhole and its end point must be located within the boundaries of the lease or spacing unit.

Directional surveys are required for all drainholes and directional wells.

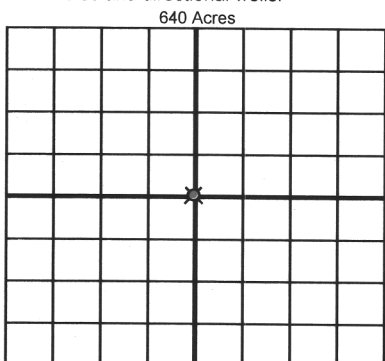

BOTTOM HOLE LOCATION FOR DIRECTIONAL HOLE

SEC	TWP	RGE	COUNTY
Spot Location			
1/4	1/4	1/4	1/4
Measured Total Depth		True Vertical Depth	BHL From Lease, Unit, or Property Line:

BOTTOM HOLE LOCATION FOR HORIZONTAL HOLE: (LATERALS)

LATERAL #1

SEC	TWP	RGE	COUNTY
Spot Location			
1/4	1/4	1/4	1/4
Depth of Deviation		Radius of Turn	Direction
Measured Total Depth		True Vertical Depth	BHL From Lease, Unit, or Property Line:

LATERAL #2

SEC	TWP	RGE	COUNTY
Spot Location			
1/4	1/4	1/4	1/4
Depth of Deviation		Radius of Turn	Direction
Measured Total Depth		True Vertical Depth	BHL From Lease, Unit, or Property Line:

LATERAL #3

SEC	TWP	RGE	COUNTY
Spot Location			
1/4	1/4	1/4	1/4
Depth of Deviation		Radius of Turn	Direction
Measured Total Depth		True Vertical Depth	BHL From Lease, Unit, or Property Line: