

Oklahoma Corporation Commission
Oil & Gas Conservation Division
Post Office Box 52000
Oklahoma City, Oklahoma 73152-2000
Rule 165: 10-3-25

Form 1002A

API No.: 35029213910000

Completion Report

Spud Date: February 01, 2019

OTC Prod. Unit No.: 029-225259-0-0000

Drilling Finished Date: March 07, 2019

1st Prod Date: May 20, 2019

Completion Date: May 08, 2019

Drill Type: HORIZONTAL HOLE

Well Name: TOMLINSON XLE 3H-23

Purchaser/Measurer: ATOKA MIDSTREAM LLC

Location: COAL 23 1N 9E
NW SW SE SE
471 FSL 1013 FEL of 1/4 SEC
Latitude: 34.328736 Longitude: -96.1920922
Derrick Elevation: 671 Ground Elevation: 649

First Sales Date: 05/20/2019

Operator: PABLO ENERGY II LLC 21896
PO BOX 2945
801 S FILLMORE AVE STE 130
AMARILLO, TX 79105-2945

Completion Type		Location Exception		Increased Density	
X	Single Zone	Order No		Order No	
	Multiple Zone	698588		695985	
	Commingled				

Casing and Cement							
Type	Size	Weight	Grade	Feet	PSI	SAX	Top of CMT
CONDUCTOR	20			40		2	SURFACE
SURFACE	9 5/8	40	J-55	492		175	SURFACE
PRODUCTION	5 1/2	20	P-110	14395	800	1695	4120

Liner								
Type	Size	Weight	Grade	Length	PSI	SAX	Top Depth	Bottom Depth
There are no Liner records to display.								

Total Depth: 14420

Packer	
Depth	Brand & Type
There are no Packer records to display.	

Plug	
Depth	Plug Type
There are no Plug records to display.	

Initial Test Data

Test Date	Formation	Oil BBL/Day	Oil-Gravity (API)	Gas MCF/Day	Gas-Oil Ratio Cu FT/BBL	Water BBL/Day	Pumpin or Flowing	Initial Shut-In Pressure	Choke Size	Flow Tubing Pressure
May 23, 2019	WOODFORD	5	42	4284	856800	1221	FLOWING	1200	44/64	805

Completion and Test Data by Producing Formation

Formation Name: WOODFORD

Code: 319WDFD

Class: GAS

Spacing Orders

Order No	Unit Size
634608	480

Perforated Intervals

From	To
7100	14300

Acid Volumes

48,787 GALLONS 15% HCL

Fracture Treatments

215,591 BARRELS SLICK WATER, 7,287,475 POUNDS 40/70 SAND
--

Formation	Top
WAPANUCKA	4890
CROMWELL	5675
CANEY	6075
WOODFORD A1	6341
WOODFORD A2	6446

Were open hole logs run? No

Date last log run: March 05, 2019

Were unusual drilling circumstances encountered? No

Explanation:

Other Remarks

OCC - THIS WELL IS COMPLETED IN AN IRREGULAR SPACED 480 ACRE UNIT COMPRISING OF SE/4 SECTION 14 AND E/2 SECTION 23-1N-9W.

Lateral Holes

Sec: 14 TWP: 1N RGE: 9E County: COAL

NW NE NE SE

274 FNL 390 FEL of 1/4 SEC

Depth of Deviation: 6046 Radius of Turn: 550 Direction: 359 Total Length: 7510

Measured Total Depth: 14420 True Vertical Depth: 6847 End Pt. Location From Release, Unit or Property Line: 274

FOR COMMISSION USE ONLY

1143147

Status: Accepted

API NO. 029 21391
OTC PROD. 029 - 225259
UNIT NO.

(PLEASE TYPE OR USE BLACK INK ONLY)

OKLAHOMA CORPORATION COMMISSION

Oil & Gas Conservation Division
Post Office Box 52000

Oklahoma City, Oklahoma 73152-2000
Rule 165:10-3-25

RECEIVED

JUN 19 2019

Oklahoma Corporation
Commission

Form 1002A
Rev. 2009

☒ ORIGINAL
☐ AMENDED (Reason)

COMPLETION REPORT

TYPE OF DRILLING OPERATION

☐ STRAIGHT HOLE ☐ DIRECTIONAL HOLE ☒ HORIZONTAL HOLE
☐ SERVICE WELL

If directional or horizontal, see reverse for bottom hole location.

COUNTY	COAL	SEC	23	TWP	1N	RGE	9E	SPUD DATE	02/01/19
LEASE NAME	TOMLINSON XLE							DRG FINISHED DATE	03/07/19
NW 1/4 SW 1/4 SE 1/4 SE 1/4	FSL OF 1/4 SEC		471	WELL NO.	3H-23	1st PROD DATE		05/20/19	
ELEVATION	671	Ground	649	Latitude (if known)	34.328736	Longitude (if known)		-96.1920922	
OPERATOR NAME	PABLO ENERGY II, LLC							OTC / OCC OPERATOR NO.	21896 0
ADDRESS	PO BOX 2945								
CITY	AMARILLO	STATE	TX	ZIP	79105				

640 Acres									
W E									
LOCATE WELL									

COMPLETION TYPE

<input checked="" type="checkbox"/> SINGLE ZONE	
<input type="checkbox"/> MULTIPLE ZONE	
<input type="checkbox"/> COMMINGLED	
LOCATION EXCEPTION ORDER NO.	690626
INCREASED DENSITY ORDER NO.	692277

CASING & CEMENT (Attach Form 1002C)

TYPE	SIZE	WEIGHT	GRADE	FEET	PSI	SAX	TOP OF CMT
CONDUCTOR	20'			40'		2.5 yds	SURFACE
SURFACE	9 5/8"	40	J-55	492' GL		175	SURFACE
INTERMEDIATE							
PRODUCTION	5 1/2	20	P-110	14395' KB	800	1695	4120' (log)
LINER							
							14420'

PACKER @ _____ BRAND & TYPE _____ PLUG @ _____ TYPE _____ PLUG @ _____ TYPE _____
PACKER @ _____ BRAND & TYPE _____ PLUG @ _____ TYPE _____ PLUG @ _____ TYPE _____

COMPLETION & TEST DATA BY PRODUCING FORMATION

319WDFD

FORMATION	WOODFORD						
SPACING & SPACING ORDER NUMBER	480 ACRES 634608						
CLASS: Oil, Gas, Dry, Inj, Disp, Comm Disp, Svc	GAS						
PERFORATED INTERVALS	14300-14200 14060-13910 11329-11176 11086-10937 8449-8299 8209-8059	13820-13670 13580-13430 10847-10697 10607-10457 7959-7819 7729-7580	13340-13265 13090-12910 10367-10217 10127-9977 7490-7340 7250-7100	12805-12625 12525-12375 9887-9738 9648-9498	12285-12135 12040-11896 9408-9258 9158-9018	11806-11656 11566-11416 8928-8778 8688-8530	
ACID/VOLUME	48,787 gals 15% HCL						
FRACTURE TREATMENT (Fluids/Prop Amounts)	215,591 bbls slick water	7,287,475 lbs 40/70 sand					

Monitor Report
to Frac Focus

Min Gas Allowable (165:10-17-7)
OR
Oil Allowable (165:10-13-3)

Gas Purchaser/Measurer
First Sales Date

ATOKA MIDSTEAM, LLC
5/20/2019

INITIAL TEST DATA

INITIAL TEST DATE	5/23/2019				
OIL-BBL/DAY	5				
OIL-GRAVITY (API)	42				
GAS-MCF/DAY	4284				
GAS-OIL RATIO CU FT/BBL	856800				
WATER-BBL/DAY	1221				
PUMPING OR FLOWING	flowing				
INITIAL SHUT-IN PRESSURE	1200				
CHOKE SIZE	44/64				
FLOW TUBING PRESSURE	805				

AS SUBMITTED

A record of the formations drilled through, and pertinent remarks are presented on the reverse. I declare that I have knowledge of the contents of this report and am authorized by my organization to make this report, which was prepared by me or under my supervision and direction, with the data and facts stated herein to be true, correct, and complete to the best of my knowledge and belief.

GARY E. WURDEMAN

SIGNATURE

NAME (PRINT OR TYPE)

DATE

PHONE NUMBER

1759 W. 33RD STREET, STE 120

EDMOND

OK

73013

gary.w@pabloenergy.com

ADDRESS

CITY

STATE

ZIP

EMAIL ADDRESS

PLEASE TYPE OR USE BLACK INK ONLY
FORMATION RECORD

Give formation names and tops, if available, or descriptions and thickness of formations drilled through. Show intervals cored or drillstem tested.

LEASE NAME TOMLINSON XLE

WELL NO. 3H-23

NAMES OF FORMATIONS	TOP
WAPANUCKA	4890' TVD
CROMWELL	5675' TVD
CANEY	6075 TVD
WOODFORD A1	6341' TVD
WOODFORD A2	6446' TVD

FOR COMMISSION USE ONLY

ITD on file ☐ YES ☐ NO

APPROVED _____ DISAPPROVED _____

2) Reject Codes _____

Were open hole logs run? _____ yes ☒ no

Date Last log was run Geological mud log -3/5/19

Was CO₂ encountered? _____ yes ☒ no at what depths? _____

Was H₂S encountered? _____ yes ☒ no at what depths? _____

Were unusual drilling circumstances encountered? _____ yes ☒ no
If yes, briefly explain below

Other remarks: OCC - This well is completed in an irregular 480 acre unit comprising of SE 1/4 Sec 14 & E 1/2 Sec 23 - 1N-9E

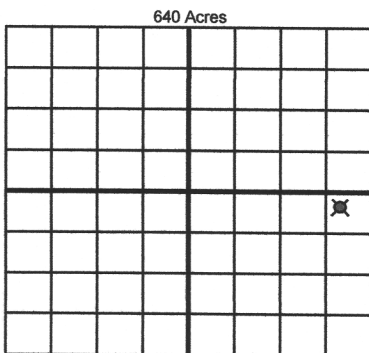

If more than three drainholes are proposed, attach a separate sheet indicating the necessary information.

Direction must be stated in degrees azimuth.
Please note, the horizontal drainhole and its end point must be located within the boundaries of the lease or spacing unit.

Directional surveys are required for all drainholes and directional wells.

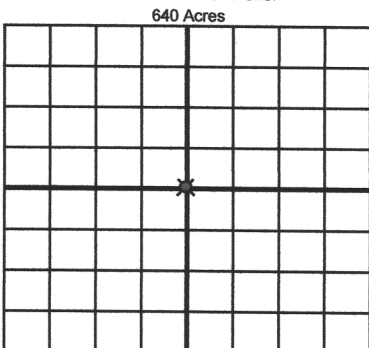

BOTTOM HOLE LOCATION FOR DIRECTIONAL HOLE

SEC	TWP	RGE	COUNTY
Spot Location			
1/4	1/4	1/4	1/4
Measured Total Depth		True Vertical Depth	BHL From Lease, Unit, or Property Line:

BOTTOM HOLE LOCATION FOR HORIZONTAL HOLE: (LATERALS)

LATERAL #1

SEC	TWP	RGE	COUNTY	COAL
14	1N	9E		<u>274FNL 390FNL</u>
Spot Location				
NW	NE	SE		
1/4	1/4	1/4		
Depth of Deviation		Radius of Turn	Direction	Total Length
6046'		550	<u>359.5 deg</u>	<u>7510'</u>
Measured Total Depth		True Vertical Depth	BHL From Lease, Unit, or Property Line:	
14420'		6,847	<u>285' 274</u>	

LATERAL #2

SEC	TWP	RGE	COUNTY
Spot Location			
1/4	1/4	1/4	1/4
Depth of Deviation		Radius of Turn	Direction
Measured Total Depth		True Vertical Depth	BHL From Lease, Unit, or Property Line:

LATERAL #3

SEC	TWP	RGE	COUNTY
Spot Location			
1/4	1/4	1/4	1/4
Depth of Deviation		Radius of Turn	Direction
Measured Total Depth		True Vertical Depth	BHL From Lease, Unit, or Property Line:

TEST: ☒ INITIAL
☐ ANNUAL
☐ RETEST

OKLAHOMA CORPORATION COMMISSION
Oil & Gas Conservation Division
Post Office Box 52000
Oklahoma City, Oklahoma 73152-2000

RECEIVED

Form 1016
Rev. 2018

JUN 19 2019

Oklahoma Corporation
Commission

BACK PRESSURE TEST FOR NATURAL GAS WELLS

OAC 165:10-17-6

DATE OF TEST:

6/5/2019

DATE OF 1ST SALES: 5/20/2019

Operator PABLO ENERGY II, LLC				Operator # 21896-0	
Address 1759 WEST 33RD ST, SUITE 120			City EDMOND	ST OK	ZIP 73013
E-mail gary.w@pabloenergy.com		Ph 405-513-7121	Fax	Well Name/# Tomlinson XLE 3H-23	
Gas Volumes to be Reported to OCC by: BlueMark			Gas Volume Reporter # 24180	API # 029-21394	
Producing Zone WOODFORD 319 WDFD			OTC Lease # 029-225259		
Surface Location 471' FSL, 1013' FEL	1/4 SW 1/4 SE 1/4 SE 1/4	Sec 23	Twp 1N	Rge 9E	(OCC use) Allowable # 225259 I
Zone Location (if different) 2377' FSL, 391' FEL	1/4 NE 1/4 NE 1/4 SE 1/4	Sec 14	Twp 1N	Rge 9E	County COAL
Field W. COALGATE				Spacing Size 480	

COMPLETION: ☒ Single ☐ Multiple Zone ☐ Commingled ☐ Recompletion Date of Completion **05/08/19**

Total Depth 14420'	Plug Back Depth 14318'	Packer Set Depth	Elevation 649' G.L.
Csg Size 5 1/2"	WT 20.0	d 4.778	Perfs. 7100'-14300'
Tbg Size 2 3/8"	WT 4.7	d 1.995	Perfs.
Prod. Thru CASING	Res. Temp. F 165	@ 10700	Mean Grd. Temp. F 60.0
L 10700	H 10700	C _g .6869	%CO ₂ .497
%N ₂ 1.257	H ₂ S(ppm)	Prover	Meter Run X
			Taps FLANGE

SHUT-IN DATA		FLOW DATA						TUBING DATA		CASING DATA		BHP DATA		FLOW (HRS)
		PROVER			DIFF									
PRESS	(HRS)	LINE SIZE	X	ORIFICE SIZE	PRESS (PSIG)	(INCHES) (ROOTS)	TEMP (F)	PRESS (PSIG)	TEMP (F)	PRESS (PSIG)	TEMP (F)	PRESS (PSIG)	TEMP (F)	
1059	24	3.068		1.875	122	262	85	893	80	590	80			24

RATE OF FLOW CALCULATIONS

COEFFICIENT (24 HOUR)	$\sqrt{h_w P_m}$	PRESSURE P _m	FLOW TEMP. FACTOR F _t	GRAVITY FACTOR F _g	SUPER COMPRESS FACTOR F _{pw}	RATE OF FLOW (Q) MCFD
18.75	189.0418	136.4	.9768	1.2066	1.0122	4228

P _i	TEMP. R	T _i	Z
.2045	544.7	1.4265	.9760

Gas/Liquid Hydrocarbon Ratio	234.92	MCF/BBL
API Gravity of Liquid Hydrocarbons	60	Deg.
Specific Gravity Separator Gas	.6869	Specific Gravity Flowing Fluid
	.6989	
Critical Pressure	667.06	PSIA
	666.62	PSIA
Critical Temperature	381.81	R
	385.5	R

P_c **1073.4** (PSIA) P_c² **1152.19**

P _w	P _w ²	P _c ² - P _w ²
604.4	365.30	786.89

[1] $\frac{P_c^2}{P_c^2 - P_w^2} = \frac{1.4642}{(Not\ to\ exceed\ 5.263)}$

[2] $\left| \frac{P_c^2}{P_c^2 - P_w^2} \right|^n = 1.3828$ WHAOF=Q

$\left| \frac{P_c^2}{P_c^2 - P_w^2} \right|^n = \frac{5847}{5895}$

Calculated wellhead open flow **5847** MCFD @ 14.65 Angle of Slope Slope, n **.850**

Remarks **Conducted Test Backwards, Well is being produced through the casing.**

Oil Produced **18 BBLs** Water Produced **524 BBLs**

Irregular 480-acre unit; SE Sec. 14 & E2 Sec. 13.

Approved by Commission: *DR* Conducted by: **Clint Sorrells** Calculated by: **Thurmond McGlothlin** Checked by:

WITNESSED - OCC FIELD STAFF: Y ☒ N ☐ NAME: **Del Lynch** (over) DATE: **06/05/2019**

NA✓ E2

DR

IF THE ALLOWABLE FOR THIS WELL HAS BEEN ADJUSTED BY COMMISSION ORDER, PLEASE GIVE THE ORDER NUMBER(S) IN ONE OR MORE OF THE CATEGORIES BELOW:

INCREASED DENSITY 692277 LOCATION EXCEPTION *
COMMINGLING MULTIPLE ZONE
SEPARATE OR SPECIAL ALLOWABLE *
OTHER PENALTY ORDER(S) *

* FOR THESE ORDER TYPES, PLEASE DESCRIBE ALLOWABLES AND/OR PENALTIES:

I declare that I have knowledge of the contents of this report and am authorized by my organization to make this report, which was prepared by me or under my supervision and direction, with the data and facts stated herein to be true, correct and complete to the best of my knowledge and belief.

SIGNATURE	<u>Thurmond McGlothlin</u>	TITLE	<u>Manager</u>
COMPANY	<u>Thurmond McGlothlin</u>	DATE	<u>06/13/19</u>
		PHONE NO.	<u>580-256-9849</u>

- Pc SHUT-IN PRESSURE, PSIA (LENGTH OF SHUT-IN MINIMUM OF 24 HOURS).
- Pw STATIC COLUMN WELLHEAD PRESSURE CORRESPONDING TO THE FLOWING WELLHEAD PRESSURE, PSIA (TO BE RECORDED AT END OF EACH FLOW RATE.) THE VALUE OF Pw SHOULD NOT EXCEED 90% OF Pc.
- Gg SPECIFIC GRAVITY OF SEPARATOR GAS (AIR = 1.000).
- L LENGTH OF THE FLOW STRING FROM THE MIDDLE OF THE PRODUCING FORMATION TO THE PRESSURE POINT AT WELLHEAD, FEET.
- H VERTICAL DEPTH CORRESPONDING TO L, FEET.
- Q 24 HOUR RATE OF FLOW, MCF/D.
- d INSIDE DIAMETER, INCHES.
- R DEGREES, RANKINE (DEGREES FAHRENHEIT ABSOLUTE).
- Pr REDUCED PRESSURE, DIMENSIONLESS.
- Tr REDUCED TEMPERATURE, DIMENSIONLESS.
- Z COMPRESSIBILITY FACTOR, DIMENSIONLESS.