

Oklahoma Corporation Commission
Oil & Gas Conservation Division
Post Office Box 52000
Oklahoma City, Oklahoma 73152-2000
Rule 165: 10-3-25

Form 1002A

API No.: 35103219150002

Completion Report

Spud Date: December 19, 1982

OTC Prod. Unit No.: 103-080801

Drilling Finished Date: January 02, 1983

Amended

1st Prod Date: May 17, 1983

Amend Reason: RECOMPLETION / RUN LINER / RE-PERFORATE / NEW FRAC

Completion Date: May 15, 1983

Recomplete Date: October 28, 2019

Drill Type: STRAIGHT HOLE

Well Name: MURPHY 1

Purchaser/Measurer:

Location: NOBLE 18 22N 2W
C NE SE SE
990 FSL 2310 FWL of 1/4 SEC
Latitude: 36.37872 Longitude: -97.44432
Derrick Elevation: 1083 Ground Elevation: 1073

First Sales Date:

Operator: DAVIDSON ENERGY INC 17058
PO BOX 782
621 DELAWARE
PERRY, OK 73077-0782

Completion Type		Location Exception		Increased Density	
X	Single Zone	Order No		Order No	
	Multiple Zone	There are no Location Exception records to display.		There are no Increased Density records to display.	
	Commingled				

Casing and Cement							
Type	Size	Weight	Grade	Feet	PSI	SAX	Top of CMT
SURFACE	8 5/8	24	K-55	370	1000	321	SURFACE
PRODUCTION	4 1/2	11.6	J-55	5261	4700	360	4080

Liner								
Type	Size	Weight	Grade	Length	PSI	SAX	Top Depth	Bottom Depth
LINER	1/2	9.3	P-110	0	1700	55	SURFACE	

Total Depth: 5474

Packer		Plug	
Depth	Brand & Type	Depth	Plug Type
There are no Packer records to display.		4902	CIBP

Initial Test Data

Test Date	Formation	Oil BBL/Day	Oil-Gravity (API)	Gas MCF/Day	Gas-Oil Ratio Cu FT/BBL	Water BBL/Day	Pumpin or Flowing	Initial Shut-In Pressure	Choke Size	Flow Tubing Pressure
May 16, 1983	LAYTON LOW	51	42			10	PUMPING		OPEN	60
Nov 30, 2019	LAYTON LOW	7	42			93	PUMPING		OPEN	35

Completion and Test Data by Producing Formation									
Formation Name: LAYTON LOW				Code: 405LYTNL			Class: OIL		
Spacing Orders				Perforated Intervals					
Order No		Unit Size		From			To		
NONE				4246			4264		
Acid Volumes				Fracture Treatments					
500 GALLONS 15% HCL				18,220 GALLONS DIESEL, 285 SACKS 10/20					

Formation Name: LAYTON LOW		Code: 405LYTNL		Class: OIL	
Spacing Orders		Perforated Intervals			
Order No	Unit Size	From	To		
NONE		4219	4274		
Acid Volumes		Fracture Treatments			
NONE		1,658 BARRELS WATER, 128,940 POUNDS 10/20			

Formation	Top
MISSISSIPPI LIME	4978
WOODFORD SHALE	5211
VIOLA LIME	5260

Were open hole logs run? Yes
 Date last log run: January 02, 1983

 Were unusual drilling circumstances encountered? No
 Explanation:

Other Remarks
OCC - NEW LINER SEALED OFF COTTONWOOD PERFORATIONS AT 1,380' - 1,390' AND ORIGINAL LAYTON PERFORATIONS. PRESENT OPERATOR FOUND TUBING DOWN TO ABOVE THE MISSISSIPPI INDICATING IT HAD BEEN OPEN AS WELL AS INDICATIONS UPPER LAYTON WAS OPEN ALSO. ALL ZONES FOR AWHILE WAS PROVIDING WATER TO A WATERFLOOD ACROSS THE ROAD. CIBP SET AT 4902 TO SEAL OFF MISSISSIPPI PERFORATIONS. ONCE LINER SET REPERFORATED LOWER LAYTON RESTIMULATED WITH NEW FRAC.

FOR COMMISSION USE ONLY
<div> <div>Status: Accepted</div> <div>1144574</div> </div>

RECEIVED

Form 1002A
Rev. 2009

API NO. 10321915
OTC PROD. UNIT NO. 103-080801

(PLEASE TYPE OR USE BLACK INK ONLY)

OKLAHOMA CORPORATION COMMISSION
Oil & Gas Conservation Division
Post Office Box 52000
Oklahoma City, Oklahoma 73152-2000
Rule 165:10-3-25

JAN 16 2020

OKLAHOMA CORPORATION COMMISSION

☐ ORIGINAL
☒ AMENDED (Reason)

re-completion / *Re-Perforate*

COMPLETION REPORT

TYPE OF DRILLING OPERATION *Run Liner / New Frac Lower Layton*
☒ STRAIGHT HOLE ☐ DIRECTIONAL HOLE ☐ HORIZONTAL HOLE

SPUD DATE 12/19/1982

If directional or horizontal, see reverse for bottom hole location.

DRLG FINISHED DATE 01/02/1983

COUNTY Noble SEC 18 TWP 22N RGE 02W DATE OF WELL COMPLETION 05/15/1983

LEASE NAME Murphy WELL NO. 1 1st PROD DATE 05/17/1983

1/4 NE 1/4 SE 1/4 SE 1/4 FSL OF 1/4 SEC 990 FWL OF 1/4 SEC 2310 RECOMP DATE 10/28/2019

ELEVATION Derrick FL 1083 Ground 1073 Latitude (if known) 36.37872 Longitude (if known) -97.44432

OPERATOR NAME Davidson Energy, Inc. OTC / OCC OPERATOR NO. 17058

ADDRESS P.O. Box 782

CITY Perry STATE OK ZIP 73077

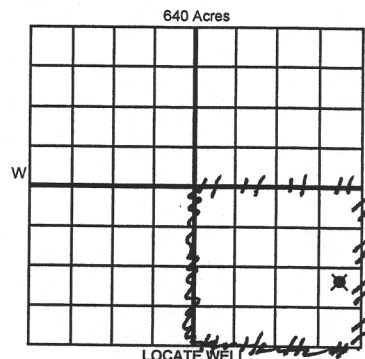

COMPLETION TYPE

<input checked="" type="checkbox"/>	SINGLE ZONE	
<input type="checkbox"/>	MULTIPLE ZONE	
<input type="checkbox"/>	Application Date	
<input type="checkbox"/>	COMINGLED	
<input type="checkbox"/>	Application Date	
<input type="checkbox"/>	LOCATION EXCEPTION ORDER NO.	
<input type="checkbox"/>	INCREASED DENSITY ORDER NO.	

CASING & CEMENT (Attach Form 1002C)

TYPE	SIZE	WEIGHT	GRADE	FEET	PSI	SAX	TOP OF CMT
CONDUCTOR							
SURFACE	8 5/8	24	K-55	370	1000	321	surface
INTERMEDIATE							
PRODUCTION	4 1/2	11.6	j-55	5261	4700	360	4080
LINER	3 1/2	9.3	p-110	5261	1700	55	2,400

PACKER @ _____ BRAND & TYPE _____

PLUG @ 4902 TYPE CIBP

PLUG @ _____ TYPE _____

TOTAL DEPTH 5,474

PACKER @ _____ BRAND & TYPE _____

PLUG @ _____ TYPE _____

PLUG @ _____ TYPE _____

COMPLETION & TEST DATA BY PRODUCING FORMATION

405LYTNL

FORMATION	Lower Layton	Lower Layton				
SPACING & SPACING ORDER NUMBER	none	none				
CLASS: Oil, Gas, Dry, Inj, Disp, Comm Disp, Svc	oil	oil				
PERFORATED INTERVALS	4246-4264	4219-4274				
ACID/VOLUME	500 h 15% HCL	none				
FRACTURE TREATMENT (Fluids/Prop Amounts)	18,220 gal diesel	2658 bbl water				
	285 saks 10/20	128940# 10/20				

☐ Min Gas Allowable OR (165:10-17-7)
☐ Oil Allowable (165:10-13-3)

Gas Purchaser/Measurer
First Sales Date

INITIAL TEST DATA

INITIAL TEST DATE	5/16/1983	11/30/2019			
OIL-BBL/DAY	51	7			
OIL-GRAVITY (API)	42	42			
GAS-MCF/DAY	none	none			
GAS-OIL RATIO CU FT/BBL					
WATER-BBL/DAY	10	93			
PUMPING OR FLOWING	pumping	pumping			
INITIAL SHUT-IN PRESSURE					
CHOKE SIZE	open	open			
FLOW TUBING PRESSURE	60	35			

AS SUBMITTED

A record of the formations drilled through, and pertinent remarks are presented on the reverse. I declare that I have knowledge of the contents of this report and am authorized by my organization to make this report, which was prepared by me or under my supervision and direction, with the data and facts stated herein to be true, correct, and complete to the best of my knowledge and belief.

Gerald W. Davidson
SIGNATURE

Gerald W. Davidson

01/15/2020 580 572-8137

P.O. Box 782

NAME (PRINT OR TYPE)

DATE PHONE NUMBER

ADDRESS

Perry

OK

73077

gerald@DavidsonEnergyInc.com

EMAIL ADDRESS

CITY

STATE

ZIP

PLEASE TYPE OR USE BLACK INK ONLY
FORMATION RECORD

Give formation names and tops, if available, or descriptions and thickness of formations drilled through. Show intervals cored or drillstem tested.

LEASE NAME _____ WELL NO. _____

NAMES OF FORMATIONS	TOP
Mississippi Lime	4,978
Woodford Shale	5211
Viola Lime	5,260
Total depth	
5414	

FOR COMMISSION USE ONLY

ITD on file ☐ YES ☐ NO

APPROVED _____ DISAPPROVED _____

2) Reject Codes _____

Were open hole logs run? ☒ yes ☐ no

Date Last log was run 1/2/1983

Was CO₂ encountered? ☐ yes ☐ no at what depths? _____

Was H₂S encountered? ☐ yes ☐ no at what depths? _____

Were unusual drilling circumstances encountered? ☐ yes ☐ no

If yes, briefly explain below _____

Other remarks: OCC - New liner sealed off Cottonwood perforations at 1380-1390'
OCC - Per present operator tubing was run to top of Mississippi
indicating well had been producing from Mississippi formation of the well.
Plugged that off with CIBP at 4902. It appeared the Upper Layton
may have also been perforated. For a while all zones being used
to provide water for waterflood across the road.

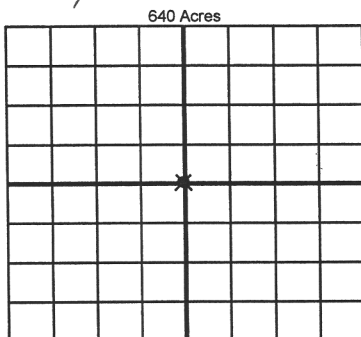

If more than three drainholes are proposed, attach a separate sheet indicating the necessary information.

Direction must be stated in degrees azimuth.
Please note, the horizontal drainhole and its end point must be located within the boundaries of the lease or spacing unit.

Directional surveys are required for all drainholes and directional wells.

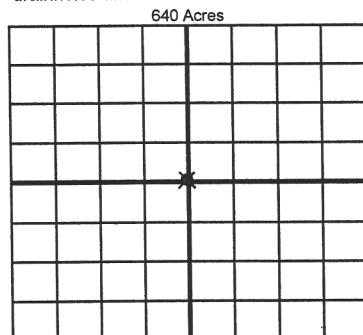

BOTTOM HOLE LOCATION FOR DIRECTIONAL HOLE

SEC	TWP	RGE	COUNTY
Spot Location			
1/4	1/4	1/4	1/4
Measured Total Depth		True Vertical Depth	BHL From Lease, Unit, or Property Line:

BOTTOM HOLE LOCATION FOR HORIZONTAL HOLE: (LATERALS)

LATERAL #1

SEC	TWP	RGE	COUNTY
Spot Location			
1/4	1/4	1/4	1/4
Depth of Deviation		Radius of Turn	Direction
Measured Total Depth		True Vertical Depth	BHL From Lease, Unit, or Property Line:

LATERAL #2

SEC	TWP	RGE	COUNTY
Spot Location			
1/4	1/4	1/4	1/4
Depth of Deviation		Radius of Turn	Direction
Measured Total Depth		True Vertical Depth	BHL From Lease, Unit, or Property Line:

LATERAL #3

SEC	TWP	RGE	COUNTY
Spot Location			
1/4	1/4	1/4	1/4
Depth of Deviation		Radius of Turn	Direction
Measured Total Depth		True Vertical Depth	BHL From Lease, Unit, or Property Line: