

Oklahoma Corporation Commission
Oil & Gas Conservation Division
Post Office Box 52000
Oklahoma City, Oklahoma 73152-2000
Rule 165: 10-3-25

Form 1002A

API No.: 35015364310003

Completion Report

Spud Date: August 01, 1955

OTC Prod. Unit No.:

Drilling Finished Date: August 13, 1955

Amended

1st Prod Date: August 20, 1955

Amend Reason: CHANGED PACKER / CORRECTED FOOTAGE LOCATION

Completion Date: August 22, 1955

Recomplete Date: January 20, 2022

Drill Type: STRAIGHT HOLE

SERVICE WELL

Well Name: HOPPIN 3

Purchaser/Measurer:

Location: CADDO 4 5N 9W
NE SW NW NE
1660 FSL 360 FWL of 1/4 SEC
Latitude: 34.939138 Longitude: -98.148388
Derrick Elevation: 0 Ground Elevation: 0

First Sales Date:

Operator: CEMOIL INC 20924
PO BOX 563
200 NORTH MAIN
CEMENT, OK 73017-0563

Completion Type		Location Exception		Increased Density	
	Single Zone	Order No		Order No	
	Multiple Zone	There are no Location Exception records to display.		There are no Increased Density records to display.	
	Commingled				

Casing and Cement							
Type	Size	Weight	Grade	Feet	PSI	SAX	Top of CMT
SURFACE	8.0			201		165	SURFACE
PRODUCTION	5.5			4005		450	SURFACE

Liner								
Type	Size	Weight	Grade	Length	PSI	SAX	Top Depth	Bottom Depth
There are no Liner records to display.								

Total Depth: 4085

Packer		Plug	
Depth	Brand & Type	Depth	Plug Type
1950	WEATHERFORD PAD-1	There are no Plug records to display.	

Initial Test Data

Test Date	Formation	Oil BBL/Day	Oil-Gravity (API)	Gas MCF/Day	Gas-Oil Ratio Cu FT/BBL	Water BBL/Day	Pumpin or Flowing	Initial Shut- In Pressure	Choke Size	Flow Tubing Pressure
-----------	-----------	----------------	----------------------	----------------	----------------------------	------------------	----------------------	---------------------------------	---------------	-------------------------

There are no Initial Data records to display.

Completion and Test Data by Producing Formation

Formation Name: FORTUNA

Code: 451FRTN

Class: COMM DISP

Spacing Orders

Order No	Unit Size
There are no Spacing Order records to display.	

Perforated Intervals

From	To
2006	2185

Acid Volumes

There are no Acid Volume records to display.
--

Fracture Treatments

There are no Fracture Treatments records to display.
--

Formation Name: CISCO

Code: 406CSCO

Class: COMM DISP

Spacing Orders

Order No	Unit Size
There are no Spacing Order records to display.	

Perforated Intervals

From	To
2192	2314

Acid Volumes

There are no Acid Volume records to display.
--

Fracture Treatments

There are no Fracture Treatments records to display.
--

Formation Name: NOBLE-OLSON

Code: 451NBLO

Class: COMM DISP

Spacing Orders

Order No	Unit Size
There are no Spacing Order records to display.	

Perforated Intervals

From	To
3126	3541

Acid Volumes

There are no Acid Volume records to display.
--

Fracture Treatments

There are no Fracture Treatments records to display.
--

Formation Name: GRIFFIN

Code: 406GRFN

Class: COMM DISP

Spacing Orders

Order No	Unit Size
There are no Spacing Order records to display.	

Perforated Intervals

From	To
3611	3676

Acid Volumes

There are no Acid Volume records to display.
--

Fracture Treatments

There are no Fracture Treatments records to display.
--

Formation Name: GARNER		Code: 406GRNR	Class: COMM DISP
Spacing Orders		Perforated Intervals	
Order No	Unit Size	From	To
There are no Spacing Order records to display.		3772	3976
Acid Volumes		Fracture Treatments	
There are no Acid Volume records to display.		There are no Fracture Treatments records to display.	

Formation	Top
FORTUNA	2006
CISCO	2192
NOBLE OLSON	3240
GRIFFIN	3611
GARNER	3772

Were open hole logs run? No
Date last log run:

Were unusual drilling circumstances encountered? No
Explanation:

Other Remarks
OCC - UIC ORDER NUMBER 347203. SEE ORDER FOR DETAIL BREAK DOWN ON PERFORATED INTERVALS. CORRECT PERFORATED INTERVAL ON NOBLE-OLSON FROM LAST 1002A. PER UIC ORDER, THE 5 1/2" CASING WAS PERFORATED AT 950' AND SQUEEZED CEMENT LIFTING IT TO SURFACE. THE CALCULATED TOP OF CEMENT BEFORE THE SQUEEZE WAS 1,273'.

FOR COMMISSION USE ONLY	
Status: Accepted	1147536

API NO. 3501536431
OTC PROD.
UNIT NO.

Oil and Gas Conservation Division
P.O. Box 52000
Oklahoma City, OK 73152-2000
405-521-2331
OCCCentralProcessing@OCC.OK.GOV



OKLAHOMA
Corporation
Commission

Form 1002A
Rev. 2021

ORIGINAL
AMENDED (Reason) Changed packer

Rule 165:10-3-25

COMPLETION REPORT

TYPE OF DRILLING OPERATION Corrected location
☒ STRAIGHT HOLE ☐ DIRECTIONAL HOLE ☐ HORIZONTAL HOLE
☒ SERVICE WELL
If directional or horizontal, see reverse for bottom hole location.

SPUD DATE 8-1-55
DRLG FINISHED DATE 8-13-55
DATE OF WELL COMPLETION 8-22-55
1st PROD DATE 8-20-55
RECOMP DATE 1-20-22

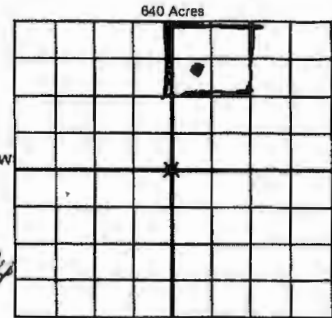

COUNTY Caddo SEC 4 TWP 5N RGE 9W
LEASE NAME Hoppin WELL NO. 3
NE 1/4 SW 1/4 NW 1/4 NE 1/4 FSL 4300 FWL 3000
ELEVATION 1660 Ground 360 Latitude 360 Longitude
OPERATOR NAME Cemail, Inc DTG / OCC OPERATOR NO. 2029462024
ADDRESS PO Box 563
CITY Cement STATE OK ZIP 73017

COMPLETION TYPE
☐ SINGLE ZONE
☐ MULTIPLE ZONE
☐ COMMINGLED
LOCATION EXCEPTION ORDER NO.
MULTIUNIT ORDER NO.
INCREASED DENSITY ORDER NO.

CASING & CEMENT (Attach Form 1002C)

TYPE	SIZE	WEIGHT	GRADE	FEET	PSI	SAX	TOP OF CMT
CONDUCTOR							
SURFACE	<u>8.0"</u>			<u>201</u>		<u>165</u>	<u>visual surface</u>
INTERMEDIATE							
PRODUCTION	<u>5.5"</u>			<u>4005</u>		<u>450</u>	<u>calculated surface</u>
LINER							

PACKER @ 1950 BRAND & TYPE Weatherford PLUG @ 1 TYPE 1 PLUG @ 1 TYPE 1 TOTAL DEPTH 4085
PACKER @ 1950 BRAND & TYPE Weatherford PLUG @ 1 TYPE 1 PLUG @ 1 TYPE 1 TOTAL DEPTH 4085
COMPLETION & TEST DATA BY PRODUCING FORMATION 451 FRTN 451 CSCO 451 INBLD 406 GRN 406 GRNR

FORMATION	Fortuna	Cisco	Noble	Dixon	Griffin	Garner
SPACING & SPACING ORDER NUMBER						
CLASS: Oil, Gas, Dry, Inj, Disp, Comm Disp, Svc	<u>STOP</u>	<u>STOP</u>	<u>STOP</u>	<u>STOP</u>	<u>STOP</u>	<u>STOP</u>
PERFORATED INTERVALS	<u>2006 - 2185</u>	<u>2192 - 2314</u>	<u>3126 - 3541</u>	<u>3611 - 3676</u>	<u>3772 - 3976</u>	
ACID/VOLUME						
FRACTURE TREATMENT (Fluids/Prop Amounts)						

RECEIVED
FEB 07 2022

INITIAL TEST DATA						
INITIAL TEST DATE						
OIL-BBL/DAY						
OIL-GRAVITY (API)						
GAS-MCF/DAY						
GAS-OIL RATIO CU FT/BBL						
WATER-BBL/DAY						
PUMPING OR FLOWING						
INITIAL SHUT-IN PRESSURE						
CHOKE SIZE						
FLOW TUBING PRESSURE						

A record of the formations drilled through, and pertinent remarks are presented on the reverse. I declare that I have knowledge of the contents of this report and am authorized by my organization to make this report, which was prepared by me or under my supervision and direction, with the data and facts stated herein to be true, correct, and complete to the best of my knowledge and belief.

Candy Knight SIGNATURE
PO Box 563 ADDRESS
Cement CITY
OK STATE
73017 ZIP

1-20-22 DATE
405-222-4449 PHONE NUMBER
cmknight@cemail.com EMAIL ADDRESS

PLEASE TYPE OR USE BLACK INK ONLY
FORMATION RECORD

Give formation names and tops, if available, or descriptions and thickness of formations drilled through. Show intervals cored or drillstem tested.

NAMES OF FORMATIONS	TOP
Fortuna +	2006
Cisco SS	2038
	2064
	2114
	2134
	2142
	2174
	2192
	2284
	2308
Noble Olson SS	3240
	3308
	3392
	3532
Griffin SS	3611
	3660
Garner SS	3772
	3847
	3960

LEASE NAME: _____ WELL NO. _____

FOR COMMISSION USE ONLY	
ITD on file <input type="checkbox"/> YES <input type="checkbox"/> NO	
APPROVED _____	DISAPPROVED _____
2) Reject Codes	

Were open hole logs run?	<input type="radio"/> yes <input type="radio"/> no
Date Last log was run	_____
Was CO ₂ encountered?	<input type="radio"/> yes <input type="radio"/> no at what depths? _____
Was H ₂ S encountered?	<input type="radio"/> yes <input type="radio"/> no at what depths? _____
Were unusual drilling circumstances encountered?	<input type="radio"/> yes <input type="radio"/> no
If yes, briefly explain below	

Other remarks: OCC - UIC order 347203, see order for detail break down on perforated intervals. Correct perforated interval on Noble-Olson from last 1002A. Per UIC order the 5 1/2" casing was perforated at 950' and squeezed cement lifting it to surface the calculated top of cement before the squeeze was 1273'

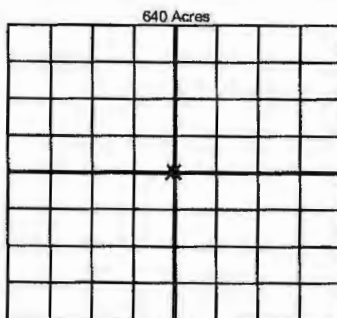

If more than three drainholes are proposed, attach a separate sheet indicating the necessary information.

Direction must be stated in degrees azimuth. Please note, the horizontal drainholes and its end point must be located within the boundaries of the lease or spacing unit.

Directional surveys are required for all drainholes and directional wells

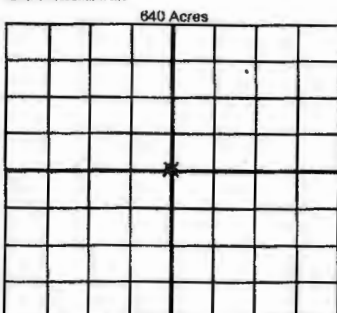

BOTTOM HOLE LOCATION FOR DIRECTIONAL HOLE

SEC	TWP	RGE	COUNTY
1/4	1/4	1/4	1/4
Measured Total Depth		True Vertical Depth	
		BHL From Lease, Unit, or Property Line:	

BOTTOM HOLE LOCATION FOR HORIZONTAL HOLE: (LATERALS)

LATERAL #1			
SEC	TWP	RGE	COUNTY
1/4	1/4	1/4	1/4
Depth of Deviation		Radius of Turn	
Measured Total Depth		True Vertical Depth	
		BHL From Lease, Unit, or Property Line:	

LATERAL #2			
SEC	TWP	RGE	COUNTY
1/4	1/4	1/4	1/4
Depth of Deviation		Radius of Turn	
Measured Total Depth		True Vertical Depth	
		BHL From Lease, Unit, or Property Line:	

LATERAL #3			
SEC	TWP	RGE	COUNTY
1/4	1/4	1/4	1/4
Depth of Deviation		Radius of Turn	
Measured Total Depth		True Vertical Depth	
		BHL From Lease, Unit, or Property Line:	