

Oklahoma Corporation Commission  
Oil & Gas Conservation Division  
Post Office Box 52000  
Oklahoma City, Oklahoma 73152-2000  
Rule 165: 10-3-25

Form 1002A

API No.: 35007216920002

**Completion Report**

Spud Date: April 28, 1979

OTC Prod. Unit No.: 007-028007-0-0000

Drilling Finished Date: May 14, 1979

**Amended**

1st Prod Date: July 27, 1979

Amend Reason: RECOMPLETION

Completion Date: July 30, 1979

Recomplete Date: April 16, 2022

**Drill Type: STRAIGHT HOLE**

Min Gas Allowable: Yes

Well Name: H A DUNN 6

Purchaser/Measurer: DCP MIDSTREAM

Location: BEAVER 35 3N 25E CM  
W2 E2 SW SW  
660 FSL 860 FWL of 1/4 SEC  
Latitude: 36.676036 Longitude: -100.341019  
Derrick Elevation: 2567 Ground Elevation: 2556

First Sales Date: 07/27/1979

Operator: LATIGO OIL AND GAS INC 10027  
PO BOX 1208  
5815 OKLAHOMA AVE  
WOODWARD, OK 73802-1208

Completion Type		Location Exception		Increased Density	
X	Single Zone	Order No		Order No	
	Multiple Zone	There are no Location Exception records to display.		There are no Increased Density records to display.	
	Commingled				

Casing and Cement							
Type	Size	Weight	Grade	Feet	PSI	SAX	Top of CMT
SURFACE	8 5/8	24	K-55	714		375	SURFACE
PRODUCTION	5 1/2	15.5 / 17	K-55	7898		400	6300

Liner								
Type	Size	Weight	Grade	Length	PSI	SAX	Top Depth	Bottom Depth
There are no Liner records to display.								

**Total Depth: 7900**

Packer		Plug	
Depth	Brand & Type	Depth	Plug Type
There are no Packer records to display.		7595	RBP

Initial Test Data
-------------------

Test Date	Formation	Oil BBL/Day	Oil-Gravity (API)	Gas MCF/Day	Gas-Oil Ratio Cu FT/BBL	Water BBL/Day	Pumpin or Flowing	Initial Shut-In Pressure	Choke Size	Flow Tubing Pressure
Jul 03, 1979	MORROW SAND LOW	10		60	6000	11	PUMPING			
Apr 21, 2022	MORROW SAND MID	27		38	1407	47	PUMPING	1420		

Completion and Test Data by Producing Formation										
Formation Name: MORROW SAND MID				Code: 402MWSDM				Class: OIL		
Spacing Orders				Perforated Intervals						
Order No		Unit Size		From			To			
724278		80		7475			7481			
				7487			7490			
Acid Volumes				Fracture Treatments						
500 GALLONS 7.5% HCL				30,300 GALLONS X FRAC, 40,000 POUNDS 20/40 SAND						
Formation Name: MORROW SAND LOW				Code: 402MWSDL				Class: DRY		
Spacing Orders				Perforated Intervals						
Order No		Unit Size		From			To			
47930		80		7762			7822			
Acid Volumes				Fracture Treatments						
There are no Acid Volume records to display.				There are no Fracture Treatments records to display.						

Formation	Top
MORROW SAND MID	7470
MORROW SAND LOW	7762

Were open hole logs run? Yes

Date last log run: May 14, 1979

Were unusual drilling circumstances encountered? No

Explanation:

Other Remarks
RBP SET OVER MORROW SAND LOWER. WILL PULL UPON APPROVED COMMINGLE APPLICATION.

FOR COMMISSION USE ONLY
<div>1148054</div> <div>Status: Accepted</div>

RECEIVED

API NO. 35-007-21692  
 OTC PROD. UNIT NO. 007028007

Oil and Gas Conservation Division  
 P.O. Box 52000  
 Oklahoma City, OK 73152-2000  
 405-521-2331  
 OCCCentralProcessing@OCC.OK.GOV



**OKLAHOMA**  
 Corporation  
 Commission

APR 29 2022 Form 1002A  
 Rev. 2021

OKLAHOMA CORPORATION  
 COMMISSION

☒ ORIGINAL  
☒ AMENDED (Reason) \_\_\_\_\_ Recompletion  
 Rule 165:10-3-25  
 COMPLETION REPORT

TYPE OF DRILLING OPERATION

☒ STRAIGHT HOLE ☐ DIRECTIONAL HOLE ☐ HORIZONTAL HOLE

☐ SERVICE WELL

If directional or horizontal, see reverse for bottom hole location.

COUNTY	Beaver	SEC	35	TWP	3N	RGE	25ECM
LEASE NAME	H A Dunn			WELL NO.	6		
E2 1/4 SW 1/4 SW 1/4 1/4	FSL	660	FWL	860	DATE OF WELL COMPLETION	7/30/1979	
ELEVATION	2567	Ground	2556	Latitude	36.676044		Longitude
Derrick FL				1st PROD DATE	7/27/1979		
OPERATOR NAME	Latigo Oil & Gas, Inc.			OTC / OCC OPERATOR NO.	10027		
ADDRESS	PO Box 1208						
CITY	Woodward	STATE	OK	ZIP	73802-1208		

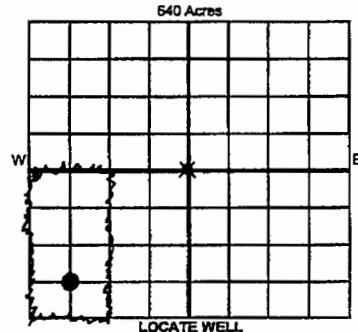

COMPLETION TYPE

<input checked="" type="radio"/> SINGLE ZONE	
<input type="radio"/> MULTIPLE ZONE	
<input type="radio"/> COMMINGLED	
<input type="radio"/> LOCATION EXCEPTION	
<input type="radio"/> ORDER NO.	
<input type="radio"/> MULTUNIT ORDER NO.	
<input type="radio"/> INCREASED DENSITY	
<input type="radio"/> ORDER NO.	

CASING & CEMENT (Attach Form 1002C)

TYPE	SIZE	WEIGHT	GRADE	FEET	PSI	SAX	TOP OF CMT
CONDUCTOR							
SURFACE	8-5/8"	24	K55	714		375	Surface
INTERMEDIATE							
PRODUCTION	5-1/2"	15.5/17	K55	7898		400	6300
LINER							

PACKER @ \_\_\_\_\_ BRAND & TYPE \_\_\_\_\_ PLUG @ 7595 TYPE RBP PLUG @ \_\_\_\_\_ TYPE \_\_\_\_\_ TOTAL DEPTH 7900

COMPLETION & TEST DATA BY PRODUCING FORMATION 402 MW5DM 402 MW5DL

FORMATION	Morrow Sand Mid	Morrow Sand Low				
SPACING & SPACING ORDER NUMBER	724278 (80)	47930 (80)				
CLASS: Oil, Gas, Dry, Int, Disp, Comm Disp, Svc	Oil	OK Dry	below plug			
PERFORATED INTERVALS	7475'-7481'	7762-7822'				
	7487'-7490'					
ACID VOLUME	500 GAL 7.5% HCL					
FRACTURE TREATMENT (Fluids/Prop Amounts)	30,300 GAL X FRAC, 40,000# 20/40 SD					

Morriston  
 Report to Fractures

☒ Min Gas Allowable (165:10-17-7)  
 OR  
☐ Oil Allowable (165:10-13-3)  
 Purchaser/Measurer DCP MIDSTREAM  
 First Sales Date 7/27/1979

INITIAL TEST DATA

INITIAL TEST DATE	4-21-22	7-3-1979				
OIL-BBL/DAY	27	10				
OIL-GRAVITY (API)						
GAS-MCF/DAY	38	60				
GAS-OIL RATIO CU FT/BBL	1407	6000				
WATER-BBL/DAY	47	11				
PUMPING OR FLOWING	PUMPING	PUMPING				
INITIAL SHUT-IN PRESSURE	1420#					
CHOKE SIZE	NA					
FLOW TUBING PRESSURE	NA					

A record of the formations drilled through, and pertinent remarks are presented on the reverse. I declare that I have knowledge of the contents of this report and am authorized by my organization to make this report, which was prepared by me or under my supervision and direction, with the data and facts stated herein to be true, correct, and complete to the best of my knowledge and belief.

SIGNATURE Ryan Barby 04/29/2022 580-256-1416  
 PO Box 1208 NAME (PRINT OR TYPE) DATE PHONE NUMBER  
 Woodward OK 73802-1208 RyanB@Latigooil.com  
 ADDRESS CITY STATE ZIP EMAIL ADDRESS

PLEASE TYPE OR USE BLACK INK ONLY

FORMATION RECORD

Give formation names and tops, if available, or descriptions and thickness of formations drilled through. Show intervals cored or drillstem tested.

NAMES OF FORMATIONS	TOP
Morrow Sand Mid	7470
Morrow Sand Low	7762

LEASE NAME H A Dunn

WELL NO. 6

FOR COMMISSION USE ONLY	
ITD on file <input type="checkbox"/> YES <input type="checkbox"/> NO	
APPROVED _____	DISAPPROVED _____
2) Reject Codes	

Were open hole logs run?	<input checked="" type="radio"/> yes <input type="radio"/> no
Date Last log was run	<u>5-14-1979</u>
Was CO <sub>2</sub> encountered?	<input type="radio"/> yes <input checked="" type="radio"/> no at what depths? _____
Was H <sub>2</sub> S encountered?	<input type="radio"/> yes <input checked="" type="radio"/> no at what depths? _____
Were unusual drilling circumstances encountered?	<input type="radio"/> yes <input checked="" type="radio"/> no
If yes, briefly explain below	

Other remarks: RBP SET OVER LOWER MORROW SAND. WILL PULL UPON APPROVED COMMINGLE APP.

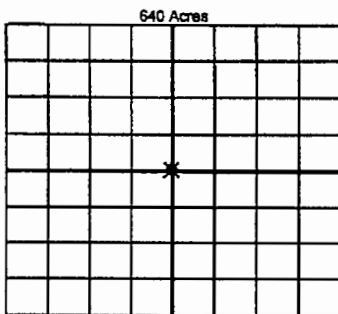

If more than three drainholes are proposed, attach a separate sheet indicating the necessary information.

Direction must be stated in degrees azimuth. Please note, the horizontal drainholes and its end point must be located within the boundaries of the lease or spacing unit.

Directional surveys are required for all drainholes and directional wells

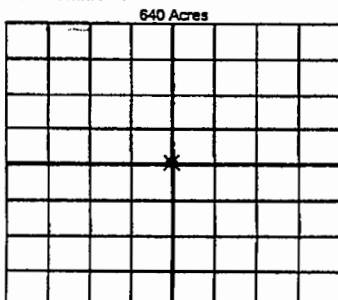

BOTTOM HOLE LOCATION FOR DIRECTIONAL HOLE

SEC	TWP	RGE	COUNTY
1/4	1/4	1/4	1/4
Measured Total Depth		True Vertical Depth	BHL From Lease, Unit, or Property Line:

BOTTOM HOLE LOCATION FOR HORIZONTAL HOLE: (LATERALS)

LATERAL #1			
SEC	TWP	RGE	COUNTY
1/4	1/4	1/4	1/4
Depth of Deviation		Radius of Turn	Direction
Measured Total Depth		True Vertical Depth	BHL From Lease, Unit, or Property Line:

LATERAL #2			
SEC	TWP	RGE	COUNTY
1/4	1/4	1/4	1/4
Depth of Deviation		Radius of Turn	Direction
Measured Total Depth		True Vertical Depth	BHL From Lease, Unit, or Property Line:

LATERAL #3			
SEC	TWP	RGE	COUNTY
1/4	1/4	1/4	1/4
Depth of Deviation		Radius of Turn	Direction
Measured Total Depth		True Vertical Depth	BHL From Lease, Unit, or Property Line: