

Oklahoma Corporation Commission
Oil & Gas Conservation Division
Post Office Box 52000
Oklahoma City, Oklahoma 73152-2000
Rule 165: 10-3-25

Form 1002A

API No.: 35071249010000

Completion Report

Spud Date: December 22, 2018

OTC Prod. Unit No.: 071-225461-0-0000

Drilling Finished Date: December 30, 2018

1st Prod Date: March 09, 2019

Completion Date: March 08, 2019

Drill Type: STRAIGHT HOLE

Well Name: BRUCE 1

Purchaser/Measurer:

Location: KAY 18 29N 3E
E2 SW SW NE
330 FSL 535 FWL of 1/4 SEC
Latitude: 36.9929495 Longitude: -97.0189978
Derrick Elevation: 1170 Ground Elevation: 1160

First Sales Date:

Operator: HADAWAY CONSULTING & ENGINEERING LLC 22787
PO BOX 188
711 W BIRCH ST
CANADIAN, TX 79014-0188

Completion Type		Location Exception		Increased Density	
X	Single Zone	Order No		Order No	
	Multiple Zone	There are no Location Exception records to display.		There are no Increased Density records to display.	
	Commingle				

Casing and Cement							
Type	Size	Weight	Grade	Feet	PSI	SAX	Top of CMT
CONDUCTOR	20	94	J-55	40			SURFACE
SURFACE	8 5/8	24	J-55	292		188	SURFACE
PRODUCTION	5 1/2	15.5	J-55	3350		180	1800

Liner								
Type	Size	Weight	Grade	Length	PSI	SAX	Top Depth	Bottom Depth
There are no Liner records to display.								

Total Depth: 3350

Packer	
Depth	Brand & Type
There are no Packer records to display.	

Plug	
Depth	Plug Type
There are no Plug records to display.	

Initial Test Data

Test Date	Formation	Oil BBL/Day	Oil-Gravity (API)	Gas MCF/Day	Gas-Oil Ratio Cu FT/BBL	Water BBL/Day	Pumpin or Flowing	Initial Shut- In Pressure	Choke Size	Flow Tubing Pressure
Mar 20, 2019	CLEVELAND	40	40	50	1250	110	PUMPING	500		

Completion and Test Data by Producing Formation

Formation Name: CLEVELAND

Code: 405CLVD

Class: OIL

Spacing Orders

Order No	Unit Size
688998	40

Perforated Intervals

From	To
2896	2929

Acid Volumes

NONE

Fracture Treatments

1,770 BARRELS 20 POUNDS XL GEL, 78,800 POUNDS 16/30 SAND
--

Formation	Top
OREAD	1707
PAWHUSKA	2080
AVANT	2386
OSAGE LAYTON	2569
CHECKERBOARD	2858
CLEVELAND	2882
OSWEGO	2982
RED FORK	3320

Were open hole logs run? Yes
Date last log run: December 30, 2018

Were unusual drilling circumstances encountered? No
Explanation:

Other Remarks
There are no Other Remarks.

FOR COMMISSION USE ONLY

Status: Accepted

1143527

API NO. 07124901
OTC PROD. UNIT NO. 071-225461-0-0000

(PLEASE TYPE OR USE BLACK INK ONLY)

OKLAHOMA CORPORATION COMMISSION
Oil & Gas Conservation Division
Post Office Box 52000
Oklahoma City, Oklahoma 73152-2000
Rule 165-10-3-25

Form 1002A
Rev. 2009

☒ ORIGINAL
☐ AMENDED (Reason) _____

COMPLETION REPORT

TYPE OF DRILLING OPERATION

☒ STRAIGHT HOLE ☐ DIRECTIONAL HOLE ☐ HORIZONTAL HOLE
☐ SERVICE WELL

If directional or horizontal, see reverse for bottom hole location.

COUNTY KAY SEC 18 TWP 29N RGE 3E
LEASE NAME BRUCE WELL NO. 1
NE 1/4 SW 1/4 SW 1/4 NE 1/4 FSL OF 330' FWL OF 535'
ELEVATION 1170 Ground 1160 Latitude (if known) 36.9929495 Longitude (if known) -97.0189978
OPERATOR HADAWAY CONSULTING & ENGINEERING OTC OPERATOR NO. 22787
ADDRESS PO BOX 188
CITY CANADIAN STATE TX ZIP 79014

SPUD DATE 12/22/2018

DRLG FINISHED DATE 12/30/2018

DATE OF WELL COMPLETION 03/08/2019

1st PROD DATE 03/09/2019

RECOMP DATE

LOCATE WELL

COMPLETION TYPE

☒ SINGLE ZONE
☐ MULTIPLE ZONE
Application Date
COMINGLED
Application Date
LOCATION EXCEPTION
ORDER NO.
INCREASED DENSITY
ORDER NO.

CASING & CEMENT (Attach Form 1002C)

TYPE	SIZE	WEIGHT	GRADE	FEET	PSI	SAX	TOP OF CMT
CONDUCTOR	20	94	J55	40			surface
SURFACE	8 5/8	24	J55	292		188	surface
INTERMEDIATE							
PRODUCTION	5 1/2	15.5	J55	3350		180	1800
LINER							
TOTAL DEPTH							3,350

PACKER @ _____ BRAND & TYPE _____ PLUG @ _____ TYPE _____ PLUG @ _____ TYPE _____
PACKER @ _____ BRAND & TYPE _____ PLUG @ _____ TYPE _____ PLUG @ _____ TYPE _____

COMPLETION & TEST DATA BY PRODUCING FORMATION

FORMATION	CLEVELAND						
SPACING & SPACING ORDER NUMBER	688498(40)						Monitor Report to FracFocus
CLASS: Oil, Gas, Dry, Inj, Disp, Comm Disp, Svc	oil						
	2896-2929						
PERFORATED INTERVALS							
ACID/VOLUME	none						
FRACTURE TREATMENT (Fluids/Prop Amounts)	1770 BBL 20# XL GEL 78800# 16/30 sand						

Min Gas Allowable (165:10-17-7)

Gas Purchaser/Measurer

☐ OR
Oil Allowable (165:10-13-3)

First Sales Date

INITIAL TEST DATA

INITIAL TEST DATE	3/20/2019					
OIL-BBL/DAY	40					
OIL-GRAVITY (API)	40					
GAS-MCF/DAY	50					
GAS-OIL RATIO CU FT/BBL	1250					
WATER-BBL/DAY	110					
PUMPING OR FLOWING	PUMPING					
INITIAL SHUT-IN PRESSURE	500					
CHOKE SIZE						
FLOW TUBING PRESSURE						

AS SUBMITTED

A record of the formations drilled through, and pertinent remarks are presented on the reverse. I declare that I have knowledge of the contents of this report and am authorized by my organization to make this report, which was prepared by me or under my supervision and direction, with the data and facts stated herein to be true, correct, and complete to the best of my knowledge and belief.

SIGNATURE NEAL EARLE 7/9/2018 806.323.9811
711 W. BIRCH CANADIAN TX 79014 EARLE@HADENG.COM
ADDRESS CITY STATE ZIP EMAIL ADDRESS

PLEASE TYPE OR USE BLACK INK ONLY

FORMATION RECORD

Give formation names and tops, if available, or descriptions and thickness of formations drilled through. Show intervals cored or drillstem tested.

NAMES OF FORMATIONS	TOP
OREAD	1,707
PAWHUSKA	2,080
AVANT	2386
OSAGE LAYTON	2,569
CHECKERBOARD	2,858
CLEVELAND	2,882
OSWEGO	2,982
RED FORK	3,320

LEASE NAME BRUCE WELL NO. 1

FOR COMMISSION USE ONLY	
ITD on file <input type="checkbox"/> YES <input type="checkbox"/> NO	
APPROVED _____	DISAPPROVED _____
2) Reject Codes	

Were open hole logs run?	<u>X</u> yes <u> </u> no
Date Last log was run	<u>12/30/2018</u>
Was CO ₂ encountered?	<u> </u> yes <u>X</u> no at what depths? _____
Was H ₂ S encountered?	<u> </u> yes <u>X</u> no at what depths? _____
Were unusual drilling circumstances encountered?	<u> </u> yes <u>X</u> no
If yes, briefly explain below	

Other remarks:

640 Acres

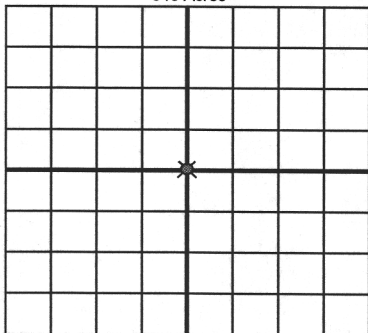

If more than three drainholes are proposed, attach a separate sheet indicating the necessary information.

Direction must be stated in degrees azimuth.
Please note, the horizontal drainhole and its end point must be located within the boundaries of the lease or spacing unit.

Directional surveys are required for all drainholes and directional wells.

640 Acres

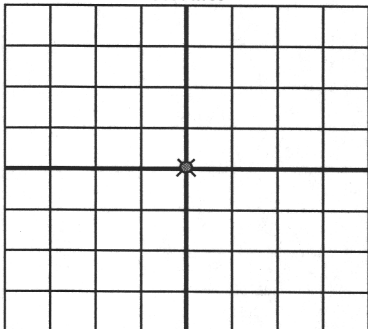

BOTTOM HOLE LOCATION FOR DIRECTIONAL HOLE

SEC	TWP	RGE	COUNTY
Spot Location	1/4	1/4	1/4
Measured Total Depth	True Vertical Depth	BHL From Lease, Unit, or Property Line:	

BOTTOM HOLE LOCATION FOR HORIZONTAL HOLE: (LATERALS)

LATERAL #1

SEC	TWP	RGE	COUNTY
Spot Location	1/4	1/4	1/4
Depth of Deviation	Radius of Turn	Direction	Total Length
Measured Total Depth	True Vertical Depth	BHL From Lease, Unit, or Property Line:	

LATERAL #2

SEC	TWP	RGE	COUNTY
Spot Location	1/4	1/4	1/4
Depth of Deviation	Radius of Turn	Direction	Total Length
Measured Total Depth	True Vertical Depth	BHL From Lease, Unit, or Property Line:	

LATERAL #3

SEC	TWP	RGE	COUNTY
Spot Location	1/4	1/4	1/4
Depth of Deviation	Radius of Turn	Direction	Total Length
Measured Total Depth	True Vertical Depth	BHL From Lease, Unit, or Property Line:	

API NO. 07124901
 OTC PROD.
 UNIT NO.

(PLEASE TYPE OR USE BLACK INK ONLY)

OKLAHOMA CORPORATION COMMISSION
 Oil & Gas Conservation Division
 Post Office Box 52000
 Oklahoma City, Oklahoma 73152-2000
 Rule 165:10-3-25

RECEIVED

Form 1002A
 Rev. 2009

SEP 23 2019

☒ ORIGINAL
☐ AMENDED (Reason)

COMPLETION REPORT

TYPE OF DRILLING OPERATION
☒ STRAIGHT HOLE ☐ DIRECTIONAL HOLE ☐ HORIZONTAL HOLE
☐ SERVICE WELL

If directional or horizontal, see reverse for bottom hole location.

COUNTY Kay SEC 18 TWP 29N RGE 03E
 LEASE NAME Bruce WELL NO. 1
 E2 1/4 SW 1/4 SW 1/4 NE 1/4 FSL OF 1/4 SEC 330 FWL OF 1/4 SEC 535
 ELEVATION 1170 Ground 1160 Latitude (if known) Longitude (if known)
 OPERATOR NAME Hadaway Consulting & Engineering OTC / OCC OPERATOR NO. 22787 0
 ADDRESS P O Box 188
 CITY Canadian STATE TX ZIP 79014 0188

SPUD DATE 12/22/2018
 DRLG FINISHED DATE 12/31/2018
 DATE OF WELL COMPLETION 3/08/2019
 1st PROD DATE 3/01/2019
 RECOMP DATE

OKLAHOMA CORPORATION COMMISSION

LOCATE WELL

COMPLETION TYPE

☒ SINGLE ZONE
☐ MULTIPLE ZONE
 Application Date
☐ COMINGLED
 Application Date
 LOCATION EXCEPTION ORDER NO.
 INCREASED DENSITY ORDER NO.

CASING & CEMENT (Attach Form 1002C)

TYPE	SIZE	WEIGHT	GRADE	FEET	PSI	SAX	TOP OF CMT
CONDUCTOR	20			40			
SURFACE	8 5/8'	24	J-55	295		188	Surface
INTERMEDIATE							
PRODUCTION	5 1/2"	15.5	J-55	3349		180	1820
LINER							
						TOTAL DEPTH	3,350

PACKER @ BRAND & TYPE PLUG @ TYPE PLUG @ TYPE
 PACKER @ BRAND & TYPE PLUG @ TYPE PLUG @ TYPE

COMPLETION & TEST DATA BY PRODUCING FORMATION

FORMATION	Cleveland						
SPACING & SPACING ORDER NUMBER	40 Ac 888998						
CLASS: Oil, Gas, Dry, Inj. Disp, Comm Disp, Svc	Oil						
PERFORATED INTERVALS	2896' - 2929'						
ACID/VOLUME							
FRACTURE TREATMENT (Fluids/Prop Amounts)	1770 BBL 20# 78,800# 16/30						

☐ Min Gas Allowable (165:10-17-7)
 OR
☐ Oil Allowable (165:10-13-3)

Gas Purchaser/Measurer
 First Sales Date

INITIAL TEST DATA

INITIAL TEST DATE	3/3/2019						
OIL-BBL/DAY	62						
OIL-GRAVITY (API)	42						
GAS-MCF/DAY	NA						
GAS-OIL RATIO CU FT/BBL							
WATER-BBL/DAY	163						
PUMPING OR FLOWING	Pump						
INITIAL SHUT-IN PRESSURE	100						
CHOKE SIZE							
FLOW TUBING PRESSURE							

AS SUBMITTED

A record of the formations drilled through, and pertinent remarks are presented on the reverse. I declare that I have knowledge of the contents of this report and am authorized by my organization to make this report, which was prepared by me or under my supervision and direction, with the data and facts stated herein to be true, correct, and complete to the best of my knowledge and belief.

SIGNATURE Ron Brown NAME (PRINT OR TYPE) Ron Brown
 770 E Britton Oklahoma City OK 73114
 ADDRESS CITY STATE ZIP
 DATE 3/2019 405 778-0
 PHONE NUMBER
 EMAIL ADDRESS qualityengineeringllc@outlook.com

PLEASE TYPE OR USE BLACK INK ONLY
FORMATION RECORD

Give formation names and tops, if available, or descriptions and thickness of formations drilled through. Show intervals cored or drillstem tested.

NAMES OF FORMATIONS	TOP
Checkerboard	2,866
Cleveland	2,890
Oswego	2997
Redfork	3,327

LEASE NAME Bruce WELL NO. 1

FOR COMMISSION USE ONLY	
ITD on file <input type="checkbox"/> YES <input type="checkbox"/> NO	
APPROVED _____	DISAPPROVED _____
2) Reject Codes	

Were open hole logs run?	<input checked="" type="checkbox"/> yes <input type="checkbox"/> no
Date Last log was run	<u>12/29/2018</u>
Was CO ₂ encountered?	<input type="checkbox"/> yes <input type="checkbox"/> no at what depths? _____
Was H ₂ S encountered?	<input type="checkbox"/> yes <input type="checkbox"/> no at what depths? _____
Were unusual drilling circumstances encountered?	<input type="checkbox"/> yes <input type="checkbox"/> no
If yes, briefly explain below	

Other remarks:

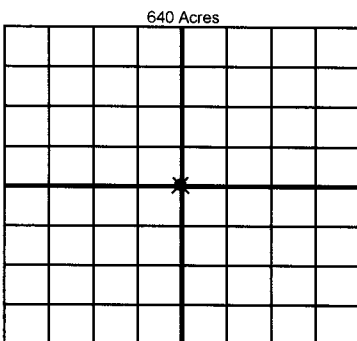

If more than three drainholes are proposed, attach a separate sheet indicating the necessary information.

Direction must be stated in degrees azimuth.
Please note, the horizontal drainhole and its end point must be located within the boundaries of the lease or spacing unit.

Directional surveys are required for all drainholes and directional wells.

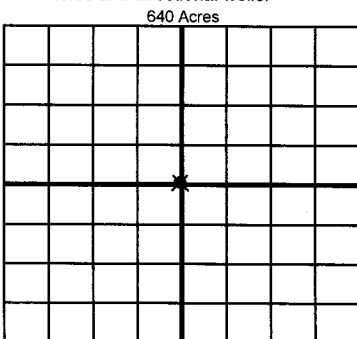

BOTTOM HOLE LOCATION FOR DIRECTIONAL HOLE

SEC	TWP	RGE	COUNTY
Spot Location		Feet From 1/4 Sec Lines	
1/4	1/4	1/4	1/4
Measured Total Depth		True Vertical Depth	
BHL From Lease, Unit, or Property Line:			

BOTTOM HOLE LOCATION FOR HORIZONTAL HOLE: (LATERALS)

LATERAL #1			
SEC	TWP	RGE	COUNTY
Spot Location		Feet From 1/4 Sec Lines	
1/4	1/4	1/4	1/4
Depth of Deviation	Radius of Turn	Direction	Total Length
Measured Total Depth	True Vertical Depth		
BHL From Lease, Unit, or Property Line:			

LATERAL #2			
SEC	TWP	RGE	COUNTY
Spot Location		Feet From 1/4 Sec Lines	
1/4	1/4	1/4	1/4
Depth of Deviation	Radius of Turn	Direction	Total Length
Measured Total Depth	True Vertical Depth		
BHL From Lease, Unit, or Property Line:			

LATERAL #3			
SEC	TWP	RGE	COUNTY
Spot Location		Feet From 1/4 Sec Lines	
1/4	1/4	1/4	1/4
Depth of Deviation	Radius of Turn	Direction	Total Length
Measured Total Depth	True Vertical Depth		
BHL From Lease, Unit, or Property Line:			