

Oklahoma Corporation Commission
Oil & Gas Conservation Division
Post Office Box 52000
Oklahoma City, Oklahoma 73152-2000
Rule 165: 10-3-25

Form 1002A

API No.: 35109224730000

Completion Report

Spud Date: August 10, 2019

OTC Prod. Unit No.: 109-226314 AND 017-226314

Drilling Finished Date: August 23, 2019

1st Prod Date: October 10, 2019

Completion Date: September 19, 2019

Drill Type: HORIZONTAL HOLE

Min Gas Allowable: Yes

Well Name: ARYA 1404 06-01 2BH

Purchaser/Measurer: SUPERIOR PIPELINE

Location: OKLAHOMA 6 14N 4W
NE SE SE SE
560 FSL 186 FEL of 1/4 SEC
Latitude: 35.712518 Longitude: -97.6566721
Derrick Elevation: 1168 Ground Elevation: 1150

First Sales Date: 10/31/2019

Operator: REVOLUTION RESOURCES LLC 24162

14301 CALIBER DR STE 110
OKLAHOMA CITY, OK 73134-1016

Completion Type		Location Exception		Increased Density	
X	Single Zone	Order No		Order No	
	Multiple Zone	There are no Location Exception records to display.		There are no Increased Density records to display.	
	Commingled				

Casing and Cement							
Type	Size	Weight	Grade	Feet	PSI	SAX	Top of CMT
CONDUCTOR	20	94	J-55	98			SURFACE
SURFACE	9.625	36	J-55	748		340	SURFACE
PRODUCTION	7	29	P-110	7470		385	3056

Liner								
Type	Size	Weight	Grade	Length	PSI	SAX	Top Depth	Bottom Depth
LINER	4.5	13.5	P-110	8683	0	0	7407	16090

Total Depth: 16130

Packer	
Depth	Brand & Type
There are no Packer records to display.	

Plug	
Depth	Plug Type
There are no Plug records to display.	

Initial Test Data

Test Date	Formation	Oil BBL/Day	Oil-Gravity (API)	Gas MCF/Day	Gas-Oil Ratio Cu FT/BBL	Water BBL/Day	Pumpin or Flowing	Initial Shut-In Pressure	Choke Size	Flow Tubing Pressure
Oct 11, 2019	HUNTON	270	40	530	1962	500	PUMPING			

Completion and Test Data by Producing Formation

Formation Name: HUNTON		Code: 269HNTN		Class: OIL	
Spacing Orders		Perforated Intervals			
Order No	Unit Size	From	To		
20212	UNIT	There are no Perf. Intervals records to display.			
Acid Volumes		Fracture Treatments			
210,000 GALLONS ACID		61,720 BARRELS WATER			

Formation	Top
OSWEGO	6375
BARTLESVILLE	6634
WOODFORD	6799
HUNTON	6849

Were open hole logs run? No
Date last log run:

Were unusual drilling circumstances encountered? No
Explanation:

Other Remarks
THIS WELL IS AN OPEN HOLE COMPLETION FROM THE BOTTOM OF THE 7" CASING AT 7,470' TO TOTAL DEPTH AT 16,130'. THE 4-1/2" LINER IS NOT CEMENTED.

Lateral Holes
<p>Sec: 1 TWP: 14N RGE: 5W County: CANADIAN</p> <p>SW SW NE SW</p> <p>1625 FSL 1595 FWL of 1/4 SEC</p> <p>Depth of Deviation: 6392 Radius of Turn: 1172 Direction: 273 Total Length: 8925</p> <p>Measured Total Depth: 16130 True Vertical Depth: 7102 End Pt. Location From Release, Unit or Property Line: 270</p>

FOR COMMISSION USE ONLY
<div>Status: Accepted</div> <div>1144163</div>

API NO. 109-22473
OTC PROD. 24102
UNIT NO. 109-226314 017-226314

(PLEASE TYPE OR USE BLACK INK ONLY)

OKLAHOMA CORPORATION COMMISSION

Oil & Gas Conservation Division

Post Office Box 52000

Oklahoma City, Oklahoma 73152-2000

Rule 165:10-3-25

RECEIVED

NOV 13 2019

OKLAHOMA CORPORATION COMMISSION

Form 1002A

Rev. 2009

☒ ORIGINAL
☐ AMENDED (Reason)

TYPE OF DRILLING OPERATION

☐ STRAIGHT HOLE ☐ DIRECTIONAL HOLE ☒ HORIZONTAL HOLE
☐ SERVICE WELL

If directional or horizontal, see reverse for bottom hole location.

COUNTY OKLAHOMA SEC 06 TWP 14N RGE 4W
LEASE NAME ARYA 1404 06-01
WELL NO. 2BH
NE 1/4 SE 1/4 SE 1/4 SE 1/4 FSL OF 1/4 SEC 560 DATE OF 1/4 SEC 2454
ELEVATION 1168 Ground 1150 Latitude (if known) 35.712518 Longitude (if known) -97.6566721
OPERATOR NAME REVOLUTION RESOURCES LLC OTC/OCC OPERATOR NO. 24162
ADDRESS 14301 CALIBER DR SUITE 110
CITY OKLAHOMA CITY STATE OK ZIP 73134

SPUD DATE 8/10/2019
DRLG FINISHED DATE 8/23/2019
DATE OF WELL COMPLETION 9/19/2019
1st PROD DATE 10/10/2019
RECOMP DATE

640 Acres
W E
LOCATE WELL

COMPLETION TYPE

☒ SINGLE ZONE
☐ MULTIPLE ZONE
Application Date
COMMINGLED
Application Date
LOCATION EXCEPTION
ORDER NO.
INCREASED DENSITY
ORDER NO.

CASING & CEMENT (Form 1002C must be attached)

TYPE	SIZE	WEIGHT	GRADE	FEET	PSI	SAX	TOP OF CMT
CONDUCTOR	20	94	J-55	98'			SURF
SURFACE	9.625	36	J-55	748'		340	SURF
INTERMEDIATE	7	29	P-110	7470'		385	3056 CALC
PRODUCTION							
LINER	4.5	13.5	P-110	7407'-16090'	OPEN	HOLE	NA
TOTAL DEPTH							16130'

PACKER @ BRAND & TYPE PLUG @ TYPE PLUG @ TYPE
PACKER @ BRAND & TYPE PLUG @ TYPE PLUG @ TYPE

COMPLETION & TEST DATA BY PRODUCING FORMATION

269 HNTN

FORMATION HUNTON
SPACING & SPACING ORDER NUMBER 20212 (unit)
CLASS: Oil, Gas, Dry, Inj, Disp, Comm Disp, Svc OIL
PERFORATED INTERVALS OPENHOLE
COMPLETION
ACID/VOLUME 210,000 GAL ACID
61,720 BBL WATER
FRACTURE TREATMENT (Fluids/Prop Amounts)

Reported to Five Focus

☒ Min Gas Allowable (165:10-17-7)
OR
☐ Oil Allowable (165:10-13-3)

Gas Purchaser/Measurer Superior Pipeline
First Sales Date 10/31/2019

INITIAL TEST DATA

INITIAL TEST DATE 10/11/2019
OIL-BBL/DAY 270
OIL-GRAVITY (API) 40
GAS-MCF/DAY 530
GAS-OIL RATIO CU FT/BBL 1962
WATER-BBL/DAY 500
PUMPING OR FLOWING PUMPING
INITIAL SHUT-IN PRESSURE
CHOKE SIZE
FLOW TUBING PRESSURE

AS SUBMITTED

A record of the formations drilled through, and pertinent remarks are presented on the reverse. I declare that I have knowledge of the contents of this report and am authorized by my organization to make this report, which was prepared by me or under my supervision and direction, with the data and facts stated herein to be true, correct, and complete to the best of my knowledge and belief.

SIGNATURE JUSTIN LUNDQUIST 11/11/2019 405-256-4393
14301 Caliber Dr. Suite 110 Oklahoma City OK 73134 JustinL@revolutionresources.com
ADDRESS CITY STATE ZIP EMAIL ADDRESS

FORMATION RECORD

LEASE NAME	ARYA 1404 06-01	WELL NO.	2BH
------------	-----------------	----------	-----

NAMES OF FORMATIONS	TOP
OSWEGO	6,375
BARTLESVILLE	6,634
WOODFORD	6799
HUNTON	6,849

FOR COMMISSION USE ONLY	
ITD on file	<input type="checkbox"/> YES <input type="checkbox"/> NO
APPROVED	DISAPPROVED
2) Reject Codes	

Were open hole logs run? ☐ yes ☒ no

Date Last log was run _____

Was CO₂ encountered? ☐ yes ☒ no at what depths? _____

Was H₂S encountered? ☐ yes ☒ no at what depths? _____

Were unusual drilling circumstances encountered? ☐ yes ☒ no

If yes, briefly explain below

Other remarks:	This well is an openhole completion from the bottom of the 7" casing at 7470' to TD at 16,130'. The 4-1/2" liner is not cemented.

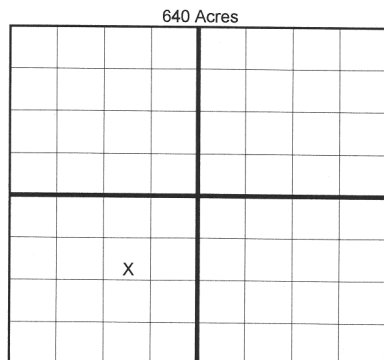

If more than three drainholes are proposed, attach a separate sheet indicating the necessary information.

Direction must be stated in degrees azimuth.
Please note, the horizontal drainhole and its end point must be located within the boundaries of the lease or spacing unit.

Directional surveys are required for all drainholes and directional wells.

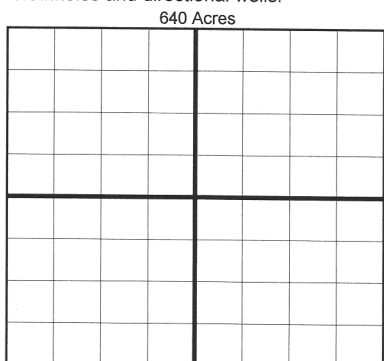

BOTTOM HOLE LOCATION FOR DIRECTIONAL HOLE

SEC	TWP	RGE	COUNTY			
Spot Location				Feet From 1/4 Sec Lines	FSL	FWL
1/4	1/4	1/4	1/4			
Measured Total Depth		True Vertical Depth	BHL From Lease, Unit, or Property Line:			

BOTTOM HOLE LOCATION FOR HORIZONTAL HOLE: (LATERALS)

LATERAL #1

SEC 1	TWP 14N	RGE 05W	COUNTY CANADIAN
Spot Location SW 1/4 SW 1/4 NE 1/4 SW 1/4		Feet From 1/4 Sec Lines	FSL 1625' FWL 1595'
Depth of Deviation 6392'		Radius of Turn 1172'	Direction 273 AZM Total Length 8925'
Measured Total Depth 16,130		True Vertical Depth 7102'	BHL From Lease, Unit, or Property Line: 270' FROM UNIT BOUNDARY

LATERAL #2

SEC	TWP	RGE	COUNTY			
Spot Location				Feet From 1/4 Sec Lines	FSL	FWL
1/4	1/4	1/4	1/4			
Depth of Deviation		Radius of Turn	Direction	Total Length		
Measured Total Depth		True Vertical Depth	BHL From Lease, Unit, or Property Line:			

LATERAL #3

SEC	TWP	RGE	COUNTY			
Spot Location				Feet From 1/4 Sec Lines	FSL	FWL
1/4	1/4	1/4	1/4			
Depth of Deviation		Radius of Turn	Direction	Total Length		
Measured Total Depth		True Vertical Depth	BHL From Lease, Unit, or Property Line:			