

Oklahoma Corporation Commission
Oil & Gas Conservation Division
Post Office Box 52000
Oklahoma City, Oklahoma 73152-2000
Rule 165: 10-3-25

Form 1002A

API No.: 35037223580001

Completion Report

Spud Date: September 21, 1979

OTC Prod. Unit No.:

Drilling Finished Date: September 24, 1979

Amended

1st Prod Date: December 11, 1979

Amend Reason: CONVERT TO DISPOSAL

Completion Date: November 24, 1979

Recomplete Date: October 30, 2019

Drill Type: STRAIGHT HOLE

SERVICE WELL

Well Name: FARMER 2

Purchaser/Measurer:

Location: CREEK 18 17N 12E
SE NW SW SE
900 FSL 575 FWL of 1/4 SEC
Latitude: 35.947321 Longitude: -96.072125
Derrick Elevation: 784 Ground Elevation: 780

First Sales Date:

Operator: T BAR M ENERGY RESOURCES LLC 23380
PO BOX 668
8948 W 191ST S
MOUNDS, OK 74047-0668

Completion Type		Location Exception		Increased Density	
X	Single Zone	Order No		Order No	
	Multiple Zone	There are no Location Exception records to display.		There are no Increased Density records to display.	
	Commingled				

Casing and Cement							
Type	Size	Weight	Grade	Feet	PSI	SAX	Top of CMT
PRODUCTION	5 12			2100		200	SURFACE

Liner								
Type	Size	Weight	Grade	Length	PSI	SAX	Top Depth	Bottom Depth
There are no Liner records to display.								

Total Depth: 2100

Packer		Plug	
Depth	Brand & Type	Depth	Plug Type
1440	TENSION	There are no Plug records to display.	

Initial Test Data

Test Date	Formation	Oil BBL/Day	Oil-Gravity (API)	Gas MCF/Day	Gas-Oil Ratio Cu FT/BBL	Water BBL/Day	Pumpin or Flowing	Initial Shut- In Pressure	Choke Size	Flow Tubing Pressure
-----------	-----------	----------------	----------------------	----------------	----------------------------	------------------	----------------------	---------------------------------	---------------	-------------------------

There are no Initial Data records to display.

Completion and Test Data by Producing Formation

Formation Name: STRAY

Code: 000STRY

Class: DISP

Spacing Orders

Order No

Unit Size

There are no Spacing Order records to display.

Perforated Intervals

From

To

1490

1500

1518

1524

Acid Volumes

YES

Fracture Treatments

YES

Formation Name: GLENN

Code: 404GLNN

Class: DISP

Spacing Orders

Order No

Unit Size

There are no Spacing Order records to display.

Perforated Intervals

From

To

1584

1600

Acid Volumes

YES

Fracture Treatments

NONE

Formation Name: DUTCHER

Code: 403DTCR

Class: DISP

Spacing Orders

Order No

Unit Size

There are no Spacing Order records to display.

Perforated Intervals

From

To

2052

2070

Acid Volumes

YES

Fracture Treatments

NONE

Formation	Top
STRAY	1490
GLENN	1570
DUTCHER	2000

Were open hole logs run? No

Date last log run:

Were unusual drilling circumstances encountered? No

Explanation:

Other Remarks

OCC - UIC PERMIT NUMBER 2002000049

FOR COMMISSION USE ONLY

1147542

Status: Accepted

037-22358-01

RECEIVED

Form 1002A

Rev. 2020

FEB 09 2022

API NO. **372235-8**
 OTC PROD.
 UNIT NO.

Oil and Gas Conservation Division
 P.O. Box 52000
 Oklahoma City, OK 73152-2000
 405-522-0577
 OCCCentralProcessing@OCC.OK.GOV



OKLAHOMA
 Corporation
 Commission

ORIGINAL *convert to waste disposal*
 AMENDED (Reason)

Rule 165:10-3-25
 COMPLETION REPORT

OKLAHOMA CORPORATION
 COMMISSION

TYPE OF DRILLING OPERATION
☒ STRAIGHT HOLE ☐ DIRECTIONAL HOLE ☐ HORIZONTAL HOLE
☒ SERVICE WELL
 If directional or horizontal, see reverse for bottom hole location.

SPUD DATE **9-21-79**
 DRLG FINISHED DATE **9-24-79**
 DATE OF WELL COMPLETION **11-24-79**
 1st PROD DATE **12-11-79**
 RECOMP DATE **10-30-2019**
 DATE **10-30-2019**
 OPERATOR NO. **23380**

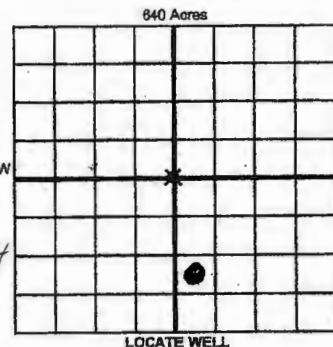

COUNTY **Creek** SEC **18** TWP **7N** RGE **12E**
 LEASE NAME **Farmer** WELL NO. **#2**
SE 1/4 NW 1/4 SW 1/4 SE 1/4 FSL 900 575
 ELEVATION **784** Ground **780** Latitude Longitude
 OPERATOR NAME **T. BAC M. Energy Res. LLC** OTC / OCC OPERATOR NO. **23380**
 ADDRESS **P.O. BOX 3724**
 CITY **Kiefer** STATE **OK** ZIP **74041**

COMPLETION TYPE
☒ SINGLE ZONE
☐ MULTIPLE ZONE
☐ COMMINGLED
 LOCATION EXCEPTION ORDER NO.
 MULTIUNIT ORDER NO.
 INCREASED DENSITY ORDER NO.

CASING & CEMENT (Attach Form 1002C)

TYPE	SIZE	WEIGHT	GRADE	FEET	PSI	SAX	TOP OF CMT
CONDUCTOR							
SURFACE							
INTERMEDIATE							
PRODUCTION	5 1/2			2100		800	Surface
LINER							

PACKER @ **1440** BRAND & TYPE **Tension** PLUG @ TYPE PLUG @ TYPE
 PACKER @ BRAND & TYPE PLUG @ TYPE PLUG @ TYPE
 TOTAL DEPTH **2100**

COMPLETION & TEST DATA BY PRODUCING FORMATION **COOSTRY, 904GLNN, 403DTCS**

FORMATION	Stray	Glenn	Dutcher	No new treatments
SPACING & SPACING ORDER NUMBER				
CLASS: Oil, Gas, Dry, Int, Disp, Comm Disp, Svc	Disposal	Disposal	Disposal	
PERFORATED INTERVALS	1490-1500	1584-1600	2052	
	1518-1524		-2070	
	2 holes / ft	2 holes / ft	2 holes / ft	
ACID/VOLUME	Yes	Yes	Yes	
FRACTURE TREATMENT (Fluids/Prop Amounts)	Yes	No	No	

Min Gas Allowable (165:10-17-7)

OR

Oil Allowable (165:10-13-3)

Purchaser/Measurer

First Sales Date

INITIAL TEST DATA

INITIAL TEST DATE	12-11-79	12-11-79	12-11-79
OIL-BBL/DAY	3	3	0
OIL-GRAVITY (API)	36	36	36
GAS-MCF/DAY			
GAS-OIL RATIO CU FT/BBL			
WATER-BBL/DAY	15	600	150
PUMPING OR FLOWING	Pumping	Pumping	Pumping
INITIAL SHUT-IN PRESSURE			
CHOKE SIZE			
FLOW TUBING PRESSURE			

A record of the formations drilled through, and pertinent remarks are presented on the reverse. I declare that I have knowledge of the contents of this report and am authorized by my organization to make this report, which was prepared by me or under my supervision and direction, with the data and facts stated herein to be true, correct, and complete to the best of my knowledge and belief.

SIGNATURE **Chad Cartledge** NAME (PRINT OR TYPE) **Chad Cartledge** DATE **7-6-22** PHONE NUMBER **(918) 671-3238**
 ADDRESS **13400 South Garrett St.** CITY **Sapulpa** STATE **OK** ZIP **74066** EMAIL ADDRESS **Cartledge@energy.vch.com**

PLEASE TYPE OR USE BLACK INK ONLY
FORMATION RECORD

Give formation names and tops, if available, or descriptions and thickness of formations drilled through. Show intervals cored or drillstem tested.

NAMES OF FORMATIONS	TOP
Dutcher 2000	
Glenn 1570	
Stray 1490	

LEASE NAME

Farmer

WELL NO.

#2

FOR COMMISSION USE ONLY

ITD on file ☐ YES ☐ NO

APPROVED DISAPPROVED

2) Reject Codes

Were open hole logs run?

☒ yes ☐ no

Date Last log was run

Was CO₂ encountered?

☐ yes ☐ no at what depths?

Was H₂S encountered?

☐ yes ☐ no at what depths?

Were unusual drilling circumstances encountered?
If yes, briefly explain below

☐ yes ☐ no

Other remarks:

OCC - UIC permit 2002000049

640 Acres

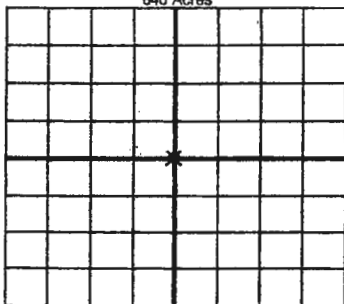

If more than three drainholes are proposed, attach a separate sheet indicating the necessary information.

Direction must be stated in degrees azimuth. Please note, the horizontal drainhole and its end point must be located within the boundaries of the lease or spacing unit.

Directional surveys are required for all drainholes and directional wells

640 Acres

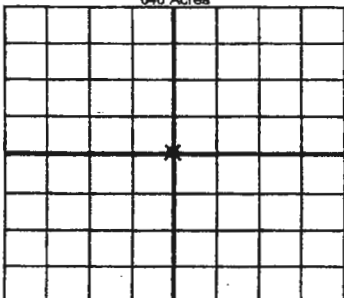

BOTTOM HOLE LOCATION FOR DIRECTIONAL HOLE

SEC	TWP	RGE	COUNTY
1/4	1/4	1/4	1/4
Measured Total Depth	True Vertical Depth	Feet From 1/4 Sec Lines	
		BHL From Lease, Unit, or Property Line:	

BOTTOM HOLE LOCATION FOR HORIZONTAL HOLE: (LATERALS)

SEC	TWP	RGE	COUNTY
1/4	1/4	1/4	1/4
Depth of Deviation	Radius of Turn	Direction	Total Length
Measured Total Depth	True Vertical Depth	BHL From Lease, Unit, or Property Line:	

SEC	TWP	RGE	COUNTY
1/4	1/4	1/4	1/4
Depth of Deviation	Radius of Turn	Direction	Total Length
Measured Total Depth	True Vertical Depth	BHL From Lease, Unit, or Property Line:	

SEC	TWP	RGE	COUNTY
1/4	1/4	1/4	1/4
Depth of Deviation	Radius of Turn	Direction	Total Length
Measured Total Depth	True Vertical Depth	BHL From Lease, Unit, or Property Line:	