

Oklahoma Corporation Commission
Oil & Gas Conservation Division
Post Office Box 52000
Oklahoma City, Oklahoma 73152-2000
Rule 165: 10-3-25

Form 1002A

API No.: 35133303140003

Completion Report

Spud Date: September 22, 1967

OTC Prod. Unit No.:

Drilling Finished Date: October 03, 1967

Amended

1st Prod Date: October 23, 1967

Amend Reason: CASING PROBLEM RAN NEW 4 1/2" LINER

Completion Date: October 20, 1967

Recomplete Date: April 09, 2021

Drill Type: SERVICE WELL

SERVICE WELL

Well Name: J W BROWN 4

Purchaser/Measurer:

Location: SEMINOLE 29 8N 8E
S2 SW NW SE
1440 FSL 330 FWL of 1/4 SEC
Latitude: 35.134319 Longitude: -96.484421
Derrick Elevation: 0 Ground Elevation: 0

First Sales Date:

Operator: BILL WEEMS OIL LLC 2315
PO BOX 1258
2501 HIGHWAY 9 W
SEMINOLE, OK 74818-1258

Completion Type		Location Exception		Increased Density	
	Single Zone	Order No		Order No	
	Multiple Zone	There are no Location Exception records to display.		There are no Increased Density records to display.	
	Commingled				

Casing and Cement								
Type		Size	Weight	Grade	Feet	PSI	SAX	Top of CMT
SURFACE		8.625	24	J-55	704	2500	400	SURFACE
PRODUCTION		5.50	14	J-55	4095	3500	230	2725

Liner								
Type	Size	Weight	Grade	Length	PSI	SAX	Top Depth	Bottom Depth
LINER	4 1/2		J-55	3130	0	150	0	3130

Total Depth: 4098

Packer		Plug	
Depth	Brand & Type	Depth	Plug Type
3121	ARROW TENSION	There are no Plug records to display.	

Initial Test Data

Test Date	Formation	Oil BBL/Day	Oil-Gravity (API)	Gas MCF/Day	Gas-Oil Ratio Cu FT/BBL	Water BBL/Day	Pumpin or Flowing	Initial Shut- In Pressure	Choke Size	Flow Tubing Pressure
-----------	-----------	----------------	----------------------	----------------	----------------------------	------------------	----------------------	---------------------------------	---------------	-------------------------

There are no Initial Data records to display.

Completion and Test Data by Producing Formation

Formation Name: UNION VALLEY-CROMWELL

Code: 402UVCM

Class: DISP

Spacing Orders

Order No	Unit Size
There are no Spacing Order records to display.	

Perforated Intervals

From	To
3156	3170

Acid Volumes

There are no Acid Volume records to display.	
----------------------------------------------	--

Fracture Treatments

There are no Fracture Treatments records to display.	
------------------------------------------------------	--

Formation Name: HUNTON

Code: 269HNTN

Class: DISP

Spacing Orders

Order No	Unit Size
There are no Spacing Order records to display.	

Perforated Intervals

From	To
3887	4022

Acid Volumes

There are no Acid Volume records to display.	
----------------------------------------------	--

Fracture Treatments

There are no Fracture Treatments records to display.	
------------------------------------------------------	--

Formation	Top
BOOCH	2887
UNION VALLEY-CROMWELL	3156
HUNTON	3887

Were open hole logs run? No

Date last log run:

Were unusual drilling circumstances encountered? No

Explanation:

Other Remarks

CASING PROBLEMS CHANGED 5 1/2 CASING TO NEW 4 1/2 CASING. MIT SUCCESSFUL APRIL 9, 2021 BY GARY WOOD, FIELD REPRESENTATIVE. PACKER DEPTH ACTUAL 3,121'. OCC - D-V TOOL IN 5 1/2" CASING AT 3,450', USED 140 SACKS OF CEMENT LIFTED CEMENT TO 2,725' CALCULATED TOP.
OCC - UIC ORDER NUMBER 428585

FOR COMMISSION USE ONLY

1147631

Status: Accepted

API NO. 133-30314
OTC PROD. UNIT NO. 2315

Oil and Gas Conservation Division
P.O. Box 52000
Oklahoma City, OK 73152-2000
405-522-0577
OCCCentralProcessing@OCC.OK.GOV

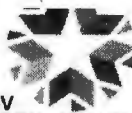

OKLAHOMA
Corporation
Commission

Form 1002A
Rev. 2020

☒ ORIGINAL
☐ AMENDED (Reason)

Casing Problem RAN NEW 4 1/2 LINER

Rule 165:10-3-25

COMPLETION REPORT

TYPE OF DRILLING OPERATION

☒ STRAIGHT HOLE ☐ DIRECTIONAL HOLE ☐ HORIZONTAL HOLE

☒ SERVICE WELL

If directional or horizontal, see reverse for bottom hole location.

COUNTY	Seminole	SEC	29	TWP	8N	RGE	8E	SPUD DATE	9-22-1967
LEASE NAME	J.W. BROWN	WELL NO.	4	DATE OF WELL COMPLETION	10-20-1967	DRLG FINISHED DATE	10-3-1967	1st PROD DATE	10-23-1967
S2 1/4 SW 1/4 NW 1/4 SE 1/4	1440	FNL	330	RECOMP DATE	4-9-21?				
ELEVATION	Ground	Latitude		Longitude					
OPERATOR NAME	Bill Weems Oil LLC	OTC / OCC OPERATOR NO.	2315						
ADDRESS	P.O. Box 1258								
CITY	Seminole	STATE	OK	ZIP	74808				

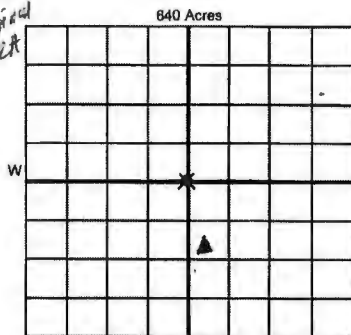

COMPLETION TYPE

<input type="radio"/> SINGLE ZONE	
<input type="radio"/> MULTIPLE ZONE	
<input type="radio"/> COMMINGLED	
LOCATION EXCEPTION ORDER NO.	
MULTIUNIT ORDER NO.	
INCREASED DENSITY ORDER NO.	

CASING & CEMENT (Attach Form 1002C)

TYPE	SIZE	WEIGHT	GRADE	FEET	PSI	SAX	TOP OF CMT
CONDUCTOR							
SURFACE	8.625	24#	55	704	2500	400	surface
INTERMEDIATE	5.50	14#	55	3450	3500	140	2725
PRODUCTION	5.50	14#	55	4095	3500	90	3625
LINER	4 1/2		5-55	surface-3130			

PACKER @ 3121 BRAND & TYPE Union Tension
PACKER @ BRAND & TYPE PLUG @ TYPE PLUG @ TYPE

COMPLETION & TEST DATA BY PRODUCING FORMATION

FORMATION	(Union Valley - Commwell) Hurdon		
SPACING & SPACING ORDER NUMBER	NA		
CLASS: Oil, Gas, Dry, Inj. Disp, Comm Disp, Svc	Disposal	Disposal	
PERFORATED INTERVALS	3156-3170	3887-4022	
ACID/VOLUME	NA		
FRACTURE TREATMENT (Fluids/Prop Amounts)	NA		

RECEIVED

APR 19 2011

Oklahoma Corporation Commission

Min Gas Allowable (165:10-17-7)

OR

Oil Allowable (165:10-13-3)

Purchaser/Measurer

First Sales Date

INITIAL TEST DATA

INITIAL TEST DATE					
OIL-BBL/DAY					
OIL-GRAVITY (API)					
GAS-MCF/DAY					
GAS-OIL RATIO CU FT/BBL					
WATER-BBL/DAY					
PUMPING OR FLOWING					
INITIAL SHUT-IN PRESSURE					
CHOKE SIZE					
FLOW TUBING PRESSURE					

A record of the formations drilled through, and pertinent remarks are presented on the reverse. I declare that I have knowledge of the contents of this report and am authorized by my organization to make this report, which was prepared by me or under my supervision and direction, with the data and facts stated herein to be true, correct, and complete to the best of my knowledge and belief.

SIGNATURE

NAME (PRINT OR TYPE)

DATE

PHONE NUMBER

ADDRESS

CITY

STATE

ZIP

EMAIL ADDRESS

PLEASE TYPE OR USE BLACK INK ONLY

FORMATION RECORD

Give formation names and tops, if available, or descriptions and thickness of formations drilled through. Show intervals cored or drillstem tested.

NAMES OF FORMATIONS	TOP
Dispose to the	
Cromwell/Hunton zone	
Booch	2887
Union Valley-Cromwell	3156
Hunton	3887

LEASE NAME J.W. Brown # 4 WELL NO. 4

FOR COMMISSION USE ONLY	
ITD on file <input type="checkbox"/> YES <input type="checkbox"/> NO	
APPROVED _____	DISAPPROVED _____
2) Reject Codes	

Were open hole logs run?	<input type="radio"/> yes <input type="radio"/> no
Date Last log was run	_____
Was CO ₂ encountered?	<input type="radio"/> yes <input type="radio"/> no at what depths? _____
Was H ₂ S encountered?	<input type="radio"/> yes <input type="radio"/> no at what depths? _____
Were unusual drilling circumstances encountered?	<input type="radio"/> yes <input type="radio"/> no
If yes, briefly explain below	

Other remarks:

* CASING PROBLEMS CHANGED 5 1/2" CASING TO NEW 4 1/2" CASING -
 MIT Successful 4-9-21 Dr Gary Wood. Field Rep.
 APE 133-30314 Packer Depth - Actual 3121'
 OCC - DVT tool in 5 1/2" casing at 3450 used 140 sacks of cement lifted cement
 to 2725 calculated top
 OCC - UIC order 428585

640 Acres

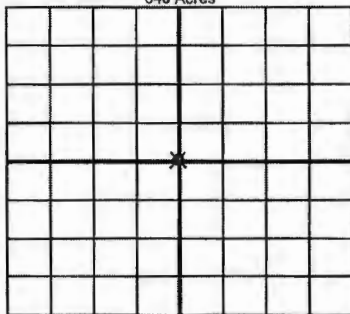

If more than three drainholes are proposed, attach a separate sheet indicating the necessary information.

Direction must be stated in degrees azimuth.
 Please note, the horizontal drainhole and its end point must be located within the boundaries of the lease or spacing unit.

Directional surveys are required for all drainholes and directional wells

640 Acres

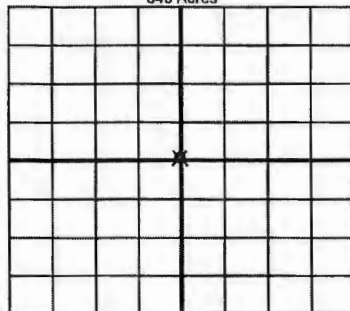

BOTTOM HOLE LOCATION FOR DIRECTIONAL HOLE

SEC	TWP	RGE	COUNTY
1/4	1/4	1/4	1/4
Measured Total Depth		True Vertical Depth	Feet From 1/4 Sec Lines BHL From Lease, Unit, or Property Line:

BOTTOM HOLE LOCATION FOR HORIZONTAL HOLE: (LATERALS)

LATERAL #1

SEC	TWP	RGE	COUNTY
1/4	1/4	1/4	1/4
Depth of Deviation	Radius of Turn	Direction	Total Length
Measured Total Depth	True Vertical Depth	BHL From Lease, Unit, or Property Line:	

LATERAL #2

SEC	TWP	RGE	COUNTY
1/4	1/4	1/4	1/4
Depth of Deviation	Radius of Turn	Direction	Total Length
Measured Total Depth	True Vertical Depth	BHL From Lease, Unit, or Property Line:	

LATERAL #3

SEC	TWP	RGE	COUNTY
1/4	1/4	1/4	1/4
Depth of Deviation	Radius of Turn	Direction	Total Length
Measured Total Depth	True Vertical Depth	BHL From Lease, Unit, or Property Line:	

[illegible]

PLEASE TYPE OR USE BLOCKS ONLY
 FORMATION RECORD

Section No. 11 / Norton Zone

Well No. 114 Brown 4

FOR COMPLETION USE ONLY

Is the well ☐ YES ☐ NO

APPROVED ☐ DISAPPROVED ☐ Report Card

Other remarks: Changing Problems Changing 5' to 4' casing for now 4 1/2 casing -
MT Successful 4-21 by Gary Wood Field Rep.
API 133-30314 Packoff Depth - Actual 3121

SECTION 16

BOTTOM HOLE LOCATION FOR DIRECTIONAL HOLE

SEC	TWP	RGE	COUNTY
14	14	14	14
Measured Total Depth	True Vertical Depth	Feet From 1/4 Sec Line	
		S/N, From Lateral, Unit, or Property Line	

BOTTOM HOLE LOCATION FOR HORIZONTAL HOLE: LATERAL

LATERAL #1

SEC	TWP	RGE	COUNTY
14	14	14	14
Depth of Deviation	Radius of Turn	Direction	Total Length
Measured Total Depth	True Vertical Depth	S/N, From Lateral, Unit, or Property Line	

LATERAL #2

SEC	TWP	RGE	COUNTY
14	14	14	14
Depth of Deviation	Radius of Turn	Direction	Total Length
Measured Total Depth	True Vertical Depth	S/N, From Lateral, Unit, or Property Line	

LATERAL #3

SEC	TWP	RGE	COUNTY
14	14	14	14
Depth of Deviation	Radius of Turn	Direction	Total Length
Measured Total Depth	True Vertical Depth	S/N, From Lateral, Unit, or Property Line	