

Oklahoma Corporation Commission
Oil & Gas Conservation Division
Post Office Box 52000
Oklahoma City, Oklahoma 73152-2000
Rule 165: 10-3-25

Form 1002A

API No.: 35047252050000

Completion Report

Spud Date: April 16, 2020

OTC Prod. Unit No.:

Drilling Finished Date: April 23, 2020

1st Prod Date:

Completion Date: April 23, 2020

Drill Type: STRAIGHT HOLE

Well Name: BAMBERG 1-2

Purchaser/Measurer:

Location: GARFIELD 2 21N 3W
C S2 SE SE
330 FSL 660 FEL of 1/4 SEC
Latitude: 36.31920858 Longitude: -97.4809991
Derrick Elevation: 1114 Ground Elevation: 1011

First Sales Date:

Operator: RUFFEL LANCE OIL & GAS LLC 15459

210 PARK AVE STE 2150
OKLAHOMA CITY, OK 73102-5632

Completion Type		Location Exception		Increased Density	
	Single Zone	Order No		Order No	
	Multiple Zone	There are no Location Exception records to display.		There are no Increased Density records to display.	
	Commingled				

Casing and Cement							
Type	Size	Weight	Grade	Feet	PSI	SAX	Top of CMT
SURFACE	8 5/8	32	J-55	253		160	253

Liner								
Type	Size	Weight	Grade	Length	PSI	SAX	Top Depth	Bottom Depth
There are no Liner records to display.								

Total Depth: 5750

Packer		Plug	
Depth	Brand & Type	Depth	Plug Type
There are no Packer records to display.		5750	PLUG

Initial Test Data										
Test Date	Formation	Oil BBL/Day	Oil-Gravity (API)	Gas MCF/Day	Gas-Oil Ratio Cu FT/BBL	Water BBL/Day	Pumpin or Flowing	Initial Shut-In Pressure	Choke Size	Flow Tubing Pressure
There are no Initial Data records to display.										
Completion and Test Data by Producing Formation										

Formation Name: NONE

Code:

Class: PLUG AND ABANDON

Formation	Top
MISSISSIPPIAN	5160
WOODFORD	5480
VIOLA	5530
FIRST WILCOX	5660
SECOND WILCOX	5750

Were open hole logs run? Yes

Date last log run:

Were unusual drilling circumstances encountered? No

Explanation:

Other Remarks

There are no Other Remarks.

FOR COMMISSION USE ONLY

1145458

Status: Accepted

API NO. **04725205**
OTC PROD.
UNIT NO.

PLEASE TYPE OR USE BLACK INK ONLY
NOTE:
Attach copy of original 1002A if recompletion or reentry.

OKLAHOMA CORPORATION COMMISSION
Oil & Gas Conservation Division
Post Office Box 52000
Oklahoma City, Oklahoma 73152-2000
Rule 165:10-3-25

RECEIVED Form 1002A
Rev. 2009

AUG 05 2020

**Oklahoma Corporation
Commission**

☒ ORIGINAL
☐ AMENDED (Reason) _____

COMPLETION REPORT

TYPE OF DRILLING OPERATION

☒ STRAIGHT HOLE ☐ DIRECTIONAL HOLE ☐ HORIZONTAL HOLE
☐ SERVICE WELL

If directional or horizontal, see reverse for bottom hole location.

COUNTY	Garfield	SEC	2	TWP	21N	RGE	3W
LEASE NAME	Bamberg			WELL NO.	1-2		
C 1/4 S2 1/4 SE 1/4 SE 1/4	FSL	330'	FWL OF 1/4 SEC	660'	DATE OF WELL COMPLETION	4/23/2020	
ELEVATION N Derrick	1114'	Ground	1011'	Latitude (if known)	36.31920858	Longitude (if known)	97.48099991
OPERATOR NAME	LANCE RUFFEL OIL & GAS LLC			OTC/OCC OPERATOR NO.	15459-0		
ADDRESS	210 PARK AVENUE, SUITE 2150						
CITY	OKLAHOMA CITY		STATE	OK	ZIP	73102	

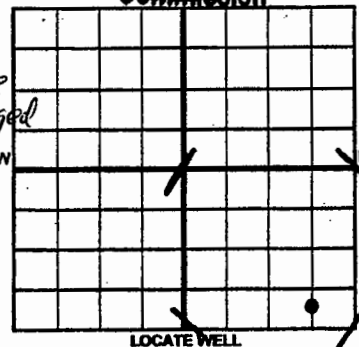

COMPLETION TYPE

<input type="checkbox"/> SINGLE ZONE
<input type="checkbox"/> MULTIPLE ZONE
Application Date
<input type="checkbox"/> COMMINGLED
Application Date
LOCATION
EXCEPTION ORDER
INCREASED DENSITY
ORDER NO.

CASING & CEMENT (Form 1002C must be attached)

TYPE	SIZE	WEIGHT	GRADE	FEET	PSI	SAX	TOP OF CMT
CONDUCTOR							
SURFACE	8 5/8	32#	J-55	253 252.96		160	253'
INTERMEDIATE							
PRODUCTION							
LINER							

PACKER @ _____ BRAND & TYPE _____ PLUG @ 5,750' TYPE _____ PLUG @ _____ TYPE _____ TOTAL DEPTH 5750'
PACKER @ _____ BRAND & TYPE _____ PLUG @ _____ TYPE _____ PLUG @ _____ TYPE _____

COMPLETION & TEST DATA BY PRODUCING FORMATION

FORMATION	-Wilcox-					
SPACING & SPACING						
ORDER NUMBER						
CLASS: Oil, Gas, Dry, Inf.						
Disp, Comm Disp, Svc	Box PVA					
PERFORATED INTERVALS						
ACID/VOLUME						
FRACTURE TREATMENT (Fluids/Prop Amounts)						

Min Gas Allowable (165:10-17-7)
OR
Oil Allowable (165:10-13-3)

Gas Purchaser/Measurer
First Sales Date

INITIAL TEST DATA

INITIAL TEST DATE						
OIL-BBL/DAY						
OIL-GRAVITY (API)						
GAS-MCF/DAY						
GAS-OIL RATIO CU FT/BBL						
WATER-BBL/DAY						
PUMPING OR FLOWING						
INITIAL SHUT-IN PRESSURE						
CHOKE SIZE						
FLOW TUBING PRESSURE						

A record of the formations drilled through, and pertinent remarks are presented on the reverse. I declare that I have knowledge of the contents of this report and am authorized by my organization to make this report, which was prepared by me or under my supervision and direction, with the data and facts stated herein to be true, correct, and complete to the best of my knowledge and belief.

SIGNATURE Lance Ruffel NAME (PRINT OR TYPE) LANCE RUFFEL DATE 7.28.20 PHONE NUMBER 405/239-7036
210 PARK AVENUE, SUITE 2150 OKLAHOMA CITY OK 73102
ADDRESS CITY STATE ZIP EMAIL ADDRESS

PLEASE TYPE OR USE BLACK INK ONLY

FORMATION RECORD

Give formation names and tops, if available, or descriptions and thickness of formations drilled through. Show intervals cored or dristern tested.

NAMES OF FORMATIONS	TOP
Mississippian	5160'
Woodford	5480'
Viola	5530'
First Wilcox	5660'
Second Wilcox	5750'
TD	5750'

LEASE NAME _____

WELL NO. _____

FOR COMMISSION USE ONLY	
ITD on file	<input type="checkbox"/> YES <input type="checkbox"/> NO
APPROVED	DISAPPROVED
2) Reject Codes	

Were open hole logs run?	<input checked="" type="checkbox"/> yes <input type="checkbox"/> no
Date Last log was run	_____
Was CO ₂ encountered?	<input type="checkbox"/> yes <input checked="" type="checkbox"/> no at what depths? _____
Was H ₂ S encountered?	<input type="checkbox"/> yes <input checked="" type="checkbox"/> no at what depths? _____
Were unusual drilling circumstances encountered?	<input type="checkbox"/> yes <input type="checkbox"/> no
If yes, briefly explain below	

Other remarks:

640 Acres

If more than three drainholes are proposed, attach a separate sheet indicating the necessary information.

Direction must be stated in degrees azimuth.
Please note, the horizontal drainhole and its end point must be located within the boundaries of the lease or spacing unit.

Directional surveys are required for all drainholes and directional wells.

640 Acres

BOTTOM HOLE LOCATION FOR DIRECTIONAL HOLE

SEC	TWP	RGE	COUNTY			
Spot Location				1/4	1/4	1/4
Measured Total Depth				True Vertical Depth		
				BHL From Lease, Unit, or Property Line:		

BOTTOM HOLE LOCATION FOR HORIZONTAL HOLE: (LATERALS)

SEC	TWP	RGE	COUNTY	Seminole		
Spot Location				1/4	1/4	1/4
Depth of Deviation				Radius of Turn		Direction
Measured Total Depth				True Vertical Depth		BHL From Lease, Unit, or Property Line:

LATERAL #2

SEC	TWP	RGE	COUNTY			
Spot Location				1/4	1/4	1/4
Depth of Deviation				Radius of Turn		Direction
Measured Total Depth				True Vertical Depth		BHL From Lease, Unit, or Property Line:

LATERAL #3

SEC	TWP	RGE	COUNTY			
Spot Location				1/4	1/4	1/4
Depth of Deviation				Radius of Turn		Direction
Measured Total Depth				True Vertical Depth		BHL From Lease, Unit, or Property Line: