

Oklahoma Corporation Commission
Oil & Gas Conservation Division
Post Office Box 52000
Oklahoma City, Oklahoma 73152-2000
Rule 165: 10-3-25

Form 1002A

API No.: 35141205270002

Completion Report

Spud Date: November 30, 2021

OTC Prod. Unit No.:

Drilling Finished Date: December 05, 2021

1st Prod Date: February 12, 2022

Completion Date: February 09, 2022

Drill Type: STRAIGHT HOLE

Well Name: BRUSER 1-10

Purchaser/Measurer:

Location: TILLMAN 10 3S 18W
NE SW NE NW
673 FNL 835 FEL of 1/4 SEC
Latitude: 34.31777761 Longitude: -99.07408826
Derrick Elevation: 0 Ground Elevation: 1217

First Sales Date:

Operator: AC OPERATING COMPANY LLC 23061

952 ECHO LN STE 390
HOUSTON, TX 77024-2851

Completion Type		Location Exception		Increased Density	
X	Single Zone	Order No		Order No	
	Multiple Zone	There are no Location Exception records to display.		There are no Increased Density records to display.	
	Commingled				

Casing and Cement							
Type	Size	Weight	Grade	Feet	PSI	SAX	Top of CMT
SURFACE	8 5/8	24	J-55	211		150	SURFACE
PRODUCTION	4 1/2	11.6	J-55	5228		250	3720

Liner								
Type	Size	Weight	Grade	Length	PSI	SAX	Top Depth	Bottom Depth
There are no Liner records to display.								

Total Depth: 5260

Packer	
Depth	Brand & Type
There are no Packer records to display.	

Plug	
Depth	Plug Type
5090	CIBP
5140	CIBP

Initial Test Data

Test Date	Formation	Oil BBL/Day	Oil-Gravity (API)	Gas MCF/Day	Gas-Oil Ratio Cu FT/BBL	Water BBL/Day	Pumpin or Flowing	Initial Shut-In Pressure	Choke Size	Flow Tubing Pressure
Feb 15, 2022	STRAWN B	5	40			14	PUMPING		OPEN	

Completion and Test Data by Producing Formation

Formation Name: STRAWN B

Code: 404STRNB

Class: OIL

Spacing Orders

Order No	Unit Size
712283	80

Perforated Intervals

From	To
5057	5072

Acid Volumes

2,500 GALLONS 15%

Fracture Treatments

There are no Fracture Treatments records to display.
--

Formation Name: STRAWN C

Code: 404STRNC

Class: DRY

Spacing Orders

Order No	Unit Size
712283	80

Perforated Intervals

From	To
5092	5098

Acid Volumes

1,500 GALLONS 15%

Fracture Treatments

There are no Fracture Treatments records to display.
--

Formation Name: STRAWN D

Code: 404STRND

Class: DRY

Spacing Orders

Order No	Unit Size
712283	80

Perforated Intervals

From	To
5145	5151

Acid Volumes

500 GALLONS 15%

Fracture Treatments

There are no Fracture Treatments records to display.
--

Formation	Top
HENDERSON	3126
CANYON	3373
STRAWN	4023
MORROW	5158

Were open hole logs run? Yes

Date last log run: December 06, 2021

Were unusual drilling circumstances encountered? No

Explanation:

Other Remarks

There are no Other Remarks.

Status: Accepted

API NO. 141-20527
OTC PROD.
UNIT NO.

Oil and Gas Conservation Division
P.O. Box 52000
Oklahoma City, OK 73152-2000
405-621-2331
OCCCentralProcessing@OCC.OK.GOV



OKLAHOMA
Corporation
Commission

Form 1002A
Rev. 2021

ORIGINAL
AMENDED (Reason)

Rule 165:10-3-25

COMPLETION REPORT

TYPE OF DRILLING OPERATION
☒ STRAIGHT HOLE ☐ DIRECTIONAL HOLE ☐ HORIZONTAL HOLE
☐ SERVICE WELL

If directional or horizontal, see reverse for bottom hole location.

COUNTY Tillman SEC 10 TWP 3S RGE 18W
LEASE NAME Bruser
WELL NO. 1-10
DATE OF WELL COMPLETION 02/09/2022
1st PROD DATE 02/12/2022
RECOMP DATE
ELEVATION Derrick FL Ground 1217' Latitude 34.31777761 Longitude 99.07408826
OPERATOR NAME AC Operating Company, LLC OTC/OCC OPERATOR NO. 23061
ADDRESS 952 Echo Lane, Suite 390
CITY Houston STATE Texas ZIP 77024

640 Acres
LOCATE WELL

COMPLETION TYPE

☒ SINGLE ZONE
☐ MULTIPLE ZONE
☐ COMMINGLED
LOCATION EXCEPTION ORDER NO.
MULTIUNIT ORDER NO.
INCREASED DENSITY ORDER NO.

CASING & CEMENT (Attach Form 1002C)

TYPE	SIZE	WEIGHT	GRADE	FEET	PSI	SAX	TOP OF CMT
CONDUCTOR							
SURFACE	8-5/8"	24	J-55	211'		150	Sfc
INTERMEDIATE							
PRODUCTION	4-1/2"	11.6	J-55	5,228'		250	3,720'
LINER							

PACKER @ _____ BRAND & TYPE _____ PLUG @ 5,140' TYPE CIBP PLUG @ _____ TYPE _____ TOTAL DEPTH 5,260'
PACKER @ _____ BRAND & TYPE _____ PLUG @ 5,090' TYPE CIBP PLUG @ _____ TYPE _____

COMPLETION & TEST DATA BY PRODUCING FORMATION

FORMATION	Strawn B	Strawn C	Strawn D	No Frac
SPACING & SPACING ORDER NUMBER	712283(EO)	712283(EO)	712283(EO)	
CLASS: Oil, Gas, Dry, Inj. Disp, Comm Disp, Svc	Oil	Dry	Dry	
PERFORATED INTERVALS	5057-72'	5092-98'	5145-51'	
ACID/VOLUME	2500g 15%	1500g 15%	500g 15%	
FRACTURE TREATMENT (Fluids/Prop Amounts)				

☐ Min Gas Allowable (165:10-17-7)
OR
☐ Oil Allowable (165:10-13-3)

Purchaser/Measurer
First Sales Date

INITIAL TEST DATA

INITIAL TEST DATE	02/15/2022				
OIL-BBL/DAY	5				
OIL-GRAVITY (API)	40				
GAS-MCF/DAY					
GAS-OIL RATIO CU FT/BBL					
WATER-BBL/DAY	14				
PUMPING OR FLOWING	Pumping				
INITIAL SHUT-IN PRESSURE					
CHOKE SIZE	Open				
FLOW TUBING PRESSURE					

RECEIVED
MAR 28 2022
OKLAHOMA CORPORATION
COMMISSION

A record of the formations drilled through, and pertinent remarks are presented on the reverse. I declare that I have knowledge of the contents of this report and am authorized by my organization to make this report, which was prepared by me or under my supervision and direction, with the data and facts stated herein to be true, correct, and complete to the best of my knowledge and belief.

SIGNATURE Michael A. Odegard
NAME (PRINT OR TYPE)
952 Echo Lane, Suite 390 Houston Texas 77024
ADDRESS CITY STATE ZIP
03/24/2022 (713) 881-9030
DATE PHONE NUMBER
maodegard@acexploration.com
EMAIL ADDRESS

PLEASE TYPE OR USE BLACK INK ONLY
FORMATION RECORD

Give formation names and tops, if available, or descriptions and thickness of formations drilled through. Show intervals cored or drillstem tested.

LEASE NAME Bruser WELL NO. 10-1

NAMES OF FORMATIONS	TOP
Top of Henderson	3126
Top of Canyon	3373
Top of Strawn	4023
Top of Morrow	5158

FOR COMMISSION USE ONLY	
ITD on file <input type="checkbox"/> YES <input type="checkbox"/> NO	
APPROVED _____	DISAPPROVED _____
2) Reject Codes	

Were open hole logs run?	<input checked="" type="radio"/> yes <input type="radio"/> no
Date Last log was run	<u>12/06/2021</u>
Was CO ₂ encountered?	<input type="radio"/> yes <input checked="" type="radio"/> no at what depths? _____
Was H ₂ S encountered?	<input type="radio"/> yes <input checked="" type="radio"/> no at what depths? _____
Were unusual drilling circumstances encountered?	<input type="radio"/> yes <input checked="" type="radio"/> no
If yes, briefly explain below	

Other remarks: Pooling Order 720869

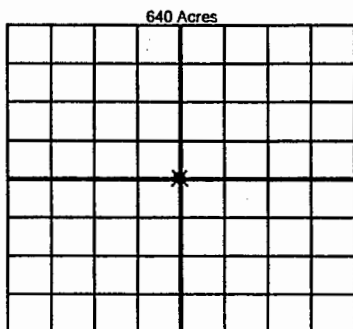

If more than three drainholes are proposed, attach a separate sheet indicating the necessary information.

Direction must be stated in degrees azimuth. Please note, the horizontal drainhole and its end point must be located within the boundaries of the lease or spacing unit.

Directional surveys are required for all drainholes and directional wells

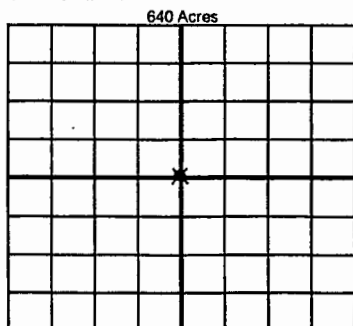

BOTTOM HOLE LOCATION FOR DIRECTIONAL HOLE

SEC	TWP	RGE	COUNTY
1/4	1/4	1/4	1/4
Measured Total Depth		True Vertical Depth	Feet From 1/4 Sec Lines
			BHL From Lease, Unit, or Property Line:

BOTTOM HOLE LOCATION FOR HORIZONTAL HOLE: (LATERALS)

LATERAL #1			
SEC	TWP	RGE	COUNTY
1/4	1/4	1/4	1/4
Depth of Deviation		Radius of Turn	Direction
Measured Total Depth		True Vertical Depth	Total Length
			BHL From Lease, Unit, or Property Line:

LATERAL #2			
SEC	TWP	RGE	COUNTY
1/4	1/4	1/4	1/4
Depth of Deviation		Radius of Turn	Direction
Measured Total Depth		True Vertical Depth	Total Length
			BHL From Lease, Unit, or Property Line:

LATERAL #3			
SEC	TWP	RGE	COUNTY
1/4	1/4	1/4	1/4
Depth of Deviation		Radius of Turn	Direction
Measured Total Depth		True Vertical Depth	Total Length
			BHL From Lease, Unit, or Property Line: