

Oklahoma Corporation Commission
Oil & Gas Conservation Division
Post Office Box 52000
Oklahoma City, Oklahoma 73152-2000
Rule 165: 10-3-25

Form 1002A

API No.: 35025210820000

Completion Report

Spud Date: May 07, 2021

OTC Prod. Unit No.:

Drilling Finished Date: May 10, 2021

1st Prod Date:

Completion Date: May 10, 2021

Drill Type: STRAIGHT HOLE

Well Name: PROTHRO 1-23

Purchaser/Measurer:

Location: CIMARRON 23 1N 8E CM
C SE NW
1980 FNL 1980 FWL of 1/4 SEC
Latitude: 36.5393305556 Longitude: -102.1690527778
Derrick Elevation: 3805 Ground Elevation: 3800

First Sales Date:

Operator: VERDUGO-PABLO ENERGY LLC 23040
PO BOX 2945
801 S FILLMORE STE 130
AMARILLO, TX 79105-2945

Completion Type		Location Exception		Increased Density	
	Single Zone	Order No		Order No	
	Multiple Zone	There are no Location Exception records to display.		There are no Increased Density records to display.	
	Commingled				

Casing and Cement							
Type	Size	Weight	Grade	Feet	PSI	SAX	Top of CMT
SURFACE	8.625	24	J-55	555	210	250	SURFACE

Liner								
Type	Size	Weight	Grade	Length	PSI	SAX	Top Depth	Bottom Depth
There are no Liner records to display.								

Total Depth: 1794

Packer		Plug	
Depth	Brand & Type	Depth	Plug Type
There are no Packer records to display.		There are no Plug records to display.	

Initial Test Data										
Test Date	Formation	Oil BBL/Day	Oil-Gravity (API)	Gas MCF/Day	Gas-Oil Ratio Cu FT/BBL	Water BBL/Day	Pumpin or Flowing	Initial Shut-In Pressure	Choke Size	Flow Tubing Pressure
There are no Initial Data records to display.										
Completion and Test Data by Producing Formation										

Formation Name: NONE	Code: 999NONE	Class: PLUG AND ABANDON
----------------------	---------------	-------------------------

Formation	Top
GLORIETA	1108
CIMARRON ANHYDRITE	1658
RED CAVE	1740

Were open hole logs run? No
Date last log run:
Were unusual drilling circumstances encountered? No
Explanation:

Other Remarks
FIRST RED CAVE SAND CAME IN 14' LOW TO OFFSET WELL, INDICATING NO STRUCTURAL HIGH, ABANDONED HOLE.

FOR COMMISSION USE ONLY	
Status: Accepted	1147917

RECEIVED

API NO. 35-025-21082
 OTC PROD. UNIT NO.

Oil and Gas Conservation Division
 P.O. Box 52000
 Oklahoma City, OK 73152-2000
 405-521-2331
 OCCCentralProcessing@OCC.OK.GOV



OKLAHOMA
 Corporation
 Commission

APR 07 2022 Form 1002A Rev. 2021

OKLAHOMA CORPORATION
 COMMISSION

☒ ORIGINAL
☐ AMENDED (Reason) Well drilled and abandoned - dry hole

Rule 165:10-3-25

COMPLETION REPORT

TYPE OF DRILLING OPERATION
☒ STRAIGHT HOLE ☐ DIRECTIONAL HOLE ☐ HORIZONTAL HOLE
☐ SERVICE WELL
 If directional or horizontal, see reverse for bottom hole location.

SPUD DATE 05/07/21
 DRLG FINISHED DATE 05/10/21
 DATE OF WELL COMPLETION D&A'd 5-10-21
 1st PROD DATE NA
 RECOMP DATE
 OTC / OCC OPERATOR NO. 23040

COUNTY Cimarron SEC 23 TWP 1N RGE 8ECM
 LEASE NAME Prothro WELL NO. 1-23
 1/4 C 1/4 SE 1/4 NW 1/4 FNL 1980 FWL 1980
 ELEVATION Derrick FL 3805 Ground 3800 Latitude Longitude
 OPERATOR NAME Verdugo-Pablo Energy LLC
 ADDRESS PO Box 2945
 CITY Amarillo STATE TX ZIP 79105

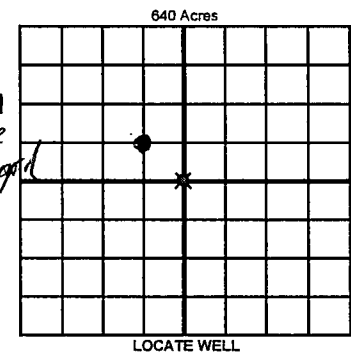

COMPLETION TYPE
☒ SINGLE ZONE
☐ MULTIPLE ZONE
☐ COMMINGLED
 LOCATION EXCEPTION ORDER NO.
 MULTIUNIT ORDER NO.
 INCREASED DENSITY ORDER NO.

CASING & CEMENT (Attach Form 1002C)							
TYPE	SIZE	WEIGHT	GRADE	FEET	PSI	SAX	TOP OF CMT
CONDUCTOR							
SURFACE	8.625	24	J-55	555	210	250	surface
INTERMEDIATE							
PRODUCTION							
LINER							

PACKER @ _____ BRAND & TYPE _____ PLUG @ _____ TYPE _____ PLUG @ _____ TYPE _____
 PACKER @ _____ BRAND & TYPE _____ PLUG @ _____ TYPE _____ PLUG @ _____ TYPE _____

TOTAL DEPTH 1794 Per 1003

COMPLETION & TEST DATA BY PRODUCING FORMATION

FORMATION						
SPACING & SPACING ORDER NUMBER						
CLASS: Oil, Gas, Dry, Inj. Disp, Comm Disp, Svc	P+A					
PERFORATED INTERVALS						
ACID/VOLUME						
FRACTURE TREATMENT (Fluids/Prop Amounts)						

☐ Min Gas Allowable (165:10-17-7) OR ☐ Oil Allowable (165:10-13-3) Purchaser/Measurer First Sales Date

INITIAL TEST DATA

INITIAL TEST DATE						
OIL-BBL/DAY						
OIL-GRAVITY (API)						
GAS-MCF/DAY						
GAS-OIL RATIO CU FT/BBL						
WATER-BBL/DAY						
PUMPING OR FLOWING						
INITIAL SHUT-IN PRESSURE						
CHOKE SIZE						
FLOW TUBING PRESSURE						

A record of the formations drilled through, and pertinent remarks are presented on the reverse. I declare that I have knowledge of the contents of this report and am authorized by my organization to make this report, which was prepared by me or under my supervision and direction, with the data and facts stated herein to be true, correct, and complete to the best of my knowledge and belief.

Dwyatt Jackson SIGNATURE Dwyatt Jackson 3/22/22 405-513-7121
 1759 W 33rd Suite 120 Edmond ok 73013
 ADDRESS CITY STATE ZIP d.jackson@pabloenergy.com EMAIL ADDRESS

PLEASE TYPE OR USE BLACK INK ONLY

FORMATION RECORD

Give formation names and tops, if available, or descriptions and thickness of formations drilled through. Show intervals cored or drillstem tested.

NAMES OF FORMATIONS	TOP
Glorieta	1108
cimarron anyhdrite	1658
red cave	1740

LEASE NAME Prothro WELL NO. 1-23

FOR COMMISSION USE ONLY	
ITD on file <input type="checkbox"/> YES <input type="checkbox"/> NO	
APPROVED	DISAPPROVED
2) Reject Codes	

Were open hole logs run?	<input type="radio"/> yes <input checked="" type="radio"/> no
Date Last log was run	
Was CO ₂ encountered?	<input type="radio"/> yes <input checked="" type="radio"/> no at what depths? _____
Was H ₂ S encountered?	<input type="radio"/> yes <input checked="" type="radio"/> no at what depths? _____
Were unusual drilling circumstances encountered?	<input type="radio"/> yes <input checked="" type="radio"/> no
If yes, briefly explain below	

Other remarks: 1st red cave sand came in 14' low to offset well, indicating no structural high, abandoned hole

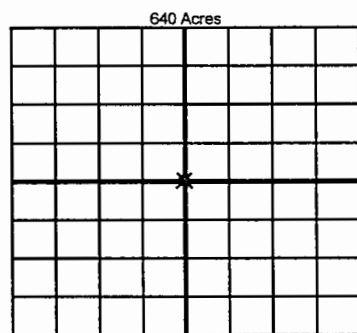

If more than three drainholes are proposed, attach a separate sheet indicating the necessary information.

Direction must be stated in degrees azimuth. Please note, the horizontal drainhole and its end point must be located within the boundaries of the lease or spacing unit.

Directional surveys are required for all drainholes and directional wells

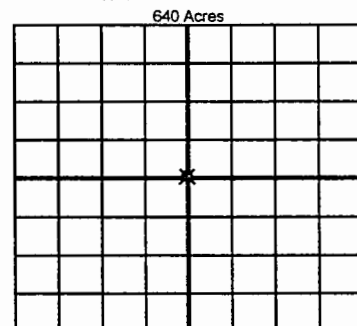

BOTTOM HOLE LOCATION FOR DIRECTIONAL HOLE

SEC	TWP	RGE	COUNTY
1/4	1/4	1/4	1/4
Measured Total Depth		True Vertical Depth	Feet From 1/4 Sec Lines
BHL From Lease, Unit, or Property Line:			

BOTTOM HOLE LOCATION FOR HORIZONTAL HOLE: (LATERALS)

LATERAL #1			
SEC	TWP	RGE	COUNTY
1/4	1/4	1/4	1/4
Depth of Deviation		Radius of Turn	Direction
Measured Total Depth		True Vertical Depth	Total Length
BHL From Lease, Unit, or Property Line:			

LATERAL #2			
SEC	TWP	RGE	COUNTY
1/4	1/4	1/4	1/4
Depth of Deviation		Radius of Turn	Direction
Measured Total Depth		True Vertical Depth	Total Length
BHL From Lease, Unit, or Property Line:			

LATERAL #3			
SEC	TWP	RGE	COUNTY
1/4	1/4	1/4	1/4
Depth of Deviation		Radius of Turn	Direction
Measured Total Depth		True Vertical Depth	Total Length
BHL From Lease, Unit, or Property Line:			