

Oklahoma Corporation Commission  
Oil & Gas Conservation Division  
Post Office Box 52000  
Oklahoma City, Oklahoma 73152-2000  
Rule 165: 10-3-25

Form 1002A

API No.: 35059226370000

**Completion Report**

Spud Date: October 05, 2021

OTC Prod. Unit No.: 059-227522-0-0000

Drilling Finished Date: October 17, 2021

1st Prod Date: January 19, 2022

Completion Date: December 14, 2021

**Drill Type: STRAIGHT HOLE**

Well Name: STU 1

Purchaser/Measurer:

Location: HARPER 33 29N 22W  
E2 W2 SW SW  
660 FSL 560 FWL of 1/4 SEC  
Latitude: 36.94573 Longitude: -99.59022  
Derrick Elevation: 1868 Ground Elevation: 1856

First Sales Date:

Operator: TEX-OK ENERGY LP 18105  
PO BOX 3010  
1501 STAMPEDE AVE STE 3200  
CODY, WY 82414-5915

Completion Type		Location Exception		Increased Density	
X	Single Zone	Order No		Order No	
	Multiple Zone	720828		There are no Increased Density records to display.	
	Commingle				

Casing and Cement							
Type	Size	Weight	Grade	Feet	PSI	SAX	Top of CMT
SURFACE	8 5/8	24	J-55	874		595	SURFACE
PRODUCTION	5 1/2	15.5	J-55	6274		170	3600

Liner								
Type	Size	Weight	Grade	Length	PSI	SAX	Top Depth	Bottom Depth
There are no Liner records to display.								

**Total Depth: 6300**

Packer		Plug	
Depth	Brand & Type	Depth	Plug Type
There are no Packer records to display.		5835	CIBP

Initial Test Data										
Test Date	Formation	Oil BBL/Day	Oil-Gravity (API)	Gas MCF/Day	Gas-Oil Ratio Cu FT/BBL	Water BBL/Day	Pumpin or Flowing	Initial Shut-In Pressure	Choke Size	Flow Tubing Pressure
Jan 24, 2022	MARMATON	3.34	48	48	14371	1	PUMPING	1020	WIDE	90

### Completion and Test Data by Producing Formation

Formation Name: KANSAS CITY

Code: 405KSSC

Class: DRY

#### Spacing Orders

Order No	Unit Size
358508	80

#### Perforated Intervals

From	To
5206	5216

#### Acid Volumes

500 GALLONS 7 1/2% MCA

#### Fracture Treatments

There are no Fracture Treatments records to display.

Formation Name: LANSING

Code: 405LNSG

Class: DRY

#### Spacing Orders

Order No	Unit Size
358508	80

#### Perforated Intervals

From	To
4592	4598
4615	4619

#### Acid Volumes

500 GALLONS 7 1/2% MCA

#### Fracture Treatments

There are no Fracture Treatments records to display.

Formation Name: MERAMEC

Code: 353MRMC

Class: DRY

#### Spacing Orders

Order No	Unit Size
160606	640

#### Perforated Intervals

From	To
5870	5880

#### Acid Volumes

1,000 GALLONS 7 1/2% MCA

#### Fracture Treatments

There are no Fracture Treatments records to display.

Formation Name: MARMATON

Code: 404MRMN

Class: OIL

#### Spacing Orders

Order No	Unit Size
351469	640

#### Perforated Intervals

From	To
5336	5340

#### Acid Volumes

400 GALLONS 7 1/2% MCA

#### Fracture Treatments

There are no Fracture Treatments records to display.

Formation	Top
HOOVER	3464
ELGIN	4244
LOVELL	4382
LANSING	4587
KANSAS CITY	5150

Were open hole logs run? Yes

Date last log run:

Were unusual drilling circumstances encountered? No

Explanation:

MARMATON	5283
CHESTER	5649
MERAMEC	5865
ST GENEVIEVE	5963
ST LOUIS	6058

Other Remarks
LANSING ZONES 4,592' - 4,598' AND 4,615' - 4,619' WERE CEMENT SQUEEZED. KANSAS CITY ZONE @ 5,206' - 5,216' WAS CEMENT SQUEEZED. OCC - OPERATOR SET A DV TOOL AT 4,636'.

FOR COMMISSION USE ONLY
<div>Status: Accepted</div> <div>1147893</div>

API NO. 35-059 22637  
OTC PROD. UNIT NO. 059 227522

Oil and Gas Conservation Division  
P.O. Box 52000  
Oklahoma City, OK 73152-2000  
405-521-2331  
OCCCentralProcessing@OCC.OK.GOV



OKLAHOMA  
Corporation  
Commission

Form 1002A  
Rev. 2021



ORIGINAL  
AMENDED (Reason)

Rule 165:10-3-25

COMPLETION REPORT

TYPE OF DRILLING OPERATION

☒ STRAIGHT HOLE ☐ DIRECTIONAL HOLE ☐ HORIZONTAL HOLE  
☐ SERVICE WELL

If directional or horizontal, see reverse for bottom hole location.

COUNTY	Harper	SEC	33	TWP	29N	RGE	22W	SPUD DATE	10/5/2021
LEASE NAME	Stu	WELL NO.	1	DRLG FINISHED DATE	10/17/2021	DATE OF WELL COMPLETION			12/14/2021
Elev $\frac{1}{2}$ $\frac{1}{2}$ SW $\frac{1}{4}$ SW $\frac{1}{4}$ FSL 660' FWL 560'				1st PROD DATE					1/19/2022
ELEVATION Derrick FL 1,868' Ground 1,856' Latitude 36° 56' 44.779 Longitude 99° 35' 24.506				RECOMP DATE					
OPERATOR NAME Tex-Ok Energy Limited Partnership				OTC/OCC OPERATOR NO.					18105
ADDRESS P.O. Box 3010									
CITY Cody				STATE Wy		ZIP 82414			

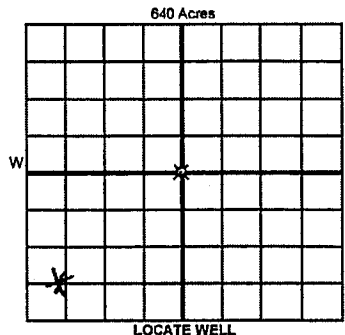

COMPLETION TYPE

<input checked="" type="radio"/> SINGLE ZONE	
<input type="radio"/> MULTIPLE ZONE	
<input type="radio"/> COMMINGLED	
LOCATION EXCEPTION ORDER NO.	720628
MULTIUNIT ORDER NO.	
INCREASED DENSITY ORDER NO.	

CASING & CEMENT (Attach Form 1002C)

TYPE	SIZE	WEIGHT	GRADE	FEET	PSI	SAX	TOP OF CMT
CONDUCTOR							
SURFACE	8 5/8"	24	J-55	874'		595	Surface
INTERMEDIATE							
PRODUCTION	5 1/2"	15.5	J-55	6,274', DVC @ 4,636'		170:95	4,752:3,600
LINER							

PACKER @ BRAND & TYPE PLUG @ 5,835' TYPE CIBP PLUG @ TYPE TOTAL DEPTH 6,300'

FORMATION	Kansas City	Lansing	Meramec	Marmaton	No Frac
SPACING & SPACING ORDER NUMBER	80, 358508	80, 358508	640/160606	640/351469	
CLASS: Oil, Gas, Dry, Inj, Disp, Comm Disp, Svc	Dry	Dry	Dry	Oil	Per GDR
PERFORATED INTERVALS	5,206' - 5,216'	4,592' - 4,598'	5,870' - 5,880'	5,336' - 5,340'	
ACID/VOLUME	7 1/2% MCA/500 gal	7 1/2% MCA/500 gal	7 1/2% MCA/1000 gal	7 1/2% MCA/400 gal	
FRACTURE TREATMENT (Fluids/Prop Amounts)					

Min Gas Allowable (165:10-17-7) OR Oil Allowable (165:10-13-3) Purchaser/Measurer First Sales Date

INITIAL TEST DATA

INITIAL TEST DATE	1/24/2022
OIL-BBL/DAY	3.34
OIL-GRAVITY (API)	48
GAS-MCF/DAY	48
GAS-OIL RATIO CU FT/BBL	14371
WATER-BBL/DAY	1.67
PUMPING OR FLOWING	pumping
INITIAL SHUT-IN PRESSURE	1020
CHOKE SIZE	Wide Open
FLOW TUBING PRESSURE	90

A record of the formations drilled through, and pertinent remarks are presented on the reverse. I declare that I have knowledge of the contents of this report and am authorized by my organization to make this report, which was prepared by me or under my supervision and direction, with the data and facts stated herein to be true, correct, and complete to the best of my knowledge and belief.

SIGNATURE P.O. Box 3010 ADDRESS	Jon Carlisle NAME (PRINT OR TYPE) Cody Wy 82414 CITY STATE ZIP	3/18/2022 DATE jsc00@lctwest.net EMAIL ADDRESS	307-587-4291 PHONE NUMBER
---------------------------------------	---	---	------------------------------

PLEASE TYPE OR USE BLACK INK ONLY  
FORMATION RECORD

Give formation names and tops, if available, or descriptions and thickness of formations drilled through. Show intervals cored or drillstem tested.

NAMES OF FORMATIONS	TOP
Hoover	3,464'
Elgin	4,244'
Lovell	4,382'
Lansing	4,587'
Kansas City	5,150'
Marmaton	5,283'
Chester	5,649'
Meramec	5,865'
St Gen	5,963'
St Louis	6,058'

LEASE NAME Stu WELL NO. 1

FOR COMMISSION USE ONLY	
ITD on file <input type="checkbox"/> YES <input type="checkbox"/> NO	
APPROVED <input type="checkbox"/> DISAPPROVED <input type="checkbox"/>	2) Reject Codes

Were open hole logs run?	<input checked="" type="radio"/> yes <input type="radio"/> no
Date Last log was run	
Was CO <sub>2</sub> encountered?	<input type="radio"/> yes <input checked="" type="radio"/> no at what depths? _____
Was H <sub>2</sub> S encountered?	<input type="radio"/> yes <input checked="" type="radio"/> no at what depths? _____
Were unusual drilling circumstances encountered?	<input type="radio"/> yes <input checked="" type="radio"/> no
If yes, briefly explain below	

Other remarks: Lansing zones 4,592' - 4,598' and 4,615' - 4,619' were cement squeezed. Kansas City zone @ 5,206' - 5,216' was cement squeezed.

OCC - Operator set a DV tool at 4636

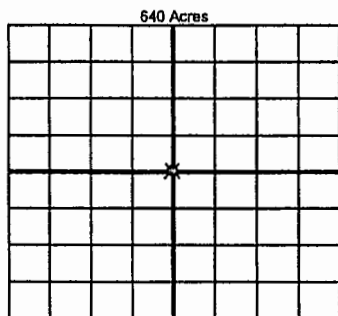

If more than three drainholes are proposed, attach a separate sheet indicating the necessary information.

Direction must be stated in degrees azimuth. Please note, the horizontal drainhole and its end point must be located within the boundaries of the lease or spacing unit.

Directional surveys are required for all drainholes and directional wells

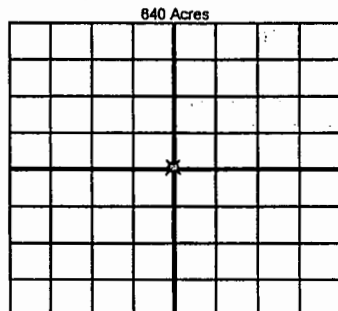

BOTTOM HOLE LOCATION FOR DIRECTIONAL HOLE

SEC	TWP	RGE	COUNTY
1/4	1/4	1/4	1/4
Measured Total Depth		True Vertical Depth	
		BHL From Lease, Unit, or Property Line:	

BOTTOM HOLE LOCATION FOR HORIZONTAL HOLE: (LATERALS)

LATERAL #1			
SEC	TWP	RGE	COUNTY
1/4	1/4	1/4	1/4
Depth of Deviation		Radius of Turn	Direction
Measured Total Depth		True Vertical Depth	Total Length
		BHL From Lease, Unit, or Property Line:	

LATERAL #2			
SEC	TWP	RGE	COUNTY
1/4	1/4	1/4	1/4
Depth of Deviation		Radius of Turn	Direction
Measured Total Depth		True Vertical Depth	Total Length
		BHL From Lease, Unit, or Property Line:	

LATERAL #3			
SEC	TWP	RGE	COUNTY
1/4	1/4	1/4	1/4
Depth of Deviation		Radius of Turn	Direction
Measured Total Depth		True Vertical Depth	Total Length
		BHL From Lease, Unit, or Property Line:	