

Oklahoma Corporation Commission  
Oil & Gas Conservation Division  
Post Office Box 52000  
Oklahoma City, Oklahoma 73152-2000  
Rule 165: 10-3-25

Form 1002A

API No.: 35137238520001

**Completion Report**

Spud Date: June 02, 1984

OTC Prod. Unit No.:

Drilling Finished Date: June 05, 1984

**Amended**

1st Prod Date:

Amend Reason: REPAIR WELL AND RETURN TO INJECTION

Completion Date: June 13, 1984

Recomplete Date: June 26, 2020

**Drill Type: STRAIGHT HOLE**

**SERVICE WELL**

Well Name: EAST VELMA M-1

Purchaser/Measurer:

Location: STEPHENS 35 1S 5W  
S2 S2 N2 NE  
1370 FSL 1320 FWL of 1/4 SEC  
Latitude: 34.43097 Longitude: -97.68907  
Derrick Elevation: 0 Ground Elevation: 1210

First Sales Date:

Operator: CITATION OIL & GAS CORPORATION 14156

14077 CUTTEN RD  
HOUSTON, TX 77069-2212

Completion Type	
X	Single Zone
	Multiple Zone
	Commingled

Location Exception
Order No
There are no Location Exception records to display.

Increased Density
Order No
There are no Increased Density records to display.

Casing and Cement							
Type	Size	Weight	Grade	Feet	PSI	SAX	Top of CMT
PRODUCTION	7	23	K-55	1099		400	SURFACE

Liner								
Type	Size	Weight	Grade	Length	PSI	SAX	Top Depth	Bottom Depth
There are no Liner records to display.								

**Total Depth: 1100**

Packer	
Depth	Brand & Type
381	TENSION

Plug	
Depth	Plug Type
There are no Plug records to display.	

Initial Test Data
-------------------

Test Date	Formation	Oil BBL/Day	Oil-Gravity (API)	Gas MCF/Day	Gas-Oil Ratio Cu FT/BBL	Water BBL/Day	Pumpin or Flowing	Initial Shut- In Pressure	Choke Size	Flow Tubing Pressure
-----------	-----------	----------------	----------------------	----------------	----------------------------	------------------	----------------------	---------------------------------	---------------	-------------------------

There are no Initial Data records to display.

Completion and Test Data by Producing Formation

Formation Name: PERMIAN                      Code: 459PRMN                      Class: INJ

Spacing Orders		Perforated Intervals	
Order No	Unit Size	From	To
246691		415	1007
Acid Volumes		Fracture Treatments	
N/A		N/A	

Formation	Top
PERMIAN	415

Were open hole logs run? No  
Date last log run:  
  
Were unusual drilling circumstances encountered? No  
Explanation:

Other Remarks
UIC - ORDER 246691. ACQUIRED HOT WELL PERMIT. CUT OFF 7" CASING 2' BELOW GROUND LEVEL. WELDED ON NEW BN, 7" COLLAR AND 1 X 7 CASING. SCREWED ON TUBING HEAD. SET SLIPS IN WELL HEAD WITH 18K# TENSION ON PACKER SET AT 381'. TESTED TO 200# FOR 30 MINUTES. HELD. MIKE WILLARD FROM OCC APPROVED TEST. PLACED BACK ON INJECTION.

FOR COMMISSION USE ONLY

1145391

Status: Accepted

API  
NO. 35-137-23852OTC PROD.  
UNIT NO.

(PLEASE TYPE OR USE BLACK INK ONLY)

## OKLAHOMA CORPORATION COMMISSION

Oil &amp; Gas Conservation Division

Post Office Box 52000

Oklahoma City, Oklahoma 73152-2000

Rule 165:10-3-25

Form 1002A

Rev. 2009

☐ ORIGINAL  
☒ AMENDED (Reason)

Repair well return to injection

## COMPLETION REPORT

## TYPE OF DRILLING OPERATION

☒ STRAIGHT HOLE ☐ DIRECTIONAL HOLE ☐ HORIZONTAL HOLE  
☒ SERVICE WELL

If directional or horizontal, see reverse for bottom hole location.

COUNTY Stephens

SEC 35

TWP 1S

RGE 5W

SPUD DATE 6/2/84

DRLG FINISHED  
DATE 6/5/84DATE OF WELL  
COMPLETION 6/13/84LEASE  
NAME East Velma MWELL  
NO. 1

1st PROD DATE NA

S2 1/4 N2 1/4 NE 1/4

FSL OF  
1/4 SEC 1370FWL OF  
1/4 SEC 1320

RECOMP DATE 6/26/20

ELEVATION  
Derrick FL Ground 1210

Latitude (if known) 34.43097

Longitude  
(if known) -97.68907OPERATOR  
NAME Citation Oil & Gas Corp.OTC / OCC  
OPERATOR NO. 14156

ADDRESS 14077 Cutten Rd

CITY Houston

STATE Texas

ZIP 77069-2212

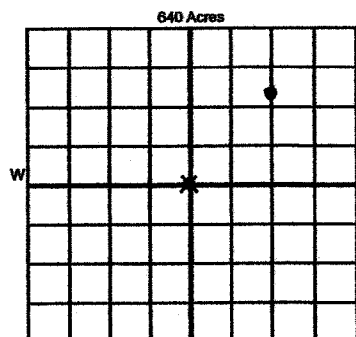

## COMPLETION TYPE

☒ SINGLE ZONE  
☐ MULTIPLE ZONE  
Application Date  
☐ COMINGLED  
Application Date  
LOCATION EXCEPTION  
ORDER NO.  
INCREASED DENSITY  
ORDER NO.

## CASING &amp; CEMENT (Attach Form 1002C)

TYPE	SIZE	WEIGHT	GRADE	FEET	PSI	SAX	TOP OF CMT
CONDUCTOR							
SURFACE							
INTERMEDIATE							
PRODUCTION	7	23	K-55	1099		400	Surface
LINER							
TOTAL DEPTH						1100	

PACKER @ 381 BRAND &amp; TYPE Tension

PLUG @ TYPE PLUG @ TYPE

PACKER @ BRAND &amp; TYPE

PLUG @ TYPE PLUG @ TYPE

## COMPLETION &amp; TEST DATA BY PRODUCING FORMATION

459 PRMN

FORMATION	Permian						
SPACING & SPACING ORDER NUMBER	246691 -> see remarks						
CLASS: Oil, Gas, Dry, Inj, Disp, Comm Disp, Svc	Inj						
PERFORATED INTERVALS	415-1007						
ACID/VOLUME	NA						
FRACTURE TREATMENT (Fluids/Prop Amounts)	NA						

RECEIVED

JUL 06 2020

Oklahoma Corporation  
Commission

Min Gas Allowable

(165:10-17-7)

Gas Purchaser/Measurer

NA



OR

First Sales Date

NA

Oil Allowable

(165:10-13-3)

## INITIAL TEST DATA

INITIAL TEST DATE	NA						
OIL-BBL/DAY							
OIL-GRAVITY (API)							
GAS-MCF/DAY							
GAS-OIL RATIO CU FT/BBL							
WATER-BBL/DAY							
PUMPING OR FLOWING							
INITIAL SHUT-IN PRESSURE							
CHOKE SIZE							
FLOW TUBING PRESSURE							

A record of the formations drilled through, and pertinent remarks are presented on the reverse. I declare that I have knowledge of the contents of this report and am authorized by my organization to make this report, which was prepared by me or under my supervision and direction, with the data and facts stated herein to be true, correct, and complete to the best of my knowledge and belief.

Sharon Ward

Sharon Ward

281-891-1556 6/30/20

SIGNATURE

NAME (PRINT OR TYPE)

DATE

PHONE NUMBER

14077 Cutten Rd

Houston

Texas 77069

sward@cogc.com

ADDRESS

CITY

STATE

ZIP

EMAIL ADDRESS

PLEASE TYPE OR USE BLACK INK ONLY

FORMATION RECORD

Give formation names and tops, if available, or descriptions and thickness of formations drilled through. Show intervals cored or drilistom tested.

NAMES OF FORMATIONS	TOP
Permian	415

LEASE NAME EAST VELMA M

WELL NO. 1

FOR COMMISSION USE ONLY	
ITD on file	<input type="checkbox"/> YES <input type="checkbox"/> NO
APPROVED	DISAPPROVED
2) Reject Codes	

Were open hole logs run?	<input type="checkbox"/> yes <input type="checkbox"/> no
Date Last log was run	NA
Was CO <sub>2</sub> encountered?	<input type="checkbox"/> yes <input type="checkbox"/> no at what depths?
Was H <sub>2</sub> S encountered?	<input type="checkbox"/> yes <input type="checkbox"/> no at what depths?
Were unusual drilling circumstances encountered?	<input type="checkbox"/> yes <input type="checkbox"/> no
If yes, briefly explain below	

Other remarks: Acquired hot well permit. Cut off 7" csg 2' below ground level. Welded on new BN, 7" collar and 1X7 csg. Screwed on tbq head. Set slips in well head w/18K# tension on pkr set at 381'. Tested to 200# for 30 min. Held. Mike Willard approved test from OCC. Placed back on injection.  
OCC-UIC order 246691

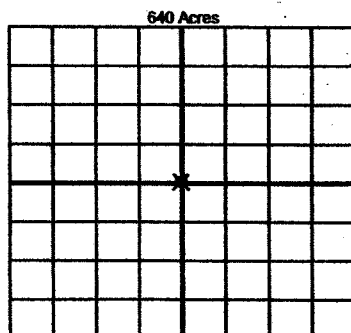

If more than three drainholes are proposed, attach a separate sheet indicating the necessary information.

Direction must be stated in degrees azimuth. Please note, the horizontal drainhole and its end point must be located within the boundaries of the lease or spacing unit.

Directional surveys are required for all drainholes and directional wells.

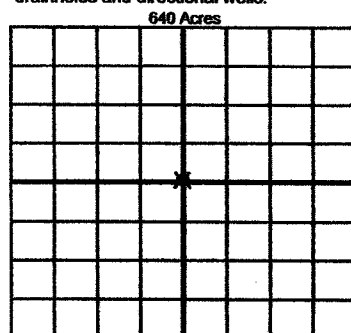

BOTTOM HOLE LOCATION FOR DIRECTIONAL HOLE

SEC	TWP	RGE	COUNTY
Spot Location			
1/4	1/4	1/4	1/4
Measured Total Depth		True Vertical Depth	BHL From Lease, Unit, or Property Line:

BOTTOM HOLE LOCATION FOR HORIZONTAL HOLE: (LATERALS)

LATERAL #1			
SEC	TWP	RGE	COUNTY
Spot Location			
1/4	1/4	1/4	1/4
Depth of Deviation		Radius of Turn	Direction
Measured Total Depth		True Vertical Depth	Total Length
			BHL From Lease, Unit, or Property Line:

LATERAL #2			
SEC	TWP	RGE	COUNTY
Spot Location			
1/4	1/4	1/4	1/4
Depth of Deviation		Radius of Turn	Direction
Measured Total Depth		True Vertical Depth	Total Length
			BHL From Lease, Unit, or Property Line:

LATERAL #3			
SEC	TWP	RGE	COUNTY
Spot Location			
1/4	1/4	1/4	1/4
Depth of Deviation		Radius of Turn	Direction
Measured Total Depth		True Vertical Depth	Total Length
			BHL From Lease, Unit, or Property Line: