

Oklahoma Corporation Commission
Oil & Gas Conservation Division
Post Office Box 52000
Oklahoma City, Oklahoma 73152-2000
Rule 165: 10-3-25

Form 1002A

API No.: 35137274540001

Completion Report

Spud Date: November 22, 2015

OTC Prod. Unit No.: 137-217066-0-0000

Drilling Finished Date: December 12, 2015

Amended

1st Prod Date: January 11, 2016

Amend Reason: CONVERT TO INJECTION

Completion Date: January 06, 2016

Recomplete Date: June 23, 2020

Drill Type: STRAIGHT HOLE

SERVICE WELL

Well Name: GREEN RANCH 3-19

Purchaser/Measurer:

Location: STEPHENS 19 2S 4W
C NW SW NE
990 FSL 330 FWL of 1/4 SEC
Latitude: 34.37173 Longitude: -97.6578
Derrick Elevation: 0 Ground Elevation: 980

First Sales Date:

Operator: HOGBACK EXPLORATION INC 21161
PO BOX 180368
10101 HIGHWAY 253
FORT SMITH, AR 72918-0368

Completion Type	
X	Single Zone
	Multiple Zone
	Commingled

Location Exception
Order No
There are no Location Exception records to display.

Increased Density
Order No
There are no Increased Density records to display.

Casing and Cement							
Type	Size	Weight	Grade	Feet	PSI	SAX	Top of CMT
SURFACE	8 5/8	24	J-55	178		140	SURFACE
PRODUCTION	5 1/2	15.5	J-55	2855		495	SURFACE

Liner								
Type	Size	Weight	Grade	Length	PSI	SAX	Top Depth	Bottom Depth
There are no Liner records to display.								

Total Depth: 2902

Packer	
Depth	Brand & Type
2536	ARROW SET IX

Plug	
Depth	Plug Type
There are no Plug records to display.	

Initial Test Data

Test Date	Formation	Oil BBL/Day	Oil-Gravity (API)	Gas MCF/Day	Gas-Oil Ratio Cu FT/BBL	Water BBL/Day	Pumpin or Flowing	Initial Shut- In Pressure	Choke Size	Flow Tubing Pressure
There are no Initial Data records to display.										

Completion and Test Data by Producing Formation									
Formation Name: DEESE				Code: 404DEESS			Class: INJ		
Spacing Orders				Perforated Intervals					
Order No		Unit Size		From			To		
There are no Spacing Order records to display.				2546			2576		
Acid Volumes				Fracture Treatments					
NONE				2,078 BARRELS SLICK WATER, 102,000 POUNDS SAND					

Formation	Top
HOXBAR	1220
DEESE	1600

Were open hole logs run? Yes

Date last log run: December 17, 2015

Were unusual drilling circumstances encountered? No

Explanation:

Other Remarks
OCC - UIC PERMIT NUMBER 2008100159

FOR COMMISSION USE ONLY
<div>Status: Accepted</div> <div>1145400</div>

API NO. 137-27454
OTC PROD. UNIT NO. 137217066

PLEASE TYPE OR USE BLACK INK ONLY

NOTE:

Attach copy of original 1002A
if recompletion or reentry.

Convert to Injection

UIC2008400150

Convert to Injection

OKLAHOMA CORPORATION COMMISSION
Oil & Gas Conservation Division
Post Office Box 52000
Oklahoma City, Oklahoma 73152-2000
Rule 165:10-3-25

Form 1002A
Rev. 2009

☐ ORIGINAL
☒ AMENDED (Reason)

COMPLETION REPORT

TYPE OF DRILLING OPERATION

☒ STRAIGHT HOLE ☐ DIRECTIONAL HOLE ☐ HORIZONTAL HOLE
☒ SERVICE WELL

If directional or horizontal, see reverse for bottom hole location.

SPUD DATE 11/22/2015

DRLG FINISHED DATE 12/12/2015

DATE OF WELL COMPLETION 01/06/2016

1st PROD DATE 01/11/2016

RECOMP DATE 6/23/2020

Longitude (if known) -97.65780

OTC/OCC OPERATOR NO. 21161-0

ADDRESS PO Box 180368

CITY Fort Smith STATE AR ZIP 72918

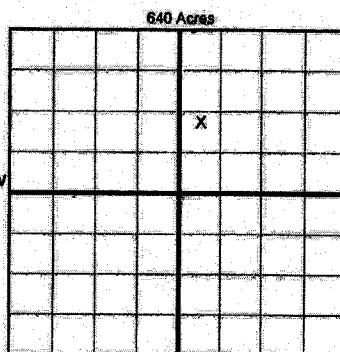

COMPLETION TYPE

☒ SINGLE ZONE
☐ MULTIPLE ZONE
Application Date
COMINGLED
Application Date
LOCATION
EXCEPTION ORDER
INCREASED DENSITY
ORDER NO.

CASING & CEMENT (Form 1002C must be attached)

TYPE	SIZE	WEIGHT	GRADE	FEET	PSI	SAX	TOP OF CMT
CONDUCTOR							
SURFACE	8 5/8"	24	J-55	178'		140	Surf
INTERMEDIATE							
PRODUCTION	5 1/2"	15.5	J-55	2855'		495	Surf
LINER							

PACKER @ 2,536 BRAND & TYPE Arrow Set IX PLUG @

PACKER @ BRAND & TYPE PLUG @

COMPLETION & TEST DATA BY PRODUCING FORMATION

FORMATION	Deese								
SPACING & SPACING ORDER NUMBER	-636725								
CLASS: Oil, Gas, Dry, Inj, Disp, Comm Disp, Svc	on Injection								
PERFORATED INTERVALS	2546'-2576'								
ACID/VOLUME	No								
FRACTURE TREATMENT (Fluids/Prop Amounts)	2,078 bbls slk wtr 102,000#sd								

Reported to
Frac Focus

RECEIVED

JUN 29 2020

Oklahoma Corporation
Commission

Min Gas Allowable (165:10-17-7)

OR

Oil Allowable (165:10-13-3)

Gas Purchaser/Measurer

First Sales Date

INITIAL TEST DATA

INITIAL TEST DATE	1/15/2016								
OIL-BBL/DAY	25								
OIL-GRAVITY (API)	25								
GAS-MCF/DAY									
GAS-OIL RATIO CU FT/BBL									
WATER-BBL/DAY									
PUMPING OR FLOWING	Pumping								
INITIAL SHUT-IN PRESSURE									
CHOKE SIZE									
FLOW TUBING PRESSURE									

A record of the formations drilled through, and pertinent remarks are presented on the reverse. I declare that I have knowledge of the contents of this report and am authorized by my organization to make this report, which was prepared by me or under my supervision and direction, with the data and facts stated herein to be true, correct, and complete to the best of my knowledge and belief.

Gerald W. Lundy
SIGNATURE
PO Box 180368
Fort Smith
ADDRESS
CITY
STATE
AR
ZIP
72918
DATE
6/23/2020
PHONE NUMBER
479-709-9014
EMAIL ADDRESS
g.lundy@hogbackexploration.com

PLEASE TYPE OR USE BLACK INK ONLY
FORMATION RECORD

Give formation names and tops, if available, or descriptions and thickness of formations drilled through. Show intervals cored or drillstem tested.

NAMES OF FORMATIONS	TOP
Hoxbar	1,220
Deese	1,600

LEASE NAME Green Ranch WELL NO. #3-19

FOR COMMISSION USE ONLY	
ITD on file <input type="checkbox"/> YES <input type="checkbox"/> NO	
APPROVED _____	DISAPPROVED _____
2) Reject Codes	

Were open hole logs run?	<input checked="" type="checkbox"/> yes <input type="checkbox"/> no
Date Last log was run	<u>12/17/2015</u>
Was CO ₂ encountered?	<input type="checkbox"/> yes <input checked="" type="checkbox"/> no at what depths? _____
Was H ₂ S encountered?	<input type="checkbox"/> yes <input checked="" type="checkbox"/> no at what depths? _____
Were unusual drilling circumstances encountered?	<input type="checkbox"/> yes <input checked="" type="checkbox"/> no
If yes, briefly explain below	

Other remarks:

OCC - UIC 2008100159

640 Acres

If more than three drainholes are proposed, attach a separate sheet indicating the necessary information.

Direction must be stated in degrees azimuth.
Please note, the horizontal drainhole and its end point must be located within the boundaries of the lease or spacing unit.

Directional surveys are required for all drainholes and directional wells.

640 Acres

BOTTOM HOLE LOCATION FOR DIRECTIONAL HOLE

SEC	TWP	RGE	COUNTY
Spot Location			
1/4	1/4	1/4	1/4
Measured Total Depth		True Vertical Depth	Feet From 1/4 Sec Lines FSL FWL
BHL From Lease, Unit, or Property Line:			

BOTTOM HOLE LOCATION FOR HORIZONTAL HOLE: (LATERALS)

LATERAL #1

SEC	TWP	RGE	COUNTY
Spot Location			
1/4	1/4	1/4	1/4
Depth of Deviation		Radius of Turn	Feet From 1/4 Sec Lines FSL FWL
Measured Total Depth		True Vertical Depth	Direction Total Length
BHL From Lease, Unit, or Property Line:			

LATERAL #2

SEC	TWP	RGE	COUNTY
Spot Location			
1/4	1/4	1/4	1/4
Depth of Deviation		Radius of Turn	Feet From 1/4 Sec Lines FSL FWL
Measured Total Depth		True Vertical Depth	Direction Total Length
BHL From Lease, Unit, or Property Line:			

LATERAL #3

SEC	TWP	RGE	COUNTY
Spot Location			
1/4	1/4	1/4	1/4
Depth of Deviation		Radius of Turn	Feet From 1/4 Sec Lines FSL FWL
Measured Total Depth		True Vertical Depth	Direction Total Length
BHL From Lease, Unit, or Property Line:			



Oklahoma Corporation Commission
Oil & Gas Conservation Division
P.O. Box 52000
Oklahoma City, OK 73152-2000

Dear Conservation Division:

Enclosed with this letter please find the following:

1002A for the DPWU Water Supply #1
Cerement Bond Log
Phased Induction Log
Compensated Neutron Micro Log

1002A- Original -Emmett Massey #104
1002A- Recompletion for Injection- Emmett Massey #104

1002A- Original -Green Ranch #3-19
1002A- Recompletion for Injection- Green Ranch #3-19

1002A- Original -Green Ranch #10-19
1002A- Recompletion for Injection- Green Ranch #10-19

Due to the Emmett Massey #104, Green Ranch #3-19, and Green Ranch #10-19 wells being converted from oil to injection, it was our understanding that these wells do not require that a 1029A be filed. Also, we believe the same to be true for the DPWU Water Supply #1. If this is incorrect you may contact Gerry at g.lundy@hogbackexploration.com or at 479-461-9069.

Sincerely,

Hogback Exploration, Inc.