

Oklahoma Corporation Commission
Oil & Gas Conservation Division
Post Office Box 52000
Oklahoma City, Oklahoma 73152-2000
Rule 165: 10-3-25

Form 1002A

API No.: 35019263440000

Completion Report

Spud Date: December 10, 2019

OTC Prod. Unit No.: N/A

Drilling Finished Date: December 20, 2019

1st Prod Date: February 22, 2020

Completion Date: February 19, 2020

Drill Type: STRAIGHT HOLE

Min Gas Allowable: Yes

Well Name: SW WILDCAT JIM DEESE UNIT 5-3

Purchaser/Measurer: TARGA RESOURCES PART.

Location: CARTER 6 2S 2W
SE SE SW SW
308 FSL 1080 FWL of 1/4 SEC
Derrick Elevation: 10 Ground Elevation: 1052

First Sales Date: 03/09/2020

Operator: MACK ENERGY CO 11739
PO BOX 400
1202 N 10TH ST
DUNCAN, OK 73534-0400

Completion Type		Location Exception		Increased Density	
X	Single Zone	Order No		Order No	
	Multiple Zone	There are no Location Exception records to display.		There are no Increased Density records to display.	
	Commingled				

Casing and Cement							
Type	Size	Weight	Grade	Feet	PSI	SAX	Top of CMT
SURFACE	9 5/8	40	J-55	1328		435	SURFACE
PRODUCTION	7	26	J-55	4410		540	SURFACE

Liner								
Type	Size	Weight	Grade	Length	PSI	SAX	Top Depth	Bottom Depth
There are no Liner records to display.								

Total Depth: 4448

Packer		Plug	
Depth	Brand & Type	Depth	Plug Type
There are no Packer records to display.		There are no Plug records to display.	

Initial Test Data										
Test Date	Formation	Oil BBL/Day	Oil-Gravity (API)	Gas MCF/Day	Gas-Oil Ratio Cu FT/BBL	Water BBL/Day	Pumpin or Flowing	Initial Shut-In Pressure	Choke Size	Flow Tubing Pressure
Mar 09, 2020	DEESE	2	23	15	7500	307	PUMPING			

Completion and Test Data by Producing Formation

Formation Name: DEESE

Code: 404DEESS

Class: OIL

Spacing Orders

Order No	Unit Size
701901	UNIT

Perforated Intervals

From	To
4078	4200

Acid Volumes

550 GALLONS 7.5% NEFE HCL

Fracture Treatments

1,539 BARRELS, 70,000 POUNDS 16/30 SAND, 14,000 POUNDS RESIN SAND

Formation Name: DEESE

Code: 404DEESS

Class: OIL

Spacing Orders

Order No	Unit Size
701901	UNIT

Perforated Intervals

From	To
3884	3958

Acid Volumes

200 GALLONS 7.5% NEFE HCL

Fracture Treatments

396 BARRELS, 20,000 POUNDS 16/30 SAND, 4,000 POUNDS RESIN SAND
--

Formation Name: DEESE

Code: 404DEESS

Class: OIL

Spacing Orders

Order No	Unit Size
701901	UNIT

Perforated Intervals

From	To
3666	3754

Acid Volumes

400 GALLONS 7.5% NEFE HCL

Fracture Treatments

1,280 BARRELS, 55,000 POUNDS 16/30, 10,000 POUNDS RESIN

Formation Name: DEESE

Code: 404DEESS

Class: OIL

Spacing Orders

Order No	Unit Size
701901	UNIT

Perforated Intervals

From	To
3506	3544

Acid Volumes

400 GALLONS 7.5% NEFE

Fracture Treatments

1,228 BARRELS, 53,500 POUNDS 16/30 SAND, 10,000 POUNDS RESIN
--

Formation	Top
DEESE	3140

Were open hole logs run? Yes

Date last log run: December 19, 2019

Were unusual drilling circumstances encountered? No

Explanation:

Other Remarks
There are no Other Remarks.

FOR COMMISSION USE ONLY	
Status: Accepted	1144895

API NO. 019-26344
OTC PROD. N/A
UNIT NO.

(PLEASE TYPE OR USE BLACK INK ONLY)

OKLAHOMA CORPORATION COMMISSION
Oil & Gas Conservation Division
Post Office Box 52000
Oklahoma City, Oklahoma 73152-2000
Rule 165:10-3-25

RECEIVED

Form 1002A
Rev. 2009

MAR 13 2020

☒ ORIGINAL
☐ AMENDED (Reason)

COMPLETION REPORT

OKLAHOMA CORPORATION
COMMISSION

640 Acres

TYPE OF DRILLING OPERATION
☒ STRAIGHT HOLE ☐ DIRECTIONAL HOLE ☐ HORIZONTAL HOLE
☐ SERVICE WELL

If directional or horizontal, see reverse for bottom hole location.

COUNTY Carter SEC 6 TWP 2S RGE 2W
LEASE NAME SW Wildcat SW WJDU
Jin Deesedant WELL NO. 5-3
SE 1/4 SE 1/4 SW 1/4 SW 1/4 FSL OF 1/4 SEC 308 FWL OF 1/4 SEC 1080
ELEVATION Derrick FL 10' Ground 1052' Latitude (if known) Longitude (if known)
OPERATOR NAME Mack Energy Co. OTC / OCC OPERATOR NO. 11739
ADDRESS P.O. Box 400
CITY Duncan STATE OK ZIP 73534

COMPLETION TYPE

☒ SINGLE ZONE
☐ MULTIPLE ZONE
Application Date
COMINGLED
Application Date
LOCATION EXCEPTION
ORDER NO.
INCREASED DENSITY
ORDER NO.

CASING & CEMENT (Attach Form 1002C)

TYPE	SIZE	WEIGHT	GRADE	FEET	PSI	SAX	TOP OF CMT
CONDUCTOR							
SURFACE	9 5/8"	40	J-55	1328		435	Surface
INTERMEDIATE							
PRODUCTION	7"	26	J-55	4410		540	Surface
LINER							
TOTAL DEPTH							4448'

PACKER @ _____ BRAND & TYPE _____ PLUG @ _____ TYPE _____ PLUG @ _____ TYPE _____
PACKER @ _____ BRAND & TYPE _____ PLUG @ _____ TYPE _____ PLUG @ _____ TYPE _____

COMPLETION & TEST DATA BY PRODUCING FORMATION

FORMATION	(Morris)	(U. Morris)	(Carpenter)	(Tussy)	404 DEESS
SPACING & SPACING ORDER NUMBER	10 acre/ 701901	10 acre/ 701901	10 acre/ 701901	10 acre/ 701901	unit
CLASS: Oil, Gas, Dry, Inj, Disp, Comm Disp, Svc	Oil	Oil	Oil	Oil	
PERFORATED INTERVALS	4078-4086'	3884-3896'	3666-3678'	3506-3544'	
	4156-4200'	3952-3958'	3720-3728'		
			3734-3754'		
ACID/VOLUME					
FRACTURE TREATMENT (Fluids/Prop Amounts)	550 gals 7.5% NeFe HCl	200 gals 7.5% NeFe HCl	400 gals 7.5% NeFe HCl	400 gals 7.5% NeFe	
	1539 bbls/70000# 16/30 sd	396 bbls/20000# 16/30 sd	1280 bbls 55000# 16/30	1228 bbls 53500# 16/30 sd	
	14000# resin sd	4000# resin sd	10000# resin	10000# resin	

☒ Min Gas Allowable (165:10-17-7)
OR
☐ Oil Allowable (165:10-13-3)

Gas Purchaser/Measurer
First Sales Date

Targa Resources Part.
3/9/2020

INITIAL TEST DATA

INITIAL TEST DATE	3/9/2020				
OIL-BBL/DAY	2				
OIL-GRAVITY (API)	23				
GAS-MCF/DAY	15				
GAS-OIL RATIO CU FT/BBL	7500				
WATER-BBL/DAY	307				
PUMPING OR FLOWING	Pumping				
INITIAL SHUT-IN PRESSURE	0				
CHOKE SIZE	N/A				
FLOW TUBING PRESSURE	N/A				

A record of the formations drilled through, and pertinent remarks are presented on the reverse. I declare that I have knowledge of the contents of this report and am authorized by my organization to make this report, which was prepared by me or under my supervision and direction, with the data and facts stated herein to be true, correct, and complete to the best of my knowledge and belief.

Dinah Mayes
SIGNATURE
3730 Samedan Road
ADDRESS
Ratliff City
CITY
OK
STATE
73481
ZIP
3/12/2020
DATE
580-856-3705
PHONE NUMBER
dmayes@mackenergy.com
EMAIL ADDRESS

X213

PLEASE TYPE OR USE BLACK INK ONLY
FORMATION RECORD

Give formation names and tops, if available, or descriptions and thickness of formations drilled through. Show intervals cored or drillstem tested.

NAMES OF FORMATIONS	TOP
Deese	3140'

LEASE NAME SW WJDU

WELL NO. 5-3

FOR COMMISSION USE ONLY	
ITD on file <input type="checkbox"/> YES <input type="checkbox"/> NO	
APPROVED _____	DISAPPROVED _____
2) Reject Codes	

Were open hole logs run?	<input checked="" type="checkbox"/> yes	<input type="checkbox"/> no
Date Last log was run	<u>12/19/2019</u>	
Was CO ₂ encountered?	<input type="checkbox"/> yes	<input checked="" type="checkbox"/> no at what depths? _____
Was H ₂ S encountered?	<input type="checkbox"/> yes	<input checked="" type="checkbox"/> no at what depths? _____
Were unusual drilling circumstances encountered?	<input type="checkbox"/> yes	<input checked="" type="checkbox"/> no
If yes, briefly explain below		

Other remarks:

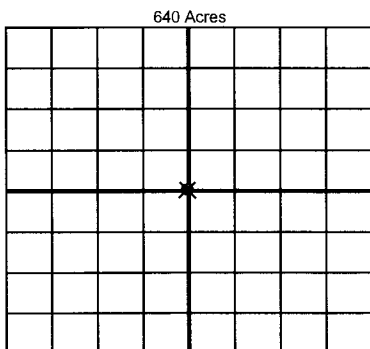

If more than three drainholes are proposed, attach a separate sheet indicating the necessary information.

Direction must be stated in degrees azimuth. Please note, the horizontal drainhole and its end point must be located within the boundaries of the lease or spacing unit.

Directional surveys are required for all drainholes and directional wells.

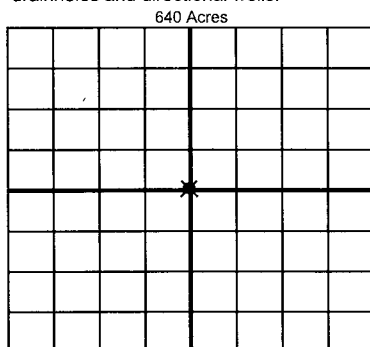

BOTTOM HOLE LOCATION FOR DIRECTIONAL HOLE

SEC	TWP	RGE	COUNTY
Spot Location			
1/4	1/4	1/4	1/4
Measured Total Depth		True Vertical Depth	BHL From Lease, Unit, or Property Line:

BOTTOM HOLE LOCATION FOR HORIZONTAL HOLE: (LATERALS)

LATERAL #1

SEC	TWP	RGE	COUNTY
Spot Location			
1/4	1/4	1/4	1/4
Depth of Deviation		Radius of Turn	Direction
Measured Total Depth		True Vertical Depth	BHL From Lease, Unit, or Property Line:

LATERAL #2

SEC	TWP	RGE	COUNTY
Spot Location			
1/4	1/4	1/4	1/4
Depth of Deviation		Radius of Turn	Direction
Measured Total Depth		True Vertical Depth	BHL From Lease, Unit, or Property Line:

LATERAL #3

SEC	TWP	RGE	COUNTY
Spot Location			
1/4	1/4	1/4	1/4
Depth of Deviation		Radius of Turn	Direction
Measured Total Depth		True Vertical Depth	BHL From Lease, Unit, or Property Line: