

Oklahoma Corporation Commission
Oil & Gas Conservation Division
Post Office Box 52000
Oklahoma City, Oklahoma 73152-2000
Rule 165: 10-3-25

Form 1002A

API No.: 35019264010000

Completion Report

Spud Date: October 19, 2020

OTC Prod. Unit No.: 019-028650-0-0000

Drilling Finished Date: October 20, 2020

1st Prod Date: February 04, 2021

Completion Date: February 03, 2021

Drill Type: STRAIGHT HOLE

Well Name: OIL CITY UNIT 78

Purchaser/Measurer:

Location: CARTER 28 3S 2W
NE SE NE NE
1815 FSL 2475 FWL of 1/4 SEC
Derrick Elevation: 1011 Ground Elevation: 1006

First Sales Date:

Operator: KODIAK OIL & GAS INC 23226

204 N WALNUT ST
MUENSTER, TX 76252-2766

Completion Type		Location Exception		Increased Density	
X	Single Zone	Order No		Order No	
	Multiple Zone	There are no Location Exception records to display.		There are no Increased Density records to display.	
	Commingled				

Casing and Cement							
Type	Size	Weight	Grade	Feet	PSI	SAX	Top of CMT
PRODUCTION	5 1/2	17	J	1182		180	SURFACE

Liner								
Type	Size	Weight	Grade	Length	PSI	SAX	Top Depth	Bottom Depth
There are no Liner records to display.								

Total Depth: 1211

Packer		Plug	
Depth	Brand & Type	Depth	Plug Type
There are no Packer records to display.		There are no Plug records to display.	

Initial Test Data										
Test Date	Formation	Oil BBL/Day	Oil-Gravity (API)	Gas MCF/Day	Gas-Oil Ratio Cu FT/BBL	Water BBL/Day	Pumpin or Flowing	Initial Shut-In Pressure	Choke Size	Flow Tubing Pressure
Feb 05, 2021	PONTOTOC	4	21			35	PUMPING	40	0	

Completion and Test Data by Producing Formation										
---	--	--	--	--	--	--	--	--	--	--

Formation Name: PONTOTOC		Code: 419PNTC	Class: OIL
Spacing Orders		Perforated Intervals	
Order No	Unit Size	From	To
47075	UNIT	820	840
67235	UNIT	904	914
		948	980
Acid Volumes		Fracture Treatments	
NONE		NONE	

Formation	Top
PONTOTOC	820

Were open hole logs run? Yes
Date last log run: October 19, 2020

Were unusual drilling circumstances encountered? No
Explanation:

Other Remarks
There are no Other Remarks.

FOR COMMISSION USE ONLY	
Status: Accepted	1146135

API NO. 35-019-26401
OTC PROD. UNIT NO. 019-028650

Oil and Gas Conservation Division
P.O. Box 52000
Oklahoma City, OK 73152-2000
405-522-0577
OCCCentralProcessing@OCC.OK.GOV



OKLAHOMA
Corporation
Commission

Form 1002A
Rev. 2020

Received
2-10-21
PBN

ORIGINAL
AMENDED (Reason)

Rule 165:10-3-25

COMPLETION REPORT

TYPE OF DRILLING OPERATION

☒ STRAIGHT HOLE ☐ DIRECTIONAL HOLE ☐ HORIZONTAL HOLE
☐ SERVICE WELL

If directional or horizontal, see reverse for bottom hole location.

COUNTY	CARTER	SEC	28	TWP	3S	RGE	2W	SPUD DATE	10-19-2020		
LEASE NAME	OIL CITY UNIT				WELL NO.	78	DATE OF WELL COMPLETION	02/03/2021	DRLG FINISHED DATE	10-20-2020	
NE 1/4 SE 1/4 NE 1/4 NE 1/4	FSL	1815	FWL	2475	RECOMP DATE						
ELEVATION Derrick FL	1011	Ground	1006	Latitude						Longitude	
OPERATOR NAME	KODIAK OIL & GAS, INC				OTC / OCC OPERATOR NO.	23226					
ADDRESS	204 N WALNUT ST										
CITY	MUENSTER			STATE	TX	ZIP	76252				

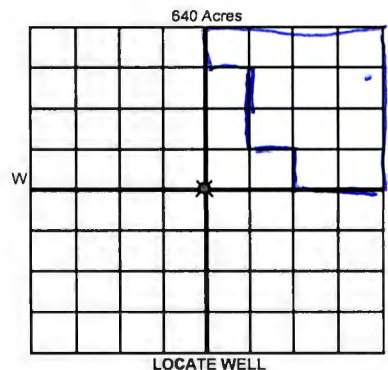

COMPLETION TYPE

<input checked="" type="radio"/> SINGLE ZONE	
<input type="radio"/> MULTIPLE ZONE	
<input type="radio"/> COMMINGLED	
LOCATION EXCEPTION ORDER NO.	
MULTIUNIT ORDER NO.	
INCREASED DENSITY ORDER NO.	

CASING & CEMENT (Attach Form 1002C)

TYPE	SIZE	WEIGHT	GRADE	FEET	PSI	SAX	TOP OF CMT
CONDUCTOR							
SURFACE							
INTERMEDIATE							
PRODUCTION	5 1/2	17#	J	1182		180	SURFACE
LINER							

PACKER @ _____ BRAND & TYPE _____ PLUG @ _____ TYPE _____ PLUG @ _____ TYPE _____ TOTAL DEPTH 1211

COMPLETION & TEST DATA BY PRODUCING FORMATION

FORMATION	PONTOTOC						No Frac
SPACING & SPACING ORDER NUMBER (unit)	47075 & 67235 (unit)						
CLASS: Oil, Gas, Dry, Inj, Disp, Comm Disp, Svc	Oil						
PERFORATED INTERVALS	820-840						
	904-914						
	948-980						
ACID/VOLUME	none						
FRACTURE TREATMENT (Fluids/Prop Amounts)	none						

☒ Min Gas Allowable (165:10-17-7)
OR
☐ Oil Allowable (165:10-13-3)

Purchaser/Measurer
First Sales Date

INITIAL TEST DATA

INITIAL TEST DATE	2/5/2021					
OIL-BBL/DAY	4					
OIL-GRAVITY (API)	21					
GAS-MCF/DAY	0					
GAS-OIL RATIO CU FT/BBL	0					
WATER-BBL/DAY	35					
PUMPING OR FLOWING	PUMPING					
INITIAL SHUT-IN PRESSURE	40					
CHOKE SIZE	0					
FLOW TUBING PRESSURE	0					

A record of the formations drilled through, and pertinent remarks are presented on the reverse. I declare that I have knowledge of the contents of this report and am authorized by my organization to make this report, which was prepared by me or under my supervision and direction, with the data and facts stated herein to be true, correct, and complete to the best of my knowledge and belief.

SIGNATURE: 204 N WALNUT ST
NAME (PRINT OR TYPE): MUENSTER TX 76252
DATE: 2/8/2021 PHONE NUMBER: 940-759-4001
EMAIL ADDRESS: WFW@NTIN.NET

PLEASE TYPE OR USE BLACK INK ONLY
FORMATION RECORD

Give formation names and tops, if available, or descriptions and thickness of formations drilled through. Show intervals cored or drillstem tested.

NAMES OF FORMATIONS	TOP
PONTOTOC	820

LEASE NAME _____ OIL CITY UNIT _____ WELL NO. 78

FOR COMMISSION USE ONLY	
ITD on file	<input type="checkbox"/> YES <input type="checkbox"/> NO
APPROVED	DISAPPROVED
2) Reject Codes	

Were open hole logs run?	<input checked="" type="radio"/> yes <input type="radio"/> no
Date Last log was run	10/19/2020
Was CO ₂ encountered?	<input type="radio"/> yes <input checked="" type="radio"/> no at what depths? _____
Was H ₂ S encountered?	<input type="radio"/> yes <input checked="" type="radio"/> no at what depths? _____
Were unusual drilling circumstances encountered?	<input type="radio"/> yes <input checked="" type="radio"/> no
If yes, briefly explain below	

Other remarks: _____

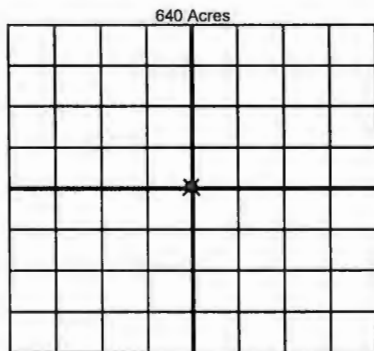

BOTTOM HOLE LOCATION FOR DIRECTIONAL HOLE

SEC	TWP	RGE	COUNTY
1/4	1/4	1/4	1/4
Measured Total Depth		True Vertical Depth	Feet From 1/4 Sec Lines
BHL From Lease, Unit, or Property Line:			

BOTTOM HOLE LOCATION FOR HORIZONTAL HOLE: (LATERALS)

LATERAL #1

SEC	TWP	RGE	COUNTY
1/4	1/4	1/4	1/4
Depth of Deviation		Radius of Turn	Direction
Measured Total Depth		True Vertical Depth	Total Length
BHL From Lease, Unit, or Property Line:			

LATERAL #2

SEC	TWP	RGE	COUNTY
1/4	1/4	1/4	1/4
Depth of Deviation		Radius of Turn	Direction
Measured Total Depth		True Vertical Depth	Total Length
BHL From Lease, Unit, or Property Line:			

LATERAL #3

SEC	TWP	RGE	COUNTY
1/4	1/4	1/4	1/4
Depth of Deviation		Radius of Turn	Direction
Measured Total Depth		True Vertical Depth	Total Length
BHL From Lease, Unit, or Property Line:			

If more than three drainholes are proposed, attach a separate sheet indicating the necessary information.

Direction must be stated in degrees azimuth. Please note, the horizontal drainhole and its end point must be located within the boundaries of the lease or spacing unit.

Directional surveys are required for all drainholes and directional wells

