

Oklahoma Corporation Commission  
Oil & Gas Conservation Division  
Post Office Box 52000  
Oklahoma City, Oklahoma 73152-2000  
Rule 165: 10-3-25

Form 1002A

API No.: 35139011270001

**Completion Report**

Spud Date: August 01, 1945

OTC Prod. Unit No.:

Drilling Finished Date: September 08, 1945

**Amended**

1st Prod Date: September 18, 1945

Amend Reason: NEW FRACTURE STIMULATION

Completion Date: September 18, 1945

Recomplete Date: November 12, 2018

**Drill Type: STRAIGHT HOLE**

Well Name: A HELLBUSCH 1

Purchaser/Measurer:

Location: TEXAS 10 4N 14E CM  
SW SW SW NE  
2500 FNL 2530 FEL of 1/4 SEC  
Latitude: 36.82825 Longitude: -101.536944  
Derrick Elevation: 3226 Ground Elevation: 0

First Sales Date:

Operator: SCOUT ENERGY MANAGEMENT LLC 23138

4901 LBJ FWY STE 300  
DALLAS, TX 75244-6107

Completion Type	
X	Single Zone
	Multiple Zone
	Commingled

Location Exception
Order No
There are no Location Exception records to display.

Increased Density
Order No
There are no Increased Density records to display.

Casing and Cement							
Type	Size	Weight	Grade	Feet	PSI	SAX	Top of CMT
SURFACE	10.75	32.75	LW	335		300	SURFACE
PRODUCTION	7	20	SS	2680		1000	600

Liner								
Type	Size	Weight	Grade	Length	PSI	SAX	Top Depth	Bottom Depth
LINER	5.5	14		129	0	0	2651	2780

**Total Depth: 2780**

Packer	
Depth	Brand & Type
2640	PACKER

Plug	
Depth	Plug Type
There are no Plug records to display.	

Initial Test Data
-------------------

Test Date	Formation	Oil BBL/Day	Oil-Gravity (API)	Gas MCF/Day	Gas-Oil Ratio Cu FT/BBL	Water BBL/Day	Pumpin or Flowing	Initial Shut-In Pressure	Choke Size	Flow Tubing Pressure
Nov 12, 2018	GUYMON-HUGOTON			319			FLOWING	1071		

#### Completion and Test Data by Producing Formation

Formation Name: GUYMON-HUGOTON

Code: 451GYHG

Class: GAS

#### Spacing Orders

Order No	Unit Size
There are no Spacing Order records to display.	

#### Perforated Intervals

From	To
2680	2780

#### Acid Volumes

1,000 GALLONS 15% HCL
-----------------------

#### Fracture Treatments

50,000 POUNDS 16/30 SAND WITH 444 POUNDS WATER, SPEC. GRAVITY 2.65 - 75 QUALITY FOAM
--

Formation	Top
KRIDER	2700
WLD	2745
HERINGTON	2662
TOWANDA	2809

Were open hole logs run? No

Date last log run:

Were unusual drilling circumstances encountered? No

Explanation:

#### Other Remarks

There are no Other Remarks.
-----------------------------

#### FOR COMMISSION USE ONLY

1141463

Status: Accepted

Footage Calculated 6PS

SW

API NO. 35-139-01127  
OTC PROD.  
UNIT NO.

(PLEASE TYPE OR USE BLACK INK ONLY)

OKLAHOMA CORPORATION COMMISSION

Oil & Gas Conservation Division

Post Office Box 52000

Oklahoma City, Oklahoma 73152-2000

Rule 165:10-3-25

RECEIVED

DEC 11 2018

OKLAHOMA CORPORATION COMMISSION

Form 1002A

Rev. 2009

☒ ORIGINAL  
☒ AMENDED (Reason)

New

Fracture Stimulation

COMPLETION REPORT

TYPE OF DRILLING OPERATION

☒ STRAIGHT HOLE ☐ DIRECTIONAL HOLE ☐ HORIZONTAL HOLE  
☐ SERVICE WELL

If directional or horizontal, see reverse for bottom hole location.

COUNTY Texas SEC 10 TWP 4N RGE 14ECM  
LEASE NAME Hellbusch, A.  
WELL NO. 1  
SW 1/4 SW 1/4 NE 1/4 1/4 ENL OF 1/4 SEC 2500  
ELEVATION 3226' Ground  
Derrick FL 3226' Ground  
Latitude (if known) 36.828250  
Longitude (if known) -101.536944  
OPERATOR NAME Scout Energy Management LLC  
ADDRESS 4901 LBJ Freeway, Ste 300  
CITY Dallas STATE TX ZIP 75244

SPUD DATE 08/01/1945  
DRLG FINISHED DATE 09/08/1945  
DATE OF WELL COMPLETION 09/18/1945  
1st PROD DATE 09/18/1945  
RECOMP DATE 11/12/2018

640 Acres  
LOCATE WELL

COMPLETION TYPE

☒ SINGLE ZONE  
☐ MULTIPLE ZONE  
Application Date  
COMINGLED  
Application Date  
LOCATION EXCEPTION  
ORDER NO.  
INCREASED DENSITY  
ORDER NO.

CASING & CEMENT (Form 1002C must be attached)

TYPE	SIZE	WEIGHT	GRADE	FEET	PSI	SAX	TOP OF CMT
CONDUCTOR							
SURFACE	10.75	32.75	LW	335'		300	Surface
INTERMEDIATE							
PRODUCTION	7	20	SS	2680'		1000	600
LINER (Slotted)	5.5	14		2651'-2780'		NA	NA
						TOTAL DEPTH	2780'

PACKER @ 2640' BRAND & TYPE PLUG @ TYPE PLUG @ TYPE  
PACKER @ BRAND & TYPE PLUG @ TYPE PLUG @ TYPE

COMPLETION & TEST DATA BY PRODUCING FORMATION

FORMATION (Chase) Guyman-Hugoton  
SPACING & SPACING ORDER NUMBER  
CLASS: Oil, Gas, Dry, Inj, Disp, Comm Disp, Svc  
PERFORATED INTERVALS 2680'-2780'  
ACID/VOLUME 1000 gal. 15% HCl  
FRACTURE TREATMENT (Fluids/Prop Amounts) 50,000 lbs of 16/30 sand w/ 444 lbs wtr, Spec. Gravity 2.65 - 75 quality foam

Monitor Report to Frac Focus

Min Gas Allowable (165:10-17-7)

Gas Purchaser/Measurer

First Sales Date

INITIAL TEST DATA

INITIAL TEST DATE 11/12/2018  
OIL-BBL/DAY 0  
OIL-GRAVITY (API) -  
GAS-MCF/DAY 319  
GAS-OIL RATIO CU FT/BBL -  
WATER-BBL/DAY 0  
PUMPING OR FLOWING Flowing  
INITIAL SHUT-IN PRESSURE 1071  
CHOKE SIZE -  
FLOW TUBING PRESSURE -

AS SUBMITTED

A record of the formations drilled through, and pertinent remarks are presented on the reverse. I declare that I have knowledge of the contents of this report and am authorized by my organization to make this report, which was prepared by me or under my supervision and direction, with the data and facts stated herein to be true, correct, and complete to the best of my knowledge and belief.  
Signature: Emily J. Van Der Gryp  
NAME (PRINT OR TYPE): Emily J. Van Der Gryp  
DATE: 12/10/2018 (972) 325-1146  
PHONE NUMBER: 325-1146  
ADDRESS: 4901 LBJ Freeway, Ste 300  
CITY: Dallas STATE: TX ZIP: 75244  
EMAIL ADDRESS: evandergryp@scoutep.com

### FORMATION RECORD

LEASE NAME **Hellbusch, A.**

WELL NO. 1

NAMES OF FORMATIONS	TOP
451KRDR	2700
451WLD	2745
Herrington	2662
Towanda	2809
TD:	2780

FOR COMMISSION USE ONLY	
ITD on file	<input type="checkbox"/> YES <input type="checkbox"/> NO
APPROVED	DISAPPROVED
2) Reject Codes	

Were open hole logs run?               \_\_\_ yes     X no  
Date Last log was run                  Unknown  
Was CO<sub>2</sub> encountered?              \_\_\_ yes     X no     at what depths? \_\_\_\_\_  
Was H<sub>2</sub>S encountered?              \_\_\_ yes     X no     at what depths? \_\_\_\_\_  
  
Were unusual drilling circumstances encountered?   \_\_\_ yes     X no  
If yes, briefly explain below

Other remarks:

640 Acres

A 10x10 grid representing 640 acres. The grid is divided into four 5x5 quadrants by a thick vertical line between the first and second columns, and a thick horizontal line between the fifth and sixth rows. The top-left quadrant is shaded light blue. The text '640 Acres' is centered above the grid.

Direction must be stated in degrees azimuth.  
Please note, the horizontal drainhole and its end point must be located within the boundaries of the lease or spacing unit.

640 Acres

**BOTTOM HOLE LOCATION FOR DIRECTIONAL HOLE**

SEC	TWP	RGE	COUNTY
Spot Location			
1/4	1/4	1/4	1/4
Measured Total Depth		True Vertical Depth	BHL From Lease, Unit, or Property Line:

**BOTTOM HOLE LOCATION FOR HORIZONTAL HOLE: (LATERALS)**

**LATERAL #1**

SEC	TWP	RGE	COUNTY			
Spot Location				Feet From 1/4 Sec Lines	FSL	FWL
1/4	1/4	1/4	1/4			
Depth of Deviation	Radius of Turn		Direction	Total Length		
Measured Total Depth		True Vertical Depth	BHL From Lease, Unit, or Property Line:			

**LATERAL #2**

SEC	TWP	RGE	COUNTY			
Spot Location				Feet From 1/4 Sec Lines	FSL	FWL
1/4	1/4	1/4	1/4			
Depth of Deviation	Radius of Turn		Direction	Total Length		
Measured Total Depth		True Vertical Depth	BHL From Lease, Unit, or Property Line:			

**LATERAL #3**

SEC	TWP	RGE	COUNTY			
Spot Location				Feet From 1/4 Sec Lines	FSL	FWL
1/4	1/4	1/4	1/4			
Depth of Deviation		Radius of Turn	Direction	Total Length		
Measured Total Depth		True Vertical Depth	BHL From Lease, Unit, or Property Line:			

Footage Calculated 6PS

SW

11/12/18

01

API NO. 35-139-01127  
OTC PROD. UNIT NO. 139-020092

(PLEASE TYPE OR USE BLACK INK ONLY)

OKLAHOMA CORPORATION COMMISSION

Oil & Gas Conservation Division

Post Office Box 52000

Oklahoma City, Oklahoma 73152-2000

Rule 165:10-3-25

RECEIVED

DEC 11 2018

OKLAHOMA CORPORATION COMMISSION

Form 1002A

Rev. 2009

☒ ORIGINAL  
☒ AMENDED (Reason) **New Fracture Stimulation**

COMPLETION REPORT

TYPE OF DRILLING OPERATION  
☒ STRAIGHT HOLE ☐ DIRECTIONAL HOLE ☐ HORIZONTAL HOLE  
SERVICE WELL

If directional or horizontal, see reverse for bottom hole location.

COUNTY **Texas** SEC **10** TWP **4N** RGE **14ECM**

LEASE NAME **Hellbusch, A.**

SW 1/4 SW 1/4 NE 1/4 1/4 ENL OF 1/4 SEC **2500** FILE OF **FEL** 1/4 SEC **2530**

ELEVATION **3226'** Ground Latitude (if known) **36.828250**

OPERATOR NAME **Scout Energy Management LLC**

ADDRESS **4901 LBJ Freeway, Ste 300**

CITY **Dallas**

STATE **TX**

ZIP **75244**

SPUD DATE **08/01/1945**

DRLG FINISHED DATE **09/08/1945**

DATE OF WELL COMPLETION **09/18/1945**

1st PROD DATE **09/18/1945**

RECOMP DATE **11/12/2018**

Longitude (if known) **-101.536944**

OTC/OCC OPERATOR NO. **23138**

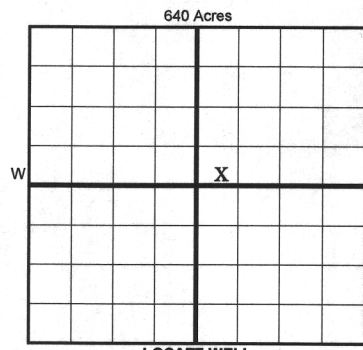

LOCATE WELL

COMPLETION TYPE

☒ SINGLE ZONE  
☐ MULTIPLE ZONE  
Application Date  
☐ COMMINGLED  
Application Date  
LOCATION EXCEPTION  
ORDER NO.  
INCREASED DENSITY  
ORDER NO.

CASING & CEMENT (Form 1002C must be attached)

TYPE	SIZE	WEIGHT	GRADE	FEET	PSI	SAX	TOP OF CMT
CONDUCTOR							
SURFACE	10.75	32.75	LW	335'		300	Surface
INTERMEDIATE							
PRODUCTION	7	20	SS	2680'		1000	600
LINER (Slotted)	5.5	14		2651'-2780'		NA	NA
						TOTAL DEPTH	2780'

PACKER @ **2640'** BRAND & TYPE

PLUG @ TYPE

PLUG @ TYPE

TOTAL DEPTH

PACKER @ BRAND & TYPE

PLUG @ TYPE

PLUG @ TYPE

COMPLETION & TEST DATA BY PRODUCING FORMATION

FORMATION	(Chase) <b>Guyman-Hugoton</b>						Monitor Report to Frac Focus
SPACING & SPACING ORDER NUMBER							
CLASS: Oil, Gas, Dry, Inj, Disp, Comm Disp, Svc	Gas						
PERFORATED INTERVALS	2680'-2780'						
ACID/VOLUME	1000 gal. 15% HCl						
FRACTURE TREATMENT (Fluids/Prop Amounts)	50,000 lbs of 16/30 sand w/ 444 lbs wtr, Spec. Gravity 2.65 - 75 quality foam						

Min Gas Allowable (165:10-17-7)

Gas Purchaser/Measurer

OR Oil Allowable (165:10-13-3)

First Sales Date

INITIAL TEST DATA

INITIAL TEST DATE	11/12/2018						
OIL-BBL/DAY	0						
OIL-GRAVITY (API)	-						
GAS-MCF/DAY	319						
GAS-OIL RATIO CU FT/BBL	-						
WATER-BBL/DAY	0						
PUMPING OR FLOWING	Flowing						
INITIAL SHUT-IN PRESSURE	1071						
CHOKE SIZE	-						
FLOW TUBING PRESSURE	-						

AS SUBMITTED

A record of the formations drilled through, and pertinent remarks are presented on the reverse. I declare that I have knowledge of the contents of this report and am authorized by my organization to make this report, which was prepared by me or under my supervision and direction, with the data and facts stated herein to be true, correct, and complete to the best of my knowledge and belief.

**Emily J. Van Der Gryp** SIGNATURE  
4901 LBJ Freeway, Ste 300 ADDRESS  
Dallas CITY TX 75244 STATE ZIP  
12/10/2018 DATE  
(972) 325-1146 PHONE NUMBER  
evandergryp@scoutep.com EMAIL ADDRESS

1016EZ

SCANNED

QR