

Oklahoma Corporation Commission  
Oil & Gas Conservation Division  
Post Office Box 52000  
Oklahoma City, Oklahoma 73152-2000  
Rule 165: 10-3-25

Form 1002A

API No.: 35073262240000

**Completion Report**

Spud Date: August 26, 2018

OTC Prod. Unit No.: 073-224512

Drilling Finished Date: September 20, 2018

1st Prod Date: October 31, 2018

Completion Date: October 09, 2018

**Drill Type: HORIZONTAL HOLE**

Min Gas Allowable: Yes

Well Name: RUTH 15-16-6 2HC

Purchaser/Measurer: CHESAPEAKE OPERATING LLC

Location: KINGFISHER 15 16N 6W  
SE SE SE SW  
315 FSL 2465 FWL of 1/4 SEC  
Derrick Elevation: 1134 Ground Elevation: 1107

First Sales Date: 11/06/2018

Operator: CHESAPEAKE OPERATING LLC 17441  
PO BOX 18496  
6100 N WESTERN AVE  
OKLAHOMA CITY, OK 73154-0496

Completion Type		Location Exception		Increased Density	
X	Single Zone	Order No		Order No	
	Multiple Zone	687789		680416	
	Commingled	687790		680417	

Casing and Cement								
Type		Size	Weight	Grade	Feet	PSI	SAX	Top of CMT
SURFACE		9 5/8	36	J-55	1474		595	SURFACE
PRODUCTION		7	26	P-110EC	7290		410	2252

Liner								
Type	Size	Weight	Grade	Length	PSI	SAX	Top Depth	Bottom Depth
LINER	4 1/2	13.50	P-110EC	9977	0	885	7006	16983

**Total Depth: 16985**

Packer	
Depth	Brand & Type
There are no Packer records to display.	

Plug	
Depth	Plug Type
There are no Plug records to display.	

Initial Test Data										
Test Date	Formation	Oil BBL/Day	Oil-Gravity (API)	Gas MCF/Day	Gas-Oil Ratio Cu FT/BBL	Water BBL/Day	Pumpin or Flowing	Initial Shut-In Pressure	Choke Size	Flow Tubing Pressure
Nov 25, 2018	OSWEGO	916	43.75	817	892	1498	PUMPING			137

**Completion and Test Data by Producing Formation**

Formation Name: OSWEGO

Code: 404OSWG

Class: OIL

**Spacing Orders**

Order No	Unit Size
654841	640
672942	640
687788	MULTIUNIT

**Perforated Intervals**

From	To
7210	16917

**Acid Volumes**

604,488 GALLONS ACID
----------------------

**Fracture Treatments**

95,725 BARRELS FLUIDS, 330 POUNDS PROPPANT
--

Formation	Top
OSWEGO	7200

Were open hole logs run? No

Date last log run:

Were unusual drilling circumstances encountered? No

Explanation:

**Other Remarks**

There are no Other Remarks.

**Lateral Holes**

Sec: 10 TWP: 16N RGE: 6W County: KINGFISHER

NW NE NE NW

279 FNL 2307 FWL of 1/4 SEC

Depth of Deviation: 5972 Radius of Turn: 728 Direction: 359 Total Length: 9785

Measured Total Depth: 16985 True Vertical Depth: 6700 End Pt. Location From Release, Unit or Property Line: 279

**FOR COMMISSION USE ONLY**

Status: Accepted

1141787

API  
NO. 073-26224  
OTC PROD.  
UNIT NO. 073-224512

PLEASE TYPE OR USE BLACK INK ONLY

NOTE:

Attach copy of original 1002A if recompletion or reentry.

OKLAHOMA CORPORATION COMMISSION

Oil & Gas Conservation Division

Post Office Box 52000

Oklahoma City, Oklahoma 73152-2000

Rule 165:10-3-25

RECEIVED

JAN 04 2018

Oklahoma Corporation  
Commission

Form 1002A

Rev. 2009

☒ ORIGINAL  
☐ AMENDED  
Reason Amended

TYPE OF DRILLING OPERATION

☐ STRAIGHT HOLE ☐ DIRECTIONAL HOLE ☒ HORIZONTAL HOLE  
☐ SERVICE WELL

If directional or horizontal, see reverse for bottom hole location.

COUNTY Kingfisher SEC 15 TWP 16N RGE 6W  
LEASE NAME Ruth 15-16-6 WELL NO 2HC  
SHL SE 1/4 SE 1/4 SE 1/4 SW 1/4 FSL 315 FWL OF 1/4 SEC 2,465  
ELEVATION  
Derrick Fl 1,134 Ground 1,107  
OPERATOR NAME CHESAPEAKE OPERATING, L.L.C. OTC/OCC OPERATOR NO. 17441  
ADDRESS P.O. BOX 18496  
CITY OKLAHOMA CITY STATE OK ZIP 73154

COMPLETION REPORT

SPUD DATE 8/26/2018  
DRLG FINISHED DATE 9/20/2018  
DATE OF WELL COMPLETION 10/9/2018  
1ST PROD DATE 10/31/2018  
RECOMP DATE  
Longitude (if Known)  
Latitude (if Known)

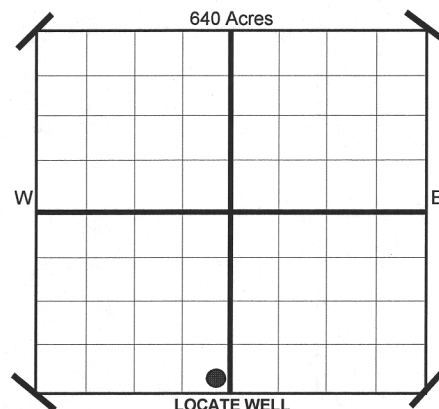

COMPLETION TYPE

☒ SINGLE ZONE  
☐ MULTIPLE ZONE  
Application Date  
COMINGLED  
Application Date  
LOCATION  
EXCEPTION ORDER NO. 687789 / 687790  
INCREASED DENSITY  
ORDER NO. 680416 / 680417

CASING & CEMENT (Form 1002C must be attached)

TYPE	SIZE	WEIGHT	GRADE	FEET	PSI	SAX	TOP
CONDUCTOR							
SURFACE	9-5/8"	36#	J-55	1,474		595	Surface
INTERMEDIATE							
PRODUCTION	7"	26#	P-110EC	7,290		410	2,252
LINER	4-1/2"	13.50#	P-110EC	7,006-16,983		885	7,006
TOTAL DEPTH							16,985

PACKER @ BRAND & TYPE  
PACKER @ BRAND & TYPE

PLUG @ TYPE  
PLUG @ TYPE  
PLUG @ TYPE  
PLUG @ TYPE

COMPLETION & TEST DATA BY PRODUCING FORMATION

FORMATION	Oswego	(Multiunit)				Reported to
SPACING & SPACING	640					Frac Focus
ORDER NUMBER	654841 / 672942	(687788) F.D.				
CLASS: Oil, Gas, Dry, Inj. Disp, Comm Disp, Svc	Oil					
	7,210 - 16,917					
PERFORATED INTERVALS						
ACID/VOLUME	604,488 gals acid 95,725 bbls fluids 330# proppant					
FRACTURE TREATMENT (Fluids/Prop Amounts)						

☒ Minimum Gas Allowable (165:10-17-7) Gas Purchaser/Measurer Chesapeake Operating, L.L.C.  
OR  
1st Sales Date 11/6/2018  
Oil Allowable (165:10-13-3)

INITIAL TEST DATA

INITIAL TEST DATE	11/25/2018				
OIL-BBL/DAY	916				
OIL-GRAVITY ( API)	43.75				
GAS-MCF/DAY	817				
GAS-OIL RATIO CU FT/BBL	892				
WATER-BBL/DAY	1,498				
PUMPING OR FLOWING	Pumping				
INITIAL SHUT-IN PRESSURE					
CHOKE SIZE					
FLOW TUBING PRESSURE	137				

AS SUBMITTED

A record of the formations drilled through, and pertinent remarks are presented on the reverse. I declare that I have knowledge of the contents of this report and am authorized by my organization to make this report, which was prepared by me or under my supervision and direction, with the data and facts stated herein to be true, correct, and complete to the best of my knowledge and belief.

Juanita Cooper  
SIGNATURE  
P.O. BOX 18496  
ADDRESS  
OKLAHOMA CITY  
CITY  
OK  
STATE  
73154  
ZIP  
1/3/2019  
DATE  
405-848-8000  
PHONE NUMBER  
juanita.cooper@chk.com  
EMAIL ADDRESS

PLEASE TYPE OR USE BLACK INK ONLY

FORMATION RECORD

Give formation names and tops, if available, or descriptions and thickness of formations drilled through. Show intervals cored or drillstem tested.

LEASE NAME Ruth 15-16-6

WELL NO. 2HC

NAMES OF FORMATIONS	TOP
Oswego	7,200

FOR COMMISSION USE ONLY	
ITD on file <input type="checkbox"/> YES <input type="checkbox"/> NO	
APPROVED _____	DISAPPROVED _____
2) Reject Codes	
_____	
_____	
_____	
_____	

Were open hole logs run?	yes <input checked="" type="checkbox"/> no <input type="checkbox"/>
Date Last log was run	N/A
Was CO <sub>2</sub> encountered?	yes <input checked="" type="checkbox"/> no <input type="checkbox"/> at what depths?
Was H <sub>2</sub> S encountered?	yes <input checked="" type="checkbox"/> no <input type="checkbox"/> at what depths?
Were unusual drilling circumstances encountered?	yes <input type="checkbox"/> no <input checked="" type="checkbox"/>
If yes, briefly explain.	

Other remarks:

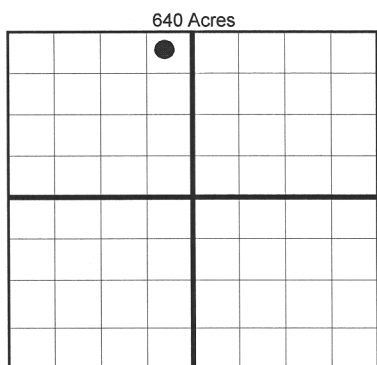

**BOTTOM HOLE LOCATION FOR DIRECTIONAL HOLE**

SEC	TWP	RGE	COUNTY
Spot Location	1/4	1/4	1/4
Measured Total Depth	True Vertical Depth	BHL From Lease, Unit, or Property Line:	

**BOTTOM HOLE LOCATION FOR HORIZONTAL HOLE: (LATERALS)**

SEC	TWP	RGE	COUNTY
10	16N	6W	Kingfisher
Spot Location	NW 1/4	NE 1/4	NW 1/4
Depth of Deviation	5,972	Radius of Turn	728
Measured Total Depth	16,985	True Vertical Depth	6,700
		Direction	359
		Total Length	9,785
		BHL From Lease, Unit, or Property Line:	
		279	

**LATERAL #2**

SEC	TWP	RGE	COUNTY
Spot Location	1/4	1/4	1/4
Depth of Deviation		Radius of Turn	
Measured Total Depth		True Vertical Depth	
		Direction	
		Total Length	
		BHL From Lease, Unit, or Property Line:	

**LATERAL #3**

SEC	TWP	RGE	COUNTY
Spot Location	1/4	1/4	1/4
Depth of Deviation		Radius of Turn	
Measured Total Depth		True Vertical Depth	
		Direction	
		Total Length	
		BHL From Lease, Unit, or Property Line:	

If more than three drainholes are proposed, attach a separate sheet indicating the necessary information.

Direction must be stated in degrees azimuth.  
Please note, the horizontal drainhole and its end point must be located within the boundaries of the lease or spacing unit.

**Directional surveys are required for all drainholes and directional wells.**

640 Acres

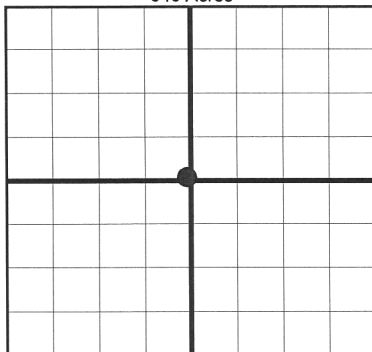

# CHESAPEAKE ENERGY

OPERATOR: CHESAPEAKE OPERATING, LLC  
LEASE NAME: RUTH 15-16-6  
WELL NO. 2HC  
STAKED DATE: 4/23/18

GROUND ELEVATION: 1106.50 GR. AT STAKE  
SURFACE HOLE FOOTAGE: 315' FSL - 2465' FWL  
SECTION: 15 TOWNSHIP: T16N RANGE: R6W  
KINGFISHER COUNTY, STATE: OK

BOTTOM HOLE: 10-T16N-R6W-1.M.  
BOTTOM HOLE FOOTAGE: 279' FNL - 2307' FWL  
BOTTOM PERF FOOTAGE: 347' FNL - 2307' FWL  
TOP PERF FOOTAGE: 526' FSL - 2255' FWL  
PENETRATION POINT FOOTAGE: 517' FSL - 2255' FWL  
ACCESSIBILITY TO LOCATION: FROM SOUTH LINE  
TOPOGRAPHY & VEGETATION: LOCATION FELL ON THE SOUTH EDGE OF A FIELD.

DISTANCE & DIRECTION FROM HWY JCT OR TOWN:  
FROM THE TOWN OF KINGFISHER HEAD EAST ON  
OK-33 FOR ±5.5MI TO N2900RD, CONTINUE EAST  
±0.4MI, PAD SITE IS NORTH OF THE ROAD.

## SURFACE HOLE DATA

### STATE PLANE COORDINATES:

ZONE: OK-NORTH NAD27  
X: 2051735.6  
Y: 312133.6  
GPS DATUM: NAD27  
LAT: 35.85736498  
LONG: -97.82541746

### STATE PLANE COORDINATES:

ZONE: OK-NORTH NAD83  
X: 2020136.9  
Y: 312157.7  
GPS DATUM: NAD83  
LAT: 35.85740893  
LONG: -97.82574613

## TOP PERF DATA

### STATE PLANE COORDINATES:

ZONE: OK-NORTH NAD27  
X: 2051524.9  
Y: 312345.8  
GPS DATUM: NAD27  
LAT: 35.85794892  
LONG: -97.82612702

### STATE PLANE COORDINATES:

ZONE: OK-NORTH NAD83  
X: 2019926.3  
Y: 312369.8  
GPS DATUM: NAD83  
LAT: 35.85799285  
LONG: -97.82645573  
MD: 7210'

## BOTTOM HOLE DATA

### STATE PLANE COORDINATES:

ZONE: OK-NORTH NAD27  
X: 2051531.3  
Y: 322117.8  
GPS DATUM: NAD27  
LAT: 35.88479458  
LONG: -97.82604648

### STATE PLANE COORDINATES:

ZONE: OK-NORTH NAD83  
X: 2019932.5  
Y: 322141.8  
GPS DATUM: NAD83  
LAT: 35.88483781  
LONG: -97.82637567  
MD: 16985'

## PENETRATION POINT DATA

### STATE PLANE COORDINATES:

ZONE: OK-NORTH NAD27  
X: 2051524.8  
Y: 312336  
GPS DATUM: NAD27  
LAT: 35.85792211  
LONG: -97.82612752

### STATE PLANE COORDINATES:

ZONE: OK-NORTH NAD83  
X: 2019926.1  
Y: 312360.1  
GPS DATUM: NAD83  
LAT: 35.85796604  
LONG: -97.82645622  
MD: 7200'

## BOTTOM PERF DATA

### STATE PLANE COORDINATES:

ZONE: OK-NORTH NAD27  
X: 2051532.3  
Y: 322049.8  
GPS DATUM: NAD27  
LAT: 35.88460779  
LONG: -97.82604363

### STATE PLANE COORDINATES:

ZONE: OK-NORTH NAD83  
X: 2019933.5  
Y: 322073.9  
GPS DATUM: NAD83  
LAT: 35.88465102  
LONG: -97.82637281  
MD: 16917'

BASIS OF BEARING:  
GRID NORTH (NAD 83)  
OKLAHOMA - NORTH ZONE

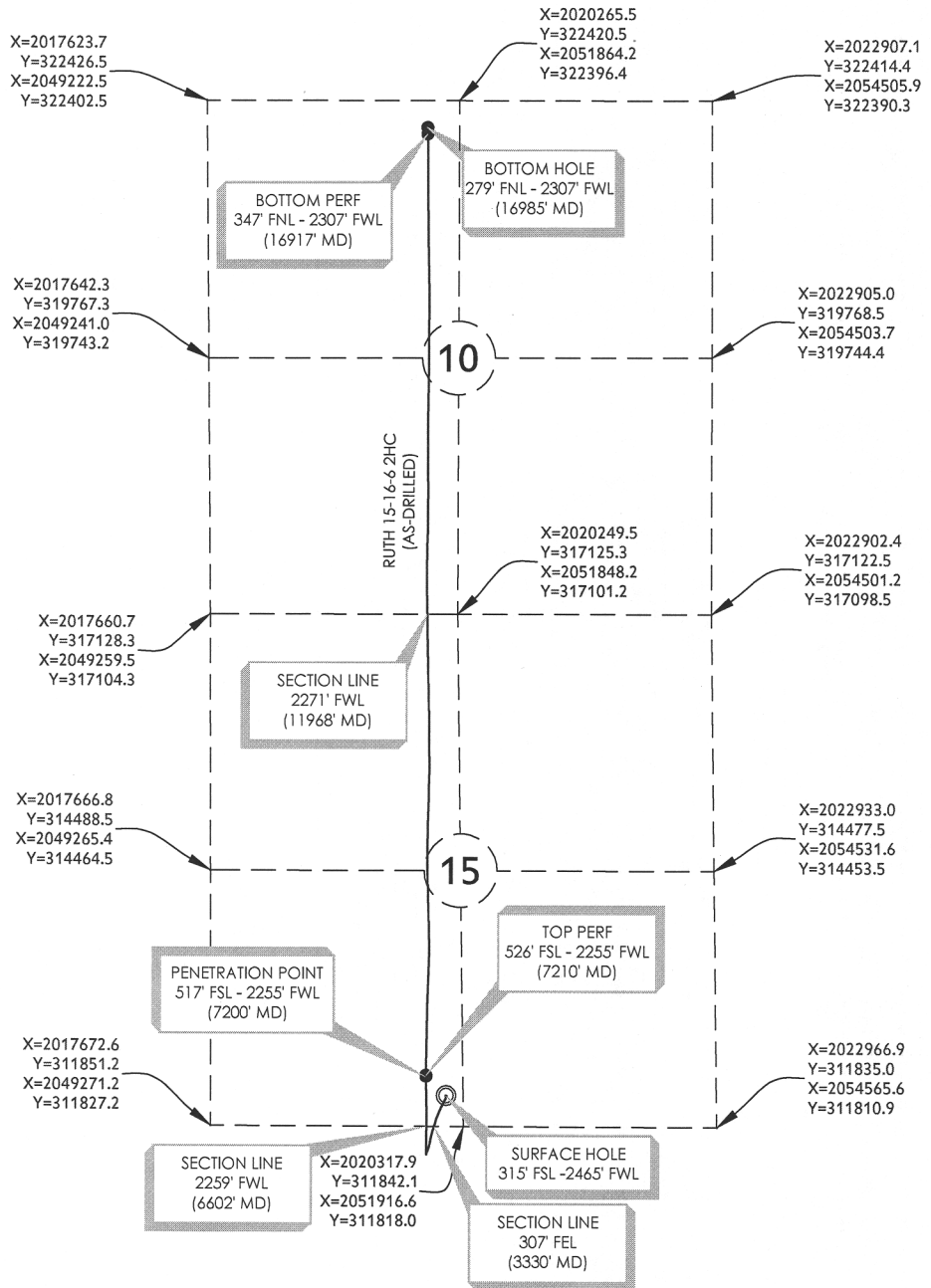

RUTH 15-16-6 2HC

PART OF THE SW/4 OF  
SECTION 15, T16N, R6W  
AS-DRILLED EXHIBIT  
KINGFISHER COUNTY, OKLAHOMA

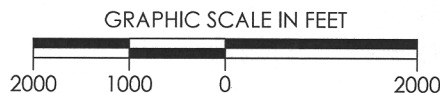

300 Pointe Parkway Blvd  
Yukon, OK 73099  
405.787.6270 f 405.787.6276 f  
www.craftontull.com

**Crafton Tull**  
SURVEYING  
CERTIFICATE OF AUTHORIZATION:  
CA 973 (PE/LS) EXPIRES 6/30/2018

SCALE: 1" = 2000'  
PLOT DATE: 11-13-2018

DRAWING: 17601117-AD-WELL  
DRAWN BY: DW

SHEET NO.: 1 OF 1