

Oklahoma Corporation Commission
Oil & Gas Conservation Division
Post Office Box 52000
Oklahoma City, Oklahoma 73152-2000
Rule 165: 10-3-25

Form 1002A

API No.: 35125239390000

Completion Report

Spud Date: September 11, 2018

OTC Prod. Unit No.:

Drilling Finished Date: September 17, 2018

1st Prod Date: September 29, 2018

Completion Date: September 29, 2018

Drill Type: STRAIGHT HOLE

Well Name: DEATHERAGE B-2

Purchaser/Measurer:

Location: POTTAWATOMIE 28 7N 4E
C NE NW
660 FNL 1980 FWL of 1/4 SEC
Derrick Elevation: 0 Ground Elevation: 976

First Sales Date:

Operator: PHOENIX OIL & GAS INC 10952
PO BOX 1859
35863 HIGHWAY 270
SEMINOLE, OK 74818-1859

Completion Type		Location Exception		Increased Density	
X	Single Zone	Order No		Order No	
	Multiple Zone	There are no Location Exception records to display.		There are no Increased Density records to display.	
	Commingled				

Casing and Cement							
Type	Size	Weight	Grade	Feet	PSI	SAX	Top of CMT
SURFACE	8 5/8	32	J-55	342		220	SURFACE
PRODUCTION	5 1/2	17	J-55	4068		150	3068

Liner								
Type	Size	Weight	Grade	Length	PSI	SAX	Top Depth	Bottom Depth
There are no Liner records to display.								

Total Depth: 4167

Packer		Plug	
Depth	Brand & Type	Depth	Plug Type
There are no Packer records to display.		There are no Plug records to display.	

Initial Test Data										
Test Date	Formation	Oil BBL/Day	Oil-Gravity (API)	Gas MCF/Day	Gas-Oil Ratio Cu FT/BBL	Water BBL/Day	Pumpin or Flowing	Initial Shut-In Pressure	Choke Size	Flow Tubing Pressure
Sep 29, 2018	SIMPSON DOLOMITE	12				1400	PUMPING			

Completion and Test Data by Producing Formation

Formation Name: SIMPSON DOLOMITE

Code: 202SMPSD

Class: OIL

Spacing Orders**Order No****Unit Size**

There are no Spacing Order records to display.

Perforated Intervals**From****To**

There are no Perf. Intervals records to display.

Acid Volumes

250 GALLONS

Fracture Treatments

NONE

Formation	Top
EARLSBORO	3566
MISENER	3766
CHIMNEY HILL	3878
VIOLA	4036
SIMPSON DOLOMITE	4164

Were open hole logs run? Yes

Date last log run: September 16, 2018

Were unusual drilling circumstances encountered? No

Explanation:

Other Remarks

OCC - THIS WELL IS AN OPEN HOLE COMPLETION FROM BOTTOM OF THE 5 1/2" CASING AT 4,068' TO TOTAL DEPTH AT 4,167'.

FOR COMMISSION USE ONLY

1141807

Status: Accepted

RECEIVED

JAN 07 2019

Form 1002A
Rev. 2009

API NO. **125-23939**
OTC PROD.
UNIT NO.

PLEASE TYPE OR USE BLACK INK ONLY
NOTE:

Attach copy of original 1002A
if recompletion or reentry.

OKLAHOMA CORPORATION COMMISSION
Oil & Gas Conservation Division
Post Office Box 52000
Oklahoma City, Oklahoma 73152-2000
Rule 165:10-3-25

OKLAHOMA CORPORATION
COMMISSION

☒ ORIGINAL
AMENDED (Reason)

COMPLETION REPORT

TYPE OF DRILLING OPERATION

☒ STRAIGHT HOLE ☐ DIRECTIONAL HOLE ☐ HORIZONTAL HOLE
☐ SERVICE WELL

If directional or horizontal, see reverse for bottom hole location.

COUNTY **Pottawatomie** SEC **28** TWP **1N** RGE **4E**
LEASE NAME **Deathridge**
1/4 **C** 1/4 **NE 1/4 NW 1/4** 50' OF FNL 1/4 SEC **660** FWL OF 1/4 SEC **1980**

ELEVATION Ground **972** Latitude (if known)

OPERATOR NAME **Phoenix Oil & Gas Inc.** OTC/OCC OPERATOR NO. **10952**

ADDRESS **P.O. Box 1859**

CITY **Seminole** STATE **OKLA** ZIP **74818**

SPUD DATE **9/11/18**
DRLG FINISHED DATE **9/17/18**
DATE OF WELL COMPLETION **9/29/18**
1st PROD DATE **9/29/18**

RECOMP DATE
Longitude (if known)

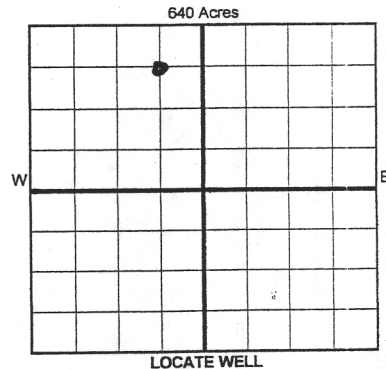

COMPLETION TYPE

☒ SINGLE ZONE ☒ MULTIPLE ZONE
Application Date
COMMINGLED
Application Date
LOCATION
EXCEPTION ORDER
INCREASED DENSITY
ORDER NO.

CASING & CEMENT (Form 1002C must be attached)

TYPE	SIZE	WEIGHT	GRADE	FEET	PSI	SAX	TOP OF CMT
CONDUCTOR							
SURFACE	8 5/8	32#	J-55	342		220	Circulate to Surface
INTERMEDIATE							
PRODUCTION	5 1/2	17#	J-55	4068'		150	3068
LINER							
TOTAL DEPTH						4167	

PACKER @ _____ BRAND & TYPE _____ PLUG @ _____ TYPE _____ PLUG @ _____ TYPE _____
PACKER @ _____ BRAND & TYPE _____ PLUG @ _____ TYPE _____ PLUG @ _____ TYPE _____

COMPLETION & TEST DATA BY PRODUCING FORMATION

FORMATION	Simp/Dolomite					No Frac
SPACING & SPACING ORDER NUMBER						
CLASS: Oil, Gas, Dry, Inj, Disp, Comm Disp, Svc	Oil					
PERFORATED INTERVALS	Open Hole 4070-4167					
ACID/VOLUME	250 gals					
FRACTURE TREATMENT (Fluids/Prop Amounts)	None					

Min Gas Allowable (165:10-17-7)

Gas Purchaser/Measurer

☐

OR

First Sales Date

INITIAL TEST DATA

Oil Allowable (165:10-13-3)

INITIAL TEST DATE	9/29/18				
OIL-BBL/DAY	12				
OIL-GRAVITY (API)					
GAS-MCF/DAY					
GAS-OIL RATIO CU FT/BBL					
WATER-BBL/DAY	1400				
PUMPING OR FLOWING	Pumping				
INITIAL SHUT-IN PRESSURE					
CHOKE SIZE					
FLOW TUBING PRESSURE					

AS SUBMITTED

A record of the formations drilled through, and pertinent remarks are presented on the reverse. I declare that I have knowledge of the contents of this report and am authorized by my organization to make this report, which was prepared by me or under my supervision and direction, with the data and facts stated herein to be true, correct, and complete to the best of my knowledge and belief.

Mark Roads Field Supt
SIGNATURE NAME (PRINT OR TYPE)
P.O. Box 1859 Seminole OK 74818
ADDRESS CITY STATE ZIP
1/2/19 **382-0535**
DATE PHONE NUMBER
EMAIL ADDRESS

PLEASE TYPE OR USE BLACK INK ONLY

FORMATION RECORD

Give formation names and tops, if available, or descriptions and thickness of formations drilled through. Show intervals cored or drillstem tested.

NAMES OF FORMATIONS	TOP
Earlsboro	3566
Miscner	3764
Chumney Hill	3878
Viola	4036
Simp / Delo	4164
TD	4167

LEASE NAME

Deatherage B-2

WELL NO. B-2

FOR COMMISSION USE ONLY

ITD on file

☐ YES

☐ NO

APPROVED

DISAPPROVED

2) Reject Codes

Were open hole logs run?

☒ yes ☐ no

Date Last log was run

9/16/13

Was CO₂ encountered?

☐ yes ☒ no at what depths?

Was H₂S encountered?

☐ yes ☒ no at what depths?

Were unusual drilling circumstances encountered?

☐ yes ☒ no

If yes, briefly explain below

Other remarks:

OCC - This well is an open hole completion from bottom of the 5 1/2" casing at 4068' to total depth at 4167'.

640 Acres

If more than three drainholes are proposed, attach a separate sheet indicating the necessary information.

Direction must be stated in degrees azimuth. Please note, the horizontal drainhole and its end point must be located within the boundaries of the lease or spacing unit.

Directional surveys are required for all drainholes and directional wells.

640 Acres

BOTTOM HOLE LOCATION FOR DIRECTIONAL HOLE

SEC	TWP	RGE	COUNTY
Spot Location	1/4	1/4	1/4
Measured Total Depth	True Vertical Depth	BHL From Lease, Unit, or Property Line:	

BOTTOM HOLE LOCATION FOR HORIZONTAL HOLE: (LATERALS)

LATERAL #1

SEC	TWP	RGE	COUNTY
Spot Location	1/4	1/4	1/4
Depth of Deviation	Radius of Turn	Direction	Total Length
Measured Total Depth	True Vertical Depth	BHL From Lease, Unit, or Property Line:	

LATERAL #2

SEC	TWP	RGE	COUNTY
Spot Location	1/4	1/4	1/4
Depth of Deviation	Radius of Turn	Direction	Total Length
Measured Total Depth	True Vertical Depth	BHL From Lease, Unit, or Property Line:	

LATERAL #3

SEC	TWP	RGE	COUNTY
Spot Location	1/4	1/4	1/4
Depth of Deviation	Radius of Turn	Direction	Total Length
Measured Total Depth	True Vertical Depth	BHL From Lease, Unit, or Property Line:	