

Oklahoma Corporation Commission
Oil & Gas Conservation Division
Post Office Box 52000
Oklahoma City, Oklahoma 73152-2000
Rule 165: 10-3-25

Form 1002A

API No.: 35125239080001

Completion Report

Spud Date: June 15, 2018

OTC Prod. Unit No.:

Drilling Finished Date: June 22, 2018

1st Prod Date: July 26, 2018

Completion Date: July 18, 2018

Drill Type: STRAIGHT HOLE

Well Name: DEATHERAGE 11

Purchaser/Measurer:

Location: POTTAWATOMIE 28 7N 4E
N2 N2 S2 NW
1155 FSL 1320 FWL of 1/4 SEC
Derrick Elevation: 0 Ground Elevation: 1006

First Sales Date:

Operator: PHOENIX OIL & GAS INC 10952
PO BOX 1859
35863 HIGHWAY 270
SEMINOLE, OK 74818-1859

Completion Type		Location Exception		Increased Density	
X	Single Zone	Order No		Order No	
	Multiple Zone	There are no Location Exception records to display.		There are no Increased Density records to display.	
	Commingled				

Casing and Cement							
Type	Size	Weight	Grade	Feet	PSI	SAX	Top of CMT
SURFACE	8 5/8	32	J-55	372		220	SURFACE
PRODUCTION	5 1/2	17	J-55	4106		100	3606

Liner								
Type	Size	Weight	Grade	Length	PSI	SAX	Top Depth	Bottom Depth
There are no Liner records to display.								

Total Depth: 4174

Packer		Plug	
Depth	Brand & Type	Depth	Plug Type
There are no Packer records to display.		There are no Plug records to display.	

Initial Test Data										
Test Date	Formation	Oil BBL/Day	Oil-Gravity (API)	Gas MCF/Day	Gas-Oil Ratio Cu FT/BBL	Water BBL/Day	Pumpin or Flowing	Initial Shut-In Pressure	Choke Size	Flow Tubing Pressure
Jul 26, 2018	SIMPSON DOLOMITE	16				700	PUMPING			

Completion and Test Data by Producing Formation			
Formation Name: SIMPSON DOLOMITE		Code: 202SMPSD	Class: OIL
Spacing Orders		Perforated Intervals	
Order No	Unit Size	From	To
There are no Spacing Order records to display.		There are no Perf. Intervals records to display.	
Acid Volumes		Fracture Treatments	
NONE		NONE	

Formation	Top
EARLSBORO	3540
MISENER	3815
CHIMNEY HILL	3820
VIOLA	4050
SIMPSON DOLOMITE	4070

Were open hole logs run? No
Date last log run:

Were unusual drilling circumstances encountered? No
Explanation:

Other Remarks
OCC - THIS WELL IS AN OPEN HOLE COMPLETION FROM BOTTOM OF THE 5 1/2" CASING AT 4,106' TO TOTAL DEPTH AT 4,174'.

FOR COMMISSION USE ONLY	
Status: Accepted	1141806

API NO. **125-23908**
OTC PROD.
UNIT NO.

PLEASE TYPE OR USE BLACK INK ONLY
NOTE:

Attach copy of original 1002A
if recompletion or reentry.

OKLAHOMA CORPORATION COMMISSION
Oil & Gas Conservation Division
Post Office Box 52000
Oklahoma City, Oklahoma 73152-2000
Rule 165:10-3-25

RECEIVED

JAN 07 2019

Form 1002A
Rev. 2009

OKLAHOMA CORPORATION
COMMISSION

☒ ORIGINAL
☐ AMENDED (Reason)

COMPLETION REPORT

TYPE OF DRILLING OPERATION

☒ STRAIGHT HOLE ☐ DIRECTIONAL HOLE ☐ HORIZONTAL HOLE
☐ SERVICE WELL

If directional or horizontal, see reverse for bottom hole location.

COUNTY	SEC	TWP	RGE	DATE OF WELL COMPLETION
Pottawatomie	28	7N	4E	7/18/18
LEASE NAME	WELL NO.	DATE OF 1st PROD	RECOMP DATE	
Deatheras	11	7/26/18		
N 1/4 N 1/4 S 1/4 NW 1/4	FSL OF 1/4 SEC	FWL OF 1/4 SEC	Longitude (if known)	
N 1/4	1155	1200		
ELEVATION	Ground	Latitude (if known)	Longitude (if known)	
1006				
OPERATOR NAME	OTC/OCC OPERATOR NO.			
Phoenix Oil & Gas Inc	10952			
ADDRESS				
P.O. Box 1859				
CITY	STATE	ZIP		
Seminole	OK	74818		

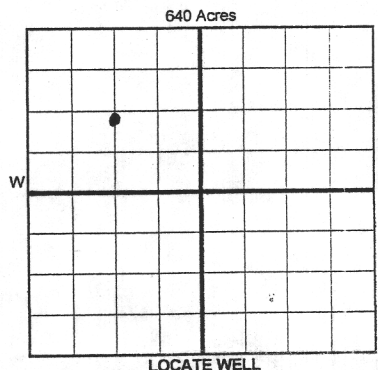

COMPLETION TYPE

SINGLE ZONE	<input checked="" type="checkbox"/>
MULTIPLE ZONE	<input type="checkbox"/>
Application Date	
COMINGLED	<input type="checkbox"/>
Application Date	
LOCATION	
EXCEPTION ORDER	
INCREASED DENSITY	
ORDER NO	

CASING & CEMENT (Form 1002C must be attached)

TYPE	SIZE	WEIGHT	GRADE	FEET	PSI	SAX	TOP OF CMT
CONDUCTOR							
SURFACE	3 1/2	32#	J-55	372		220	Circulate to surface
INTERMEDIATE							
PRODUCTION	5 1/2	17#	J-55	4106		100	3406
LINER							

PACKER @ _____ BRAND & TYPE _____ PLUG @ _____ TYPE _____ PLUG @ _____ TYPE _____
PACKER @ _____ BRAND & TYPE _____ PLUG @ _____ TYPE _____ PLUG @ _____ TYPE _____

TOTAL DEPTH **4124**

COMPLETION & TEST DATA BY PRODUCING FORMATION

FORMATION	Simp/Deionite				No Frac
SPACING & SPACING ORDER NUMBER					
CLASS: Oil, Gas, Dry, Inj, Disp, Comm Disp, Svc	O.I.				
PERFORATED INTERVALS	Open Hole				
	4106-4174				
ACID/VOLUME	None				
FRACTURE TREATMENT (Fluids/Prop Amounts)	None				

Min Gas Allowable (165:10-17-7)

Gas Purchaser/Measurer

☐

OR

First Sales Date

Oil Allowable (165:10-13-3)

INITIAL TEST DATA

INITIAL TEST DATE	7/26/18				
OIL-BBL/DAY	14				
OIL-GRAVITY (API)					
GAS-MCF/DAY					
GAS-OIL RATIO CU FT/BBL					
WATER-BBL/DAY	200				
PUMPING OR FLOWING	Pumping				
INITIAL SHUT-IN PRESSURE					
CHOKE SIZE					
FLOW TUBING PRESSURE					

AS SUBMITTED

A record of the formations drilled through, and pertinent remarks are presented on the reverse. I declare that I have knowledge of the contents of this report and am authorized by my organization to make this report which was prepared by me or under my supervision and direction, with the data and facts stated herein to be true, correct, and complete to the best of my knowledge and belief.

Mark Rhoads **Mark Rhoads** **1/2/19** **282-0935**
SIGNATURE NAME (PRINT OR TYPE) DATE PHONE NUMBER
P.O. Box **Seminole** **OK** **74818**
ADDRESS CITY STATE ZIP EMAIL ADDRESS

PLEASE TYPE OR USE BLACK INK ONLY
FORMATION RECORD

Give formation names and tops, if available, or descriptions and thickness of formations drilled through. Show intervals cored or drillstem tested.

NAMES OF FORMATIONS	TOP
Earlsboro	3540
Miscner	3815
Chimney Hill	3820
Viola	4050
Simp/Delo	4070
TD	4174

LEASE NAME

Deatherage

WELL NO.

11

FOR COMMISSION USE ONLY

ITD on file ☐ YES ☐ NO

APPROVED _____ DISAPPROVED _____

2) Reject Codes

Were open hole logs run? ☐ yes ☒ no

Date Last log was run _____

Was CO₂ encountered? ☐ yes ☒ no at what depths? _____

Was H₂S encountered? ☐ yes ☒ no at what depths? _____

Were unusual drilling circumstances encountered? ☐ yes ☐ no
If yes, briefly explain below _____

Other remarks:

OCC - This well is an open hole completion from bottom of the 5 1/2" casing at 4106' to total depth at 4174'.

640 Acres

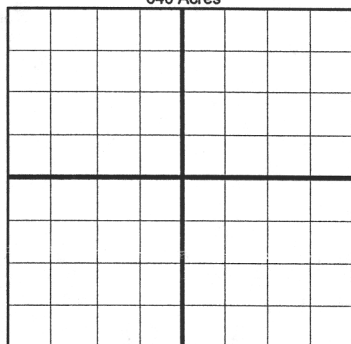

If more than three drainholes are proposed, attach a separate sheet indicating the necessary information.

Direction must be stated in degrees azimuth. Please note, the horizontal drainhole and its end point must be located within the boundaries of the lease or spacing unit.

Directional surveys are required for all drainholes and directional wells.

640 Acres

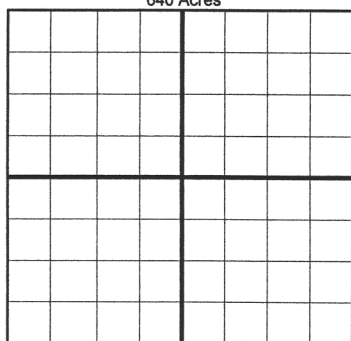

BOTTOM HOLE LOCATION FOR DIRECTIONAL HOLE

SEC	TWP	RGE	COUNTY
Spot Location	1/4	1/4	1/4
Measured Total Depth	True Vertical Depth	BHL From Lease, Unit, or Property Line:	

BOTTOM HOLE LOCATION FOR HORIZONTAL HOLE: (LATERALS)

LATERAL #1

SEC	TWP	RGE	COUNTY
Spot Location	1/4	1/4	1/4
Depth of Deviation	Radius of Turn	Direction	Total Length
Measured Total Depth	True Vertical Depth	BHL From Lease, Unit, or Property Line:	

LATERAL #2

SEC	TWP	RGE	COUNTY
Spot Location	1/4	1/4	1/4
Depth of Deviation	Radius of Turn	Direction	Total Length
Measured Total Depth	True Vertical Depth	BHL From Lease, Unit, or Property Line:	

LATERAL #3

SEC	TWP	RGE	COUNTY
Spot Location	1/4	1/4	1/4
Depth of Deviation	Radius of Turn	Direction	Total Length
Measured Total Depth	True Vertical Depth	BHL From Lease, Unit, or Property Line:	