

Oklahoma Corporation Commission  
Oil & Gas Conservation Division  
Post Office Box 52000  
Oklahoma City, Oklahoma 73152-2000  
Rule 165: 10-3-25

Form 1002A

API No.: 35139011600001

**Completion Report**

Spud Date: April 25, 1944

OTC Prod. Unit No.:

Drilling Finished Date: May 13, 1944

**Amended**

1st Prod Date:

Amend Reason: NEW FRACTURE STIMULATION

Completion Date: May 27, 1944

Recomplete Date: November 12, 2018

**Drill Type: STRAIGHT HOLE**

Well Name: A C MOORE 1

Purchaser/Measurer:

Location: TEXAS 28 4N 15E CM  
SE SE SE NW  
2580 FNL 2520 FWL of 1/4 SEC  
Latitude: 36.784111 Longitude: -101.447944  
Derrick Elevation: 3116 Ground Elevation: 0

First Sales Date:

Operator: SCOUT ENERGY MANAGEMENT LLC 23138

4901 LBJ FWY STE 300  
DALLAS, TX 75244-6107

Completion Type		Location Exception		Increased Density	
X	Single Zone	Order No		Order No	
	Multiple Zone	There are no Location Exception records to display.		There are no Increased Density records to display.	
	Commingled				

Casing and Cement							
Type	Size	Weight	Grade	Feet	PSI	SAX	Top of CMT
SURFACE	10.75	32.75	LW	530		300	SURFACE
PRODUCTION	7	24	SS	2702		1000	600

Liner								
Type	Size	Weight	Grade	Length	PSI	SAX	Top Depth	Bottom Depth
LINER	5.5	14		127	0	0	2675	2802

**Total Depth: 2804**

Packer		Plug	
Depth	Brand & Type	Depth	Plug Type
2640	PACKER	There are no Plug records to display.	

Initial Test Data
-------------------

Test Date	Formation	Oil BBL/Day	Oil-Gravity (API)	Gas MCF/Day	Gas-Oil Ratio Cu FT/BBL	Water BBL/Day	Pumpin or Flowing	Initial Shut-In Pressure	Choke Size	Flow Tubing Pressure
Nov 12, 2018	GUYMON-HUGOTON			190			FLOWING	977		

#### Completion and Test Data by Producing Formation

Formation Name: GUYMON-HUGOTON

Code: 451GYHG

Class: GAS

#### Spacing Orders

Order No

Unit Size

There are no Spacing Order records to display.

#### Perforated Intervals

From

To

There are no Perf. Intervals records to display.

#### Acid Volumes

1,000 GALLONS 15% HCL

#### Fracture Treatments

50,000 POUNDS 16/30 SAND WITH 444 POUNDS WATER, SPEC. GRAVITY 2.65 - 75 QUALITY FOAM

Formation	Top
HERINGTON	2653
KRIDER	2753
WINFIELD	2760
TOWANDA	2810

Were open hole logs run? No

Date last log run:

Were unusual drilling circumstances encountered? No

Explanation:

#### Other Remarks

OCC - THIS WELL IS AN OPEN HOLE COMPLETION FROM BOTTOM OF THE 7" CASING AT 2,702' TO TOTAL DEPTH 2,804'. THE 5 1/2" LINER IS NOT CEMENTED SLOTTED LINER.

#### FOR COMMISSION USE ONLY

1141462

Status: Accepted

Footage Calculated GPS  
SE

API NO. 35-139-01160  
OTC PROD.  
UNIT NO.

(PLEASE TYPE OR USE BLACK INK ONLY)

OKLAHOMA CORPORATION COMMISSION  
Oil & Gas Conservation Division  
Post Office Box 52000  
Oklahoma City, Oklahoma 73152-2000  
Rule 165-10-3-25

RECEIVED

DEC 11 2018

OKLAHOMA CORPORATION COMMISSION

Form 1002A

Rev. 2009

☒ ORIGINAL  
☒ AMENDED (Reason) **New Fracture Stimulation**

TYPE OF DRILLING OPERATION  
☒ STRAIGHT HOLE ☐ DIRECTIONAL HOLE ☐ HORIZONTAL HOLE  
☒ SERVICE WELL  
If directional or horizontal, see reverse for bottom hole location.

COUNTY	Texas	SEC	28	TWP	4N	RGE	15ECM
LEASE NAME	Moore, A. C.			WELL NO.	1	Center	
SE 1/4	SE 1/4	NW 1/4	1/4	FWL OF 1/4 SEC	2580	FWL OF 1/4 SEC	2520
ELEVATION	3116'	Ground	Latitude (if known)	36.784111	Longitude (if known)	-101.447944	
OPERATOR NAME	Scout Energy Management LLC			OTC/OCC OPERATOR NO.	23138		
ADDRESS	4901 LBJ Freeway, Ste 300						
CITY	Dallas	STATE	TX	ZIP	75244		

SPUD DATE 04/25/1944  
DRLG FINISHED DATE 05/13/1944  
DATE OF WELL COMPLETION 05/27/1944  
1st PROD DATE  
RECOMP DATE 11/12/2018

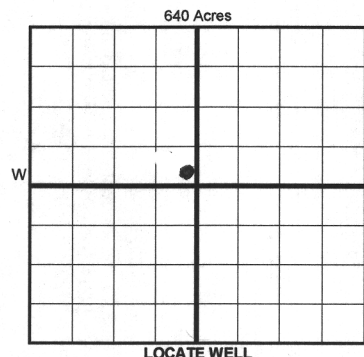

COMPLETION TYPE  
☒ SINGLE ZONE  
☐ MULTIPLE ZONE  
Application Date  
COMMINGLED  
Application Date  
LOCATION EXCEPTION  
ORDER NO.  
INCREASED DENSITY  
ORDER NO.

CASING & CEMENT (Form 1002C must be attached)

TYPE	SIZE	WEIGHT	GRADE	FEET	PSI	SAX	TOP OF CMT
CONDUCTOR							
SURFACE	10.75	32.75	LW	530'		300	Surface
INTERMEDIATE							
PRODUCTION	7	24	SS	2702'		1000	600'
LINER (Slotted)	5.5	14		2675'-2802'		NA	NA

PACKER @ 2640' BRAND & TYPE  
PACKER @ BRAND & TYPE  
PLUG @ TYPE  
PLUG @ TYPE  
PLUG @ TYPE  
PLUG @ TYPE

TOTAL DEPTH 2802'

Rec'd original 1002A

COMPLETION & TEST DATA BY PRODUCING FORMATION

FORMATION	(Chase) Guyman-Hugoton	Monitor Report to Fac Focus
SPACING & SPACING ORDER NUMBER		
CLASS: Oil, Gas, Dry, Inj, Disp, Comm Disp, Svc	Gas	
PERFORATED INTERVALS	2675'-2802' open hole	
ACID/VOLUME	1000 gal. 15% HCl	
FRACTURE TREATMENT (Fluids/Prop Amounts)	50,000 lbs of 16/30 sand w/ 444 lbs wtr, Spec. Gravity 2.65 - 75 quality foam	

Min Gas Allowable (165-10-17-7)

Gas Purchaser/Measurer  
First Sales Date

INITIAL TEST DATA

INITIAL TEST DATE	11/12/2018
OIL-BBL/DAY	0
OIL-GRAVITY ( API)	-
GAS-MCF/DAY	190
GAS-OIL RATIO CU FT/BBL	-
WATER-BBL/DAY	0
PUMPING OR FLOWING	Flowing
INITIAL SHUT-IN PRESSURE	977
CHOKE SIZE	-
FLOW TUBING PRESSURE	-

AS SUBMITTED

A record of the formations drilled through, and pertinent remarks are presented on the reverse. I declare that I have knowledge of the contents of this report and am authorized by my organization to make this report, which was prepared by me or under my supervision and direction, with the data and facts stated herein to be true, correct, and complete to the best of my knowledge and belief.

Emily J. Van Der Gryp  
SIGNATURE  
4901 LBJ Freeway, Ste 300  
ADDRESS

Emily J. Van Der Gryp  
NAME (PRINT OR TYPE)  
Dallas TX 75244  
CITY STATE ZIP

12/10/2018 (972) 325-1146  
DATE PHONE NUMBER  
evandergryp@scoutep.com  
EMAIL ADDRESS

PLEASE TYPE OR USE BLACK INK ONLY  
FORMATION RECORD

Give formation names and tops, if available, or descriptions and thickness of formations drilled through. Show intervals cored or drillstem tested.

LEASE NAME Moore, A. C.

WELL NO. 1

NAMES OF FORMATIONS	TOP
Herrington	2653
Krider	2753
Winfield	2760
Towanda	2810
TD:	2802

FOR COMMISSION USE ONLY

ITD on file ☐ YES ☐ NO

APPROVED \_\_\_\_\_ DISAPPROVED \_\_\_\_\_

2) Reject Codes

\_\_\_\_\_

\_\_\_\_\_

\_\_\_\_\_

\_\_\_\_\_

Were open hole logs run? yes ☒ no ☐

Date Last log was run Unknown

Was CO<sub>2</sub> encountered? yes ☒ no at what depths? \_\_\_\_\_

Was H<sub>2</sub>S encountered? yes ☒ no at what depths? \_\_\_\_\_

Were unusual drilling circumstances encountered? yes ☒ no ☐

If yes, briefly explain below \_\_\_\_\_

Other remarks: OCC - This well is an open hole completion from bottom of the 7" casing at 2702' to total depth 2802'. The 5 1/2" Liner is not cemented slotted liner.

640 Acres

If more than three drainholes are proposed, attach a separate sheet indicating the necessary information.

Direction must be stated in degrees azimuth. Please note, the horizontal drainhole and its end point must be located within the boundaries of the lease or spacing unit.

Directional surveys are required for all drainholes and directional wells.

640 Acres

BOTTOM HOLE LOCATION FOR DIRECTIONAL HOLE

SEC	TWP	RGE	COUNTY
Spot Location			
1/4	1/4	1/4	1/4
Measured Total Depth		True Vertical Depth	BHL From Lease, Unit, or Property Line:

BOTTOM HOLE LOCATION FOR HORIZONTAL HOLE: (LATERALS)

LATERAL #1

SEC	TWP	RGE	COUNTY
Spot Location			
1/4	1/4	1/4	1/4
Depth of Deviation		Radius of Turn	Direction
Measured Total Depth		True Vertical Depth	BHL From Lease, Unit, or Property Line:

LATERAL #2

SEC	TWP	RGE	COUNTY
Spot Location			
1/4	1/4	1/4	1/4
Depth of Deviation		Radius of Turn	Direction
Measured Total Depth		True Vertical Depth	BHL From Lease, Unit, or Property Line:

LATERAL #3

SEC	TWP	RGE	COUNTY
Spot Location			
1/4	1/4	1/4	1/4
Depth of Deviation		Radius of Turn	Direction
Measured Total Depth		True Vertical Depth	BHL From Lease, Unit, or Property Line:

Footage Calculated GPS

11/12/18

01

RECEIVED

Form 1002A  
Rev. 2009

DEC 11 2018

OKLAHOMA CORPORATION COMMISSION

1016EZ

API NO. 35-139-01160  
OTC PROD. UNIT NO. 139-020086  
A: 020086 I

☒ ORIGINAL  
☒ AMENDED (Reason) New Fracture Stimulation

TYPE OF DRILLING OPERATION  
☒ STRAIGHT HOLE ☐ DIRECTIONAL HOLE ☐ HORIZONTAL HOLE  
If directional or horizontal, see reverse for bottom hole location.

COUNTY Texas SEC 28 TWP 4N RGE 15ECM  
LEASE NAME Moore, A. C.  
SE 1/4 SE 1/4 NW 1/4 1/4  
ELEVATION 3116' Ground  
Derrick FL 3116' Ground  
Latitude (if known) 36.784111  
Longitude (if known) -101.447944  
OPERATOR NAME Scout Energy Management LLC  
ADDRESS 4901 LBJ Freeway, Ste 300  
CITY Dallas STATE TX ZIP 75244

SPUD DATE 04/25/1944  
DRLG FINISHED DATE 05/13/1944  
DATE OF WELL COMPLETION 05/27/1944  
1st PROD DATE  
RECOMP DATE 11/12/2018  
WELL NO. 1  
FWL OF 1/4 SEC 2520  
Center

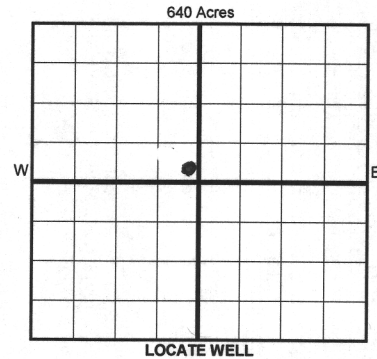

COMPLETION TYPE  
☒ SINGLE ZONE  
☐ MULTIPLE ZONE  
Application Date  
COMINGLED  
Application Date  
LOCATION EXCEPTION  
ORDER NO.  
INCREASED DENSITY  
ORDER NO.

CASING & CEMENT (Form 1002C must be attached)

TYPE	SIZE	WEIGHT	GRADE	FEET	PSI	SAX	TOP OF CMT
CONDUCTOR							
SURFACE	10.75	32.75	LW	530'		300	Surface
INTERMEDIATE							
PRODUCTION	7	24	SS	2702'		1000	600'
LINER (Slotted)	5.5	14		2675'-2802'		NA	NA

PACKER @ 2640' BRAND & TYPE  
PACKER @ BRAND & TYPE  
PLUG @ TYPE  
PLUG @ TYPE  
PLUG @ TYPE  
PLUG @ TYPE

TOTAL DEPTH 2802'

Rec'd original 1002A

COMPLETION & TEST DATA BY PRODUCING FORMATION

FORMATION	(Chase) Guyman Hugoton	Monitor Report to Foc Focus
SPACING & SPACING ORDER NUMBER		
CLASS: Oil, Gas, Dry, Inj, Disp, Comm Disp, Svc	Gas	
PERFORATED INTERVALS	2675'-2802' open hole	
ACID/VOLUME	1000 gal. 15% HCl	
FRACTURE TREATMENT (Fluids/Prop Amounts)	50,000 lbs of 16/30 sand w/ 444 lbs wtr, Spec. Gravity 2.65 - 75 quality foam	

Min Gas Allowable (165:10-17-7)  
OR  
Oil Allowable (165:10-13-3)  
Gas Purchaser/Measurer  
First Sales Date

INITIAL TEST DATA

INITIAL TEST DATE	11/12/2018
OIL-BBL/DAY	0
OIL-GRAVITY ( API)	-
GAS-MCF/DAY	190
GAS-OIL RATIO CU FT/BBL	-
WATER-BBL/DAY	0
PUMPING OR FLOWING	Flowing
INITIAL SHUT-IN PRESSURE	977
CHOKE SIZE	
FLOW TUBING PRESSURE	-

AS SUBMITTED

A record of the formations drilled through, and pertinent remarks are presented on the reverse. I declare that I have knowledge of the contents of this report and am authorized by my organization to make this report, which was prepared by me or under my supervision and direction, with the data and facts stated herein to be true, correct, and complete to the best of my knowledge and belief.  
Signature: Emily J. Van Der Gryp  
NAME (PRINT OR TYPE) Emily J. Van Der Gryp  
DATE 12/10/2018 (972) 325-1146  
PHONE NUMBER  
ADDRESS 4901 LBJ Freeway, Ste 300  
CITY Dallas STATE TX ZIP 75244  
EMAIL ADDRESS evandergryp@scoutep.com

EZ

DR

SCANNED

16132