

Oklahoma Corporation Commission  
Oil & Gas Conservation Division  
Post Office Box 52000  
Oklahoma City, Oklahoma 73152-2000  
Rule 165: 10-3-25

Form 1002A

API No.: 35139008070001

**Completion Report**

Spud Date: August 26, 1946

OTC Prod. Unit No.:

Drilling Finished Date: September 13, 1946

**Amended**

1st Prod Date:

Amend Reason: NEW FRACTURE STIMULATION

Completion Date: September 13, 1946

Recomplete Date: November 05, 2018

**Drill Type: STRAIGHT HOLE**

Well Name: KISNER 1

Purchaser/Measurer:

Location: TEXAS 27 2N 16E CM  
NE NE NE SW  
2400 FSL 2360 FWL of 1/4 SEC  
Latitude: 36.08662 Longitude: -101.323505  
Derrick Elevation: 2868 Ground Elevation: 2865

First Sales Date:

Operator: SCOUT ENERGY MANAGEMENT LLC 23138

4901 LBJ FWY STE 300  
DALLAS, TX 75244-6107

Completion Type	
X	Single Zone
	Multiple Zone
	Commingled

Location Exception
Order No
There are no Location Exception records to display.

Increased Density
Order No
There are no Increased Density records to display.

Casing and Cement							
Type	Size	Weight	Grade	Feet	PSI	SAX	Top of CMT
SURFACE	8.625	17.8	SW SJ	556		300	SURFACE
PRODUCTION	5.5	14	H-40	2633		850	600

Liner								
Type	Size	Weight	Grade	Length	PSI	SAX	Top Depth	Bottom Depth
There are no Liner records to display.								

**Total Depth: 2635**

Packer	
Depth	Brand & Type
2455	PACKER

Plug	
Depth	Plug Type
2609	PBTD

Initial Test Data
-------------------

Test Date	Formation	Oil BBL/Day	Oil-Gravity (API)	Gas MCF/Day	Gas-Oil Ratio Cu FT/BBL	Water BBL/Day	Pumpin or Flowing	Initial Shut-In Pressure	Choke Size	Flow Tubing Pressure
Nov 06, 2018	GUYMON-HUGOTON			73			FLOWING	60		

<b>Completion and Test Data by Producing Formation</b>	
Formation Name: GUYMON-HUGOTON	Code: 451GYHG
Class: GAS	
<b>Spacing Orders</b>	
<b>Order No</b>	<b>Unit Size</b>
There are no Spacing Order records to display.	
<b>Perforated Intervals</b>	
<b>From</b>	<b>To</b>
2480	2602
<b>Acid Volumes</b>	
1,000 GALLONS 15% HCL	
<b>Fracture Treatments</b>	
51,000 POUNDS 16/30 SAND WITH 444 POUNDS WATER, SPEC. GRAVITY 2.65 - 75 QUALITY FOAM	

Formation	Top
KRIDER	2531
WINFIELD	2607
TOWANDA	2665

Were open hole logs run? No  
Date last log run: September 01, 1949

Were unusual drilling circumstances encountered? No  
Explanation:

<b>Other Remarks</b>
There are no Other Remarks.

<b>FOR COMMISSION USE ONLY</b>	
<div>Status: Accepted</div>	1141461

Footage Calculated 6PS

NE

API NO. 35-139-00807  
OTC PROD.  
UNIT NO.

(PLEASE TYPE OR USE BLACK INK ONLY)

OKLAHOMA CORPORATION COMMISSION  
Oil & Gas Conservation Division  
Post Office Box 52000  
Oklahoma City, Oklahoma 73152-2000  
Rule 165:10-3-25

RECEIVED

DEC 10 2018

OKLAHOMA CORPORATION COMMISSION

Form 1002A

Rev. 2009

☒ ORIGINAL  
☒ AMENDED (Reason) **New Fracture Stimulation**

TYPE OF DRILLING OPERATION  
☒ STRAIGHT HOLE ☐ DIRECTIONAL HOLE ☐ HORIZONTAL HOLE  
☐ SERVICE WELL

If directional or horizontal, see reverse for bottom hole location.

COUNTY **Texas** SEC **27** TWP **2N** RGE **16ECM**  
LEASE NAME **Kinser** **Kisner** **FSL 2400** WELL NO. **1**  
NE 1/4 NE 1/4 SW 1/4 1/4 OF 1/4 SEC **150'** FWL OF 1/4 SEC **Center** 1st PROD DATE **11/5/2018**  
ELEVATION **2868'** Ground **2865'** Latitude (if known) **36.608662** Longitude (if known) **-101.323509**  
OPERATOR NAME **Scout Energy Management LLC** OTC/OCC OPERATOR NO. **23138**  
ADDRESS **4901 LBJ Freeway, Ste 300**  
CITY **Dallas** STATE **TX** ZIP **75244**

SPUD DATE **08/26/1946**  
DRLG FINISHED DATE **09/13/1946**  
DATE OF WELL COMPLETION **09/13/1946**  
RECOMP DATE **11/5/2018**

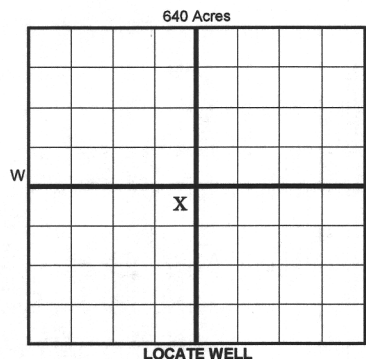

COMPLETION TYPE

☒ SINGLE ZONE  
☐ MULTIPLE ZONE  
Application Date  
COMINGLED  
Application Date  
LOCATION EXCEPTION  
ORDER NO.  
INCREASED DENSITY  
ORDER NO.

CASING & CEMENT (Form 1002C must be attached)

TYPE	SIZE	WEIGHT	GRADE	FEET	PSI	SAX	TOP OF CMT
CONDUCTOR							
SURFACE	8.625	17.8	SW SJ	556'		300	Surface
INTERMEDIATE							
PRODUCTION	5.5	14	H40	2633'		850	Approx 600'
LINER							

PACKER @ **2455'** BRAND & TYPE **451GYHG** PLUG @ **2609'** TYPE **PBTD** PLUG @ **2609'** TYPE **PBTD**  
PACKER @ **2455'** BRAND & TYPE **451GYHG** PLUG @ **2609'** TYPE **PBTD** PLUG @ **2609'** TYPE **PBTD**

TOTAL DEPTH **2635'**

COMPLETION & TEST DATA BY PRODUCING FORMATION

FORMATION	<b>Guymon</b> (Chase)								
SPACING & SPACING ORDER NUMBER	<b>Huyton</b>								
CLASS: Oil, Gas, Dry, Inj, Disp, Comm Disp, Svc	<b>Gas</b>								
PERFORATED INTERVALS	<b>2480'-2515'</b>								
	<b>2547'-2602'</b>								
ACID/VOLUME	<b>1000 gal. 15% HCl</b>								
FRACTURE TREATMENT (Fluids/Prop Amounts)	<b>51,000 lbs of 16/30 sand w/ 444 lbs wtr, Spec. Gravity 2.65 - 75 quality foam</b>								

Reported to Frac Focus

Min Gas Allowable (165:10-17-7) ☐ OR Oil Allowable (165:10-13-3) ☐  
Gas Purchaser/Measurer **Evander Gryp** First Sales Date **12/06/2018**

INITIAL TEST DATA

INITIAL TEST DATE	<b>11/06/2018</b>						
OIL-BBL/DAY	<b>0</b>						
OIL-GRAVITY (API)	<b>-</b>						
GAS-MCF/DAY	<b>73</b>						
GAS-OIL RATIO CU FT/BBL	<b>-</b>						
WATER-BBL/DAY	<b>0</b>						
PUMPING OR FLOWING	<b>Flowing</b>						
INITIAL SHUT-IN PRESSURE	<b>60</b>						
CHOKE SIZE	<b>-</b>						
FLOW TUBING PRESSURE	<b>-</b>						

AS SUBMITTED

A record of the formations drilled through, and pertinent remarks are presented on the reverse. I declare that I have knowledge of the contents of this report and am authorized by my organization to make this report, which was prepared by me or under my supervision and direction, with the data and facts stated herein to be true, correct, and complete to the best of my knowledge and belief.  
Signature **Emily J. Van Der Gryp** NAME (PRINT OR TYPE) **Emily J. Van Der Gryp** DATE **12/06/2018** PHONE NUMBER **(972) 325-1146**  
ADDRESS **4901 LBJ Freeway, Ste 300** CITY **Dallas** STATE **TX** ZIP **75244** EMAIL ADDRESS **evandergryp@scoutep.com**

## FORMATION RECORD

LEASE NAME Kinser

WELL NO. 1

NAMES OF FORMATIONS	TOP
Krider	2531
Winfield	2607
Towanda	2665
TD:	2635

FOR COMMISSION USE ONLY	
ITD on file	<input type="checkbox"/> YES <input type="checkbox"/> NO
APPROVED _____	DISAPPROVED _____  2) Reject Codes _____ _____ _____ _____ _____

Were open hole logs run?                           yes   X   no

Date Last log was run                      09/01/1949

Was CO<sub>2</sub> encountered?                           yes   X   no    at what depths?                     

Was H<sub>2</sub>S encountered?                           yes   X   no    at what depths?                     

Were unusual drilling circumstances encountered?                                 yes   X   no

If yes, briefly explain below

Other remarks:

640 Acres

Direction must be stated in degrees azimuth.  
Please note, the horizontal drainhole and its end point must be located within the boundaries of the lease or spacing unit.

640 Acres

[illegible]

SEC	TWP	RGE	COUNTY			
Spot Location				Feet From 1/4 Sec Lines	FSL	FWL
1/4	1/4	1/4	1/4	BHL From Lease, Unit, or Property Line:		
Measured Total Depth		True Vertical Depth				

SEC	TWP	RGE	COUNTY		
Spot Location			Feet From 1/4 Sec Lines	FSL	FWL
1/4	1/4	1/4	1/4		
Depth of Deviation	Radius of Turn		Direction	Total Length	
Measured Total Depth		True Vertical Depth	BHL From Lease, Unit, or Property Line:		

SEC	TWP	RGE	COUNTY
Spot Location			
1/4	1/4	1/4	1/4
Feet From 1/4 Sec Lines		FSL	FWL
Depth of Deviation	Radius of Turn	Direction	Total Length
Measured Total Depth	True Vertical Depth	BHL From Lease, Unit, or Property Line:	

SEC	TWP	RGE	COUNTY
Spot Location			
1/4	1/4	1/4	1/4
Feet From 1/4 Sec Lines		FSL	FWL
Depth of Deviation	Radius of Turn	Direction	Total Length
Measured Total Depth		True Vertical Depth	BHL From Lease, Unit, or Property Line:

Footage Calculated 675

11/5/18

01

RECEIVED

Form 1002A  
Rev. 2009

DEC 10 2018

OKLAHOMA CORPORATION COMMISSION  
1016EZ

API NO. **139-00807**  
(PLEASE TYPE OR USE BLACK INK ONLY)  
OTC PROD UNIT NO. **139-014893**  
A: 014893 I

OKLAHOMA CORPORATION COMMISSION  
Oil & Gas Conservation Division  
Post Office Box 52000  
Oklahoma City, Oklahoma 73152-2000  
Rule 165:10-3-25

☒ ORIGINAL  
☒ AMENDED (Reason) **New Fracture Stimulation**

COMPLETION REPORT

TYPE OF DRILLING OPERATION  
☒ STRAIGHT HOLE ☐ DIRECTIONAL HOLE ☐ HORIZONTAL HOLE  
SERVICE WELL  
If directional or horizontal, see reverse for bottom hole location.

SPUD DATE **08/26/1946**  
DRLG FINISHED DATE **09/13/1946**  
DATE OF WELL COMPLETION **09/13/1946**  
1st PROD DATE  
RECOMP DATE **11/5/2018**  
ELEVATION Derrick FL **2868'** Ground **2865'**  
Latitude (if known) **36.608662** Longitude (if known) **-101.323505**  
OPERATOR NAME **Scout Energy Management LLC**  
ADDRESS **4901 LBJ Freeway, Ste 300**  
CITY **Dallas** STATE **TX** ZIP **75244**

640 Acres  
LOCATE WELL

COMPLETION TYPE  
☒ SINGLE ZONE  
☐ MULTIPLE ZONE  
Application Date  
COMINGLED  
Application Date  
LOCATION EXCEPTION  
ORDER NO.  
INCREASED DENSITY  
ORDER NO.

CASING & CEMENT (Form 1002C must be attached)							
TYPE	SIZE	WEIGHT	GRADE	FEET	PSI	SAX	TOP OF CMT
CONDUCTOR							
SURFACE	8.625	17.8	SW SJ	556'		300	Surface
INTERMEDIATE							
PRODUCTION	5.5	14	H40	2633'		850	Approx 600'
LINER							
						TOTAL DEPTH	2635'

PACKER @ **2455'** BRAND & TYPE **4516YHG** PLUG @ **2609'** TYPE **PBTD** PLUG @ **2609'** TYPE **PBTD**  
PACKER @ **2609'** BRAND & TYPE **4516YHG** PLUG @ **2609'** TYPE **PBTD** PLUG @ **2609'** TYPE **PBTD**

COMPLETION & TEST DATA BY PRODUCING FORMATION  
FORMATION **Guymon (Chase)**  
SPACING & SPACING ORDER NUMBER **Hugoton**  
CLASS: Oil, Gas, Dry, Inj, Disp, Comm Disp, Svc  
PERFORATED INTERVALS  
ACID/VOLUME  
FRACTURE TREATMENT (Fluids/Prop Amounts)

INITIAL TEST DATA  
Min Gas Allowable (165:10-17-7) OR Oil Allowable (165:10-13-3)  
Gas Purchaser/Measurer First Sales Date  
INITIAL TEST DATE **11/06/2018**  
OIL-BBL/DAY **0**  
OIL-GRAVITY (API) **-**  
GAS-MCF/DAY **73**  
GAS-OIL RATIO CU FT/BBL **-**  
WATER-BBL/DAY **0**  
PUMPING OR FLOWING **Flowing**  
INITIAL SHUT-IN PRESSURE **60**  
CHOKE SIZE **-**  
FLOW TUBING PRESSURE **-**

AS SUBMITTED

A record of the formations drilled through, and pertinent remarks are presented on the reverse. I declare that I have knowledge of the contents of this report and am authorized by my organization to make this report, which was prepared by me or under my supervision and direction, with the data and facts stated herein to be true, correct, and complete to the best of my knowledge and belief.  
Signature **Emily J. Van Der Gryp** NAME (PRINT OR TYPE) **Emily J. Van Der Gryp** DATE **12/06/2018** PHONE NUMBER **(972) 325-1146**  
ADDRESS **4901 LBJ Freeway, Ste 300** CITY **Dallas** STATE **TX** ZIP **75244** EMAIL ADDRESS **evandergryp@scoutep.com**

E2

16132  
SCANNED

JR