

Oklahoma Corporation Commission  
Oil & Gas Conservation Division  
Post Office Box 52000  
Oklahoma City, Oklahoma 73152-2000  
Rule 165: 10-3-25

Form 1002A

API No.: 35011214520002

**Completion Report**

Spud Date: December 23, 1979

OTC Prod. Unit No.:

Drilling Finished Date: February 08, 1980

**Amended**

1st Prod Date:

Amend Reason: CONVERT TO COMMERCIAL DISPOSAL WELL

Completion Date: March 08, 1980

Recomplete Date: March 20, 2019

**Drill Type: STRAIGHT HOLE**

**SERVICE WELL**

Well Name: JAMES 1-15

Purchaser/Measurer:

Location: BLAINE 15 14N 11W  
S2 S2 N2 SW  
1620 FSL 1320 FWL of 1/4 SEC  
Derrick Elevation: 0 Ground Elevation: 0

First Sales Date:

Operator: VISTA DISPOSAL SOLUTIONS LLC 24198

1803 ELTON LN  
AUSTIN, TX 78703-2915

Completion Type	Location Exception	Increased Density
Single Zone	Order No	Order No
Multiple Zone	There are no Location Exception records to display.	There are no Increased Density records to display.
Commingled		

Casing and Cement							
Type	Size	Weight	Grade	Feet	PSI	SAX	Top of CMT
SURFACE	8 5/8	24	K-55	1500		950	SURFACE
PRODUCTION	5 1/2	17	N-80	10293		770	5990

Liner								
Type	Size	Weight	Grade	Length	PSI	SAX	Top Depth	Bottom Depth
There are no Liner records to display.								

**Total Depth: 11000**

Packer		Plug	
Depth	Brand & Type	Depth	Plug Type
6442	ARROW	8290	CIBP

Initial Test Data
-------------------

Test Date	Formation	Oil BBL/Day	Oil-Gravity (API)	Gas MCF/Day	Gas-Oil Ratio Cu FT/BBL	Water BBL/Day	Pumpin or Flowing	Initial Shut-In Pressure	Choke Size	Flow Tubing Pressure
There are no Initial Data records to display.										
<b>Completion and Test Data by Producing Formation</b>										
Formation Name: SHAWNEE			Code: 406SHWN			Class: COMM DISP				
<b>Spacing Orders</b>				<b>Perforated Intervals</b>						
<b>Order No</b>		<b>Unit Size</b>		<b>From</b>			<b>To</b>			
There are no Spacing Order records to display.				6501			6519			
<b>Acid Volumes</b>				<b>Fracture Treatments</b>						
There are no Acid Volume records to display.				There are no Fracture Treatments records to display.						
Formation Name: DOUGLAS			Code: 406DGLS			Class: COMM DISP				
<b>Spacing Orders</b>				<b>Perforated Intervals</b>						
<b>Order No</b>		<b>Unit Size</b>		<b>From</b>			<b>To</b>			
There are no Spacing Order records to display.				6830			7580			
<b>Acid Volumes</b>				<b>Fracture Treatments</b>						
There are no Acid Volume records to display.				There are no Fracture Treatments records to display.						
Formation Name: TONKAWA			Code: 406TNKW			Class: COMM DISP				
<b>Spacing Orders</b>				<b>Perforated Intervals</b>						
<b>Order No</b>		<b>Unit Size</b>		<b>From</b>			<b>To</b>			
There are no Spacing Order records to display.				7590			7608			
<b>Acid Volumes</b>				<b>Fracture Treatments</b>						
There are no Acid Volume records to display.				There are no Fracture Treatments records to display.						

Formation	Top
SEE ORIGINAL 1002A	0

Were open hole logs run? No

Date last log run:

Were unusual drilling circumstances encountered? No

Explanation:

Other Remarks
EXISTING WELL CONVERTED TO COMMERCIAL DISPOSAL WELL. UIC PERMIT NUMBER 1903850077. OCC - ORIGINAL WELL SHOWED D-V TOOL IN 5 1/2" CASING AT 8,000'. SEE NEW 1002C SQUEEZE JOB AT 7,225', USED 320 SACKS CEMENT, LIFTED CEMENT TO 5,990'. ORIGINAL WELL HAD 2 7/8" CASING SET TO 10,950' WITH 125 SACKS CEMENT BELOW NEW PLUG AT 8,290'.

Status: Accepted

API NO. 011-21452  
OTC PROD.  
UNIT NO.

PLEASE TYPE OR USE BLACK INK ONLY  
NOTE:

Attach copy of original 1002A  
if recompletion or reentry.

☐ ORIGINAL  
☒ AMENDED (Reason)

*convert commercial*  
**CHANGED TO DISP WELL**

OKLAHOMA CORPORATION COMMISSION  
Oil & Gas Conservation Division  
Post Office Box 52000  
Oklahoma City, Oklahoma 73152-2000  
Rule 165:10-3-25

COMPLETION REPORT

RECEIVED

JUL 02 2019

OKLAHOMA CORPORATION  
COMMISSION

TYPE OF DRILLING OPERATION

☒ STRAIGHT HOLE ☐ DIRECTIONAL HOLE ☐ HORIZONTAL HOLE  
☒ SERVICE WELL

If directional or horizontal, see reverse for bottom hole location.

COUNTY	BLAINE	SEC	15	TWP	14N	RGE	11W
LEASE NAME	JAMES			WELL NO.	1-15		
S2 1/4 S2 1/4 N2 1/4 SW 1/4	FSL OF 1/4 SEC	1620	FWL OF 1/4 SEC	1320			
ELEVATION N Derrick	Ground	Latitude (if known)	Longitude (if known)				
OPERATOR NAME	VISTA DISPOSAL SOLUTIONS LLC			OTC/OCC OPERATOR NO.	24198		
ADDRESS	12444 NW 10TH ST. BLDG G STE. 202-512						
CITY	YUKON		STATE	OK	ZIP	73099	

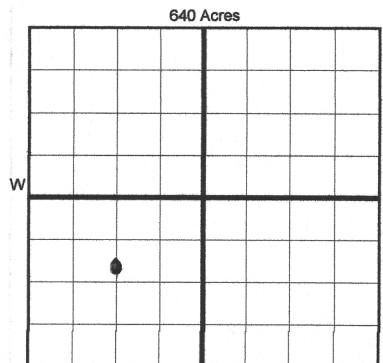

COMPLETION TYPE

<input type="checkbox"/> SINGLE ZONE
<input type="checkbox"/> MULTIPLE ZONE
Application Date
<input type="checkbox"/> COMMINGLED
Application Date
LOCATION
EXCEPTION ORDER
INCREASED DENSITY
ORDER NO.

CASING & CEMENT (Form 1002C must be attached)

TYPE	SIZE	WEIGHT	GRADE	FEET	PSI	SAX	TOP OF CMT
CONDUCTOR							
SURFACE	8 5/8"	24#	K-55	1500		950	SURFACE
INTERMEDIATE	6 1/2"	17#	N-80	8,290		920	5,990
PRODUCTION	5 1/2"	17#	N-80	10293		130	8000
LINER						770	5990

PACKER @ 6,442 BRAND & TYPE ARROW PLUG @ 8290 TYPE CIBP PLUG @ TYPE TOTAL DEPTH 10,293

COMPLETION & TEST DATA BY PRODUCING FORMATION *406 SHWN 406 DGLS 406 TNKN*

FORMATION	Shawnee	Douglas	Douglas	Douglas	Tonkawa
SPACING & SPACING ORDER NUMBER					
CLASS: Oil, Gas, Dry, Inj, Disp, Comm Disp, Svc					
PERFORATED INTERVALS	6501-6519	6830-6840	7096-7110	7504-7558	7590-7608
		6884-6918	7218-7221	7564-7580	
		6922-6934	7446-7470		
ACID/VOLUME					
FRACTURE TREATMENT (Fluids/Prop Amounts)					

Min Gas Allowable (165:10-17-7)

Gas Purchaser/Measurer

OR

First Sales Date

Oil Allowable (165:10-13-3)

INITIAL TEST DATA

INITIAL TEST DATE	NA DISP WELL
OIL-BBL/DAY	
OIL-GRAVITY ( API)	
GAS-MCF/DAY	
GAS-OIL RATIO CU FT/BBL	
WATER-BBL/DAY	
PUMPING OR FLOWING	
INITIAL SHUT-IN PRESSURE	
CHOKE SIZE	
FLOW TUBING PRESSURE	

AS SUBMITTED

A record of the formations drilled through, and pertinent remarks are presented on the reverse. I declare that I have knowledge of the contents of this report and am authorized by my organization to make this report, which was prepared by me or under my supervision and direction, with the data and facts stated herein to be true, correct, and complete to the best of my knowledge and belief.

Saleem Nizami-Consultant agent for Vista

6/6/2019 405-513-6055

SIGNATURE

NAME (PRINT OR TYPE)

DATE

PHONE NUMBER

12444 NW 10th St. Bldg G ste 202-512

Yukon

OK

73099

APECPAEC@MSN.COM

ADDRESS

CITY

STATE

ZIP

EMAIL ADDRESS

### FORMATION RECORD

LEASE NAME JAMES WELL NO. 1-15

NAMES OF FORMATIONS	TOP
<p>see original 1002A</p> <p>Commercial Disposal</p>	

FOR COMMISSION USE ONLY	
ITD on file	<input type="checkbox"/> YES <input type="checkbox"/> NO
APPROVED	DISAPPROVED
2) Reject Codes	

Were open hole logs run?      \_\_\_ yes    \_\_\_ no

Date Last log was run      na recompletion

Was CO<sub>2</sub> encountered?      \_\_\_ yes    X no    at what depths? \_\_\_\_\_

Was H<sub>2</sub>S encountered?      \_\_\_ yes    X no    at what depths? \_\_\_\_\_

Were unusual drilling circumstances encountered?      \_\_\_ yes    X no

If yes, briefly explain below

Other remarks: EXISTING WELL CONVERTED TO CDW WELL. UIC PERMIT NUMBER 1903850077

OCC - Original well showed D-V tool in 5 1/2" casing at 8000'.  
See new 1002C squeeze job at 7225' used 320  
sacks cement lifted cement to 5990'. Original well had 2 7/8"  
casing set to 10950' with 125 sacks cement below new plug  
at 8290'.

640 Acres

Direction must be stated in degrees azimuth.  
Please note, the horizontal drainhole and its end  
point must be located within the boundaries of the  
lease or spacing unit.

640 Acres

SEC	TWP	RGE	COUNTY			
Spot Location				Feet From 1/4 Sec Lines	FSL	FWL
1/4	1/4	1/4	1/4			
Measured Total Depth		True Vertical Depth		BHL From Lease, Unit, or Property Line:		

LATERAL #1						
SEC	TWP	RGE	COUNTY			
Spot Location			Feet From 1/4 Sec Lines		FSL	FWL
1/4	1/4	1/4	1/4			
Depth of Deviation		Radius of Turn	Direction		Total Length	
Measured Total Depth		True Vertical Depth	BHL From Lease, Unit, or Property Line:			

SEC	TWP	RGE	COUNTY			
Spot Location				Feet From 1/4 Sec Lines	FSL	FWL
1/4	1/4	1/4	1/4			
Depth of Deviation		Radius of Turn	Direction	Total Length		
Measured Total Depth		True Vertical Depth	BHL From Lease, Unit, or Property Line:			

LATERAL #3						
SEC	TWP	RGE	COUNTY			
Spot Location				Feet From 1/4 Sec Lines	FSL	FWL
1/4	1/4	1/4	1/4			
Depth of Deviation		Radius of Turn	Direction	Total Length		
Measured Total Depth		True Vertical Depth	BHL From Lease, Unit, or Property Line:			