

Oklahoma Corporation Commission
Oil & Gas Conservation Division
Post Office Box 52000
Oklahoma City, Oklahoma 73152-2000
Rule 165: 10-3-25

Form 1002A

API No.: 35153236460000

Completion Report

Spud Date: November 06, 2020

OTC Prod. Unit No.:

Drilling Finished Date: November 20, 2020

1st Prod Date: February 25, 2021

Completion Date: December 15, 2020

Drill Type: STRAIGHT HOLE

Well Name: GUTHRIE 1-2

Purchaser/Measurer:

Location: WOODWARD 2 22N 20W
N2 S2 SW SE
495 FSL 1980 FEL of 1/4 SEC
Derrick Elevation: 1971 Ground Elevation: 1953

First Sales Date:

Operator: WOODWARD IODINE CORPORATION 12837
PO BOX 1245
205865 ECR 32
WOODWARD, OK 73802-1245

Completion Type	
X	Single Zone
	Multiple Zone
	Commingled

Location Exception	
Order No	
714765	

Increased Density	
Order No	
There are no Increased Density records to display.	

Casing and Cement							
Type	Size	Weight	Grade	Feet	PSI	SAX	Top of CMT
CONDUCTOR	20			125		200	SURFACE
SURFACE	13 3/8	54.5	J-55	360	500	500	SURFACE
INTERMEDIATE	9 5/8	36	J-55	1730	1000	700	SURFACE
PRODUCTION	7	26	HCI-80	8437	5000	880	8010

Liner								
Type	Size	Weight	Grade	Length	PSI	SAX	Top Depth	Bottom Depth
There are no Liner records to display.								

Total Depth: 8441

Packer	
Depth	Brand & Type
There are no Packer records to display.	

Plug	
Depth	Plug Type
There are no Plug records to display.	

Initial Test Data

Test Date	Formation	Oil BBL/Day	Oil-Gravity (API)	Gas MCF/Day	Gas-Oil Ratio Cu FT/BBL	Water BBL/Day	Pumpin or Flowing	Initial Shut-In Pressure	Choke Size	Flow Tubing Pressure
Feb 25, 2021	MORROW SAND			100		3000	PUMPING		OPEN	300

Completion and Test Data by Producing Formation

Formation Name: MORROW SANDCode: 402MWSDClass: GAS

Spacing Orders

Order No	Unit Size
42740	640

Acid Volumes

There are no Acid Volume records to display.

Perforated Intervals

From	To
8220	8286

Fracture Treatments

3,657 BARRELS SLICKWATER, 181,000 POUNDS 20/40 WHITE SAND, 50,800 POUNDS 20/40 RC SAND

Formation	Top
ATOKA	7670
MORROW SHALE	7810
MORROW SAND	8042
CHESTER	8280

Were open hole logs run? Yes
Date last log run: November 16, 2020

Were unusual drilling circumstances encountered? No
Explanation:

Other Remarks

WELL WAS DRILLED FOR MORROW WATER FOR EXTRACTION OF IODINE @ WOODWARD IODINE PLANT. WELL IS PRODUCING WITH ESP AS ARTIFICIAL LIFT METHOD. VERTICAL WELL. OCC - OPERATOR SET DV TOOL AT 5,498, SEE 1002C.

FOR COMMISSION USE ONLY

Status: Accepted

1146184

API
No. 35-153-28228
OTC PROD.
UNIT NO.

**P.O. Box 52000
Oklahoma City, OK 73152-2000
405-522-0577
OCCCentralProcessing@OCC.**



OKLAHOMA
Corporation
Commission

Rev. 2020

<input checked="" type="checkbox"/> ORIGINAL <input type="checkbox"/> AMENDED (Reason) _____		Rule 185:10-3-25 COMPLETION REPORT	
TYPE OF DRILLING OPERATION <input checked="" type="checkbox"/> STRAIGHT HOLE <input type="checkbox"/> DIRECTIONAL HOLE <input type="checkbox"/> HORIZONTAL HOLE <input type="checkbox"/> SERVICE WELL If directional or horizontal, see reverse for bottom hole location.		SPUD DATE 11.6.20 DRIL FINISHED DATE 11.20.20 DATE OF WELL COMPLETION 12.15.20	
COUNTY Woodward	SEC 2	TWP 22N	RGE 20W
LEASE NAME Guthrie		WELL NO. 1-2	1st PROD DATE
N 2 1/4 S 2 1/4 SW 1/4 SE 1/4 FSL 495		FEL 1980	RECOMP DATE
ELEVATION Derrick Ft 1971	Ground 1953	Latitude 36° 24' 26.80" N	Longitude 99° 18' 23.62" W
OPERATOR NAME Woodward Iodine Corp		OTC / OCC OPERATOR NO. 12837 0	
ADDRESS P.O. Box 1245			
CITY Woodward	STATE OK	ZIP 73802-1245	

Rule 165:10-3-25

COMPLETION REPORT

640 ACTBS

LOCATE WELL

COMPLETION TYPE	
<input checked="" type="radio"/>	SINGLE ZONE
<input type="radio"/>	MULTIPLE ZONE Application Date
<input type="radio"/>	COMMINGLED Application Date
LOCATION EXCEPTION ORDER NO.	714765
MULTIUNIT ORDER NO.	
INCREASED DENSITY ORDER NO.	

CASING & CEMENT (Attach Form 1002C)

TYPE	SIZE	WEIGHT	GRADE	FEET	PSI	SAX	TOP OF CMT
CONDUCTOR	20			125		200	surface
SURFACE	13 ³ / ₈	54.5	J 55	360	500	500	surface
INTERMEDIATE	9 ⁵ / ₈	26	J 55	1730	1000	700	surface
PRODUCTION	7	26	H4C-80	8437	5000	880	5016
LINER							

PACKER @ _____ BRAND & TYPE _____ PLUG @ _____ TYPE _____ PLUG @ _____ TYPE _____
 PACKER @ _____ BRAND & TYPE _____ PLUG @ _____ TYPE _____ PLUG @ _____ TYPE _____

TOTAL DEPTH 8441

COMPLETION & TEST DATA BY PRODUCING FORMATION						
FORMATION	Morrow Sand					Monitor Re
SPACING & SPACING	42746 (640)					to Frac P
ORDER NUMBER						
CLASS: Oil, Gas, Dry, Inj,	Water Gas per initial test					
Disp, Comm Disp, Svc						
	8820-8286					
PERFORATED						
INTERVALS						
ACID/VOLUME						
FRACTURE TREATMENT (Fluids/Proc Amounts)	2657 881 Slick H2O 181 KIBS 20/40 white sand 50.8 KIBS 20/40 RC sand					

Monitor Report to Frac Focus

Min Gas Allowable (165:10-17-7)

OR

Oil Allowable (165:10-13-3)

Purchaser/Measurer**First Sales Date**

INITIAL TEST DATA		Oil Allowable	(165:10-13-3)
INITIAL TEST DATE	2-25-2021		
OIL-BBL/DAY	0		
OIL-GRAVITY (API)	0		
GAS-MCF/DAY	100		
GAS-OIL RATIO CU FT/BBL	0		
WATER-BBL/DAY	3000		
PUMPING OR FLOWING	PUMPING		
INITIAL SHUT-IN PRESSURE	0 PSIG		
CHOKE SIZE	OPEN		
FLOW TUBING PRESSURE	300 PSIG		

RECEIVED

MAR 15 2021

Oklahoma Corporation
Commission

RECEIVED

~~MAR 15 2023~~

Oklahoma Corporation	
Commission	

A record of the formations drilled through, and pertinent remarks are presented on the reverse. I declare that I have knowledge of the contents of this report and am authorized by my organization to submit this report, with the data and facts stated herein to be true, correct, and complete to the best of my knowledge and belief.

to make this report, which was prepared by me or under my direct supervision and control.

C. Neal Earle
SIGNATURE

Neal Earle (Agent)
NAME (PRINT OR TYPE)

1-20-21	(800) 323 9811
DATE	PHONE NUMBER

PO BOX 188

CANADIAN TEXAS 79014

EARLE@HADENG.COM

ADDRESS

CITY	STATE	ZIP
ALBANY	NY	12207

EMAIL ADDRESS

PLEASE TYPE OR USE BLACK INK ONLY

FORMATION RECORD

Give formation names and tops, if available, or descriptions and thickness of formations drilled through. Show intervals cored or drillstem tested.

LEASE NAME GUTHRIE

WELL NO. 1-2

NAMES OF FORMATIONS	TOP
ATOKA	7670
Morrow Shale	7810
Morrow Sand	8042
Chester	8280

FOR COMMISSION USE ONLY	
ITD on file <input type="checkbox"/> YES <input type="checkbox"/> NO	
APPROVED <input type="checkbox"/> DISAPPROVED <input type="checkbox"/>	2) Reject Codes

Were open hole logs run?	<input checked="" type="radio"/> yes <input type="radio"/> no
Date Last log was run	<u>11/16/2020</u>
Was CO ₂ encountered?	<input type="radio"/> yes <input checked="" type="radio"/> no at what depths? <u> </u>
Was H ₂ S encountered?	<input type="radio"/> yes <input checked="" type="radio"/> no at what depths? <u> </u>
Were unusual drilling circumstances encountered?	<input type="radio"/> yes <input checked="" type="radio"/> no
If yes, briefly explain below	

Other remarks: Well was drilled for Morrow Water for extraction
of Iodine @ Woodward Iodine Plant.
Well is producing with ESP as artificial lift method.
vertical well
OCC - Operator Set DV tool at 5498 see 1002C

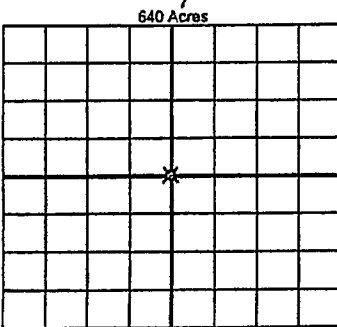

If more than three drainholes are proposed, attach a separate sheet indicating the necessary information.

Direction must be stated in degrees azimuth. Please note, the horizontal drainhole and its end point must be located within the boundaries of the lease or spacing unit.

Directional surveys are required for all drainholes and directional wells

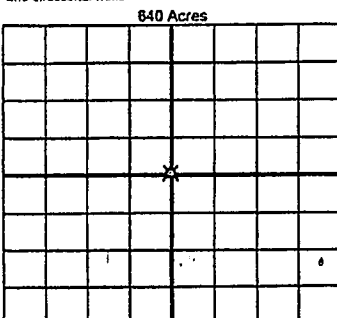

BOTTOM HOLE LOCATION FOR DIRECTIONAL HOLE

SEC	TWP	RGE	COUNTY
1/4	1/4	1/4	1/4
Measured Total Depth		True Vertical Depth	Feet From 1/4 Sec Lines BHL From Lease, Unit, or Property Line:

BOTTOM HOLE LOCATION FOR HORIZONTAL HOLE: (LATERALS)

LATERAL #1			
SEC	TWP	RGE	COUNTY
1/4	1/4	1/4	1/4
Depth of Deviation		Radius of Turn	Direction
Measured Total Depth		True Vertical Depth	Total Length
BHL From Lease, Unit, or Property Line:			

LATERAL #2			
SEC	TWP	RGE	COUNTY
1/4	1/4	1/4	1/4
Depth of Deviation		Radius of Turn	Direction
Measured Total Depth		True Vertical Depth	Total Length
BHL From Lease, Unit, or Property Line:			

LATERAL #3			
SEC	TWP	RGE	COUNTY
1/4	1/4	1/4	1/4
Depth of Deviation		Radius of Turn	Direction
Measured Total Depth		True Vertical Depth	Total Length
BHL From Lease, Unit, or Property Line:			

API
No. 35-153-28028
OTC PROD
UNIT NO. 153-22711

P.O. Box 52000
Oklahoma City, OK 73152-2000
405-522-0577
OCCCentralProcessing@OCC.



OKLAHOMA
Corporation
Commission

1002A
Addendum

Rev. 2020

<input checked="" type="checkbox"/>	ORIGINAL AMENDED (Reason)	A: 227167 I		Rule 165:10-3-25 COMPLETION REPORT	
	TYPE OF DRILLING OPERATION <input checked="" type="checkbox"/> STRAIGHT HOLE <input type="checkbox"/> DIRECTIONAL HOLE <input type="checkbox"/> HORIZONTAL HOLE <input type="checkbox"/> SERVICE WELL		SPUD DATE 11.6.20 DRLG FINISHED DATE 11.20.20		
If directional or horizontal, see reverse for bottom hole location.				DATE OF WELL COMPLETION 12.15.20	
COUNTY	Woodward	SEC	2	TWP	22N RGE 20W
LEASE NAME	Guthrie	WELL NO.	1-2		1st PROD DATE 3/1/21
N2 1/4 S2 1/4 SW 1/4 SE 1/4		FSL	495		RECOMP DATE
ELEVATION	1971	Ground	1953	Latitude	36°24'26.80"N
Longitude				99°18'23.62"W	
OPERATOR NAME	Woodward Iodine Corp			OTC / OCC OPERATOR NO.	12837 0
ADDRESS P.O. Box 1245					
CITY	Woodward			STATE	OK
				ZIP	73802-1245

COMPLETION TYPE	
<input checked="" type="radio"/>	SINGLE ZONE
<input type="radio"/>	MULTIPLE ZONE Application Date
<input type="radio"/>	COMMINGLED Application Date
LOCATION EXCEPTION ORDER NO.	714765
MULTIUNIT ORDER NO.	
INCREASED DENSITY ORDER NO.	

CASING & CEMENT (Attach Form 1002C)							
TYPE	SIZE	WEIGHT	GRADE	FEET	PSI	SAX	TOP OF CMT
CONDUCTOR	20			125		200	surface
SURFACE	13 ³ / ₈	54.5	J 55	360	500	500	surface
INTERMEDIATE	9 ⁵ / ₈	26	J 55	1730	1000	700	surface
PRODUCTION	7	26	H 40-80	8437	5000	880	5010
LINER							

PACKER @	BRAND & TYPE	PLUG @	TYPE	PLUG @	TYPE	TOTAL
PACKER @	BRAND & TYPE	PLUG @	TYPE	PLUG @	TYPE	DEPTH

COMPLETION & TEST DATA BY PRODUCING FORMATION					
FORMATION	Morrow Sand				Monitor Re
SPACING & SPACING ORDER NUMBER	42740 (640)				to Frac 6
CLASS: Oil, Gas, Dry, Inj, Disp, Comm Disp, Svc	Water Gas per initial test				
PERFORATED INTERVALS	8220-8286				
ACID/VOLUME					
FRACTURE TREATMENT (Fluids/Proc Amounts)	2657 BBLS H ₂ O 121 KILBS 20/40 white Sand 50.8 KILBS 20/40 RC Sand				

INITIAL TEST DATA	<input type="checkbox"/>	Min Gas Allowable (165:10-17-7)	Purchaser/Measurer
		OR	First Sales Date
		Oil Allowable (165:10-13-3)	

INITIAL TEST DATA		Oil Allowable	(165:10-13-3)				
INITIAL TEST DATE	2-25-2021						
OIL-BBL/DAY	0						
OIL-GRAVITY (API)	0						
GAS-MCF/DAY	100						
GAS-OIL RATIO CU FT/BBL	0						
WATER-BBL/DAY	3000						
PUMPING OR FLOWING	PUMPING						
INITIAL SHUT-IN PRESSURE	0 PSIG						
CHOKE SIZE	OPEN						
FLOW TUBING PRESSURE	300 PSIG						

A record of the formations drilled through, and pertinent remarks are presented on the reverse. I declare that I have knowledge of the contents of this report and am authorized by my organization to make this report, which was prepared by me or under my supervision and direction, with the data and facts stated herein to be true, correct, and complete to the best of my knowledge and belief.

C. Neal Earle
SIGNATURE

Neal Earle (Agent)
NAME (PRINT OR TYPE)

DATE 1-20-21 (806) 323 9811

PO BOX 188

CANADIAN TEXAS 79014
CITY STATE ZIP

EMAIL ADDRESS
EARLE@HADENG.COM