

Oklahoma Corporation Commission
Oil & Gas Conservation Division
Post Office Box 52000
Oklahoma City, Oklahoma 73152-2000
Rule 165: 10-3-25

Form 1002A

API No.: 35019229800001

Completion Report

Spud Date: April 27, 1984

OTC Prod. Unit No.: 019-06407

Drilling Finished Date: May 06, 1984

1st Prod Date: May 25, 1984

Amended

Completion Date: May 26, 1984

Amend Reason: RECOMPLETE - ADDED PERFORATIONS AND FRAC

Recomplete Date: September 29, 2021

Drill Type: STRAIGHT HOLE

Min Gas Allowable: Yes

Well Name: HEWITT UNIT (HEWITT UNIT 2394) 22-3904

Purchaser/Measurer:

Location: CARTER 22 4S 2W
NW NE NW SW
2495 FSL 795 FWL of 1/4 SEC
Latitude: 34.1940132 Longitude: -97.4019991
Derrick Elevation: 879 Ground Elevation: 863

First Sales Date:

Operator: XTO ENERGY INC 21003

22777 SPRINGWOODS VILLAGE PARKWAY
SPRING, TX 77389-1425

| Completion Type | | Location Exception | | Increased Density | |
|-----------------|---------------|---|--|--|--|
| X | Single Zone | Order No | | Order No | |
| | Multiple Zone | There are no Location Exception records to display. | | There are no Increased Density records to display. | |
| | Commingled | | | | |

| Casing and Cement | | | | | | | |
|-------------------|--------|--------|-------|------|------|-----|------------|
| Type | Size | Weight | Grade | Feet | PSI | SAX | Top of CMT |
| SURFACE | 10 3/4 | 40.5 | K-55 | 540 | 1000 | 600 | SURFACE |
| PRODUCTION | 7 | 20 | K-55 | 2524 | 1500 | 625 | 950 |

| Liner | | | | | | | | |
|--|------|--------|-------|--------|-----|-----|-----------|--------------|
| Type | Size | Weight | Grade | Length | PSI | SAX | Top Depth | Bottom Depth |
| There are no Liner records to display. | | | | | | | | |

Total Depth: 2527

| Packer | |
|---|--------------|
| Depth | Brand & Type |
| There are no Packer records to display. | |

| Plug | |
|-------|-----------------|
| Depth | Plug Type |
| 1477 | CEMENT |
| 1483 | CEMENT RETAINER |
| 1485 | CEMENT |
| 1630 | CIBP |

| Initial Test Data | | | | | | | | | | |
|-------------------|-----------|-------------|-------------------|-------------|-------------------------|---------------|-------------------|--------------------------|------------|----------------------|
| Test Date | Formation | Oil BBL/Day | Oil-Gravity (API) | Gas MCF/Day | Gas-Oil Ratio Cu FT/BBL | Water BBL/Day | Pumpin or Flowing | Initial Shut-In Pressure | Choke Size | Flow Tubing Pressure |
| Oct 12, 2021 | HEWITT | 100 | 35 | | | 44 | PUMPING | | | |

| Completion and Test Data by Producing Formation | | | |
|---|-----------|---|------------|
| Formation Name: HEWITT | | Code: 405HWTT | Class: OIL |
| Spacing Orders | | Perforated Intervals | |
| Order No | Unit Size | From | To |
| 67990 | UNIT | 1232 | 1410 |
| Acid Volumes | | Fracture Treatments | |
| There are no Acid Volume records to display. | | 2,170 BARRELS X-LINK GEL, 106,000 POUNDS SAND | |

| Formation | Top |
|-------------|------|
| BAYOU LOWER | 1290 |
| CHUBBEE | 1504 |

Were open hole logs run? Yes
Date last log run:

Were unusual drilling circumstances encountered? No
Explanation:

| Other Remarks |
|---|
| ADDED PERFORATIONS: 1,232' - 1,298', 1,339' - 1,410'. SHOT SQUEEZE HOLES @ 1,190'. SQUEEZED WITH 300 SACKS CLASS C WITH 2% CC, 4% GEL AND 2 PPS KOL |

| FOR COMMISSION USE ONLY | |
|-------------------------|---------|
| Status: Accepted | 1147269 |

RECEIVED
Form 1002A
Rev. 2020
DEC 03 2021

API NO. 35-019-22980
OTC PROD. UNIT NO. 019-06407

Oil and Gas Conservation Division
P.O. Box 52000
Oklahoma City, OK 73152-2000
405-522-0577
OCCentralProcessing@OCC.OK.GOV



ORIGINAL
☒ AMENDED (Reason) Recomplete - Added Perfs + Frac

Rule 185:10-3-25

COMPLETION REPORT

OKLAHOMA CORPORATION COMMISSION

TYPE OF DRILLING OPERATION
☒ STRAIGHT HOLE ☐ DIRECTIONAL HOLE ☐ HORIZONTAL HOLE
☐ SERVICE WELL

SPUD DATE 4/27/1984
DRLG FINISHED DATE 5/6/1984

If directional or horizontal, see reverse for bottom hole location.

COUNTY Carter SEC 22 TWP 4S RGE 2W

DATE OF WELL COMPLETION 5/26/1984

LEASE NAME Hewitt Unit

1st PROD DATE 5/25/1984

NE 1/4 NW 1/4 SW 1/4 FSL 2495 FWL 795

RECOMP DATE 9/29/21

ELEVATION Derrick FL 879 Ground 863 Latitude 34.1940132

Longitude -97.4019991

OPERATOR NAME XTO Energy Inc

OTC / OCC OPERATOR NO. 21003

ADDRESS 210 Park Ave, Suite 2350

CITY Oklahoma City STATE OK ZIP 73102

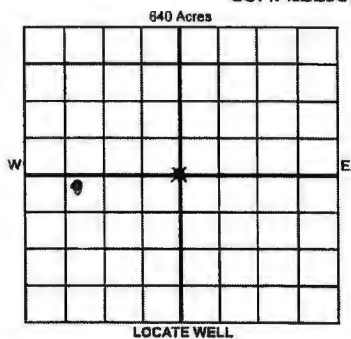

COMPLETION TYPE
☒ SINGLE ZONE
☐ MULTIPLE ZONE
☐ COMMINGLED
LOCATION EXCEPTION ORDER NO.
MULTIUNIT ORDER NO.
INCREASED DENSITY ORDER NO.

| CASING & CEMENT (Attach Form 1002C) | | | | | | | |
|-------------------------------------|---------|--------|-------|-------|------|-----|------------|
| TYPE | SIZE | WEIGHT | GRADE | FEET | PSI | SAX | TOP OF CMT |
| CONDUCTOR | | | | | | | |
| SURFACE | 10 3/4" | 40.5# | K-55 | 540' | 1000 | 800 | Surface |
| INTERMEDIATE | | | | | | | |
| PRODUCTION | 7" | 20# | K-55 | 2524' | 1500 | 625 | 950' |
| LINER | | | | | | | |

PACKER @ BRAND & TYPE PLUG @ 1430' TYPE CRIP PLUG @ 1485' TYPE Cement
PACKER @ BRAND & TYPE PLUG @ 1485' TYPE Cement PLUG @ 1477' TYPE Cement
TOTAL DEPTH 2527'

| COMPLETION & TEST DATA BY PRODUCING FORMATION | | | | | | | |
|---|--------------------|--|--|--|--|--|------------------------|
| FORMATION | Hewitt Sands | Hewitt Sands | | | | | |
| SPACING & SPACING ORDER NUMBER | 67990 (Unit) | 67990 (Unit) | | | | | |
| CLASS: Oil, Gas, Dry, Inf, Disp, Comm Disp, Svc | Oil Dry below plug | Oil | | | | | Reported to Frac Focus |
| PERFORATED INTERVALS | 1506'-2374' | 1232'-1410' | | | | | |
| ACID/VOLUME | | | | | | | |
| FRACTURE TREATMENT (Fluids/Prop Amounts) | | 2170 bbls X-Link Gel 106k# sand 106,000 lbs sand | | | | | |

| INITIAL TEST DATA | | | | | | | |
|--------------------------|---------|----------|--|--|--|--|--|
| INITIAL TEST DATE | 5/26/84 | 10/12/21 | | | | | |
| OIL-BBL/DAY | 100 | 100 | | | | | |
| OIL-GRAVITY (API) | 35.1 | 35 | | | | | |
| GAS-MCF/DAY | | | | | | | |
| GAS-OIL RATIO CU FT/BBL | 0 | 0 | | | | | |
| WATER-BBL/DAY | 353 | 44 | | | | | |
| PUMPING OR FLOWING | Pumping | Pumping | | | | | |
| INITIAL SHUT-IN PRESSURE | | | | | | | |
| CHOKE SIZE | | | | | | | |
| FLOW TUBING PRESSURE | | | | | | | |

A record of the formations drilled through, and pertinent remarks are presented on the reverse. I declare that I have knowledge of the contents of this report and am authorized by my organization to make this report, which was prepared by me or under my supervision and direction, with the data and facts stated herein to be true, correct, and complete to the best of my knowledge and belief.

SIGNATURE Liv Adams NAME (PRINT OR TYPE) Liv Adams DATE 12/2/21 PHONE NUMBER 405-594-0453
ADDRESS 210 Park Ave, Suite 2350 CITY Oklahoma City STATE OK ZIP 73102 EMAIL ADDRESS liv.adams@exxonmobil.com

PLEASE TYPE OR USE BLACK INK ONLY
FORMATION RECORD

Give formation names and tops, if available, or descriptions and thickness of formations drilled through. Show intervals cored or drillstem tested.

| NAMES OF FORMATIONS | TOP |
|---------------------|------|
| Lower Bayou | 1290 |
| Chubbee | 1504 |
| 1B | 1584 |
| 2C | 1790 |
| 3A | 2066 |
| 3B | 2098 |
| 3C | 2142 |
| 3D | 2288 |
| 3E | 2312 |

LEASE NAME _____ Health Unit _____ WELL NO. 22-3804

FOR COMMISSION USE ONLY

ITD on file ☐ YES ☐ NO

APPROVED _____ DISAPPROVED _____ 2) Reject Codes _____

Were open hole logs run? ☒ yes ☐ no

Date Last log was run _____

Was CO₂ encountered? ☐ yes ☒ no at what depths? _____

Was H₂S encountered? ☐ yes ☒ no at what depths? _____

Were unusual drilling circumstances encountered? ☐ yes ☒ no

If yes, briefly explain below _____

Other remarks: Added Perfs: 1232'-1298', 1339'-1410'.

Shot Sqz holes @ 1190'. Sqz'd w/ 300 sx Class C w/ 2% CC, 4% gel & 2pps kol

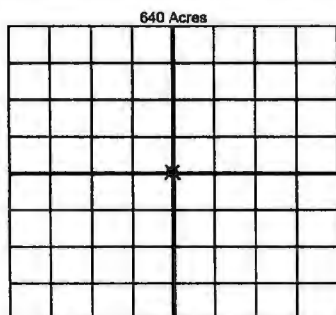

If more than three drainholes are proposed, attach a separate sheet indicating the necessary information.

Direction must be stated in degrees azimuth. Please note, the horizontal drainhole and its end point must be located within the boundaries of the lease or spacing unit.

Directional surveys are required for all drainholes and directional wells

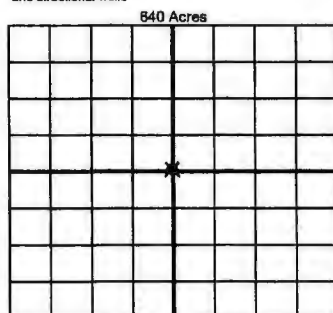

BOTTOM HOLE LOCATION FOR DIRECTIONAL HOLE

| SEC | TWP | RGE | COUNTY |
|----------------------|-----|---|--------|
| 1/4 | 1/4 | 1/4 | 1/4 |
| Measured Total Depth | | True Vertical Depth | |
| | | BHL From Lease, Unit, or Property Line: | |

BOTTOM HOLE LOCATION FOR HORIZONTAL HOLE: (LATERALS)

LATERAL #1

| SEC | TWP | RGE | COUNTY |
|----------------------|-----|---|--------|
| 1/4 | 1/4 | 1/4 | 1/4 |
| Depth of Deviation | | Radius of Turn | |
| Measured Total Depth | | True Vertical Depth | |
| | | BHL From Lease, Unit, or Property Line: | |

LATERAL #2

| SEC | TWP | RGE | COUNTY |
|----------------------|-----|---|--------|
| 1/4 | 1/4 | 1/4 | 1/4 |
| Depth of Deviation | | Radius of Turn | |
| Measured Total Depth | | True Vertical Depth | |
| | | BHL From Lease, Unit, or Property Line: | |

LATERAL #3

| SEC | TWP | RGE | COUNTY |
|----------------------|-----|---|--------|
| 1/4 | 1/4 | 1/4 | 1/4 |
| Depth of Deviation | | Radius of Turn | |
| Measured Total Depth | | True Vertical Depth | |
| | | BHL From Lease, Unit, or Property Line: | |