

Oklahoma Corporation Commission
Oil & Gas Conservation Division
Post Office Box 52000
Oklahoma City, Oklahoma 73152-2000
Rule 165: 10-3-25

Form 1002A

API No.: 35083241660003

Completion Report

Spud Date: September 19, 2013

OTC Prod. Unit No.:

Drilling Finished Date: October 04, 2013

Amended

1st Prod Date:

Amend Reason: CANCELLED UIC PERMIT AUGUST, 2021

Completion Date: November 27, 2013

Recomplete Date: August 01, 2021

Drill Type: STRAIGHT HOLE

Well Name: LENA 15-19N-3W 1SWD

Purchaser/Measurer:

Location: LOGAN 15 19N 3W
NW NW NW NW
225 FNL 171 FWL of 1/4 SEC
Latitude: 36.12998 Longitude: -97.51438
Derrick Elevation: 1111 Ground Elevation: 1088

First Sales Date:

Operator: CONTANGO MIDSTREAM COMPANY 24435

717 TEXAS AVE STE 2900
HOUSTON, TX 77002-2836

Completion Type		Location Exception		Increased Density	
	Single Zone	Order No		Order No	
	Multiple Zone	There are no Location Exception records to display.		There are no Increased Density records to display.	
	Commingled				

Casing and Cement							
Type	Size	Weight	Grade	Feet	PSI	SAX	Top of CMT
CONDUCTOR	20	133	J-55	65		8	SURFACE
SURFACE	13 3/8	54.5	J-55	507		420	SURFACE
PRODUCTION	9 5/8	40	HCK-55	6554		490	4480

Liner								
Type	Size	Weight	Grade	Length	PSI	SAX	Top Depth	Bottom Depth
There are no Liner records to display.								

Total Depth: 8137

Packer	
Depth	Brand & Type
There are no Packer records to display.	

Plug	
Depth	Plug Type
6200	CIBP
8115	CEMENT

Initial Test Data

Test Date	Formation	Oil BBL/Day	Oil-Gravity (API)	Gas MCF/Day	Gas-Oil Ratio Cu FT/BBL	Water BBL/Day	Pumpin or Flowing	Initial Shut- In Pressure	Choke Size	Flow Tubing Pressure
There are no Initial Data records to display.										

Completion and Test Data by Producing Formation										
Formation Name: NONE				Code: 999NONE			Class: DRY			

Formation	Top
ARBUCKLE	6554

Were open hole logs run? Yes
Date last log run: September 27, 2013

Were unusual drilling circumstances encountered? No
Explanation:

Other Remarks
AMENDED AUGUST, 2021: CANCELLED UIC PERMIT NUMBER 1402960052. WELL IS DRY. FROM PREVIOUS OPERATOR: IRREGULAR SECTION, OPEN HOLE 6,554' - 8,115'

FOR COMMISSION USE ONLY										
Status: Accepted										1147262

API NO. 35-083-24166
OTC PROD.
UNIT NO.

Oil and Gas Conservation Division
P.O. Box 52000
Oklahoma City, OK 73152-2000
405-521-2331
OCCentralProcessing@OCC.OK.GOV



OKLAHOMA
Corporation
Commission

Form 1002A
Rev. 2021

ORIGINAL
AMENDED (Reason) CANCELLED UIC PERMIT 08/2021

Rule 165:10-3-25

COMPLETION REPORT

TYPE OF DRILLING OPERATION
☒ STRAIGHT HOLE ☐ DIRECTIONAL HOLE ☐ HORIZONTAL HOLE
☐ SERVICE WELL

SPUD DATE 09/19/2013
DRLG FINISHED DATE 10/04/2013

If directional or horizontal, see reverse for bottom hole location.

COUNTY LOGAN SEC 15 TWP 19N RGE 3W

DATE OF WELL COMPLETION 11/27/2013

LEASE NAME LENA 15-19N-3W WELL NO. 1SWD

1st PROD DATE

NW 1/4 NW 1/4 NW 1/4 NW 1/4 ECL 225 FWL 171

RECOMP DATE 8/1/2021

ELEVATION Derrick FL 1111 Ground 1088 Latitude 36.12998

Longitude -97.51438

OPERATOR NAME CONTANGO MIDSTREAM COMPANY

OTC / OCC OPERATOR NO. 24435

ADDRESS 717 TEXAS AVE., SUITE 2900

CITY HOUSTON

STATE TX

ZIP 77002

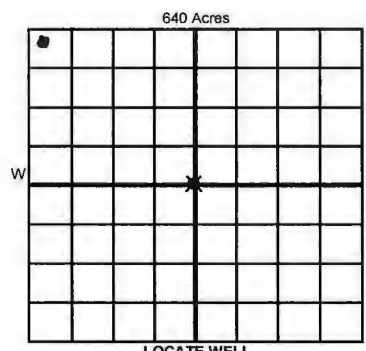

LOCATE WELL

COMPLETION TYPE

<input type="radio"/> SINGLE ZONE	
<input type="radio"/> MULTIPLE ZONE	
Application Date	
<input type="radio"/> COMMINGLED	
Application Date	
LOCATION EXCEPTION ORDER NO.	
MULTIUNIT ORDER NO.	
INCREASED DENSITY ORDER NO.	

CASING & CEMENT (Attach Form 1002C)

TYPE	SIZE	WEIGHT	GRADE	FEET	PSI	SAX	TOP OF CMT
CONDUCTOR	20	133	J-55	65		8	surface
SURFACE	13 3/8	54.5	J-55	507		420	surface
INTERMEDIATE	9 5/8	40	HCK-55	6554		490	4480
PRODUCTION							
LINER							

PACKER @ 6556 BRAND & TYPE RETRIEVABLE PLUG @ 8115 TYPE CEMENT PLUG @ 6200 TYPE CIBP TOTAL DEPTH 8137

COMPLETION & TEST DATA BY PRODUCING FORMATION

FORMATION	ARBUCKLEE	nothing open above plug
SPACING & SPACING ORDER NUMBER		
CLASS: Oil, Gas, Dry, Inj, Disp, Comm Disp, Svc	Disp Dry	
PERFORATED INTERVALS		
ACID/VOLUME		
FRACTURE TREATMENT (Fluids/Prop Amounts)		

RECEIVED

DEC 06 2021

OKLAHOMA CORPORATION COMMISSION

Min Gas Allowable (165:10-17-7)

OR

Oil Allowable (165:10-13-3)

Purchaser/Measurer

First Sales Date

INITIAL TEST DATA

INITIAL TEST DATE	
OIL-BBL/DAY	
OIL-GRAVITY (API)	
GAS-MCF/DAY	
GAS-OIL RATIO CU FT/BBL	
WATER-BBL/DAY	
PUMPING OR FLOWING	
INITIAL SHUT-IN PRESSURE	
CHOKE SIZE	
FLOW TUBING PRESSURE	

A record of the formations drilled through, and pertinent remarks are presented on the reverse. I declare that I have knowledge of the contents of this report and am authorized by my organization to make this report, which was prepared by me or under my supervision and direction, with the data and facts stated herein to be true, correct, and complete to the best of my knowledge and belief.

Adenner

SIGNATURE

717 TEXAS AVE., SUITE 2900

ADDRESS

ALISON DENNER

NAME (PRINT OR TYPE)

HOUSTON

CITY

TX 77002

STATE

ZIP

DATE

713-236-7456

PHONE NUMBER

adenner@contango.com

EMAIL ADDRESS

PLEASE TYPE OR USE BLACK INK ONLY

FORMATION RECORD

Give formation names and tops, if available, or descriptions and thickness of formations drilled through. Show intervals cored or drillstem tested.

LEASE NAME LENA 15-19N-3W WELL NO. 1SWD

NAMES OF FORMATIONS	TOP
ARBUCKLE	6554

FOR COMMISSION USE ONLY

ITD on file ☐ YES ☐ NO

APPROVED ☐ DISAPPROVED ☐ 2) Reject Codes

Were open hole logs run? ☒ yes ☐ no

Date Last log was run 09/27/2013

Was CO₂ encountered? ☐ yes ☒ no at what depths? _____

Was H₂S encountered? ☐ yes ☒ no at what depths? _____

Were unusual drilling circumstances encountered? ☐ yes ☒ no

If yes, briefly explain below

Other remarks: AMENDED 08/2021: CANCELLED UIC PERMIT #1402960052. WELL IS ~~IN~~ Dry

FROM PREVIOUS OPERATOR: IRREGULAR SECTION, UIC PERMIT #1402960052, MIT 11/27/2013.

OPEN HOLE 6554-8115'

640 Acres

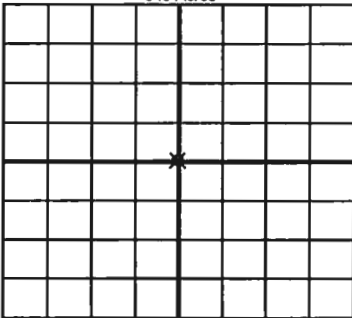

If more than three drainholes are proposed, attach a separate sheet indicating the necessary information.

Direction must be stated in degrees azimuth. Please note, the horizontal drainhole and its end point must be located within the boundaries of the lease or spacing unit.

Directional surveys are required for all drainholes and directional wells

640 Acres

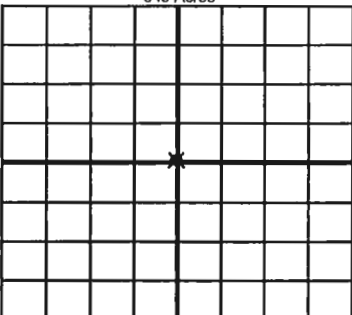

BOTTOM HOLE LOCATION FOR DIRECTIONAL HOLE

SEC	TWP	RGE	COUNTY
1/4	1/4	1/4	1/4
Measured Total Depth		True Vertical Depth	Feet From 1/4 Sec Lines
			BHL From Lease, Unit, or Property Line:

BOTTOM HOLE LOCATION FOR HORIZONTAL HOLE: (LATERALS)

LATERAL #1

SEC	TWP	RGE	COUNTY
1/4	1/4	1/4	1/4
Depth of Deviation		Radius of Turn	Direction
Measured Total Depth		True Vertical Depth	Total Length
			BHL From Lease, Unit, or Property Line:

LATERAL #2

SEC	TWP	RGE	COUNTY
1/4	1/4	1/4	1/4
Depth of Deviation		Radius of Turn	Direction
Measured Total Depth		True Vertical Depth	Total Length
			BHL From Lease, Unit, or Property Line:

LATERAL #3

SEC	TWP	RGE	COUNTY
1/4	1/4	1/4	1/4
Depth of Deviation		Radius of Turn	Direction
Measured Total Depth		True Vertical Depth	Total Length
			BHL From Lease, Unit, or Property Line: