

Oklahoma Corporation Commission
Oil & Gas Conservation Division
Post Office Box 52000
Oklahoma City, Oklahoma 73152-2000
Rule 165: 10-3-25

Form 1002A

API No.: 35125238090001

Completion Report

Spud Date: July 24, 2013

OTC Prod. Unit No.: 125-211407-0-0000

Drilling Finished Date: August 01, 2013

Amended

1st Prod Date: September 07, 2013

Amend Reason: ADDITIONAL PERFORATIONS

Completion Date: August 16, 2013

Recomplete Date: September 15, 2021

Drill Type: STRAIGHT HOLE

Well Name: MURL 1-29

Purchaser/Measurer:

Location: POTTAWATOMIE 29 7N 4E
C NW SW
1980 FSL 660 FWL of 1/4 SEC
Derrick Elevation: 1032 Ground Elevation: 1024

First Sales Date: 09/12/2013

Operator: BASIS RESOURCES GROUP LLC 22981

4334 NW EXPRESSWAY STE 201
OKLAHOMA CITY, OK 73116-1516

Completion Type		Location Exception		Increased Density	
X	Single Zone	Order No		Order No	
	Multiple Zone	There are no Location Exception records to display.		There are no Increased Density records to display.	
	Commingle				

Casing and Cement							
Type	Size	Weight	Grade	Feet	PSI	SAX	Top of CMT
SURFACE	8 5/8	24	K-55	390		280	SURFACE
PRODUCTION	5 1/2	17	J-55	4337		50	4037

Liner								
Type	Size	Weight	Grade	Length	PSI	SAX	Top Depth	Bottom Depth
There are no Liner records to display.								

Total Depth: 4370

Packer	
Depth	Brand & Type
There are no Packer records to display.	

Plug	
Depth	Plug Type
4225	CIBP

Initial Test Data										
Test Date	Formation	Oil BBL/Day	Oil-Gravity (API)	Gas MCF/Day	Gas-Oil Ratio Cu FT/BBL	Water BBL/Day	Pumpin or Flowing	Initial Shut-In Pressure	Choke Size	Flow Tubing Pressure
Sep 18, 2021	HUNTON	52	36			40	PUMPING		OPEN	200

Completion and Test Data by Producing Formation

Formation Name: BOIS D ARC

Code: 301BDRC

Class: OIL

Spacing Orders

Order No	Unit Size
55239	40

Perforated Intervals

From	To
3880	3930

Acid Volumes

1,200 GALLONS 15% FE, 100 BARRELS SW FLUSH
--

Fracture Treatments

NONE

Formation Name: CHIMNEY HILL

Code: 251CMNL

Class: OIL

Spacing Orders

Order No	Unit Size
55239	40

Perforated Intervals

From	To
4112	4140

Acid Volumes

1,500 GALLONS

Fracture Treatments

9,000BARRELS WATER, 11,000 GALS ACID, 20/40 SAND
--

Formation	Top
CHECKERBOARD	2785
PINK	3610
WOODFORD SHALE	3822
HUNTON (BOIS D'ARC)	3884
HUNTON (CHOMNEY HILL)	4110
VIOLA LIME	4260
HUNTON	3884

Were open hole logs run? Yes

Date last log run: August 15, 2013

Were unusual drilling circumstances encountered? No

Explanation:

Other Remarks

There are no Other Remarks.

FOR COMMISSION USE ONLY

1147063

Status: Accepted

125-23809-01

API NO. 35-12523809
 OTC PROD. UNIT NO. 211407

Oil and Gas Conservation Division
 P.O. Box 52000
 Oklahoma City, OK 73152-2000
 405-521-2331
 OCCentralProcessing@OCC.OK.GOV

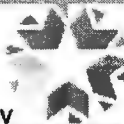

OKLAHOMA
 Corporation
 Commission

Form 1002A
 Rev. 2020

☒ ORIGINAL
☐ AMENDED (Reason) Add'l Perforations

Rule 165:10-3-25

COMPLETION REPORT

TYPE OF DRILLING OPERATION

☒ STRAIGHT HOLE ☐ DIRECTIONAL HOLE ☐ HORIZONTAL HOLE
☐ SERVICE WELL

If directional or horizontal, see reverse for bottom hole location.

COUNTY Bethaune SEC 29 TWP 1N RGE 4E
 LEASE NAME Muri WELL NO. 1-29 DATE OF WELL COMPLETION August 16, 2013
 1st PROD DATE Sept. 7, 2013
 RECOMP DATE Sept. 15, 2021
 ELEVATION 1032' Ground 1024' Latitude Longitude
 OPERATOR Basix Resources Group, LLC OTC / OCC OPERATOR NO. 22981
 ADDRESS 4334 NW Expressway, Ste. 201
 CITY Oklahoma STATE OK ZIP 73116

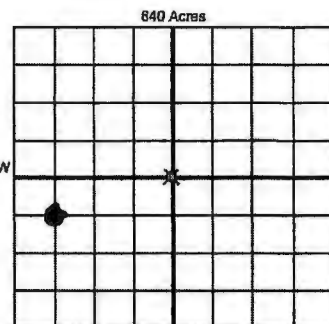

COMPLETION TYPE

☒ SINGLE ZONE
☐ MULTIPLE ZONE
☐ COMMINGLED
 LOCATION EXCEPTION ORDER NO.
 MULTUNIT ORDER NO.
 INCREASED DENSITY ORDER NO.

CASING & CEMENT (Attach Form 1002C)

TYPE	SIZE	WEIGHT	GRADE	FEET	PSI	SAX	TOP OF CMT
CONDUCTOR							
SURFACE	8 7/8"	24	K-55	390'		280	Surface
INTERMEDIATE							
PRODUCTION	5 1/2"	17	J-55	4337'		50	4037'
LINER							

PACKER @ _____ BRAND & TYPE _____ PLUG @ 4225' TYPE CRBP PLUG @ _____ TYPE _____ TOTAL DEPTH 4370'
 PACKER @ _____ BRAND & TYPE _____ PLUG @ _____ TYPE _____ PLUG @ _____ TYPE _____

COMPLETION & TEST DATA BY PRODUCING FORMATION

FORMATION Bethaune Chimney Hill Mo Frac
 SPACING & SPACING ORDER NUMBER (40)55239 55239(40)
 CLASS: Oil, Gas, Dry, Inj. Oil oil
 Disp, Comm Disp, Svc
 PERFORATED INTERVALS 3920'-3930' 4112-4140
3980'-3906'
2 SAT
 ACID/VOLUME 1200 Gal. 150 FE - 100 Bbls SW Flush 1,500 gals
 FRACTURE TREATMENT (Fluids/Prop Amounts) N/A 9000 Bbls water 11,000 gals acid 20/40 sand
All the Hunter

RECEIVED

OCT 29 2021

OKLAHOMA CORPORATION COMMISSION

Min Gas Allowable (165:10-17-7)



OR

Oil Allowable (165:10-13-3)

Purchaser/Measurer

First Sales Date

9/12/2013

INITIAL TEST DATA

INITIAL TEST DATE	<u>Sept. 18, 2021</u>				
OIL-BBL/DAY	<u>52 Bbls</u>				
OIL-GRAVITY (API)	<u>35-36</u>				
GAS-MCF/DAY	<u>-0-</u>				
GAS-OIL RATIO CU FT/BBL	<u>100% Oil</u>				
WATER-BBL/DAY	<u>40 Bbls SW</u>				
PUMPING OR FLOWING	<u>Pumping</u>				
INITIAL SHUT-IN PRESSURE	<u>Vacuum</u>				
CHOKE SIZE	<u>Open</u>				
FLOW TUBING PRESSURE	<u>150# - 200#</u>				

A record of the formations drilled through, and pertinent remarks are presented on the reverse. I declare that I have knowledge of the contents of this report and am authorized by my organization to make this report, which was prepared by me or under my supervision and direction, with the data and facts stated herein to be true, correct, and complete to the best of my knowledge and belief.

SIGNATURE [Signature] NAME (PRINT OR TYPE) Mark Hines DATE 10-22-21 PHONE NUMBER 405-266-0645
 ADDRESS 4334 NW Expressway, Ste. 201 CITY OK STATE OK ZIP 73116 EMAIL ADDRESS 9041456@1750.com

Give formation names and tops, if available, or descriptions and thickness of formations drilled through. Show intervals cored or drillstem tested.

WELL NO.

1-29

NAMES OF FORMATIONS	TOP
Chickasaw	2785'
Pink	3610'
Woodford Shale	3822'
Hunter (Bess D'Arc)	3884'
Hunter (Chimney Hill)	4110'
Viola Lime	4260'

FOR COMMISSION USE ONLY	
ITD on file	<input type="checkbox"/> YES <input type="checkbox"/> NO
APPROVED	DISAPPROVED
2) Reject Codes	

Were open hole logs run? ☒ yes ☐ no

Date Last log was run August 15, 2013

Was CO₂ encountered? ☐ yes ☒ no at what depths? _____

Was H₂S encountered? ☐ yes ☒ no at what depths? _____

Were unusual drilling circumstances encountered? ☐ yes ☒ no

If yes, briefly explain below _____

Other remarks:

If more than three drainholes are proposed, attach a separate sheet indicating the necessary information.

Direction must be stated in degrees azimuth.
Please note, the horizontal drainhole and its end
point must be located within the boundaries of the
lease or spacing unit.

Directional surveys are required for all drainholes and directional wells

SEC	TWP	RGE	COUNTY				
1/4	1/4	1/4	1/4	Feet From 1/4 Sec Lines			
Measured Total Depth		True Vertical Depth		BHL From Lease, Unit, or Property Line:			

LATERAL #1									
SEC	TWP	RGE	COUNTY						
1/4		1/4		1/4		1/4		Feet From 1/4 Sec Lines	
Depth of Deviation		Radius of Turn		Direction				Total Length	
Measured Total Depth		True Vertical Depth		BHL From Lease, Unit, or Property Line:					

SEC	TWP	RGE	COUNTY			
1/4	1/4	1/4	1/4	Feet From 1/4 Sec Lines		
Depth of Deviation	Radius of Turn	Direction	Total Length			
Measured Total Depth	True Vertical Depth	BHL From Lease, Unit, or Property Line:				

SEC	TWP	RGE	COUNTY				
1/4		1/4		1/4		1/4	
Feet From 1/4 Sec Lines							
Depth of Deviation		Radius of Turn		Direction		Total Length	
Measured Total Depth		True Vertical Depth		BHL From Lease, Unit, or Property Line:			