

Oklahoma Corporation Commission  
Oil & Gas Conservation Division  
Post Office Box 52000  
Oklahoma City, Oklahoma 73152-2000  
Rule 165: 10-3-25

Form 1002A

API No.: 35147282110000

**Completion Report**

Spud Date: July 14, 2020

OTC Prod. Unit No.: 147-108943-0-0000

Drilling Finished Date: July 17, 2020

1st Prod Date: May 01, 2021

Completion Date: July 21, 2020

**Drill Type:** STRAIGHT HOLE

Min Gas Allowable: Yes

Well Name: PRATHER 4

Purchaser/Measurer:

Location: WASHINGTON 26 25N 13E  
NW NE NW NW  
165 FNL 925 FWL of 1/4 SEC  
Latitude: 36.626176 Longitude: -95.896325  
Derrick Elevation: 714 Ground Elevation: 710

First Sales Date:

Operator: ESTATE OIL & GAS LLC 24092  
PO BOX 700898  
4017 E 67TH ST  
TULSA, OK 74170-0898

Completion Type		Location Exception		Increased Density	
X	Single Zone	Order No		Order No	
	Multiple Zone	There are no Location Exception records to display.		There are no Increased Density records to display.	
	Commingled				

Casing and Cement							
Type	Size	Weight	Grade	Feet	PSI	SAX	Top of CMT
CONDUCTOR	7	17	H-40	60		7	SURFACE
PRODUCTION	2.875	6.5	H-40	1409		175	SURFACE

Liner								
Type	Size	Weight	Grade	Length	PSI	SAX	Top Depth	Bottom Depth
There are no Liner records to display.								

**Total Depth: 1409**

Packer	
Depth	Brand & Type
There are no Packer records to display.	

Plug	
Depth	Plug Type
There are no Plug records to display.	

Initial Test Data
-------------------

Test Date	Formation	Oil BBL/Day	Oil-Gravity (API)	Gas MCF/Day	Gas-Oil Ratio Cu FT/BBL	Water BBL/Day	Pumpin or Flowing	Initial Shut- In Pressure	Choke Size	Flow Tubing Pressure
May 01, 2021	PERU	5	32			25	PUMPING	240		

Completion and Test Data by Producing Formation

Formation Name: PERU		Code: 404PERU		Class: OIL	
Spacing Orders		Perforated Intervals			
Order No	Unit Size	From		To	
There are no Spacing Order records to display.		593		602	
Acid Volumes		Fracture Treatments			
100 GALLONS 15% HCL		5,500 GALLONS FRESH WATER, 2,300 POUNDS 20/40 SAND			

Formation	Top
BIG LIME	480
PERU	555
OSWEGO	723
BARTLESVILLE	1135
MISSISSIPPI	1335

Were open hole logs run? Yes  
Date last log run: August 12, 2020  
  
Were unusual drilling circumstances encountered? No  
Explanation:

Other Remarks
There are no Other Remarks.

FOR COMMISSION USE ONLY
<div>Status: Accepted</div> <div>1147253</div>

☐ ORIGINAL  
☐ AMENDED (Reason)

**Rule 165:10-3-25**

## COMPLETION REPORT

TYPE OF DRILLING OPERATION					SPUD DATE		
<input checked="" type="checkbox"/> STRAIGHT HOLE		<input type="checkbox"/> DIRECTIONAL HOLE		<input type="checkbox"/> HORIZONTAL HOLE		7/14/20	
<input type="checkbox"/> SERVICE WELL							
If directional or horizontal, see reverse for bottom hole location.							
COUNTY	Washington	SEC	26	TWP	25N	RGE	13E
LEASE NAME				Prather		WELL NO.	4
DATE OF WELL COMPLETION						7/21/20	
1st PROD DATE						5/1/21	
NE 1/4 NW 1/4 NW 1/4				FNL		165	
FWL				925		RECOMP DATE	
ELEVATION Derrick FL		714		Ground		710	
Latitude		36.626176		Longitude		-95.896325	
OPERATOR NAME				Estate Oil & Gas LLC		OTC / OCC OPERATOR NO.	
						24092	
ADDRESS							
P.O. Box 700898							
CITY				Tulsa		STATE	
				OK		ZIP	
						74170	

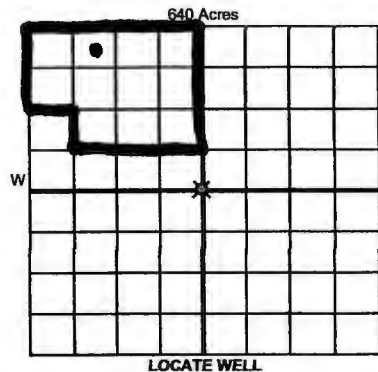

COMPLETION TYPE			CASING & CEMENT (Attach Form 1002C)							
	TYPE	SIZE	WEIGHT	GRADE	FEET	PSI	SAX	TOP OF CMT		
<input checked="" type="radio"/>	SINGLE ZONE									
<input type="radio"/>	MULTIPLE ZONE Application Date									
<input type="radio"/>	COMMINGLED Application Date									
	LOCATION EXCEPTION ORDER NO.									
	MULTIUNIT ORDER NO.									
	INCREASED DENSITY ORDER NO.									
	CONDUCTOR									
	SURFACE	7in	17lb/ft	H-40	60		7	Surface		
	INTERMEDIATE									
	PRODUCTION	2.875	6.5lb/ft	H-40	1409		175	Surface		
	LINER									

PACKER @	BRAND & TYPE	PLUG @	TYPE	PLUG @	TYPE	TOTAL
PACKER @	BRAND & TYPE	PLUG @	TYPE	PLUG @	TYPE	DEPTH 1409

### COMPLETION & TEST DATA BY PRODUCING FORMATION

FORMATION	Peru					
SPACING & SPACING						
ORDER NUMBER						
CLASS: Oil, Gas, Dry, Inj, Disp, Comm Disp, Svc	Oil					
	593-602					
PERFORATED						
INTERVALS						
ACID/VOLUME	15% HCL 100gal					
FRACTURE TREATMENT (Fluids/Prop Amounts)	5500gal fresh water 2300lb 20/40 sand					

**INITIAL TEST DATA**

<input checked="" type="checkbox"/>	Min Gas Allowable OR Oil Allowable	(165:10-17-7)  (165:10-13-3)	Purchaser/Measurer  First Sales Date		
-------------------------------------	--	------------------------------------	--	--	--

INITIAL TEST DATE	5/1/21					
OIL-BBL/DAY	5					
OIL-GRAVITY ( API)	32					
GAS-MCF/DAY	0					
GAS-OIL RATIO CU FT/BBL	0					
WATER-BBL/DAY	25					
PUMPING OR FLOWING	Pumping					
INITIAL SHUT-IN PRESSURE	240					
CHOKE SIZE						
FLOW TUBING PRESSURE						

A record of the formations drilled through, and pertinent remarks are presented on the reverse. I declare that I have knowledge of the contents of this report and am authorized by my organization to make this report, which was prepared by me or under my supervision and direction, with the data and facts stated herein to be true, correct, and complete to the best of my knowledge and belief.

SIGNATURE

4017 E 67TH ST

ADDRESS

**Seth Park**

NAME (PRINT OR TYPE)

Tulsa

CITY

OK

STATE

74136

ZIP

7/6/21

DATE \_\_\_\_\_

9182146846

PHONE NUMBER \_\_\_\_\_

sethpark@estateoilandgas.com

EMAIL ADDRESS

**PLEASE TYPE OR USE BLACK INK ONLY**  
**FORMATION RECORD**

Give formation names and tops, if available, or descriptions and thickness of formations drilled through. Show intervals cored or drillstem tested.

NAMES OF FORMATIONS	TOP
Big Lime	480
Peru	555
Oswego	723
Bartlesville	1135
Mississippi	1335

LEASE NAME \_\_\_\_\_ WELL NO. \_\_\_\_\_

FOR COMMISSION USE ONLY	
ITD on file	<input type="checkbox"/> YES <input type="checkbox"/> NO
APPROVED	DISAPPROVED
2) Reject Codes	

Were open hole logs run?	<input checked="" type="radio"/> yes <input type="radio"/> no
Date Last log was run	8/12/2020
Was CO <sub>2</sub> encountered?	<input type="radio"/> yes <input checked="" type="radio"/> no at what depths? _____
Was H <sub>2</sub> S encountered?	<input type="radio"/> yes <input checked="" type="radio"/> no at what depths? _____
Were unusual drilling circumstances encountered?	<input type="radio"/> yes <input checked="" type="radio"/> no
If yes, briefly explain below	

Other remarks: \_\_\_\_\_

\_\_\_\_\_

\_\_\_\_\_

\_\_\_\_\_

\_\_\_\_\_

\_\_\_\_\_

640 Acres

If more than three drainholes are proposed, attach a separate sheet indicating the necessary information.

Direction must be stated in degrees azimuth. Please note, the horizontal drainhole and its end point must be located within the boundaries of the lease or spacing unit.

Directional surveys are required for all drainholes and directional wells

640 Acres

**BOTTOM HOLE LOCATION FOR DIRECTIONAL HOLE**

SEC	TWP	RGE	COUNTY
1/4	1/4	1/4	1/4
Feet From 1/4 Sec Lines			
Measured Total Depth		True Vertical Depth	
BHL From Lease, Unit, or Property Line:			

**BOTTOM HOLE LOCATION FOR HORIZONTAL HOLE: (LATERALS)**

**LATERAL #1**

SEC	TWP	RGE	COUNTY
1/4	1/4	1/4	1/4
Feet From 1/4 Sec Lines			
Depth of Deviation		Radius of Turn	Direction
Measured Total Depth		True Vertical Depth	Total Length
BHL From Lease, Unit, or Property Line:			

**LATERAL #2**

SEC	TWP	RGE	COUNTY
1/4	1/4	1/4	1/4
Feet From 1/4 Sec Lines			
Depth of Deviation		Radius of Turn	Direction
Measured Total Depth		True Vertical Depth	Total Length
BHL From Lease, Unit, or Property Line:			

**LATERAL #3**

SEC	TWP	RGE	COUNTY
1/4	1/4	1/4	1/4
Feet From 1/4 Sec Lines			
Depth of Deviation		Radius of Turn	Direction
Measured Total Depth		True Vertical Depth	Total Length
BHL From Lease, Unit, or Property Line:			