

Oklahoma Corporation Commission
Oil & Gas Conservation Division
Post Office Box 52000
Oklahoma City, Oklahoma 73152-2000
Rule 165: 10-3-25

Form 1002A

API No.: 35083240690001

Completion Report

Spud Date: March 18, 2013

OTC Prod. Unit No.:

Drilling Finished Date: April 08, 2013

Amended

1st Prod Date:

Amend Reason: CANCELLED UIC PERMIT AUGUST, 2021

Completion Date: April 08, 2013

Recomplete Date: August 01, 2021

Drill Type: STRAIGHT HOLE

Well Name: ELAINE 10-18N-2W 1SWD

Purchaser/Measurer:

Location: LOGAN 10 18N 2W
SE SE SE SW
260 FSL 2427 FWL of 1/4 SEC
Latitude: 36.04384 Longitude: -97.399726
Derrick Elevation: 954 Ground Elevation: 929

First Sales Date:

Operator: CONTANGO MIDSTREAM COMPANY 24435

717 TEXAS AVE STE 2900
HOUSTON, TX 77002-2836

Completion Type		Location Exception		Increased Density	
	Single Zone	Order No		Order No	
	Multiple Zone	There are no Location Exception records to display.		There are no Increased Density records to display.	
	Commingled				

Casing and Cement							
Type	Size	Weight	Grade	Feet	PSI	SAX	Top of CMT
SURFACE	13 3/8	54.5	J-55	475		385	SURFACE
PRODUCTION	9 5/8	47	HCL-80 BTC	6345		337	5348

Liner								
Type	Size	Weight	Grade	Length	PSI	SAX	Top Depth	Bottom Depth
There are no Liner records to display.								

Total Depth: 7965

Packer	
Depth	Brand & Type
There are no Packer records to display.	

Plug	
Depth	Plug Type
6264	CIBP
7938	CEMENT

Initial Test Data

Test Date	Formation	Oil BBL/Day	Oil-Gravity (API)	Gas MCF/Day	Gas-Oil Ratio Cu FT/BBL	Water BBL/Day	Pumpin or Flowing	Initial Shut- In Pressure	Choke Size	Flow Tubing Pressure
There are no Initial Data records to display.										

Completion and Test Data by Producing Formation										
Formation Name: NONE				Code: 999NONE			Class: DRY			

Formation	Top
ARBUCKLE	6236

Were open hole logs run? Yes
Date last log run: March 29, 2013

Were unusual drilling circumstances encountered? No
Explanation:

Other Remarks
AMENDED AUGUST, 2021: CANCELLED UIC PERMIT NUMBER 1303490147. WELL IS DRY. FROM PREVIOUS OPERATOR: IRREGULAR SECTION, OPEN HOLE 6,345' - 7,965'

FOR COMMISSION USE ONLY
<div>Status: Accepted</div> <div>1147263</div>

API NO. 35-083-24069
OTC PROD.
UNIT NO.

Oil and Gas Conservation Division
P.O. Box 52000
Oklahoma City, OK 73152-2000
405-521-2331
OCCentralProcessing@OCC.OK.GOV



OKLAHOMA
Corporation
Commission

Form 1002A
Rev. 2021

ORIGINAL
AMENDED (Reason) CANCELLED UIC PERMIT 08/2021

Rule 165:10-3-25

COMPLETION REPORT

TYPE OF DRILLING OPERATION
☒ STRAIGHT HOLE ☐ DIRECTIONAL HOLE ☐ HORIZONTAL HOLE
☐ SERVICE WELL

If directional or horizontal, see reverse for bottom hole location.

COUNTY	LOGAN	SEC	10	TWP	18N	RGE	2W	SPUD DATE	03/18/2013
LEASE NAME	ELAINE 10-18N-2W	WELL NO.	1SWD	DRLG FINISHED DATE	04/08/2013	DATE OF WELL COMPLETION	04/08/2013	1st PROD DATE	
SE 1/4 SE 1/4 SE 1/4 SW 1/4	FSL	260	FWL	2427	RECOMP DATE	8/1/2021			
ELEVATION Derrick FL	954	Ground	929	Latitude	35.04384	Longitude	-97.399726		
OPERATOR NAME	CONTANGO MIDSTREAM COMPANY	OTC / OCC OPERATOR NO.	24435						
ADDRESS	717 TEXAS AVE., SUITE 2900								
CITY	HOUSTON	STATE	TX	ZIP	77002				

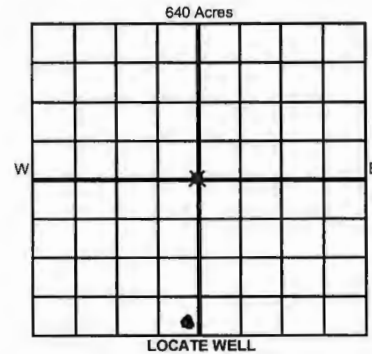

COMPLETION TYPE

<input type="radio"/> SINGLE ZONE	
<input type="radio"/> MULTIPLE ZONE	
Application Date	
<input type="radio"/> COMMINGLED	
Application Date	
LOCATION EXCEPTION ORDER NO.	
MULTIUNIT ORDER NO.	
INCREASED DENSITY ORDER NO.	

CASING & CEMENT (Attach Form 1002C)

TYPE	SIZE	WEIGHT	GRADE	FEET	PSI	SAX	TOP OF CMT
CONDUCTOR							
SURFACE	13 3/8	54.5	J-55	475		385	surface
INTERMEDIATE	9 5/8	47	HCL-80 BTC	6345		337	5348
PRODUCTION							
LINER							

PACKER @ _____ BRAND & TYPE _____ PLUG @ 7938 TYPE CEMENT PLUG @ 6264 TYPE CIBP TOTAL
PACKER @ _____ BRAND & TYPE _____ PLUG @ _____ TYPE PLUG @ _____ TYPE DEPTH 7965

COMPLETION & TEST DATA BY PRODUCING FORMATION

FORMATION	ARBUCKLE	nothing open above plug				
SPACING & SPACING ORDER NUMBER						
CLASS: Oil, Gas, Dry, Inj, Disp, Comm Disp, Svc	Disp Dry					
PERFORATED INTERVALS						
ACID/VOLUME						
FRACTURE TREATMENT (Fluids/Prop Amounts)						

RECEIVED

DEC 06 2021

OKLAHOMA CORPORATION
COMMISSION

Min Gas Allowable (165:10-17-7)



OR

Oil Allowable (165:10-13-3)

Purchaser/Measurer

First Sales Date

INITIAL TEST DATA

INITIAL TEST DATE						
OIL-BBL/DAY						
OIL-GRAVITY (API)						
GAS-MCF/DAY						
GAS-OIL RATIO CU FT/BBL						
WATER-BBL/DAY						
PUMPING OR FLOWING						
INITIAL SHUT-IN PRESSURE						
CHOKE SIZE						
FLOW TUBING PRESSURE						

A record of the formations drilled through, and pertinent remarks are presented on the reverse. I declare that I have knowledge of the contents of this report and am authorized by my organization to make this report, which was prepared by me or under my supervision and direction, with the data and facts stated herein to be true, correct, and complete to the best of my knowledge and belief.

Adenner

ALISON DENNER

713-236-7456

SIGNATURE

NAME (PRINT OR TYPE)

DATE

PHONE NUMBER

717 TEXAS AVE., SUITE 2900

HOUSTON

TX

77002

adenner@contango.com

ADDRESS

CITY

STATE

ZIP

EMAIL ADDRESS

PLEASE TYPE OR USE BLACK INK ONLY
FORMATION RECORD

Give formation names and tops, if available, or descriptions and thickness of formations drilled through. Show intervals cored or drillstem tested.

NAMES OF FORMATIONS	TOP
ARBUCKLE	6236

LEASE NAME ELAINE 10-18N-2W WELL NO. 1SWD

FOR COMMISSION USE ONLY	
ITD on file	<input type="checkbox"/> YES <input type="checkbox"/> NO
APPROVED	DISAPPROVED
2) Reject Codes	

Were open hole logs run?	<input checked="" type="radio"/> yes <input type="radio"/> no
Date Last log was run	03/29/2013
Was CO ₂ encountered?	<input type="radio"/> yes <input checked="" type="radio"/> no at what depths? _____
Was H ₂ S encountered?	<input type="radio"/> yes <input checked="" type="radio"/> no at what depths? _____
Were unusual drilling circumstances encountered?	<input type="radio"/> yes <input checked="" type="radio"/> no
If yes, briefly explain below	

Other remarks: AMDENDED 08/2021: CANCELLED UIC PERMIT #1303490147. WELL IS ~~DRY~~ FROM PREVIOUS OPERATOR: IRREGULAR SECTION, UIC PERMIT #1303490147. MEAS FROM KB. CMT REPORT MEAS FROM GL. OPEN HOLE 6345-7965'

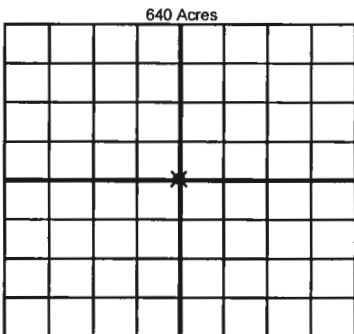

If more than three drainholes are proposed, attach a separate sheet indicating the necessary information.

Direction must be stated in degrees azimuth. Please note, the horizontal drainhole and its end point must be located within the boundaries of the lease or spacing unit.

Directional surveys are required for all drainholes and directional wells

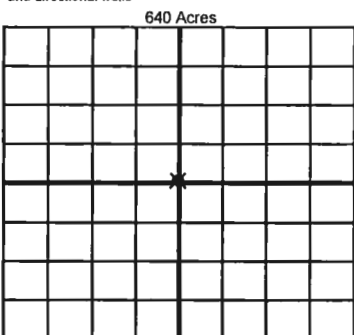

BOTTOM HOLE LOCATION FOR DIRECTIONAL HOLE

SEC	TWP	RGE	COUNTY
1/4	1/4	1/4	1/4
Measured Total Depth		True Vertical Depth	Feet From 1/4 Sec Lines
BHL From Lease, Unit, or Property Line:			

BOTTOM HOLE LOCATION FOR HORIZONTAL HOLE: (LATERALS)

SEC	TWP	RGE	COUNTY
1/4	1/4	1/4	1/4
Depth of Deviation		Radius of Turn	Direction
Measured Total Depth		True Vertical Depth	Total Length
BHL From Lease, Unit, or Property Line:			

LATERAL #2

SEC	TWP	RGE	COUNTY
1/4	1/4	1/4	1/4
Depth of Deviation		Radius of Turn	Direction
Measured Total Depth		True Vertical Depth	Total Length
BHL From Lease, Unit, or Property Line:			

LATERAL #3

SEC	TWP	RGE	COUNTY
1/4	1/4	1/4	1/4
Depth of Deviation		Radius of Turn	Direction
Measured Total Depth		True Vertical Depth	Total Length
BHL From Lease, Unit, or Property Line:			