

Oklahoma Corporation Commission  
Oil & Gas Conservation Division  
Post Office Box 52000  
Oklahoma City, Oklahoma 73152-2000  
Rule 165: 10-3-25

Form 1002A

API No.: 35083243000001

**Completion Report**

Spud Date: July 01, 2014

OTC Prod. Unit No.:

Drilling Finished Date: July 14, 2014

**Amended**

1st Prod Date:

Amend Reason: CANCELLED UIC PERMIT AUGUST, 2021

Completion Date: August 13, 2014

Recomplete Date: August 01, 2021

**Drill Type: STRAIGHT HOLE**

Well Name: LEMMONS 14-19N-3W 1SWD

Purchaser/Measurer:

Location: LOGAN 14 19N 3W  
NW SE SE SE  
491 FSL 590 FEL of 1/4 SEC  
Latitude: 36.117432 Longitude: -97.481226  
Derrick Elevation: 1110 Ground Elevation: 1086

First Sales Date:

Operator: CONTANGO MIDSTREAM COMPANY 24435

717 TEXAS AVE STE 2900  
HOUSTON, TX 77002-2836

Completion Type		Location Exception		Increased Density	
	Single Zone	Order No		Order No	
	Multiple Zone	There are no Location Exception records to display.		There are no Increased Density records to display.	
	Commingled				

Casing and Cement							
Type	Size	Weight	Grade	Feet	PSI	SAX	Top of CMT
CONDUCTOR	20	94	J-55	65		8	SURFACE
SURFACE	13 3/8	54.5	J-55	510		420	SURFACE
PRODUCTION	9 5/8	40	HCK-55	6555		905	2472

Liner								
Type	Size	Weight	Grade	Length	PSI	SAX	Top Depth	Bottom Depth
There are no Liner records to display.								

**Total Depth: 8098**

Packer	
Depth	Brand & Type
There are no Packer records to display.	

Plug	
Depth	Plug Type
6350	CIBP
6536	RETRIEVABLE
8050	CEMENT

Initial Test Data										
Test Date	Formation	Oil BBL/Day	Oil-Gravity (API)	Gas MCF/Day	Gas-Oil Ratio Cu FT/BBL	Water BBL/Day	Pumpin or Flowing	Initial Shut-In Pressure	Choke Size	Flow Tubing Pressure
There are no Initial Data records to display.										

Completion and Test Data by Producing Formation										
Formation Name: NONE				Code: 999NONE			Class: DRY			

Formation	Top
ARBUCKLE	6555

Were open hole logs run? Yes  
 Date last log run: July 11, 2014  
  
 Were unusual drilling circumstances encountered? No  
 Explanation:

Other Remarks
AMENDED AUGUST, 2021: CANCELLED UIC PERMIT NUMBER 1408120165. WELL IS DRY. FROM PREVIOUS OPERATOR: IRREGULAR SECTION, OPEN HOLE 6,555' - 8,050'

FOR COMMISSION USE ONLY	
Status: Accepted	1147260

API NO. 35-083-24300  
OTC PROD.  
UNIT NO.

Oil and Gas Conservation Division  
P.O. Box 52000  
Oklahoma City, OK 73152-2000  
405-521-2331  
OCCCentralProcessing@OCC.OK.GOV



OKLAHOMA  
Corporation  
Commission

Form 1002A  
Rev. 2021

ORIGINAL  
AMENDED (Reason) CANCELLED UIC PERMIT 08/2021

Rule 165:10-3-25

COMPLETION REPORT

TYPE OF DRILLING OPERATION  
☒ STRAIGHT HOLE ☐ DIRECTIONAL HOLE ☐ HORIZONTAL HOLE  
☐ SERVICE WELL

If directional or horizontal, see reverse for bottom hole location.

SPUD DATE 07/01/2014  
DRLG FINISHED DATE 07/14/2014  
DATE OF WELL COMPLETION 08/13/2014  
1st PROD DATE  
RECOMP DATE 8-1-2021  
ELEVATION Derrick FL 1110 Ground 1086  
Latitude 36.117432 Longitude -97.481226  
OPERATOR NAME CONTANGO MIDSTREAM COMPANY  
OTC / OCC OPERATOR NO. 24435  
ADDRESS 717 TEXAS AVE., SUITE 2900  
CITY HOUSTON STATE TX ZIP 77002

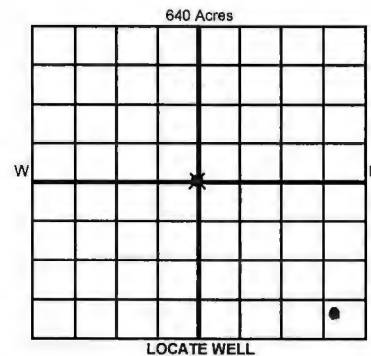

COMPLETION TYPE

☐ SINGLE ZONE  
☐ MULTIPLE ZONE  
Application Date  
☐ COMMINGLED  
Application Date  
LOCATION EXCEPTION ORDER NO.  
MULTIUNIT ORDER NO.  
INCREASED DENSITY ORDER NO.

CASING & CEMENT (Attach Form 1002C)

TYPE	SIZE	WEIGHT	GRADE	FEET	PSI	SAX	TOP OF CMT
CONDUCTOR	20	94	J-55	65		8	surface
SURFACE	13 3/8	54.5	J-55	510		420	surface
INTERMEDIATE	9 5/8	40	HCK-55	6555		905	2472
PRODUCTION							
LINER							

Plug @ 6536 BRAND & TYPE RETRIEVABLE PLUG @ 8050 TYPE CEMENT PLUG @ 6350 TYPE CIBP  
PACKER @ BRAND & TYPE PLUG @ TYPE PLUG @ TYPE  
TOTAL DEPTH 8098

COMPLETION & TEST DATA BY PRODUCING FORMATION

FORMATION	ARBuckle	nothing open above plug			
SPACING & SPACING ORDER NUMBER					
CLASS: Oil, Gas, Dry, Inj, Disp, Comm Disp, Svc	Disp Dry				
PERFORATED INTERVALS					
ACID/VOLUME					
FRACTURE TREATMENT (Fluids/Prop Amounts)					

RECEIVED

DEC 06 2021

OKLAHOMA CORPORATION  
COMMISSION

Min Gas Allowable (165:10-17-7)



OR

Oil Allowable (165:10-13-3)

Purchaser/Measurer

First Sales Date

INITIAL TEST DATA

INITIAL TEST DATE					
OIL-BBL/DAY					
OIL-GRAVITY ( API)					
GAS-MCF/DAY					
GAS-OIL RATIO CU FT/BBL					
WATER-BBL/DAY					
PUMPING OR FLOWING					
INITIAL SHUT-IN PRESSURE					
CHOKE SIZE					
FLOW TUBING PRESSURE					

A record of the formations drilled through, and pertinent remarks are presented on the reverse. I declare that I have knowledge of the contents of this report and am authorized by my organization to make this report, which was prepared by me or under my supervision and direction, with the data and facts stated herein to be true, correct, and complete to the best of my knowledge and belief.

*Adenner*

SIGNATURE

717 TEXAS AVE., SUITE 2900

ADDRESS

HOUSTON

CITY

ALISON DENNER

NAME (PRINT OR TYPE)

TX 77002

STATE

ZIP

713-236-7456

DATE

PHONE NUMBER

adenner@contango.com

EMAIL ADDRESS

PLEASE TYPE OR USE BLACK INK ONLY

FORMATION RECORD

Give formation names and tops, if available, or descriptions and thickness of formations drilled through. Show intervals cored or drillstem tested.

LEASE NAME LEMMONS 14-19N-3W

WELL NO. 1SWD

NAMES OF FORMATIONS	TOP
ARBUCKLE	6555

FOR COMMISSION USE ONLY	
ITD on file <input type="checkbox"/> YES <input type="checkbox"/> NO	
APPROVED _____	DISAPPROVED _____
2) Reject Codes	
_____	
_____	
_____	
_____	

Were open hole logs run?	<input checked="" type="radio"/> yes <input type="radio"/> no
Date Last log was run	07/11/2014
Was CO <sub>2</sub> encountered?	<input type="radio"/> yes <input checked="" type="radio"/> no at what depths? _____
Was H <sub>2</sub> S encountered?	<input type="radio"/> yes <input checked="" type="radio"/> no at what depths? _____
Were unusual drilling circumstances encountered?	<input type="radio"/> yes <input checked="" type="radio"/> no
If yes, briefly explain below	

Other remarks: AMENDED 08/2021: CANCELLED UIC PERMIT #1408120165. WELL IS DRY  
FROM PREVIOUS OPERATOR: IRREGULAR SECTION, UIC PERMIT #1408120165.  
OPEN HOLE 6555-8050'

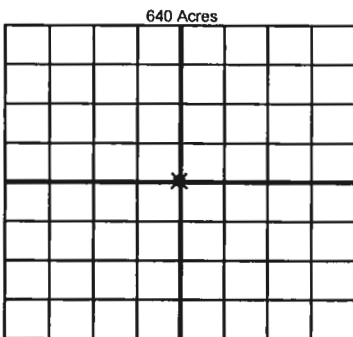

If more than three drainholes are proposed, attach a separate sheet indicating the necessary information.

Direction must be stated in degrees azimuth. Please note, the horizontal drainhole and its end point must be located within the boundaries of the lease or spacing unit.

Directional surveys are required for all drainholes and directional wells

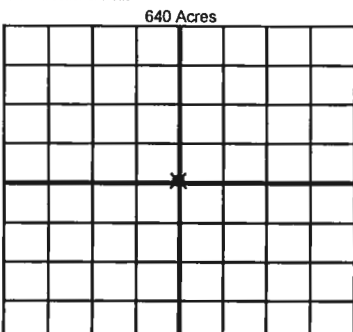

BOTTOM HOLE LOCATION FOR DIRECTIONAL HOLE

SEC	TWP	RGE	COUNTY
1/4	1/4	1/4	1/4
Measured Total Depth		True Vertical Depth	Feet From 1/4 Sec Lines
			BHL From Lease, Unit, or Property Line:

BOTTOM HOLE LOCATION FOR HORIZONTAL HOLE: (LATERALS)

LATERAL #1

SEC	TWP	RGE	COUNTY
1/4	1/4	1/4	1/4
Depth of Deviation		Radius of Turn	Direction
Measured Total Depth		True Vertical Depth	Total Length
			BHL From Lease, Unit, or Property Line:

LATERAL #2

SEC	TWP	RGE	COUNTY
1/4	1/4	1/4	1/4
Depth of Deviation		Radius of Turn	Direction
Measured Total Depth		True Vertical Depth	Total Length
			BHL From Lease, Unit, or Property Line:

LATERAL #3

SEC	TWP	RGE	COUNTY
1/4	1/4	1/4	1/4
Depth of Deviation		Radius of Turn	Direction
Measured Total Depth		True Vertical Depth	Total Length
			BHL From Lease, Unit, or Property Line: